

STANDARD LENGTHS.

PART NUMBER	'L' (Metres)
53380-010500	5
53380-011000	10
53380-011500	15
53380-012000	20
53380-012500	25
53380-013000	30
53380-013500	35
53380-014000	40
53380-014500	45
53380-015000	50
53380-016000	60
53380-017000	70
53380-018000	80
53380-019000	90
53380-01L000	100
53380-01L250	125
53380-01L500	150
53380-01L750	175
53380-01M000	200

ITEM	PART No.	DESCRIPTION	QTY.
1	HM1C16D2J110EB	4x6 - CONNECTOR KIT	2
2	HM1C01CR02B	FERRULE	2
3	435605-012	120 Ohm 26 AWG Twisted pair cable / CS-005	'L'
4	53390-001	LABEL-IDENTIFICATION	2

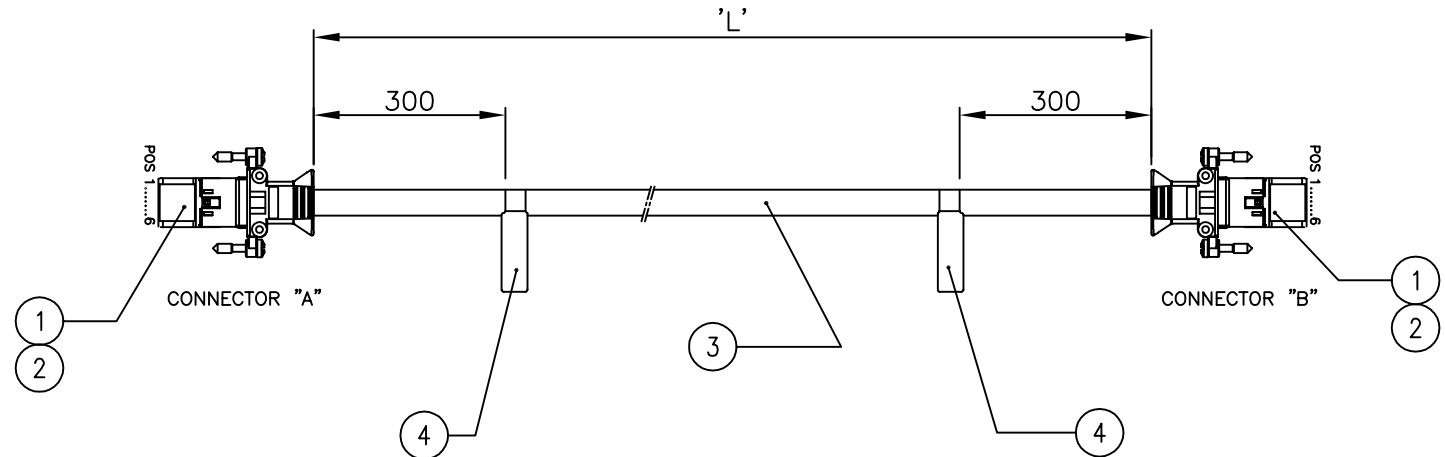

- 1 DASH NUMBER -XXXXY
- XX DESIGNATES THE ASSEMBLY CONFIGURATION
 - YYYY DEFINES THE ASSEMBLY LENGTH, ATTENTION, THERE ARE TWO OPTIONS !!
- a) ASSY LENGTH SHORTER THAN 100 METRES.
ONLY FIGURES ARE USED.
IN THIS CASE, THE FIGURES DESIGNATE THE CABLE ASSY LENGTH IN CENTIMETRES.
e.g. 0600 MEANS A LENGTH OF 600 cm.
- b) ASSY LENGTH EQUAL TO OR LONGER THAN 100 METRES.
ONE LETTER "L" OR "M" AND THREE FIGURES ARE USED.
- DESIGNATE THE ADDITIONAL CABLE LENGTH IN DECIMETRES.
e.g. L265 MEANS A LENGTH OF 126.5 metres.
"M" MEANS 200 METRE. AGAIN THE ADDITIONAL FIGURES DESIGNATE THE ADDITIONAL CABLE LENGTH IN DECIMETRES.
e.g. M500 MEANS A LENGTH OF 250 metres.

- 2 FOR TOLERANCES ON CABLE LENGTH "L", SEE TABLE 1.
- 3 ASSEMBLY MUST BE TESTED ELECTRICALLY FOR CORRECT PAIRS, CONTINUITY, SHORT CIRCUITS AND HIGH POT.
- 4 PACK IN ANTISTATIC BAG WITH FCI PART No. & BATCH No.
- 5 MATING BOARD CONNECTORS - 72858-20X OR 72844-20X

TABLE 1	
CABLE LENGTH DIM "L" mm	TOLERANCES mm
< 500	+5mm/0mm
500-1000	+10mm/0mm
> 1000	+1%/0mm

mat'l code				tolerances unless otherwise specified		CUSTOMER COPY		ELECTRONICS FCI www.fciconnect.com	
ltr	ecr no	dr	date	linear		projection		title	
A	SC2258	JFO	021031						
				angles		mm		product family	CABLE ASSY
				dr	J.J.Fox.	021031	scale	size	dwg no
				enrg	J.J.Fox.	021031			
				chr	R.Albaracin.	021031	NTS	A3	53380
				appd	J.J.Fox.	021031			
sheet	revision	A	A						
index	sheet	1	2						

Tous droits strictement réservés. Reproduction ou communication à des tiers
interdite sous quelque forme que ce soit sans autorisation écrite du propriétaire.
Propriété de FCI Inc.
© FCI Inc.

All rights strictly reserved. Reproduction or issue to third parties in any form
whatever is not permitted without written authority from the proprietor.
Property of FCI Inc.
© FCI Inc.

PRODUCT NUMBER
53380-01yyyy

WIRING DIAGRAM 1
FOR CABLE ASSEMBLY 53380-01yyyy

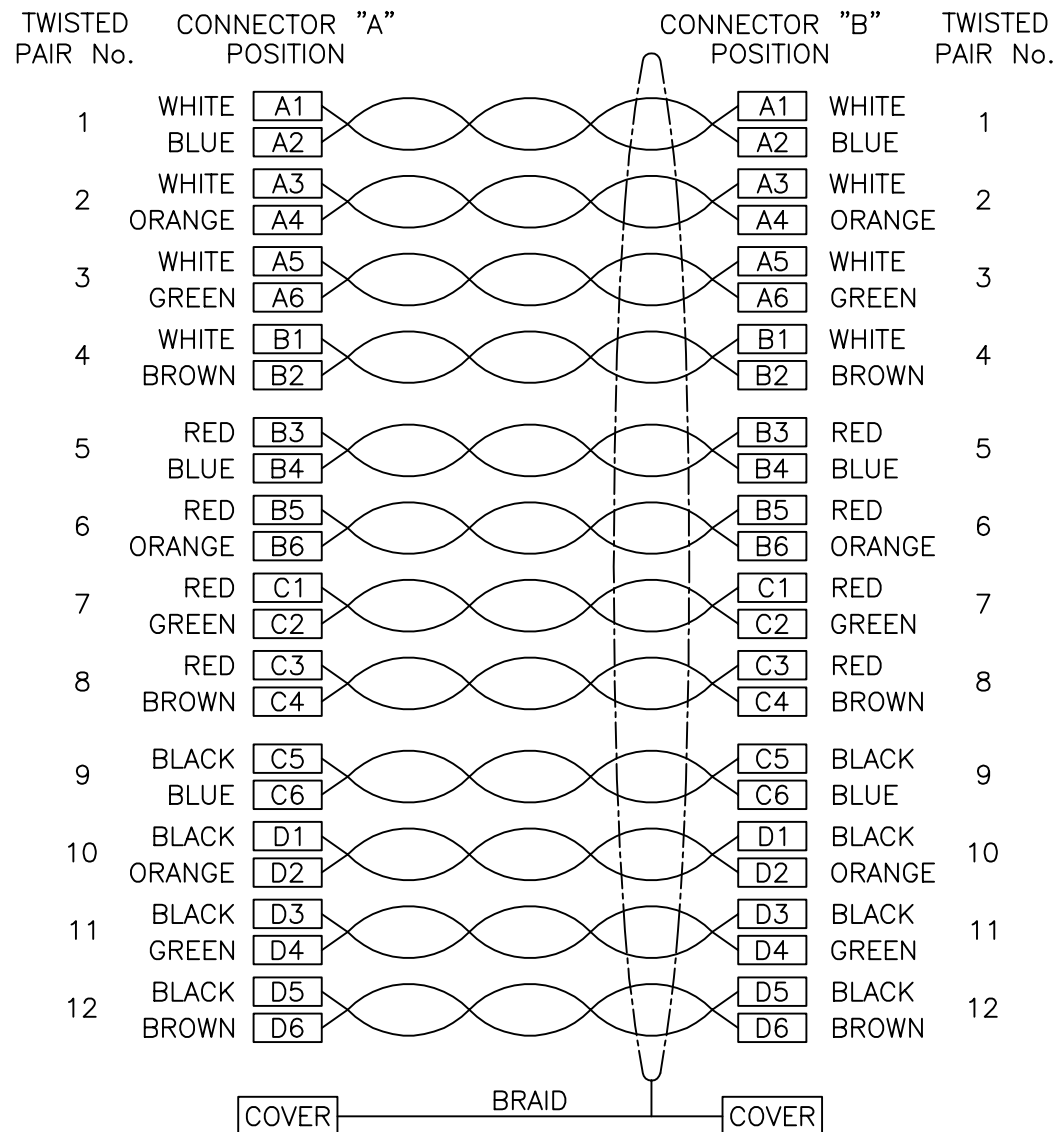

mat'l code				tolerances unless otherwise specified		CUSTOMER COPY		FCI ELECTRONICS www.fciconnect.com	
ltr	ecn no	dr	date	linear		projection		title	
A	SC2258	JFO	021031					SOFIX-4X6-SIGNAL	
				angles		mm		product family	Cable Assy
								size	dwg no
				dr	J.J.Fox.	021031	scale	A3 53380	
				enrg	J.J.Fox.	021031		code	213
				chr	R.Albaracin.	021031	NTS	sheet	2 of
				appd	J.J.Fox.	021031			
sheet index	revision	sheet							