

# ADAM TECH

ADAM TECHNOLOGIES INC.

## IDC DIP PLUG

.100" x .300" [2.54 x 7.62]

.100" x .600" [2.54 x 15.24]

FDP SERIES

### INTRODUCTION:

Adam Tech FDP and FDH Series DIP Plugs are used for fast connection of flat cable directly to PC boards or when connect/disconnect capabilities are required. They are widely used for interboard bussing to connect one board to another or one subsystem to another. Our design conforms to MIL-C-83503/6 and includes innovative features such as cable guides and underside cap conductor slots for easy cable alignment. A positive lock feature ensures uniform termination certainty. Our snap-tight cover withstands over 25 lbs. of pull-off force and the specially designed contacts provide gas-tight termination that can easily be done with a bench press or simple hand tool.

### FEATURES:

- Low profile
- Mates with standard DIP Socket or directly solders to PCB
- Pre-assembled cover with molded in cable guides ensures proper positioning and speeds assembly
- Accepts 28 AWG flat cable on .050" centers
- Strong, yet flexible posts
- Disconnect capability when used with IC Socket

### MATING OPTIONS:

Mates with Adam Tech ICS Series IC Sockets or directly to PC board

### SPECIFICATIONS:

#### Material:

Insulator: Polybutylene Terephthalate (PBT), glass reinforced thermoplastic, rated UL 94V-0

Insulator color: Black

Optional color: Gray

Contacts: Phosphor Bronze

#### Plating:

100  $\mu$ m bright tin-lead plate to MIL-T-10727, Type 1 over 50  $\mu$ m copper underplate to MIL-C-14550. Optional 5  $\mu$ m or 30  $\mu$ m gold to MIL-G-45204, Type II, Grade C on solder tails.

#### Electrical:

Operation voltage: 250 VAC max

Current rating: 1 Amp max

Contact resistance: 20 m $\Omega$  max

Insulation resistance: 5000 M $\Omega$  min @ 1000 VDC between adjacent contacts (75° F and 50% R.H.)

Dielectric withstanding voltage: 1000 VAC min rms (sea level)

#### Environmental:

Operating temperature: -65°C to +125°C

### PACKAGING:

Anti-static plastic trays

### APPROVALS AND CERTIFICATIONS:

Recognized under the component program

of Underwriters Laboratories, Inc. No. E167232

Certified by Canadian Standards Association No. LR75112

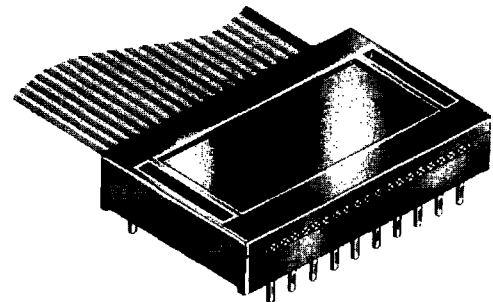
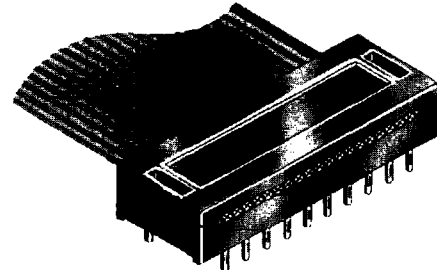

### ORDERING INFORMATION

FDP

16

T

#### SERIES INDICATOR

FDP = Flat Cable, DIP Plug

FDH = Flat Cable, 4 Row Transition Plug

#### PLATING

T = Tin plated  
G = Gold plating on tails

#### POSITIONS

FDP: 8, 10, 14, 16, 18, 20, 24, 28, 32, 40

FDH: 10, 14, 16, 20, 26, 34, 40, 50, 60

### OPTIONS:

Add as suffix to basic part number

30 = 30  $\mu$ m gold plating on tails

GY = Gray color insulator

# ADAM TECH

ADAM TECHNOLOGIES INC.

# IDC DIP PLUG

.100" x .300" [2.54 x 7.63]

.100" x .600" [2.54 x 15.24]

FDP SERIES

## .100" x .300" POSITIONS 8 - 20

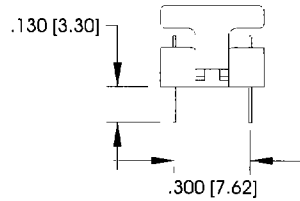
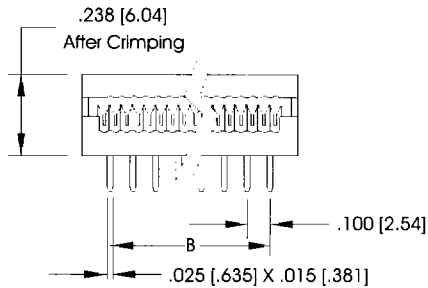
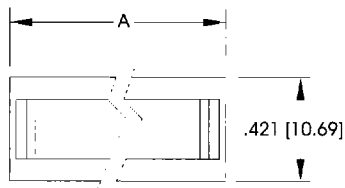

Unit: Inch / mm

Dimensional:		
CONTACTS	A	B
8	.565 (14.35)	.300 ( 7.62)
10	.665 (16.89)	.400 (10.16)
14	.865 (21.97)	.600 (15.24)
16	.965 (24.51)	.700 (17.78)
18	1.065 (27.05)	.800 (20.32)
20	1.165 (29.59)	.900 (22.86)
24	1.365 (34.67)	1.100 (27.94)
28	1.565 (39.75)	1.300 (33.02)
32	1.765 (44.83)	1.500 (38.10)
40	2.165 (54.99)	1.900 (48.26)

## .100" x .600" POSITIONS 24 - 40

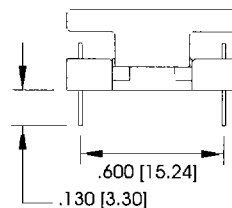
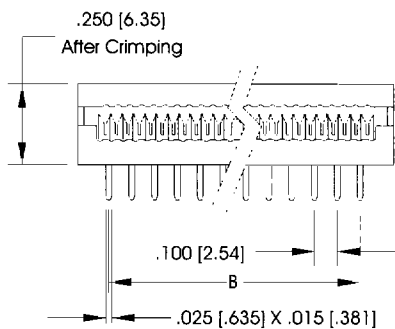
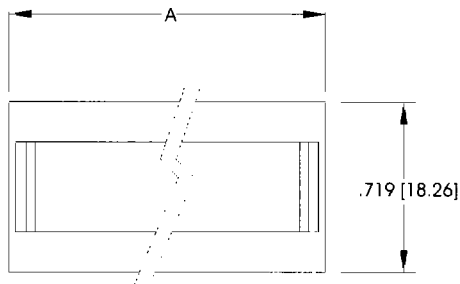

### PC Board Layout

#### Positions 8 thru 20

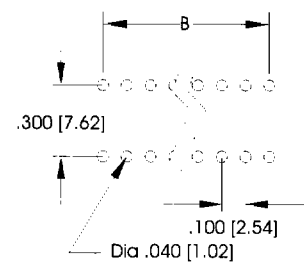

### PC Board Layout

#### Positions 24 thru 40

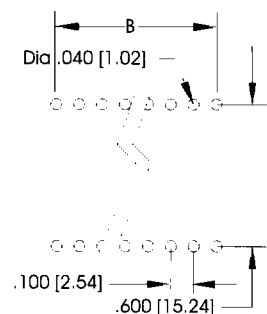

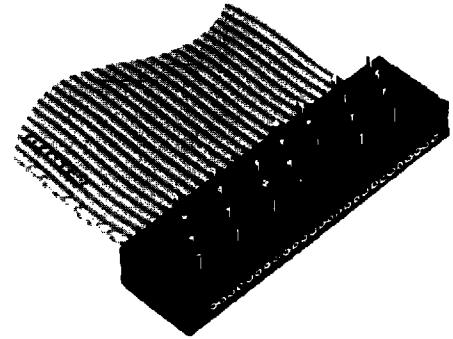
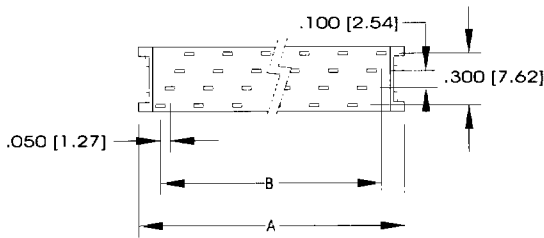
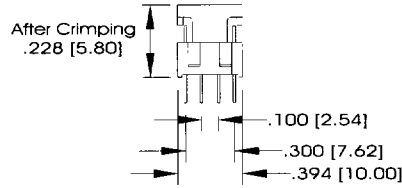
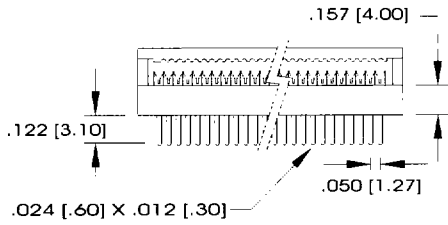

Ordering Information Page 228

### PC Board Layout

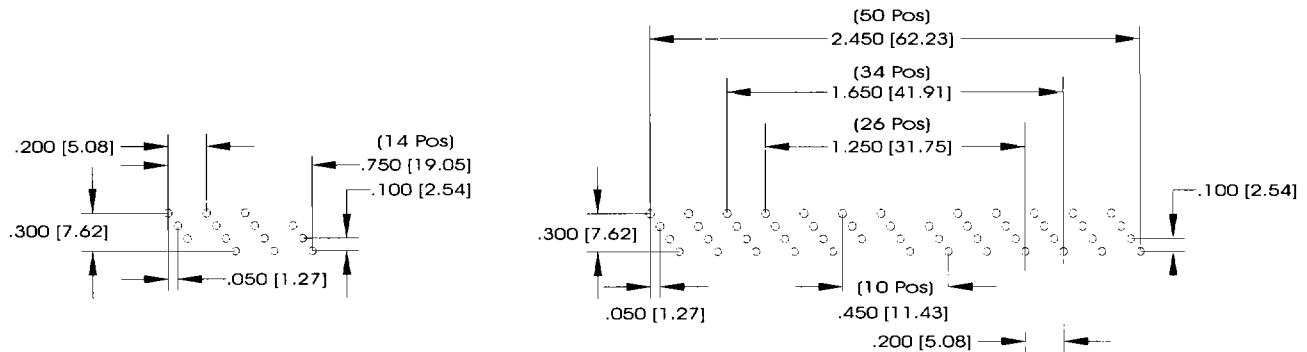

Unit: Inch / mm

Dimensional:					
POSITIONS	A	B	POSITIONS	A	B
10	.689 (17.50)	.450 (11.43)	34	1.889 (47.98)	1.650 (41.91)
14	.889 (22.58)	.650 (16.51)	40	2.189 (55.60)	1.950 (49.53)
16	.989 (25.12)	.750 (19.05)	50	2.689 (68.30)	2.450 (62.23)
20	1.189 (30.20)	.950 (24.13)	60	3.189 (81.00)	2.950 (74.93)
26	1.468 (37.28)	1.250 (31.75)			