

Customer Information Sheet

DRAWING No.: P42-XX11

SHEET 2 OF 2

IF IN DOUBT - ASK

©

NOT TO SCALE

THIRD ANGLE PROJECTION

ALL DIMENSIONS IN mm

PROBE HEAD VARIANTS

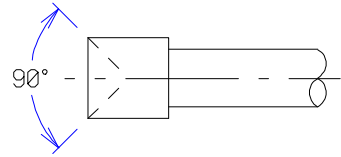

HARWIN PART NO.
P42-1011

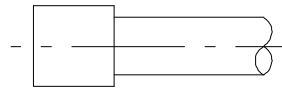

HARWIN PART NO.
P42-0511

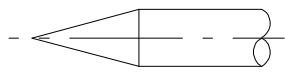

HARWIN PART NO.
P42-0111

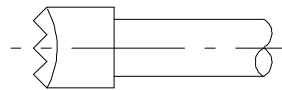

HARWIN PART NO.
P42-4011

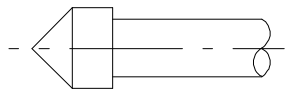

HARWIN PART NO.
P42-2011



HARWIN PART NO.
P42-7011

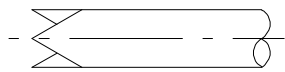

HARWIN PART NO.
P42-3011

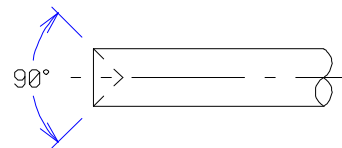

HARWIN PART NO.
P42-1311

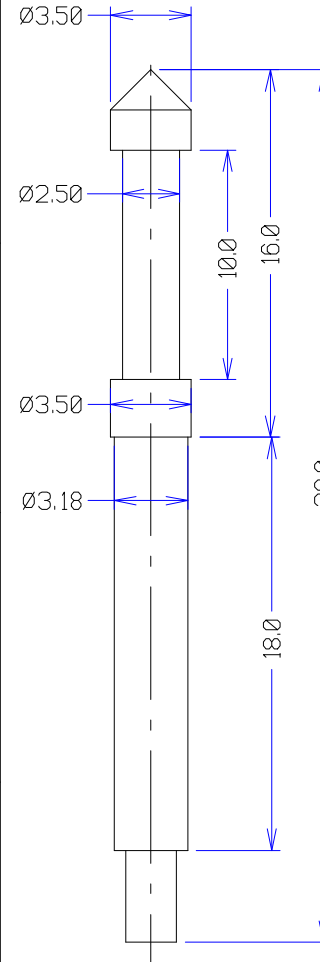

NOTES:

1. MINIMUM CENTRES = 4.20mm.
2. MATERIALS AND FINISH:
PLUNGER = BERYLLIUM COPPER,
GOLD PLATED
BARREL = NICKEL PLATED
3. RECOMMENDED MOUNTING HOLE =
Ø3.25-3.20mm.

SPECIFICATIONS:

FULL TRAVEL = 10.0mm
SPRING FORCE = 1.96N (200g) @ 10.0mm
CURRENT RATING = 5A

ORDER CODE:
P42-XX11
PROBE HEAD
VARIANT (SEE TABLE)

2	04.01.99	4703
ISS.	DATE	C/N
APPROVED:		
CHECKED:		
DRAWN: D. BECK		
CUSTOMER REF.		
ASSEMBLY DRG:		

HARWIN

TOLERANCES

X. = ±1mm
X.X = ±0.25mm
X.XX = ±0.10mm
X.XXX = ±0.01mm
ANGLES = ±1°
UNLESS STATED

MATERIAL:

SEE NOTE 2

FINISH:

SEE NOTE 2

S/AREA:

mm²

TITLE:

4.20mm MIN. CENTRE
ONE-PIECE SPRING PROBE

DRAWING NUMBER:

P42-XX11

HARWIN INC
U.S.A.
TEL: (812) 285 0055
FAX: (812) 285 0056

HARWIN PLC
U.K.
TEL: 01705 370451
FAX: 01705 314590

HARWIN PTE
SINGAPORE
TEL: 65 7794909
FAX: 65 7793868

SHT
2
OF
2