

Direct Solder Type Cable Connectors for Semi-Rigid Cable

Straight Plug, Solderless Version, Without Center Contact*

Part Number	Cable Number
055-624-6703890	RG402/U

* Center conductor of cable is used as contact.

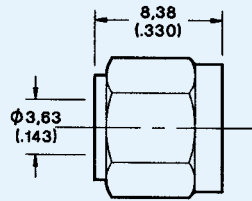

Assembly Instruction AI-507 (Page 123)

Straight Plug, Solderless Version, With Center Contact

Part Number	Cable Number	A
055-607-6702890	RG405/U	2,20 (.088)
055-607-6203890	RG402/U	3,60 (.142)

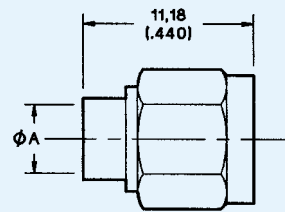

Assembly Instruction AI-521 (Page 123)

Right Angle Plug

Part Number	Cable Number	A
055-611-3702890	RG405/U	2,20 (.088)
055-611-3703890	RG402/U	3,60 (.142)

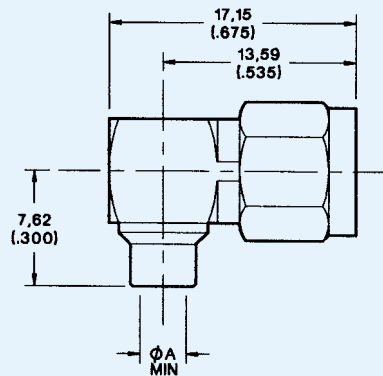

Assembly Instruction AI-98 (Page 111)

Flange Mount Panel Jack

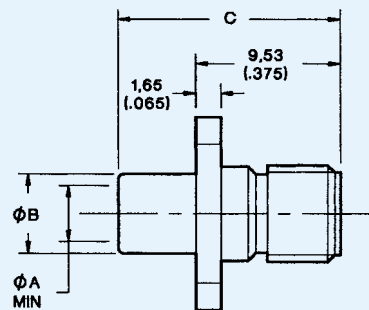

Assembly Instruction AI-278 (Page 117)

Part Numbers		Cable Number	Dimensions		
Square Flange	Narrow Flange		A	B	C
055-604-9172310	055-604-9272310	RG405/U	2,20 (.088)	3,05 (.120)	12,70 (.500)
055-604-9173310	055-604-9273310	RG402/U	3,60 (.142)	4,68 (.184)	14,28 (.560)