

Part No.	Type	Nominal diameter	Withdraw. force	Rated current	Contact resistance
----------	------	------------------	-----------------	---------------	--------------------

5.3302-050 (50 cm) **MLK 1.5-B**

5.3302-100 (100 cm)

5.3302-150 (150 cm)

5.3302-200 (200 cm)

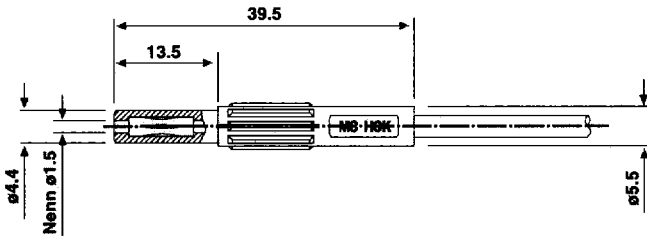

Highly flexible female connecting leads. Axial-entry 1.5 mm safety socket with reliable Multilam™ contacts at one end and open-ended lead at the other. The lead's silicone insulation and the socket's thermoplastic elastomer insulation **can be sterilized in steam**. Brass, gold plated.

- Ratings:
- Wire cross section 0.5 mm²
 - Operating temperature (lead): -80°C to +150°C (-112°F to 302°F)
 - Operating temperature (insulator): -40°C to +80°C (-40°F to 176°F)

1:1 Colors: 21 - 23, 29

5.3301 **MEB 1.5-R**

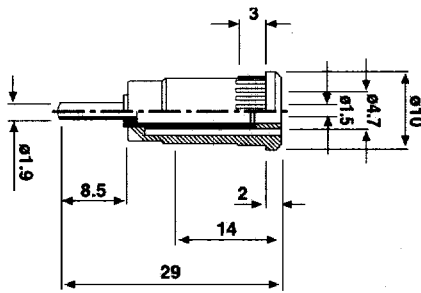

Fully insulated, 1.5 mm press-in male panel receptacles with gold plated round pin for rear connection. This receptacle can be assembled in various ways in predrilled panels of plastic, metal, etc. Polyamide insulator. Plug is brass, gold plated.

- Components and ratings:
- Panel thickness min 1.5 mm
 - Panel drilling 8.3 mm diameter
 - Terminal round pin, 1.9 mm diameter
 - Operating temperature: -40°C to +80°C (-40°F to 176°F)

1:1 Colors: 21 - 23, 29

5.3300 **MLB 1.5-R**

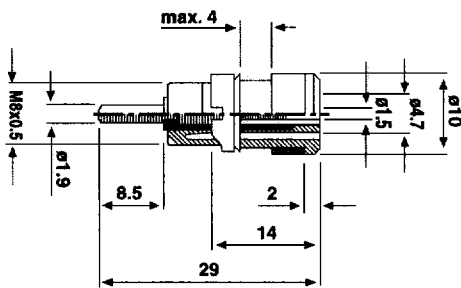

Fully insulated, 1.5 mm mounting male panel receptacle with gold plated round pin for rear connection. This socket can be assembled in various ways in predrilled panels of plastic, metal, etc. Polyamide insulator. Plug is brass, gold plated.

- Components and ratings:
- Panel thickness see sketch
 - Panel drilling see sketch
 - Terminal round pin, 1.9 mm diameter
 - Operating temperature: -40°C to +80°C (-40°F to 176°F)

1:1 Colors: 21 - 23, 29

Press-in
MEB 1.5-R
MLB 1.5-R

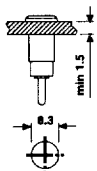

Assembled flush
without spacer
sleeve
MLB 1.5-R

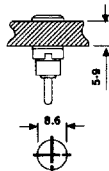

Assembled flush
with spacer
sleeve
MLB 1.5-R

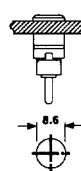

Surface mounted
with spacer
sleeve
MLB 1.5-R

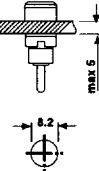

Call us today, or see our website for information about our new 2 mm line of medical connectors!

- 20 - green/yellow 21 - black 22 - red 23 - blue 24 - yellow 25 - green 26 - violet 27 - brown 28 - gray 29 - white 33 - transparent