

**DESCRIPTION/APPLICATION**

Designed to European specifications, these two piece blocks provide interconnection between wire and PC board. Wire is terminated at the connector and the header is mounted to the PC board. The pluggable design expedites field servicing and troubleshooting.

**DESIGN ADVANTAGES**

- Pitches Available:
  - 3,5mm (0.138")
  - 5,0mm (0.197")
  - 5,08mm (0.200")
  - 7,0mm (0.276")
  - 10,0mm (0.394")
  - 10,16mm (0.400")
- Locking fingers provide secure "vibration-proof" connection.
- Mate with either closed-end or open-end shrouded headers.
- Available in two connection styles:
  - Cage clamp for superior connection.
  - Wire protection for economical designs.
- Vertical, horizontal, or universal mounting.
- Optional press-on coding key and polarizing clip system for B52 series. Polarized feature of connector and header allows for varied applications.
- UL94V-0 rated thermoplastic insulator housing.
- Gold and silver plated terminals available in addition to standard tin plating.
- Terminal marking available.
- Shrouded headers provide increased circuit isolation with 4 sided barrier protection.

# TWO PIECE / PLUGGABLE CONNECTORS

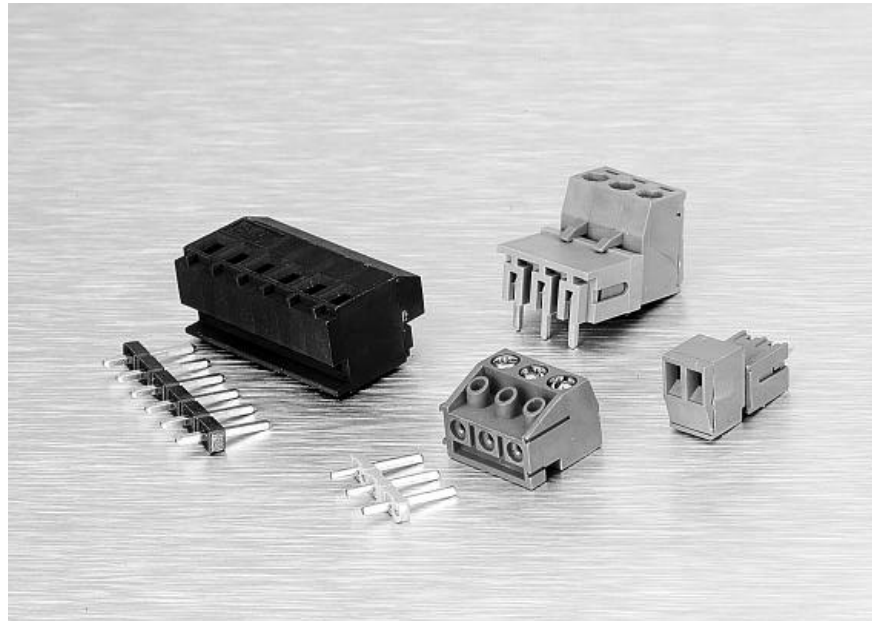

**CONNECTOR INDEX**

3,5mm Connector with Cage Clamp .....	32
3,5mm Header .....	33
5mm Flush Connector with Cage Clamp .....	34
5mm Flush Header .....	35
5mm Locking Connector with Cage Clamp .....	36
5mm Open End Header .....	37
5mm Closed End Header .....	38, 39
5mm Fastening Block, Latch .....	40
5mm Flush Connector and Header Combo .....	41
5mm Flush Connector with Wire Protector .....	42
5mm Flush Header .....	43
5,08mm Flush Connector with Cage Clamp .....	44
5,08mm Flush Header .....	45
5,08mm Locking Connector with Cage Clamp .....	46
5,08mm Header .....	47
3,5mm Polarizing Accessories .....	48

## 5MM PLUG-IN CONNECTOR AND HEADER COMBO WITH WIRE PROTECTORS SERIES 5MDV

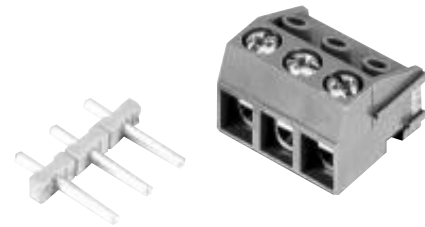

### PHYSICAL PROPERTIES:

#### Housing:

HOUSING MATERIAL: Polyester

FLAMMABILITY: UL94V-0

COLOR: Blue

#### Terminal:

SOLDER PIN: Brass, tin/lead plated

WIRE PROTECTOR: Brass, tin plated

CLAMP: Phosphor Bronze 0.2

SCREW: M2.5 steel, zinc plated

SOLDERABILITY: MIL-STD-202, Method 208

#### Mechanical:

PITCH (TERMINAL SPACING): 5mm

RECOMMENDED PCB HOLE DIA.: .067" Dia.

RECOMMENDED TIGHTENING TORQUE: 5.7 in-lbs

### ELECTRICAL PROPERTIES:

MAXIMUM CURRENT: 10A

OPERATING VOLTAGE: 300V

WIRE RANGE: 14-22 AWG (solid or stranded)

### ENVIRONMENTAL PROPERTIES:

OPERATING TEMPERATURE RANGE: -40°C to +85°C

(-40°F to +185°F)

5MDV Connector  
(Can be ordered separately on the following page)

5mm Pitch

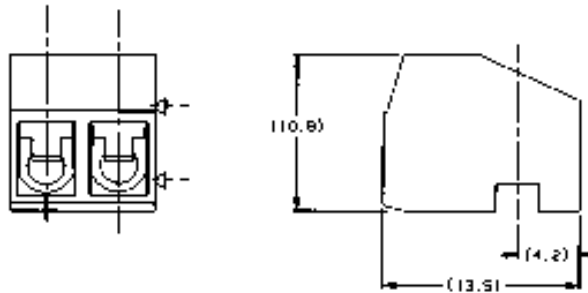
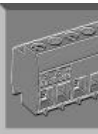
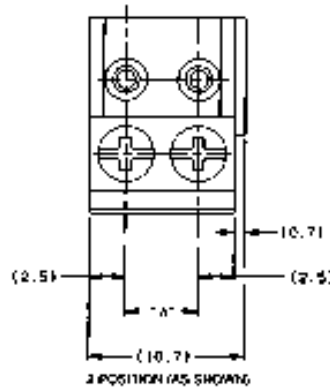

### Ordering Information

# OF TERMINALS	5MM VERTICAL
2	5MDV-02
3	5MDV-03
4	5MDV-04
5	5MDV-05
6	5MDV-06
7	5MDV-07
8	5MDV-08
9	5MDV-09
10	5MDV-10
11	5MDV-11
12	5MDV-12
13	5MDV-13
14	5MDV-14
15	5MDV-15
16	5MDV-16
17	5MDV-17
18	5MDV-18
19	5MDV-19
20	5MDV-20
21	5MDV-21
22	5MDV-22
23	5MDV-23
24	5MDV-24

5MDV Header  
(Can be ordered separately on page 43)

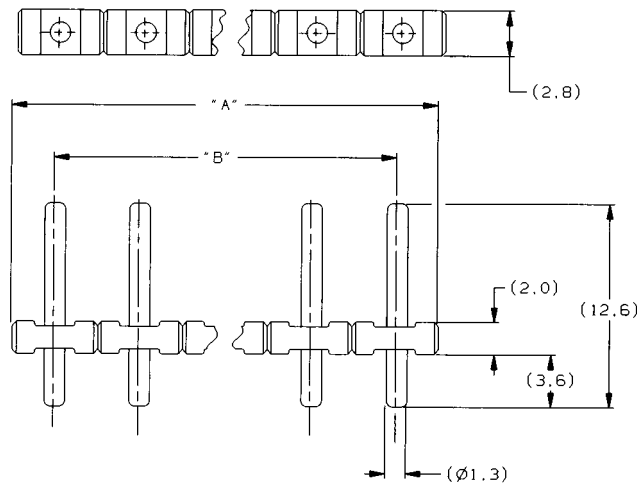

LR30811 E54800

## 5MM PLUG-IN CONNECTOR WITH WIRE PROTECTORS SERIES 5MDV

### PHYSICAL PROPERTIES:

#### Housing:

HOUSING MATERIAL: Polyester

FLAMMABILITY: UL94V-0

COLOR: Blue

#### Terminal:

CAGE CLAMP & SOLDER PIN: Phosphor Bronze 0.2

WIRE CAGE: Brass, tin plated

SCREWS: M2.5 steel, zinc plated

SOLDER PIN: Brass, tin/lead plated

SOLDERABILITY: MIL-STD-202, Method 208

#### Mechanical:

PITCH (TERMINAL SPACING): 5mm

RECOMMENDED PCB HOLE DIA.: .067" Dia.

RECOMMENDED TIGHTENING TORQUE: 5.7 in-lbs

### ELECTRICAL PROPERTIES:

MAXIMUM CURRENT: 10A

OPERATING VOLTAGE: 300V

WIRE RANGE: 14-22 AWG (solid or stranded)

### ENVIRONMENTAL PROPERTIES:

OPERATING TEMPERATURE RANGE: -40°C to +85°C

(-40°F to +185°F)

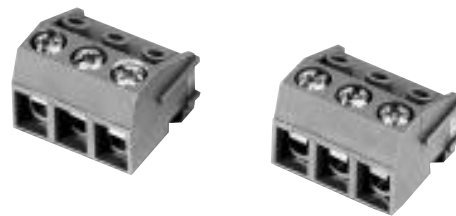

5MDV Connector

5mm Pitch

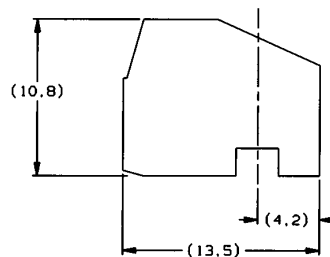
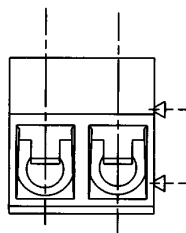
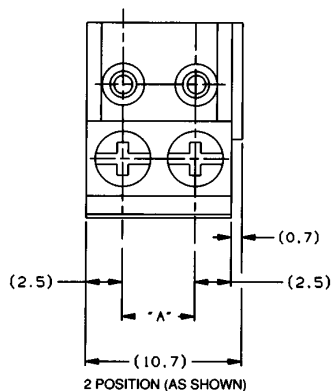

### Ordering Information

# OF TERMINALS	5MM VERTICAL
2	5MDV-02-P
3	5MDV-03-P
4	5MDV-04-P
5	5MDV-05-P
6	5MDV-06-P
7	5MDV-07-P
8	5MDV-08-P
9	5MDV-09-P
10	5MDV-10-P
11	5MDV-11-P
12	5MDV-12-P
13	5MDV-13-P
14	5MDV-14-P
15	5MDV-15-P
16	5MDV-16-P
17	5MDV-17-P
18	5MDV-18-P
19	5MDV-19-P
20	5MDV-20-P
21	5MDV-21-P
22	5MDV-22-P
23	5MDV-23-P
24	5MDV-24-P



LR30811 E54800

## 5MM FLUSH MOUNT HEADERS (FOR SERIES 5MDV...P CONNECTORS) SERIES 5MDV...H

### PHYSICAL PROPERTIES:

#### Housing:

HOUSING MATERIAL: Polyester

FLAMMABILITY: UL94V-0

COLOR: Gray

#### Terminal:

TUBULAR SCREW & SOLDER PIN: Brass, tin/lead plated

SOLDERABILITY: MIL-STD-202, method 208

#### Mechanical:

PITCH (TERMINAL SPACING): 5mm

RECOMMENDED PC HOLE SIZE: .067" Dia.

### ELECTRICAL PROPERTIES:

MAXIMUM CURRENT: 10A

OPERATING VOLTAGE: 300V

### ENVIRONMENTAL PROPERTIES:

OPERATING TEMPERATURE RANGE: -40°C to +85°C  
(-40°F to +185°F)

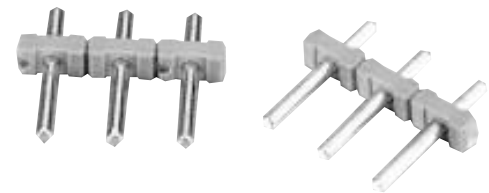

5mm Pitch

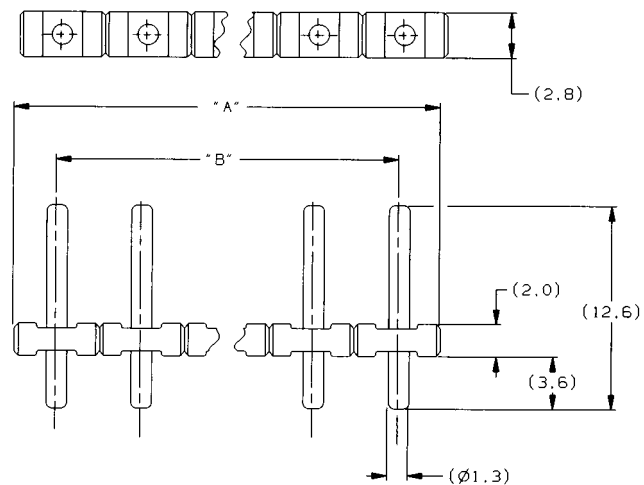
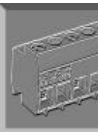

### Ordering Information

# OF TERMINALS	5MM VERTICAL
2	5MDV-02-H
3	5MDV-03-H
4	5MDV-04-H
5	5MDV-05-H
6	5MDV-06-H
7	5MDV-07-H
8	5MDV-08-H
9	5MDV-09-H
10	5MDV-10-H
11	5MDV-11-H
12	5MDV-12-H
13	5MDV-13-H
14	5MDV-14-H
15	5MDV-15-H
16	5MDV-16-H
17	5MDV-17-H
18	5MDV-18-H
19	5MDV-19-H
20	5MDV-20-H
21	5MDV-21-H
22	5MDV-22-H
23	5MDV-23-H
24	5MDV-24-H