

DSM-VT-B-25-P-L-TB

DSM-VT-E-09-S-F-TB-RJ

VERTICAL D-SUB DSM-VT SERIES

SPECIFICATIONS

For complete specifications see www.samtec.com?DSM-VT

Insulator Material:

Black High Temperature Thermoplastic

Pin Material:

Copper Alloy

Socket Material:

Phosphor Bronze

Shell Material:

Steel

Operating Temp Range:

-55°C to +105°C

Plating:

Gold Flash on Contacts, Nickel on Shell and Tin-Lead on Tails

Current Rating:

1 A per contact

Voltage Rating:

40 VAC

Contact Resistance:

20 mΩ max

Minimum Cycles:

1000

9, 15, 25 or 37 Contacts

Pin or Socket

Selectively Plated

Vertical Orientation

Variety of Board and Face Mount Options

Processing:

Suggested PCB Layouts:

For reference only. Please contact Samtec or go to www.samtec.com?DSM-VT for recommended PCB layout.

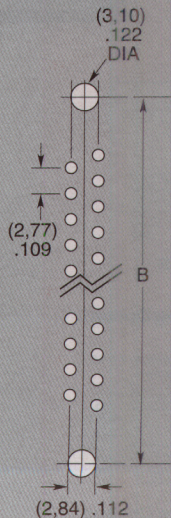

DSM	VT	SHELL SIZE-POSITIONS	GENDER	PLATING	BOARD MOUNT	FACE MOUNT
-----	----	----------------------	--------	---------	-------------	------------

-E-09 = 9 Positions
 -A-15 = 15 Positions
 -B-25 = 25 Positions
 -C-37 = 37 Positions

-P = Pin
 -S = Socket

-F = Gold Flash on Mating Area, Tin-Lead on Tails
 -L = 10µ" (0,25µm) Gold on Mating Area, Tin-Lead on Tails
 -S = 30µ" (0,76µm) Gold on Mating Area, Tin-Lead on Tails

-BL = Board Locks
 -TB = Threaded Bushing

-RJ = Removable #4-40 Jackscrews (Leave blank for no face mount)

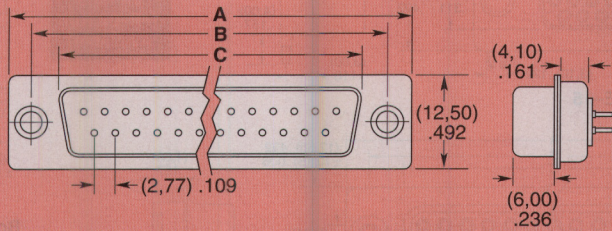
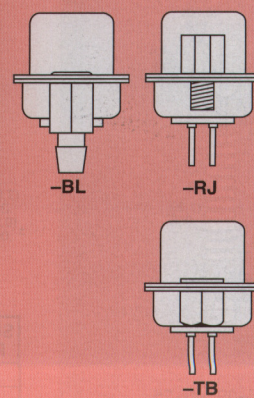

SHELL SIZE-POSITIONS	A	B	C (-P)	C (-S)
	± (0,25) .010	± (0,25) .010	± (0,25) .010	± (0,25) .010
-E-09	(30,81) 1.213	(24,99) .984	(16,92) .666	(16,33) .643
-A-15	(39,14) 1.541	(33,32) 1.312	(25,25) .994	(24,66) .971
-B-25	(53,04) 2.088	(47,04) 1.852	(38,96) 1.534	(38,38) 1.511
-C-37	(69,32) 2.729	(63,50) 2.500	(55,43) 2.182	(54,84) 2.159

Due to technical progress, all designs, specifications and components are subject to change without notice.

WWW.SAMTEC.COM