



**Part Number : CAD06W2272**

**6 Pins Wingblock(Cover) Without Switch Connector, SMT Mounting**

- Cover
- With card guide and card stop
- Total height is 2.7mm

- Material:**  
 Contact: Phosphor Copper  
 Wing: Stainless steel  
 Insulator: Glass filled high temperature Engineering plastics UL94V-0, black
- Finish:**  
 Contact: 0.38 micron Min gold plating at mating area, 1.27-2.54 micron matte tin at solder tail, 1.27-2.54 micron nickel under plated.  
 Wing: 2.0 micron bright tin and 1.27-2.54 micron nickel under plate
- Electrical specifications:**  
 Voltage rating: 250 Vac min  
 Current rating: 2.0 A min  
 Dielectric strength: 1000 Vac for 1 minute min  
 Insulation resistance: 1000 MEG ohm min  
 Contact resistance: 30 milliohm max  
 Operation temperature: -55°C to +125°C
- Mechanical specifications:**  
 Durability: 5,000 cycles  
 Normal force at mated position: 0.5N ± 0.2N
- Packaging:**  
 Parts to be packaged in anti-static tape and reel. All packaging materials to be approved by Amphenol engineering.

SIM Card Connector

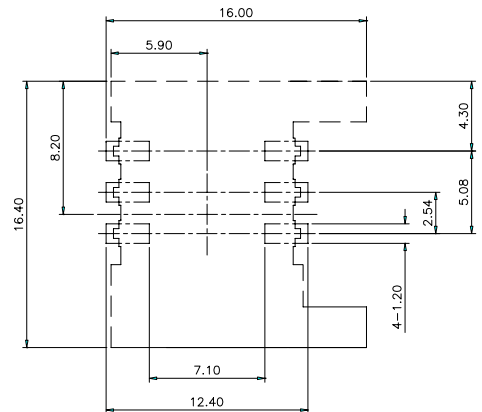
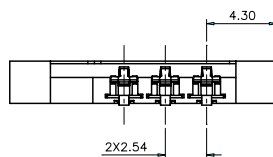
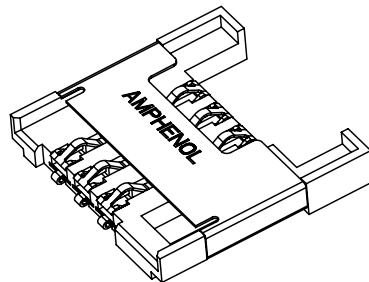
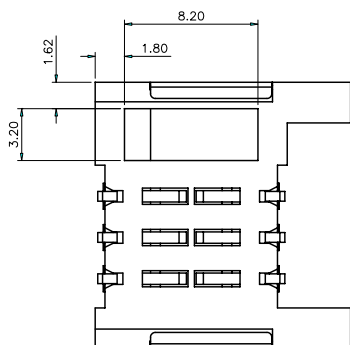
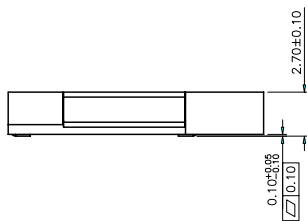
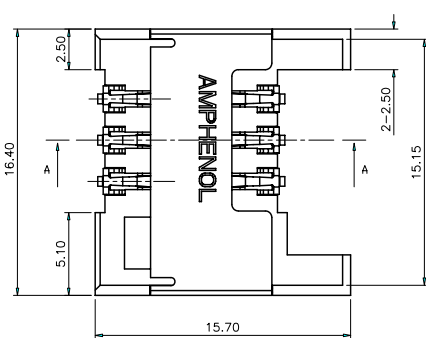

RECOMMENDED PCB LAYOUT

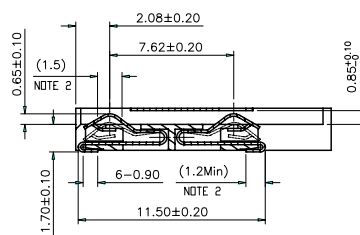

SECTION A-A