

**Size R** Reversed style, acc. to DIN 41 612/IEC 60603-2

**Size R/2** Reversed style, short version of size R

**Size R/3** Reversed style, third-length of size R

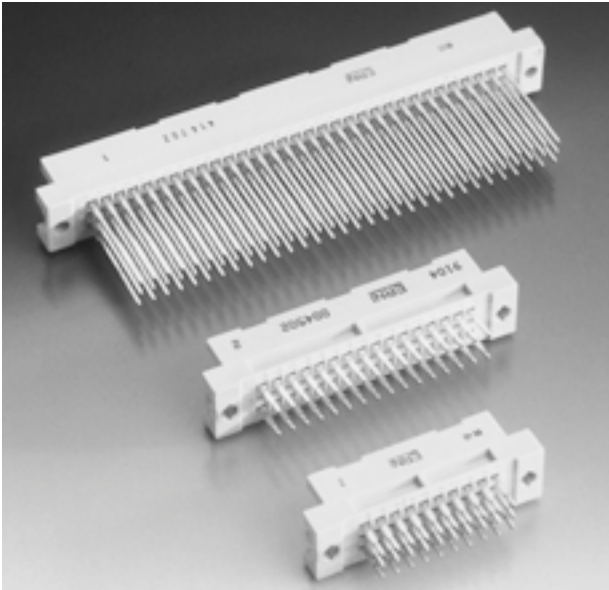

**Dimensional drawings**

Male connector

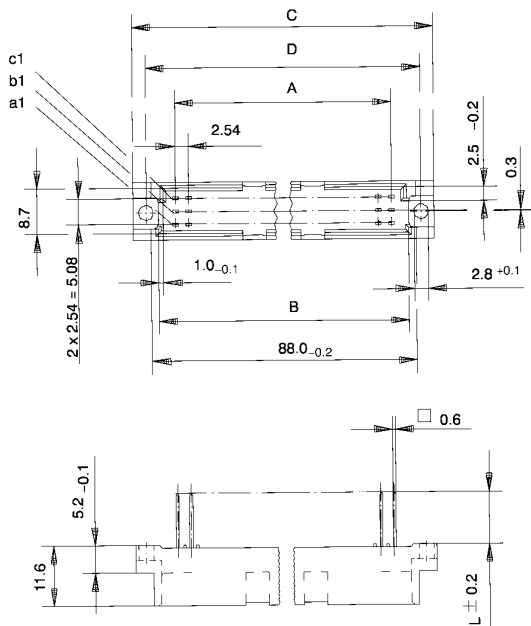

	<b>R</b>	<b>R/2</b>	<b>R/3</b>
A	31 x 2.54 = 78.74	15 x 2.54 = 38.1	9 x 2.54 = 22.86
B	85.2 <sup>+0.2</sup>	44.6 <sup>+0.2</sup>	29.3 <sup>+0.2</sup>
C	95.0 max.	55.0 max.	39.76 max.
D	90.0 <sup>±0.1</sup>	50.0 <sup>±0.1</sup>	34.76 <sup>±0.1</sup>



## Ordering informations

### Male connectors

Contact supporting press-in tool

	Size R	Size R/2	Size R/3
	<p>STV-R 96-M-abc-EE</p> <p>107      207      307</p> <p><b>414690    414691</b></p>	<p>STV-R/2 48-M-abc-EE</p> <p>107      207      307</p> <p><b>004993</b></p>	<p>STV-R/3 30-M-abc-EE</p> <p>107      207      307</p> <p><b>023419</b></p>
	<p>STV-R 64-M-ac-EE</p> <p>107      207      307</p> <p><b>414687    414688</b></p>	<p>STV-R/2 32-M-ac-EE</p> <p>107      207      307</p> <p><b>023422</b></p>	<p>STV-R/3 20-M-ac-EE</p> <p>107      207      307</p> <p><b>023423</b></p>
	<p>STV-R 96-M-abc-EE</p> <p>107      207      307</p> <p><b>593413    593414</b></p>	<p>STV-R/2 48-M-abc-EE</p> <p>107      207      307</p> <p><b>004480</b></p>	<p>STV-R/3 30-M-abc-EE</p> <p>107      207      307</p> <p><b>433780</b></p>
	<p>STV-R 64-M-ac-EE</p> <p>107      207      307</p> <p><b>593410    593411</b></p>	<p>STV-R/2 32-M-ac-EE</p> <p>107      207      307</p> <p><b>004502</b></p>	<p>STV-R/3 20-M-ac-EE</p> <p>107      207      307</p> <p><b>023424</b></p>

Other versions on request.

0,8 mm early make/last break contacts  
are possible at all positions.

## Ordering informations

Male connectors with transfer-zone

Contact supporting press-in tool

	Size R	Size R/2	Size R/3
<p>PBT</p>	<p>STV-R 96-M-abc-EEUE 1)</p> <p>32 1</p> <p>101 201 301</p> <p><b>414702 414703</b></p>	<p>STV-R/2 48-M-abc-EEUE 1)</p> <p>16 1</p> <p>101 201 301</p> <p><b>023425</b></p>	<p>STV-R/3 30-M-abc-EEUE 1)</p> <p>10 1</p> <p>101 201 301</p> <p><b>023426</b></p>
<p>PBT</p>	<p>STV-R 64-M-ac-EEUE 1)</p> <p>32 1</p> <p>101 201 301</p> <p><b>414699 414700</b></p>	<p>STV-R/2 32-M-ac-EEUE 1)</p> <p>16 1</p> <p>101 201 301</p> <p><b>023427</b></p>	<p>STV-R/3 20-M-ac-EEUE 1)</p> <p>10 1</p> <p>101 201 301</p> <p><b>023428</b></p>

1) Terminals nickel-plated over full length.  
Transfer-zone (5.0 mm) hard gold-plated.

Other versions on request.

0,8 mm early make/last break contacts  
are possible at all positions.

## Application example

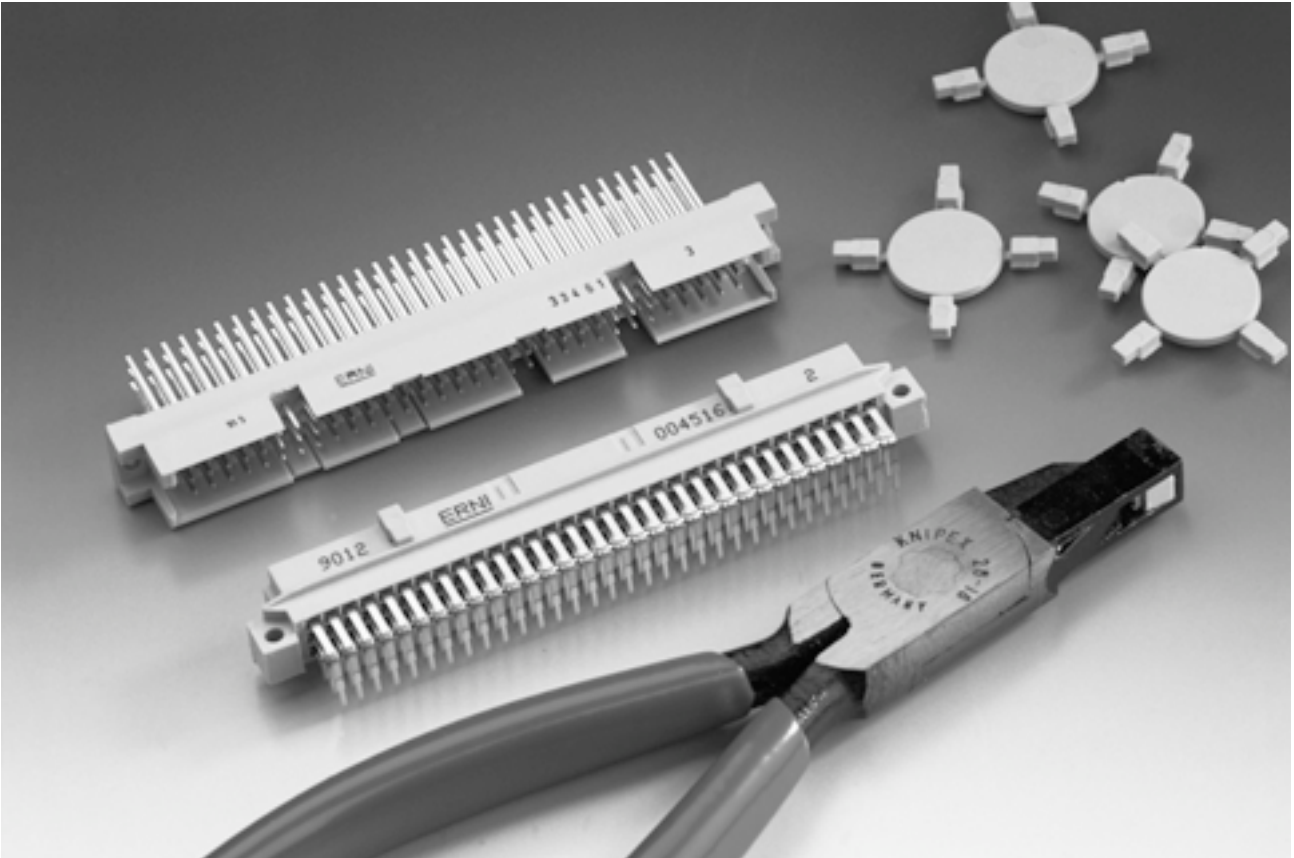

In order to avoid any incorrect connections being made which could lead to the damage of sensitive electronic equipment due to overload, provisions are available for coding the connector halves.

Connector sizes B/2, B/3, C/2, C/3, M and the inverse versions are provided with this integral coding.

The integral coding is accomplished by breaking off (with pliers) the coding tab positions on the male connector. Coding slots are made on the corresponding locations as well on the female connector.

For information on coding systems, please contact the local ERNI sales office.