

Ordering number CA13509_STRADA-SQ-T2

Family	Strada-SQ	FWHM	Asymmetric degrees
Type	Assembly	Efficiency	93 %
LED	LUXEON M	cd/Im	0.600
Color	Black	Gerber File	Available
Diameter	25 x 25 mm		
Height	8.7 mm		
Style	Square		
Optic Material	PMMA		
Holder Material	-		
Fastening	-		
Status	Ready		

We recommend a minimum center to center spacing between S



Ordering number CA13688_STRADA-SQ-T3

Family	Strada-SQ	FWHM	Asymmetric degrees
Type	Assembly	Efficiency	92 %
LED	LUXEON M	cd/Im	0.500
Color	Clear	Gerber File	Available
Diameter	25 x 25 mm		
Height	8.4 mm		
Style	Square		
Optic Material	PMMA		
Holder Material	-		
Fastening	-		
Status	Ready		

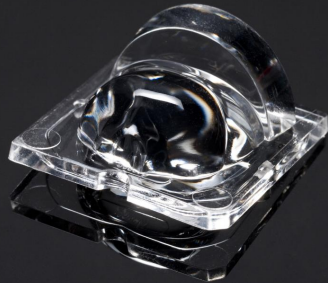
We recommend a minimum center to center spacing between S

Ordering number CA13758_STRADA-SQ-FS-NP

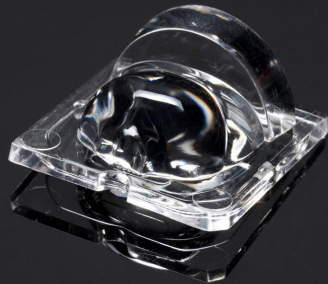
Family	Strada-SQ	FWHM	Asym degrees
Type	Assembly	Efficiency	92 %
LED	LUXEON M	cd/Im	0.900
Color	Clear	Gerber File	Available
Diameter	25x25 mm		
Height	12.6 mm		
Style	Square		
Optic Material	PMMA		
Holder Material	-		
Fastening	-		
Status	Ready		

Ordering number CA13897_STRADA-SQ-FS

Family	Strada-SQ	FWHM	Asymmetric degrees
Type	Lens	Efficiency	92 %
LED	LUXEON M	cd/Im	0.900
Color	Clear	Gerber File	Available
Diameter	25x25 mm		
Height	12.6 mm		
Style	Square		
Optic Material	PMMA		
Holder Material	-		
Fastening	-		
Status	Ready		

Ordering number C13866_STRADA-SQ-CY

Family	Strada-SQ	FWHM	120+115 degrees
Type	Lens	Efficiency	94 %
LED	LUXEON M	cd/Im	0.410
Color	Clear	Gerber File	Available
Diameter	25x25 mm		
Height	10.1 mm		
Style	Square		
Optic Material	PMMA		
Holder Material	-		
Fastening	-		
Status	Ready		

Ordering number CA14219_STRADA-SQ-CY

Family	Strada-SQ	FWHM	120+115 degrees
Type	Assembly	Efficiency	94 %
LED	LUXEON M	cd/Im	0.410
Color	Clear	Gerber File	Available
Diameter	25x25 mm		
Height	10.1 mm		
Style	Square		
Optic Material	PMMA		
Holder Material	-		
Fastening	-		
Status	Ready		

Ordering number C12727_STRADA-SQ-VSM

Family	Strada-SQ	FWHM	154 degrees
Type	Lens	Efficiency	93 %
LED	LUXEON M	cd/Im	0.250
Color	Clear	Gerber File	Available
Diameter	25 x 25 mm		
Height	6.8 mm		
Style	Square		
Optic Material	PMMA		
Holder Material	-		
Fastening	Screw, pin, glue		
Status	Ready		

Ordering number CA12891_STRADA-SQ-VSM

Family	Strada-SQ	FWHM	154 degrees
Type	Assembly	Efficiency	93 %
LED	LUXEON M	cd/Im	0.250
Color	Clear	Gerber File	Available
Diameter	25 x 25 mm		
Height	6.95 mm		
Style	Square		
Optic Material	PMMA		
Holder Material	-		
Fastening	Screw, pin, tape		
Status	Ready		



PRODUCT DATASHEET
Strada-SQ series
last update 15/11/2013

PHILIPS
LUMILEDS

NOTE: The typical divergence will be changed by different color, chip size and chip position tolerance. The typical total divergence is the full angle measured where the luminous intensity is half of the peak value.



PRODUCT DATASHEET

Strada-SQ series

last update 15/11/2013

PHILIPS
LUMILEDS

GENERAL INFORMATION

- Product series especially designed & optimized for LUXEON M series of LEDs.
- Special care taken to make light distribution as uniform as possible.
- Lens material optical grade PMMA with high UV and temperature resistance (105 degrees of Celcius / 220 degrees of Fahrenheit). Allows use of high current and temperature conditions.

Please find more information about used material from below:

http://ledil.fi/sites/default/files/Documents/Technical/Material/PMMA%20N%20UL94_Yellow%20Card.pdf

<http://ledil.fi/sites/default/files/Documents/Technical/Material/PMMA%20N%20PLEXIGLAS-Datasheet.pdf>

- Fastening to heat sink with a PU foam adhesive tape of automotive grade. Please find fastening details by clicking link: http://www.ledil.com/datasheets/DataSheet_TAPE.pdf

- Fastening to PCB with appropriate adhesive. By clicking link below you can find Ledil recommended glue options.

http://www.ledil.com/datasheets/DataSheet_GLUES.pdf

NOTE 1: We advise customer to ensure the suitability and sufficiency of the bond in the end product. For example, mechanical stress, vibration and holes on the surface of the circuit board weaken the strength of the tape.

NOTE 2: Assembly to the surface must be made straight, so the tape bonds constant and balanced with fastening surface. Slanted assembly might cause unbalanced bond to the surface. All surfaces where tape is applied must be clean, dry and free from grease and dirt.

If cleaning of PCB surfaces is needed, please follow strictly the cleaning instructions of your LED manufacturer - this is important as cleaning shall under no circumstances damage LEDs or other electronics components on the PCB.

Further note that optical components shall not be cleaned with any chemicals - only micro fiber cloth may be used to remove fingerprints or other traces from handling.

NOTE 1: We advise customer to ensure the suitability and sufficiency of the bond in the end product. For example, mechanical stress, vibration and holes on the surface of the circuit board weaken the strength of the glue.

NOTE 2: All surfaces where glue is applied must be clean, dry and free from grease and dirt. If cleaning of PCB surfaces is needed, please follow strictly the cleaning instructions of your LED manufacturer -this is important as cleaning shall under no circumstances damage LEDs or other electronics components on the PCB.

Further note that optical components shall not be cleaned with any chemicals - only micro fiber cloth may be used to remove fingerprints or other traces from handling.

D C B A

4

4

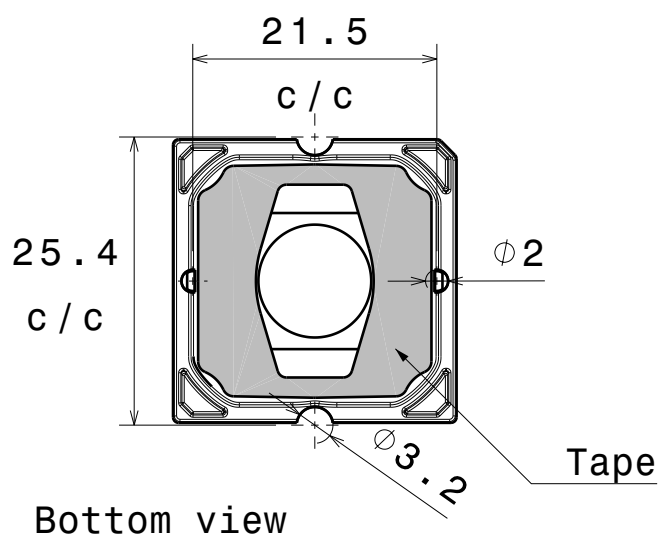

Bottom view

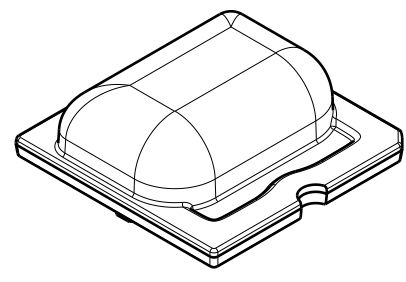

Isometric view

3

3

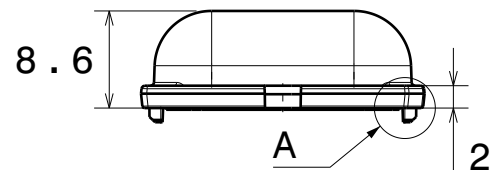

Front view

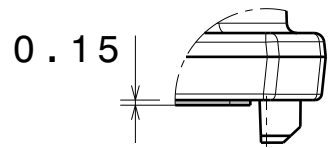

Detail A

2

2

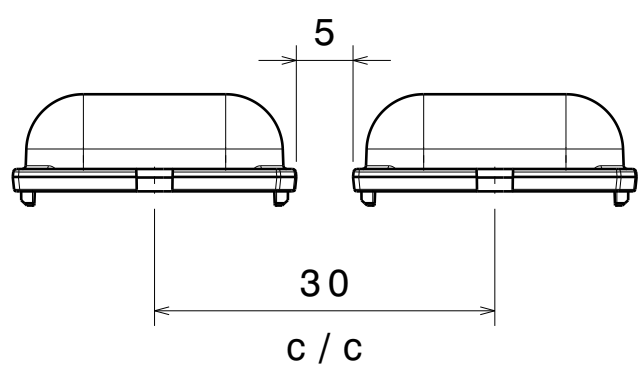

Minimum spacing

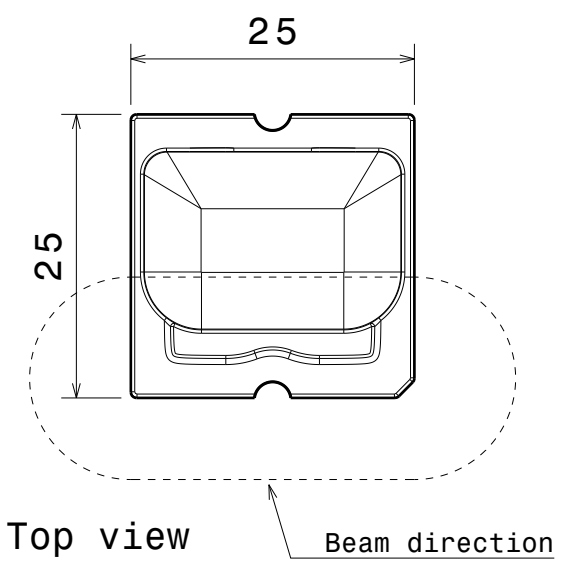

Top view

Tolerances if not otherwise shown
According to DIN ISO 2768-1
Linear measures:
Up to 30mm class F, otherwise class M.
According to DIN ISO 2768-2
Form and position: class K

LEDiL	LediL Oy Salorankatu 10 FIN 24240 SALO Finland		
	DRAWING TITLE		

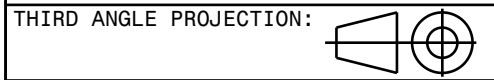

STRADA-SQ-T2 Datasheet

This drawing is the property of LEDiL Oy. It may not be reproduced, copied or communicated without a written agreement with LEDiL Oy."

SIZE	PART NUMBER		
A4		-	

SCALE	3:2	WEIGHT	-	SHEET	1/1
-------	-----	--------	---	-------	-----

1

1

D A

LEDiL Oy CA13509_STRADA-SQ-T2_(LUXEON_M) Eff.93.1% / LDC (Linear)

Luminaire: LEDiL Oy CA13509_STRADA-SQ-T2_(LUXEON_M) Eff.93.1%
Lamps: 1 x LUXEON_M_350.373lm@250mA_CCT=4092K_P=2.73116W_I=249.9mA

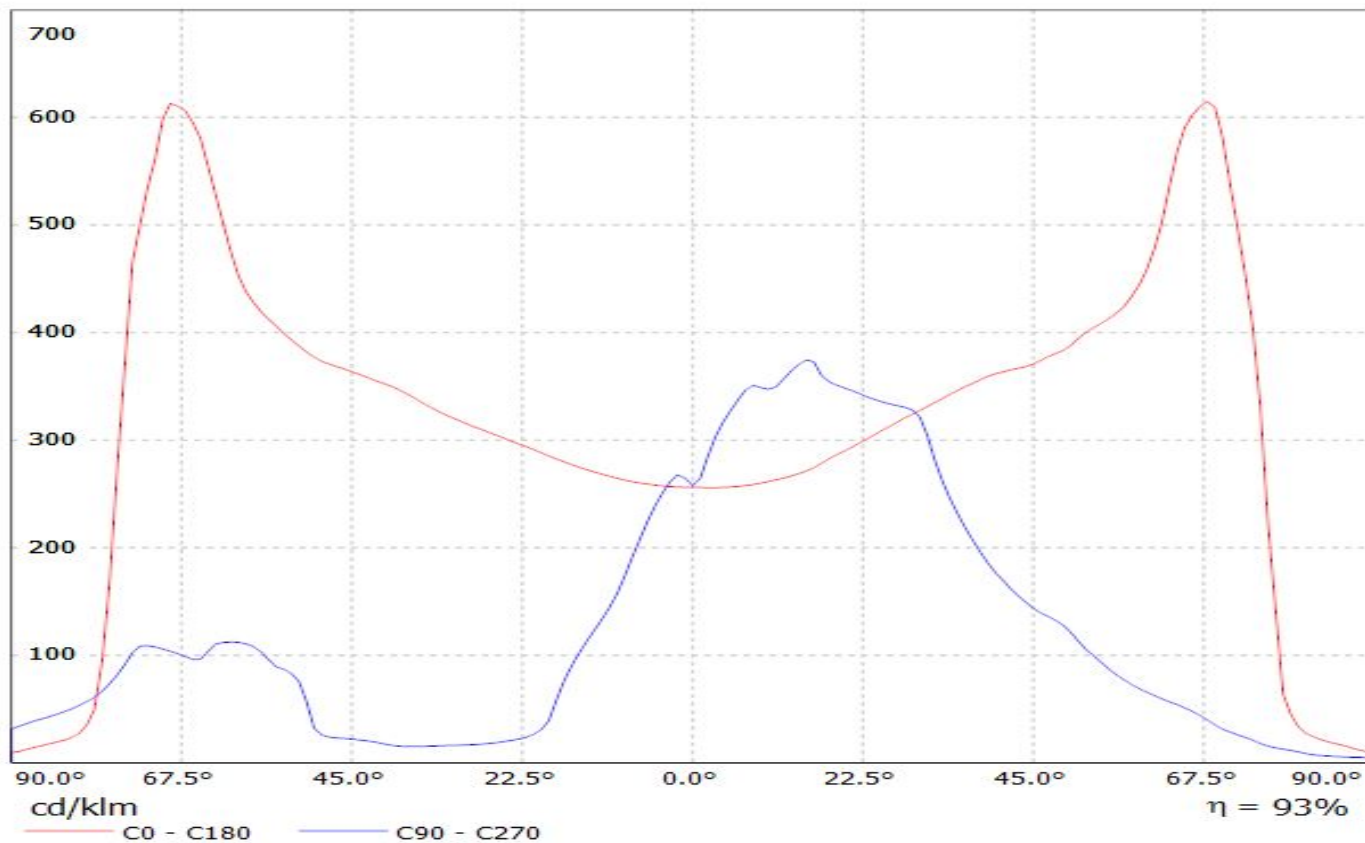

LEDiL Oy CA13688_STRADA-SQ-T3_(LUXEON_M) Eff.91.7% / LDC (Linear)

Luminaire: LEDiL Oy CA13688_STRADA-SQ-T3_(LUXEON_M) Eff.91.7%
Lamps: 1 x LUXEON_M_350.373lm@250mA_CCT=4092K_P=2.73116W_I=249.9mA

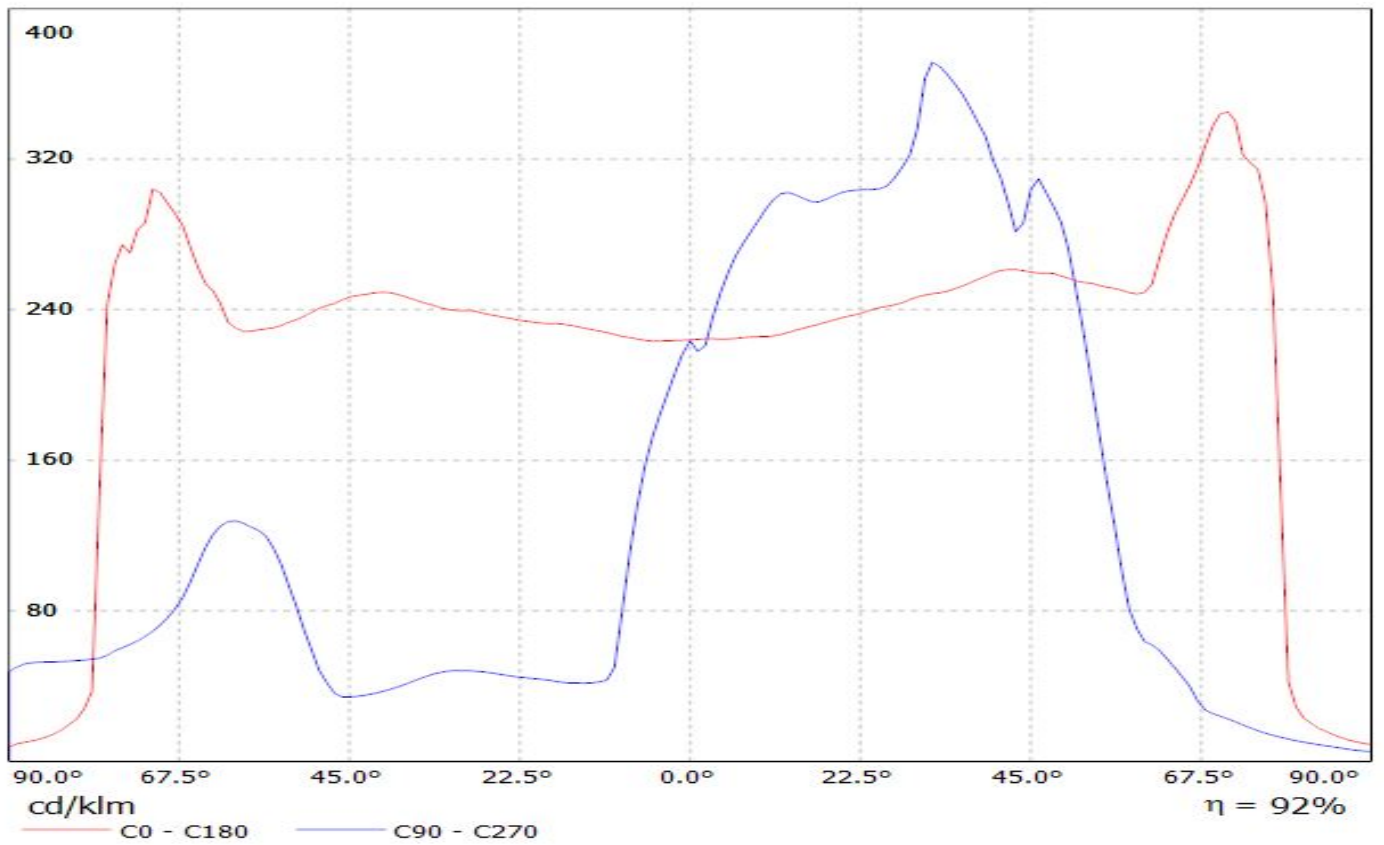

Luminaire: LEDiL Oy CA13758_STRADA-SQ-FS-NP_(LUXEON_M) Eff.92.4%
Lamps: 1 x LUXEON_M_349.54lm@250mA_CCT=4092K_P=2.72807W_I=249.8mA

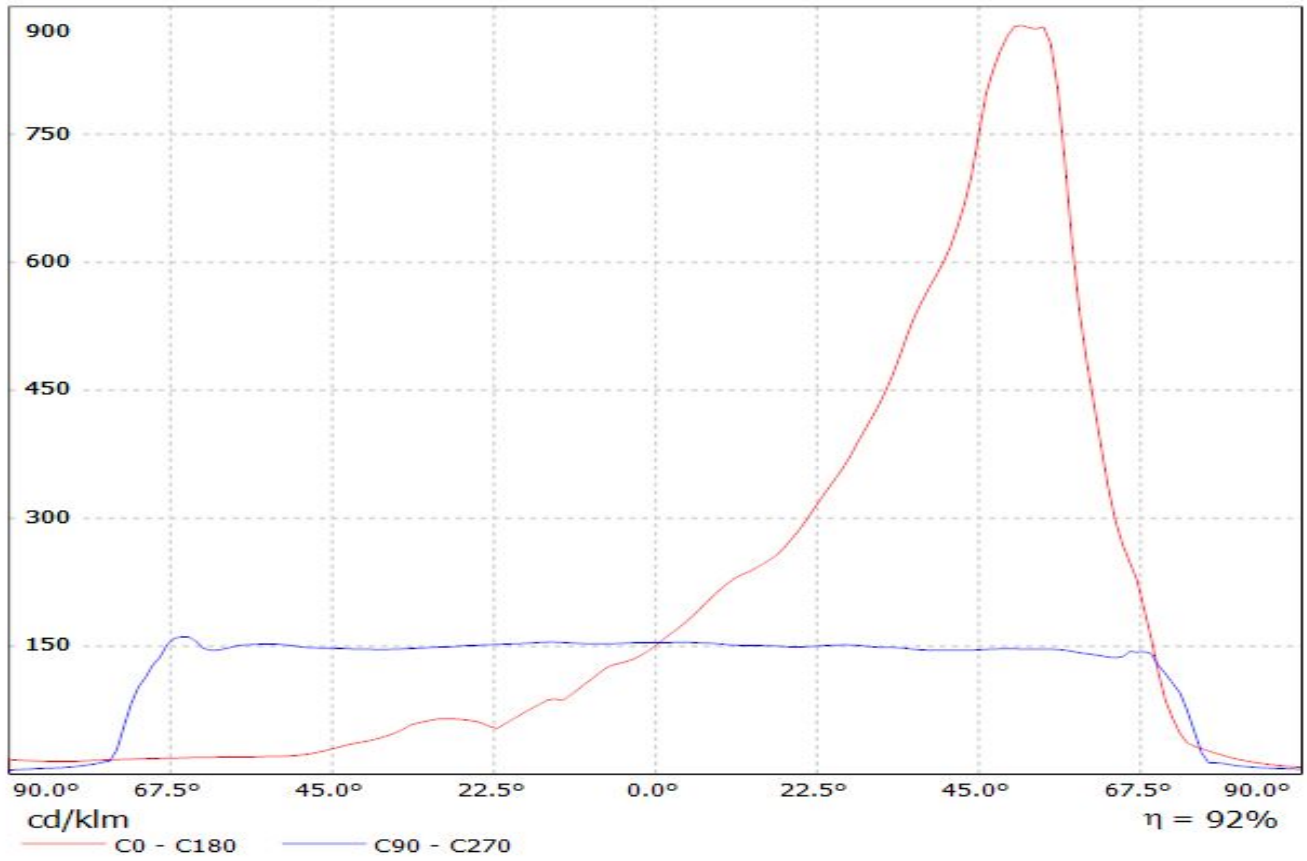

Luminaire: LEDiL Oy CA13897_STRADA-SQ-FS_(LUXEON_M) Eff.92.4%
Lamps: 1 x LUXEON_M_349.54lm@250mA_CCT=4092K_P=2.72807W_I=249.8mA

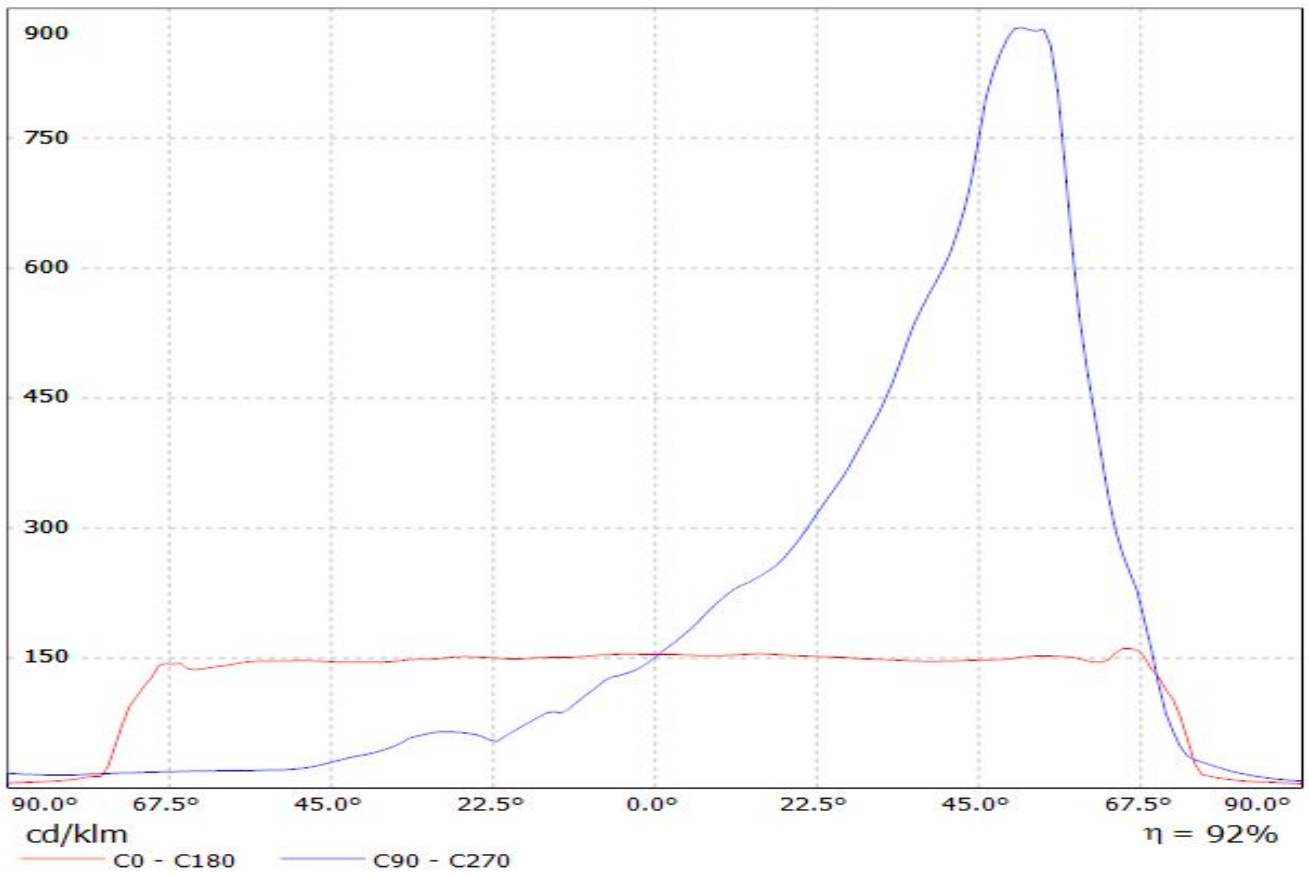

LEDiL Oy C13866_STRADA-SQ-CY_(LUXEON_M) Eff.94.0% / LDC (Linear)

Luminaire: LEDiL Oy C13866_STRADA-SQ-CY_(LUXEON_M) Eff.94.0%
Lamps: 1 x LUXEON_M_359.1lm@250mA_CCT=4092K_P=2.73016W_I=249.9mA

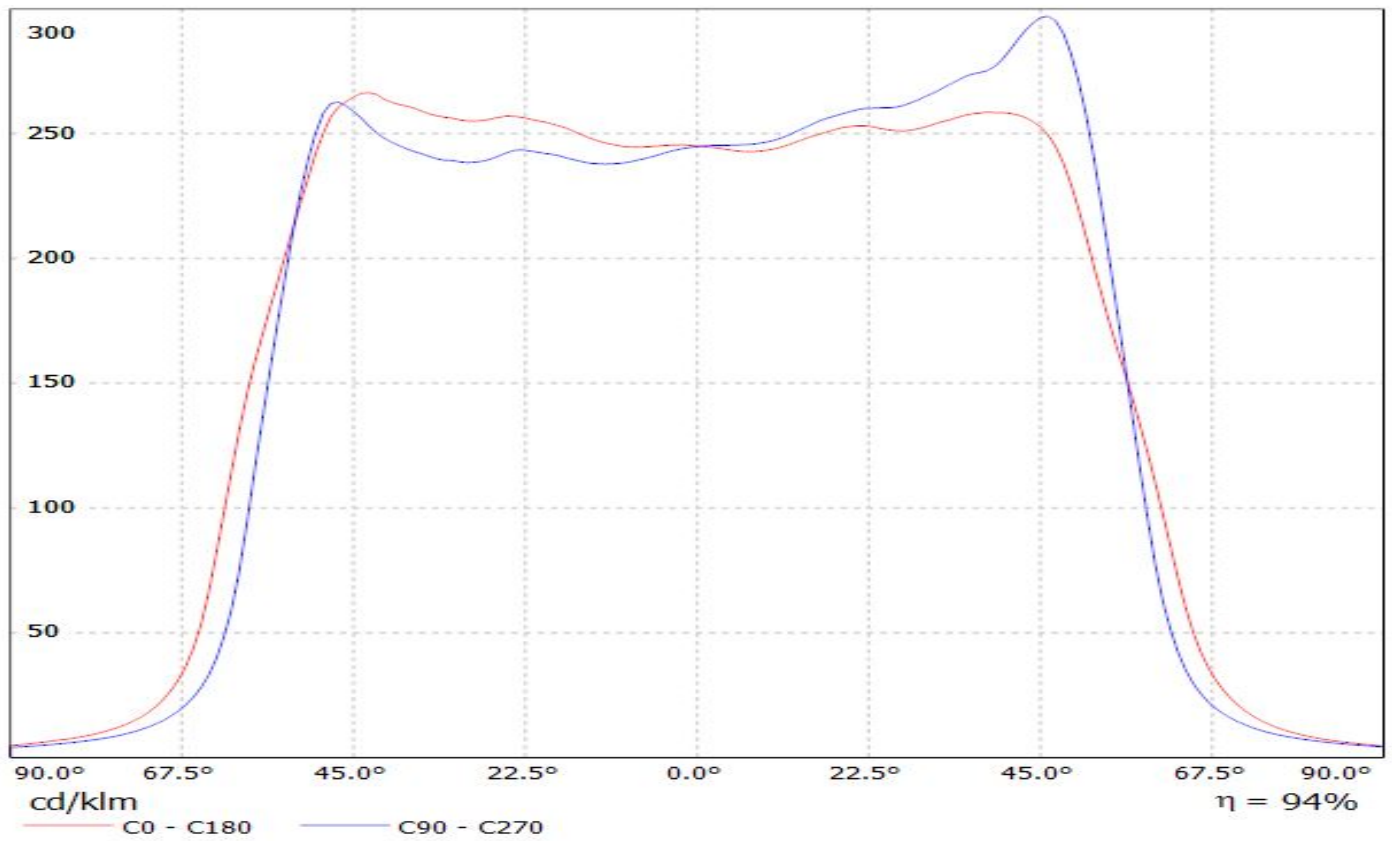

Luminaire: LEDIL OY C12727_STRADA-SQ-VSM (Luxeon M) Efficiency=95%
Lamps: 1 x Luxeon M (360lm@250mA)

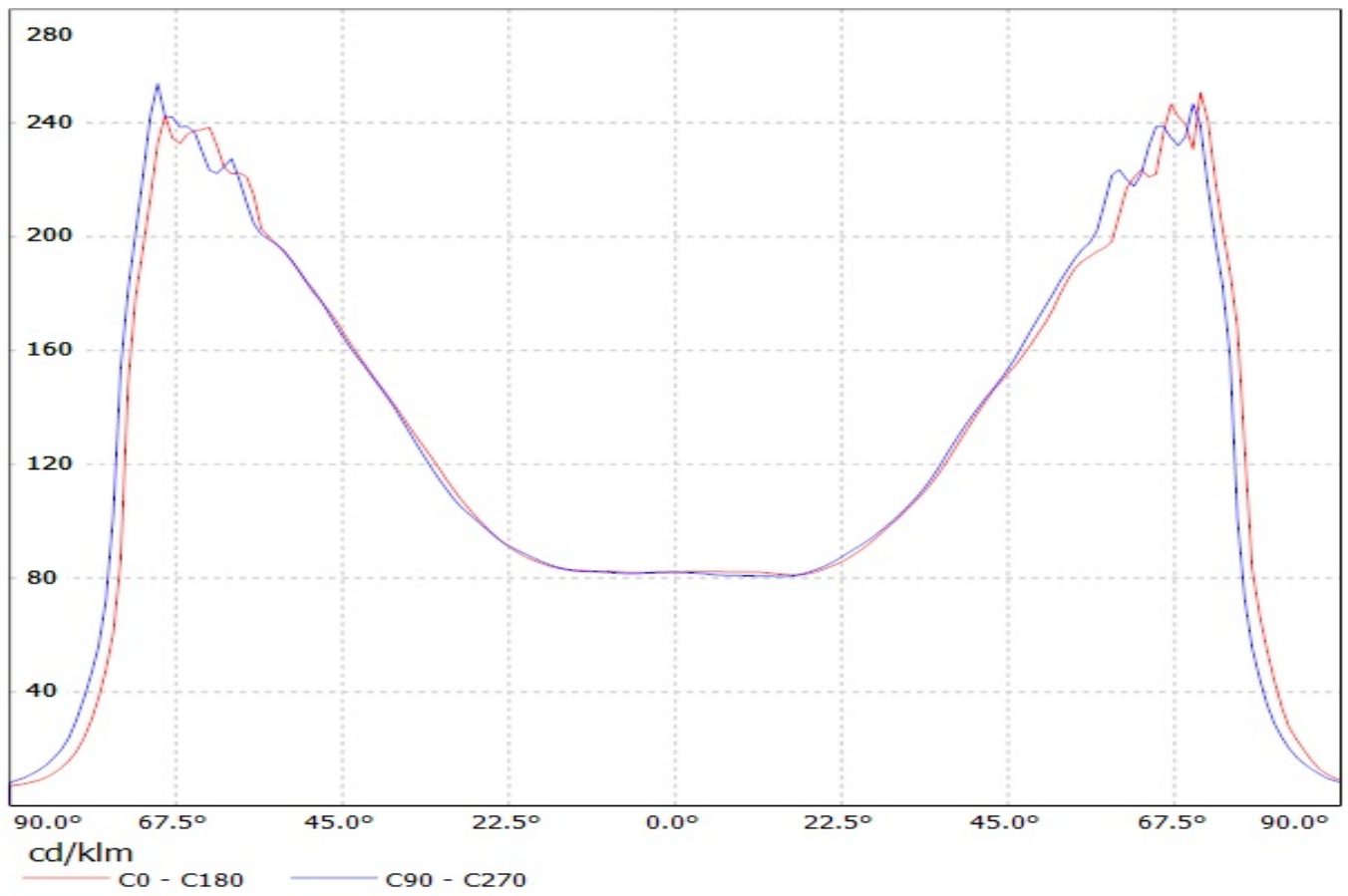

Luminaire: LEDIL OY C12727_STRADA-SQ-VSM (Luxeon M) Efficiency=95%
Lamps: 1 x Luxeon M (360lm@250mA)

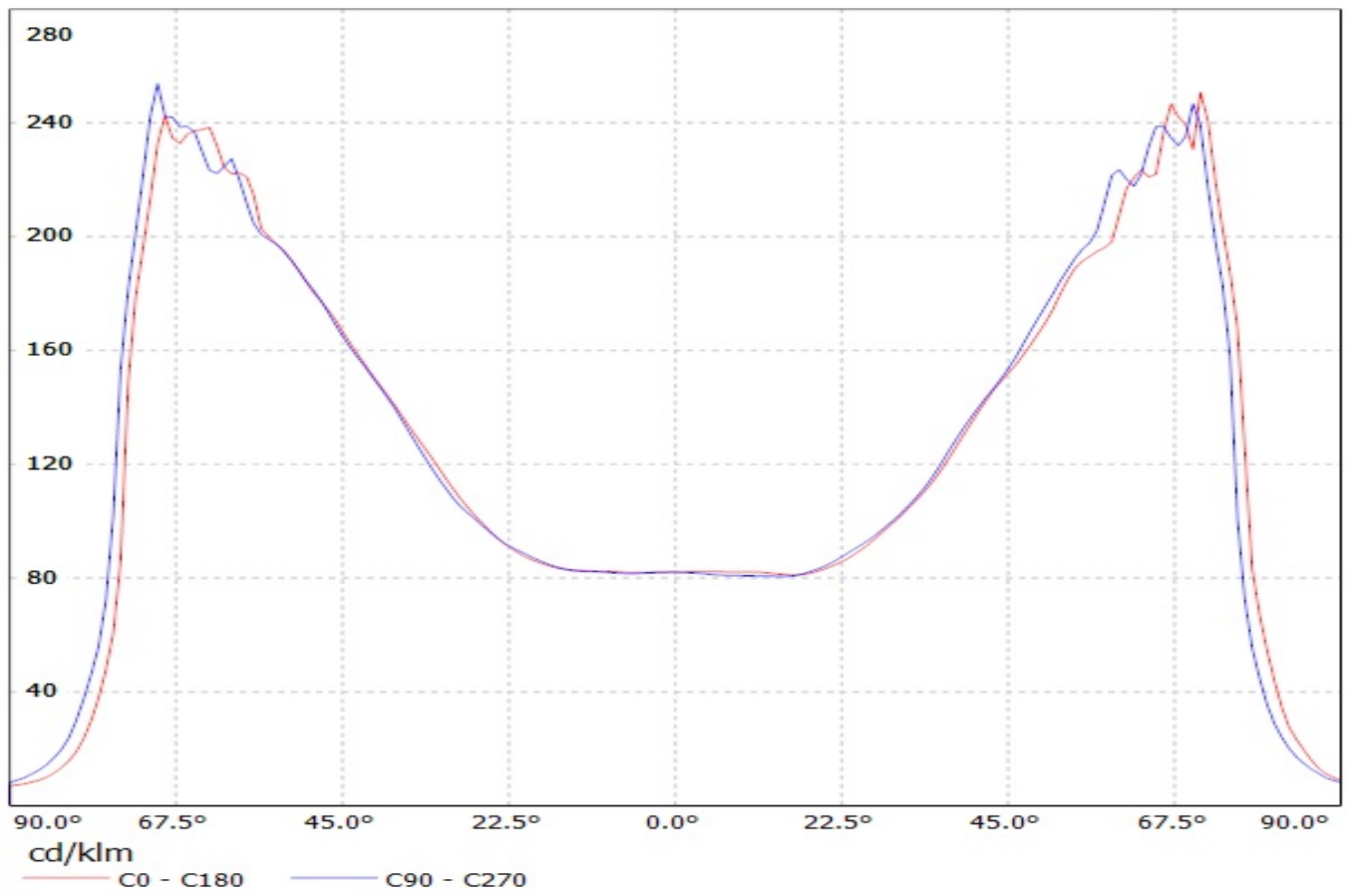

LEDiL Oy CA13509_STRADA-SQ-T2_(LUXEON_M) Eff.93.1% / LDC (Polar)

Luminaire: LEDiL Oy CA13509_STRADA-SQ-T2_(LUXEON_M) Eff.93.1%

Lamps: 1 x LUXEON_M_350.373lm@250mA_CCT=4092K_P=2.73116W_I=249.9mA

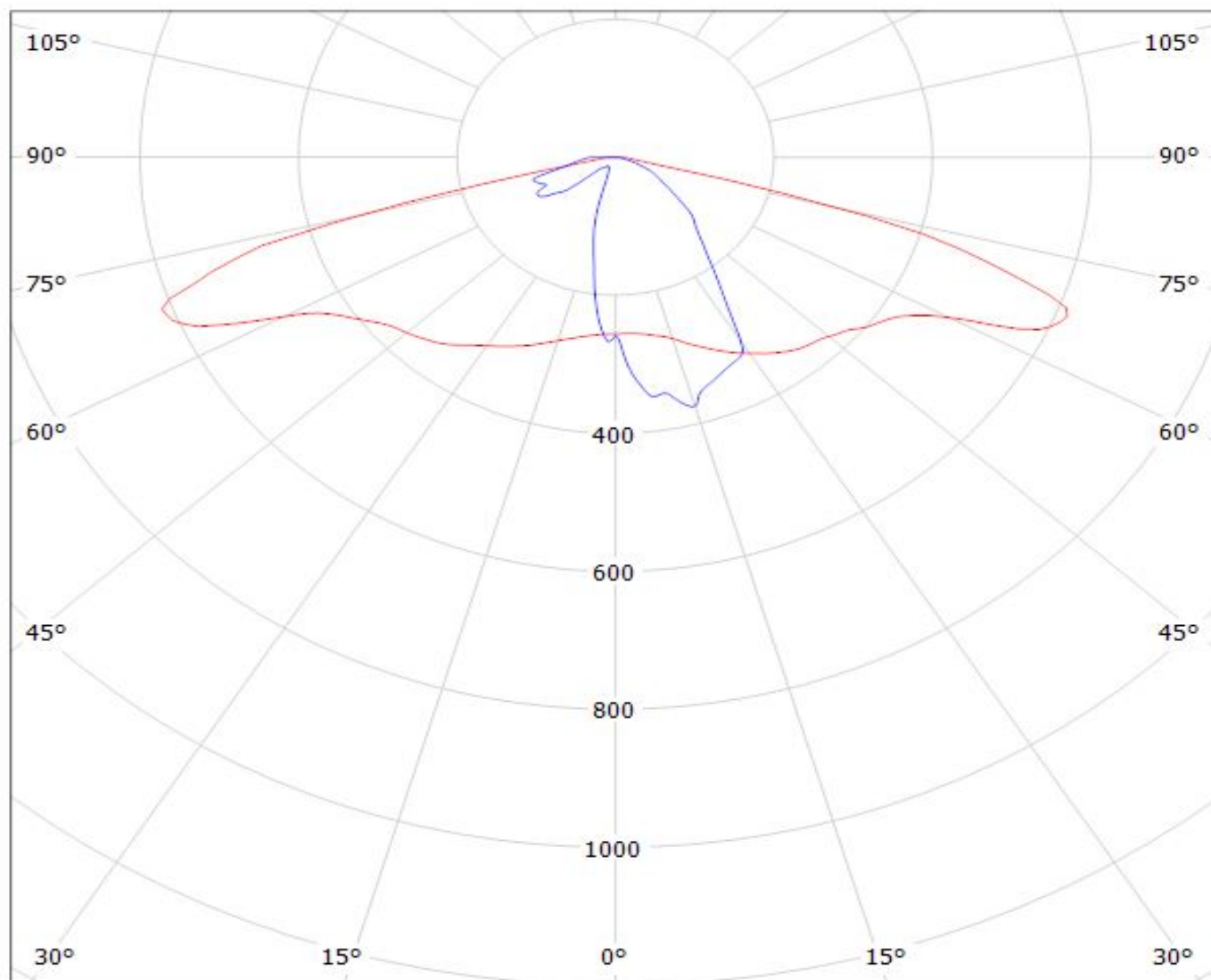

— C0 - C180 — C90 - C270

LEDiL Oy CA13688_STRADA-SQ-T3_(LUXEON_M) Eff.91.7% / LDC (Polar)

Luminaire: LEDiL Oy CA13688_STRADA-SQ-T3_(LUXEON_M) Eff.91.7%

Lamps: 1 x LUXEON_M_350.373lm@250mA_CCT=4092K_P=2.73116W_I=249.9mA

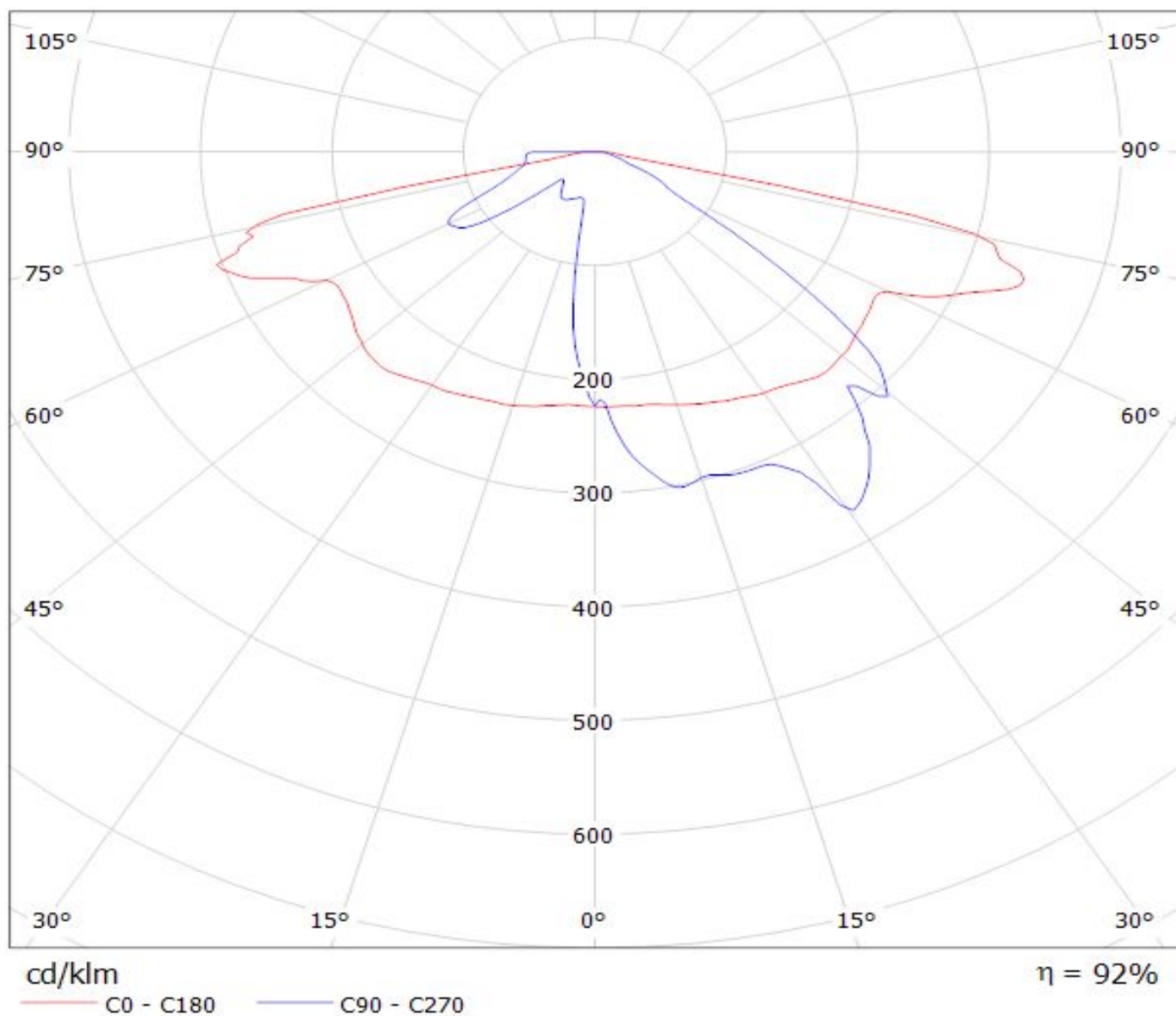

Luminaire: LEDiL Oy CA13758_STRADA-SQ-FS-NP_(LUXEON_M) Eff.92.4%
Lamps: 1 x LUXEON_M_349.54lm@250mA_CCT=4092K_P=2.72807W_I=249.8mA

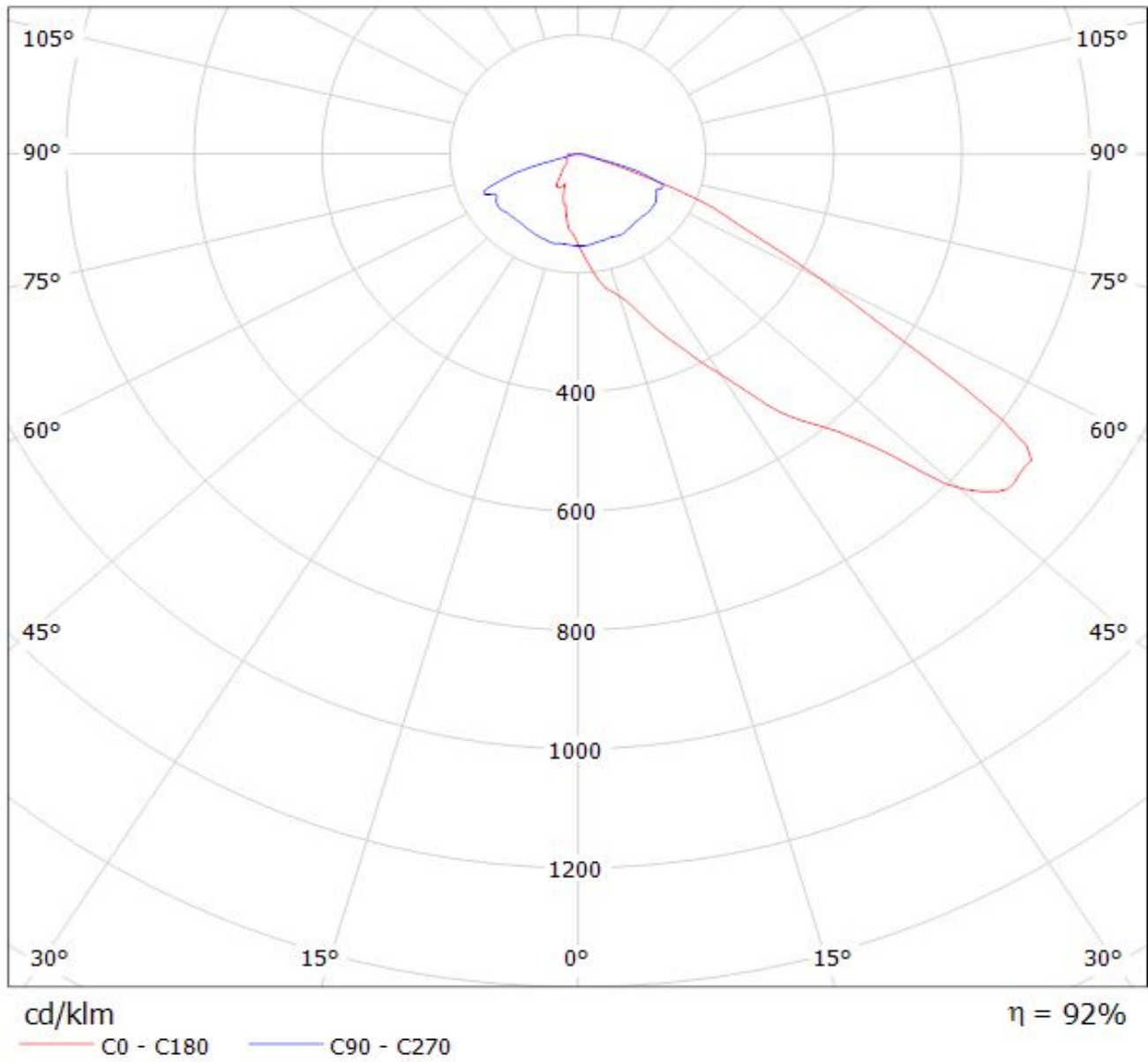

Luminaire: LEDiL Oy CA13897_STRADA-SQ-FS_(LUXEON_M) Eff.92.4%
Lamps: 1 x LUXEON_M_349.54lm@250mA_CCT=4092K_P=2.72807W_I=249.8mA

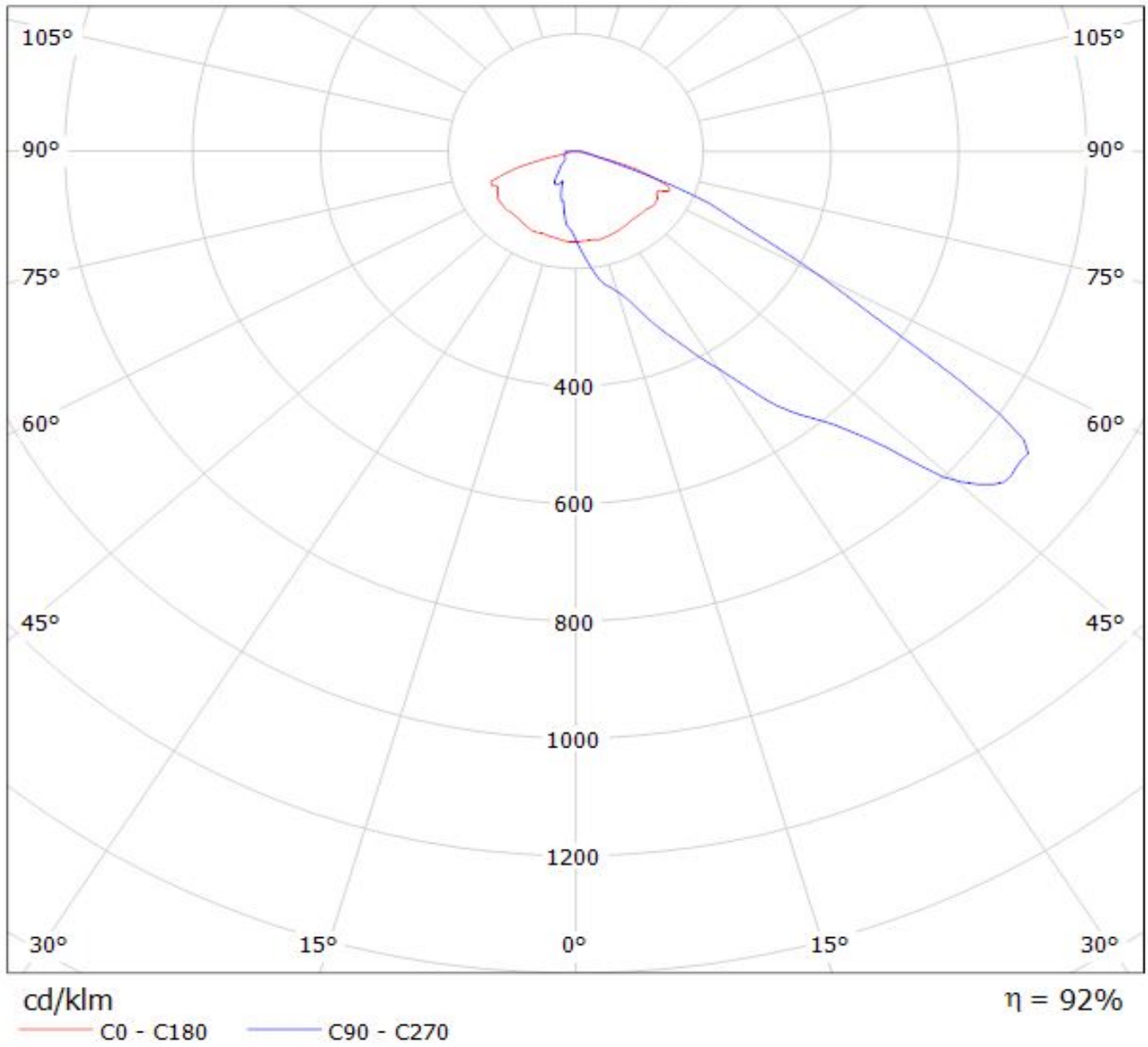

LEDiL Oy C13866_STRADA-SQ-CY_(LUXEON_M) Eff.94.0% / LDC (Polar)

Luminaire: LEDiL Oy C13866_STRADA-SQ-CY_(LUXEON_M) Eff.94.0%

Lamps: 1 x LUXEON_M_359.1lm@250mA_CCT=4092K_P=2.73016W_I=249.9mA

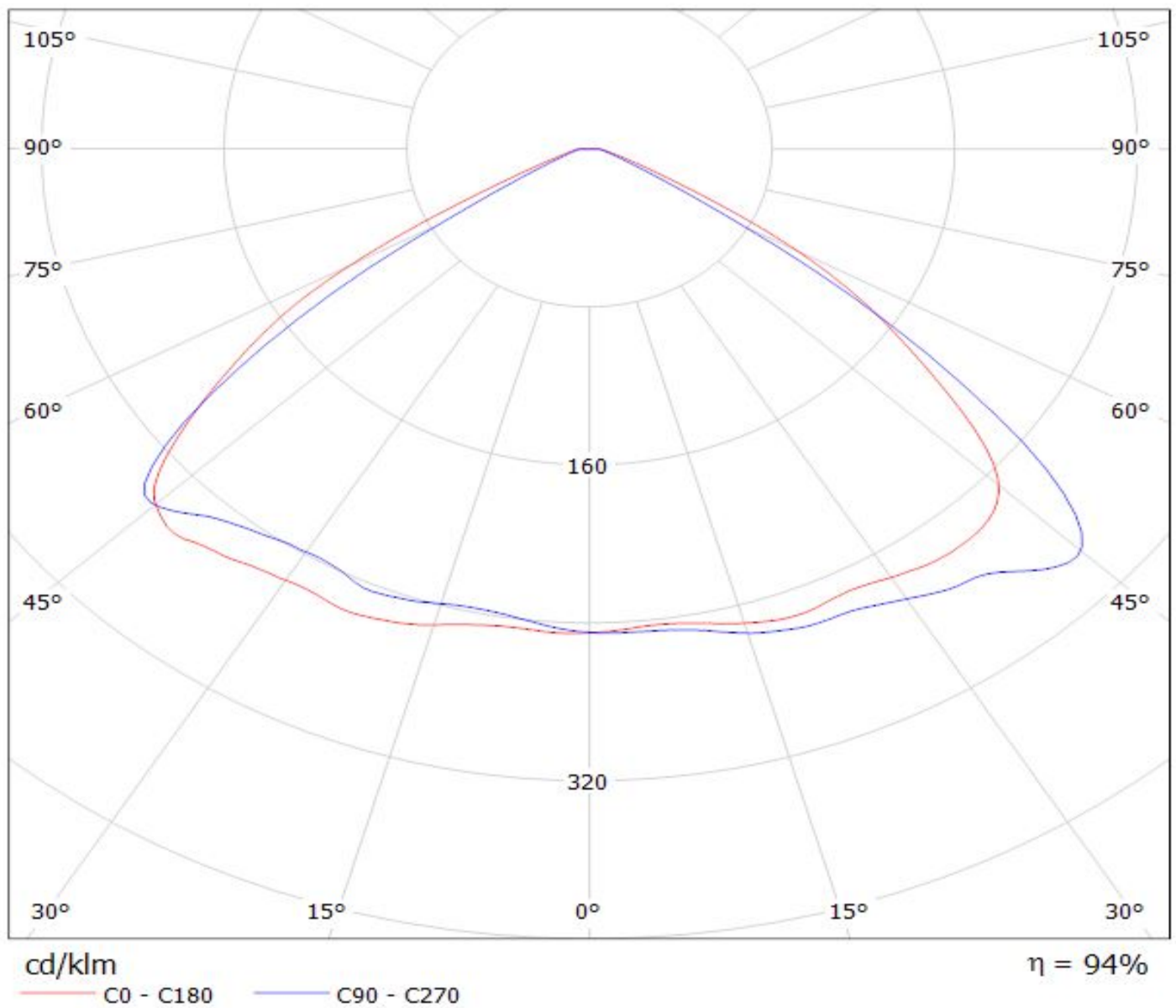

Luminaire: LEDIL OY C12727_STRADA-SQ-VSM (Luxeon M) Efficiency=95%
Lamps: 1 x Luxeon M (360lm@250mA)

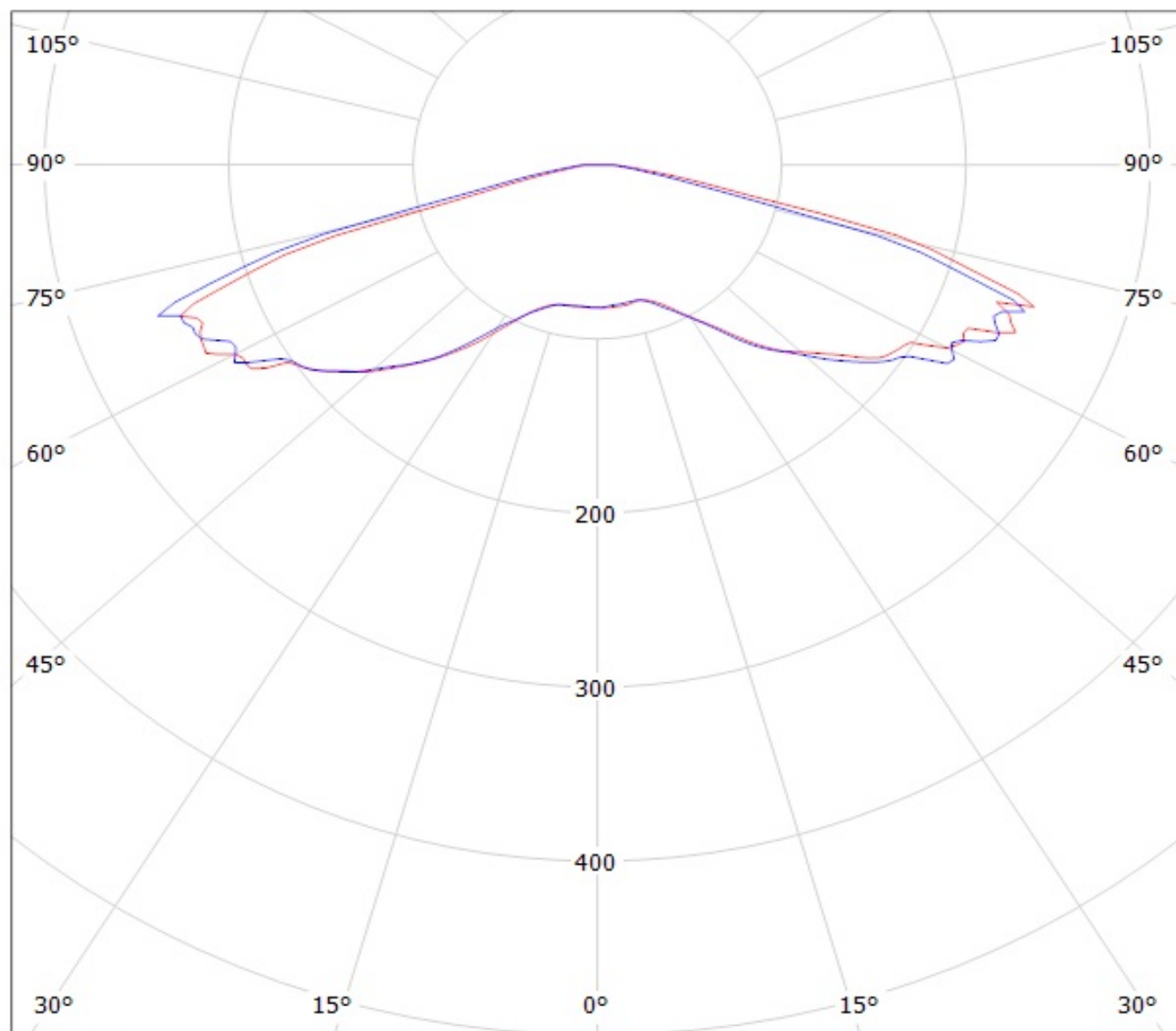

cd/klm

— C0 - C180

— C90 - C270

Luminaire: LEDIL OY C12727_STRADA-SQ-VSM (Luxeon M) Efficiency=95%
Lamps: 1 x Luxeon M (360lm@250mA)

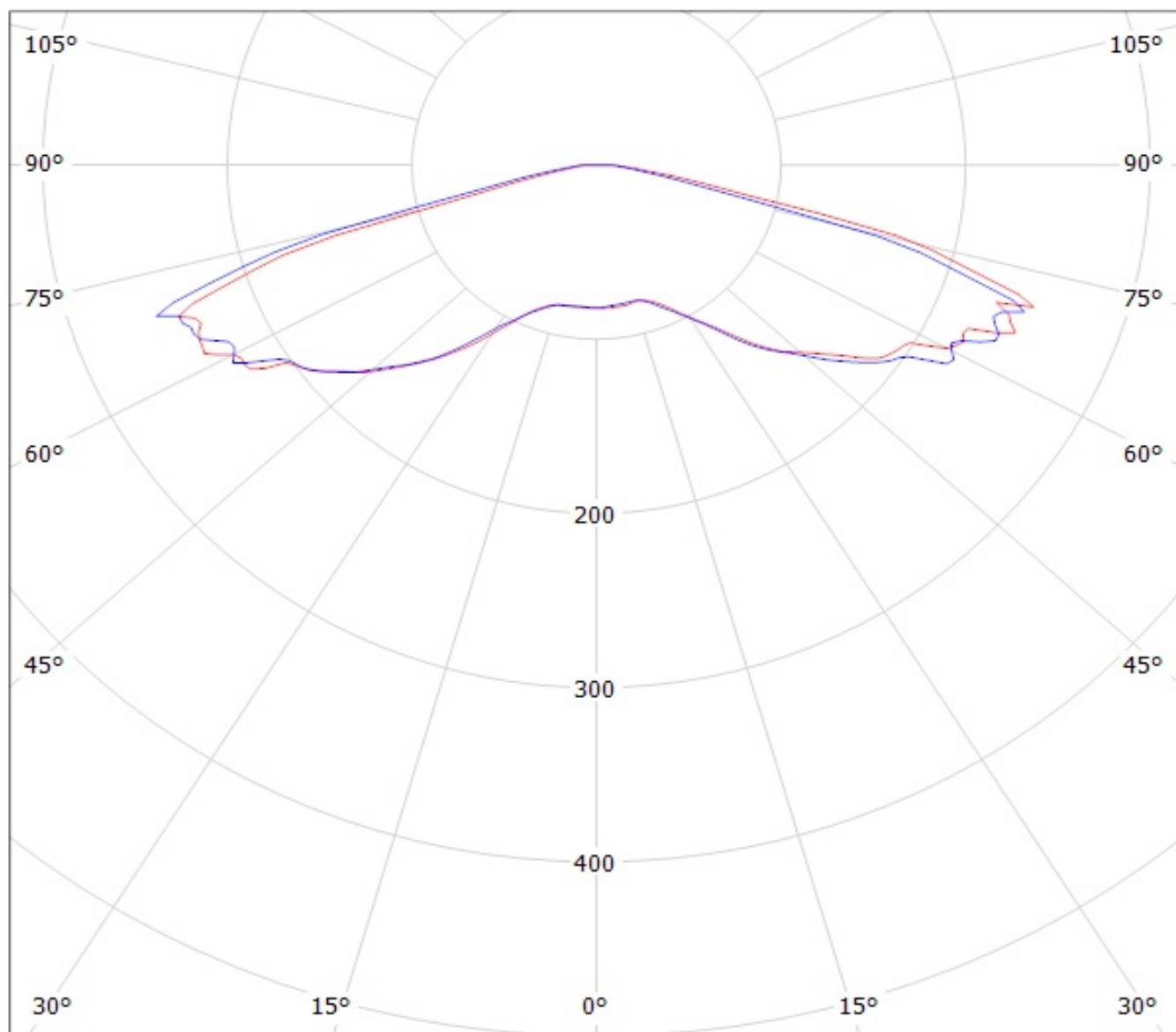

cd/klm

— C0 - C180

— C90 - C270