

L SERIES-Modules

Module P 200 Amp Contact Rating

■ Width is 6 units ■ 2 Hypertac® fixed contacts ■ \varnothing .241" (6.12mm) contacts

TERMINAL STYLE

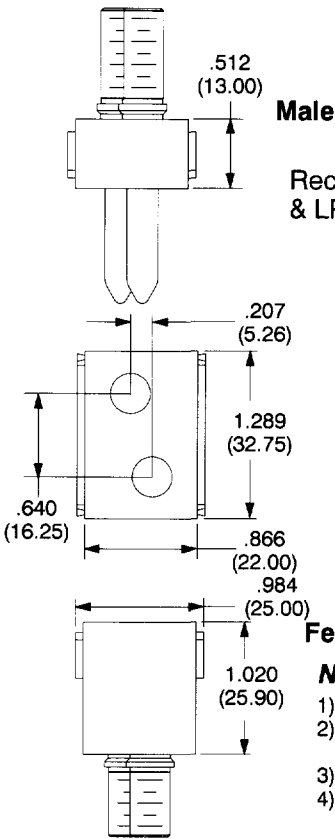

Recommended for LEH & LPH Frames Only

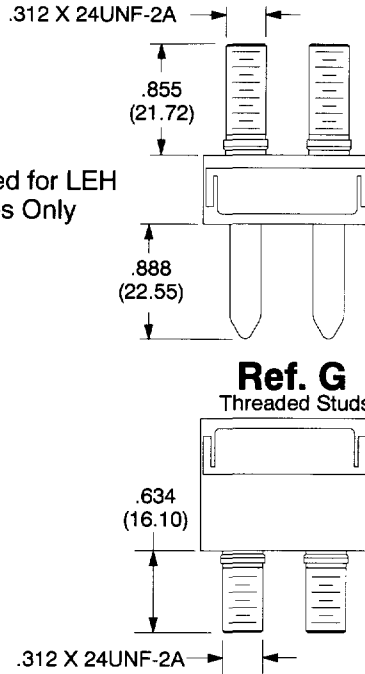

Notes:

- 1) For empty block, order LPHT.
- 2) For ordering information regarding modules assembled in frames, see pg. L20.
- 3) Dimensions in inches (mm)
- 4) If assembling the modules into a frame, two YHD0027 clips are required per module.

GENERAL SPECIFICATIONS

Current Rating	200 amps
Contact Resistance	< .25 milliohms
Extraction Force	80 - 160 oz.
Contact Life Cycles	>100,000
Breakdown voltage	>250V AC
Insulation Resistance	>10 ⁶ megohms @ 500 VDC
Temperature Rating	-55°C to + 125°C
Insulator	Diallyl-phthalate
Contact Material:	(pin) Brass (socket) BeCu wires + brass body
Approx. Weight	M: 66g F: 69g
Plating Reference	TH = 50µin (min) gold over Ni (pin only) TAH = 50µin (min) gold over Ni on mating surface, gold flash over Ni on termination (sockets only)

ORDERING INFORMATION

L P F G T

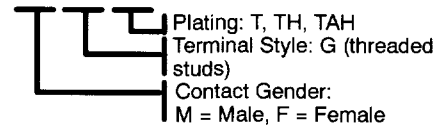

MODULE AVAILABILITY:
Available Option (Consult Factory)

Module N ■ Width is 4 units ■ 4 Hypertac® fixed contacts ■ \varnothing .078" (2.00mm) contacts

16 Amp Contact Rating ■ Make first ground contact

TERMINAL STYLE

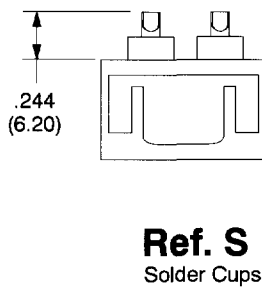
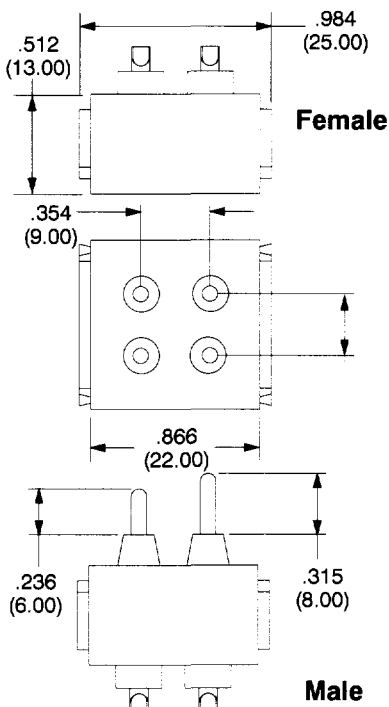

Notes:

- For ordering information regarding modules assembled in frames, see pg. L20.
- Dimensions in inches (mm)
- If assembling the modules into a frame, two YHD0027 clips are required per module.

GENERAL SPECIFICATIONS

Current Rating	16 amps
Contact Resistance	< 1.5 milliohms
Extraction Force	1.5 - 8 oz. (excluding sleeve)
Contact Life Cycles	>100,000
Breakdown voltage	>4000V/4500V RMS
Dielectric Withstanding Voltage:	3000V/3375V RMS
Insulation Resistance	>10 ⁶ megohms @ 500 VDC
Temperature Rating	-55°C to + 125°C
Insulator	PPS (Polyphenylene sulfide)
Contact Material:	(pin) Brass (socket) BeCu wires + brass body
Approx. Weight	M: .4 oz. (11.5g) F: .35 oz. (9.5g)
Plating Reference	T = 10µin gold (min) over Ni on mating surface

ORDERING INFORMATION

L N F S T

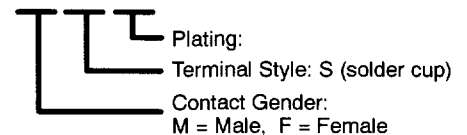

MODULE AVAILABILITY:
Available Option (Consult Factory)