

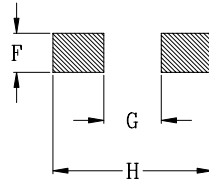

## DELTA P/N : HCB1075N Series

### Mechanical dimensions

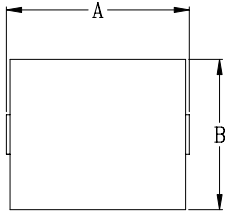

PCB LAYOUT

Dimensions (Unit : mm)

A	10.4 MAX
B	8.0 MAX
C	7.5 MAX
D	2.2
E	2.5
F	2.7
G	4.6
H	11.2

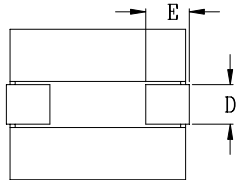

### Electrical Characteristics

Delta P/N	$L^1$ (nH)	Li (nH)	DCR (mΩ)	$Isat^2$ (A)	$Ir^3$ (A)
HCB1075N-121	115	92	0.29 ± 7%	94	41
HCB1075N-151	150	120		72	
HCB1075N-181	175	140		62	
HCB1075N-211	215	172		48	
HCB1075N-231	230	184		43	
HCB1075N-271	270	216		37	
HCB1075N-311	310	248		32	

1. Tolerance of inductance : ± 15%
2.  $Isat$  is the DC current which cause the inductance drop to Li
3.  $Ir$  is the DC current which cause the surface temperature of the part increase approximately 40 .
4. Operating temperature: -40 to 125 (Self-temperature rise included).