

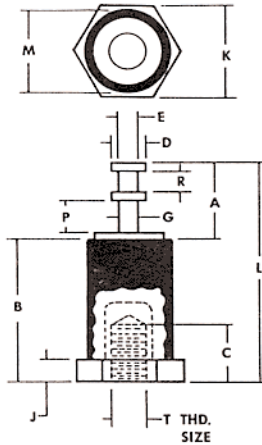

EMC® Product "DTS" Series



Type 91

Plating:

- 14: 400µ" Tin terminal, 200µ" Cadmium Chromate base/eyelet
- 4: 30µ" Gold terminal, 200µ" Cadmium Chromate base/eyelet
- 17: 400µ" Tin terminal, 200µ" Nickel base/eyelet
- 52: 400µ" Tin terminal, 200µ" Cadmium Chromate base/eyelet

Material:

Terminal: Brass, 1/2-hard, QQ-B-626
 Base/Eyelet: Brass, 1/2-hard, QQ-B-626
 Insulator: Diallyl Phthalate, MIL-M-14F Type SDG

Type 91 Continued On Next Page →

Type	EMC Part #	Flash-over Volt.	A	B	C	D	E	G	J	K	L	M	P	R	T
91	6665-14-1	12000	.344 (8.74)	.594 (15.09)	.219 (5.56)	.140 (3.56)	.064 (1.63)	.074 (1.88)	.062 (1.57)	.250 (6.35)	.938 (23.83)	.234 (5.94)	.140 (3.56)	.143 (3.63)	6-32
91	5687-14-1	12000	.344 (8.74)	.594 (15.09)	.219 (5.56)	.140 (3.56)	.062 (1.57)	.078 (1.98)	.062 (1.57)	.250 (6.35)	.938 (23.83)	.232 (5.89)	.139 (3.53)	.093 (2.36)	6-32
91	5686-14-1	12000	.344 (8.74)	.594 (15.09)	.219 (5.56)	.140 (3.56)	.062 (1.57)	.078 (1.98)	.062 (1.57)	.250 (6.35)	.938 (23.83)	.232 (5.89)	.139 (3.53)	.093 (2.36)	4-40
91	2047-14-1	12000	.344 (8.74)	.594 (15.09)	.219 (5.56)	.140 (3.56)	.062 (1.57)	.078 (1.98)	.062 (1.57)	.250 (6.35)	.938 (23.83)	.232 (5.89)	.158 (4.01)	.097 (2.46)	6-32
91	2045-14-1	12000	.344 (8.74)	.594 (15.09)	.219 (5.56)	.140 (3.56)	.062 (1.57)	.078 (1.98)	.062 (1.57)	.250 (6.35)	.938 (23.83)	.232 (5.89)	.158 (4.01)	.097 (2.46)	4-40
91	2403-14-1	12000	.250 (6.35)	.594 (15.09)	.219 (5.56)	.125 (3.18)	.062 (1.57)	.062 (1.57)	.062 (1.57)	.250 (6.35)	.844 (21.44)	.232 (5.89)	.102 (2.59)	.078 (1.98)	6-32
91	5690-14-1	12000	.219 (5.56)	.594 (15.09)	.219 (5.56)	.093 (2.36)	.047 (1.19)	.047 (1.19)	.062 (1.57)	.250 (6.35)	.813 (20.65)	.232 (5.89)	.093 (2.36)	.063 (1.60)	4-40
91	2597-14-1	12000	.219 (5.56)	.594 (15.09)	.219 (5.56)	.093 (2.36)	.050 (1.27)	.050 (1.27)	.062 (1.57)	.250 (6.35)	.813 (20.65)	.232 (5.89)	.089 (2.26)	.056 (1.42)	6-32
91	5691-52-6	12000	.219 (5.56)	.594 (15.09)	.219 (5.56)	.093 (2.36)	.047 (1.19)	.047 (1.19)	.062 (1.57)	.250 (6.35)	.813 (20.65)	.232 (5.89)	.093 (2.36)	.063 (1.60)	6-32
91	2338-14-1	12000	.250 (6.35)	.594 (15.09)	.219 (5.56)	.125 (3.18)	.065 (1.65)	.065 (1.65)	.062 (1.57)	.250 (6.35)	.843 (21.41)	.232 (5.89)	.102 (2.59)	.078 (1.98)	4-40
91	2344-14-1	12000	.250 (6.35)	.594 (15.09)	.219 (5.56)	.093 (2.36)	.050 (1.27)	.050 (1.27)	.062 (1.57)	.250 (6.35)	.843 (21.41)	.232 (5.89)	.107 (2.72)	.063 (1.60)	6-32
91	2858-14-1	12000	.344 (8.74)	.594 (15.09)	.219 (5.56)	.097 (2.46)	.050 (1.27)	.050 (1.27)	.062 (1.57)	.250 (6.35)	.938 (23.83)	.232 (5.89)	.158 (4.01)	.097 (2.46)	4-40
91	3240-14-1	12000	.188 (4.78)	.594 (15.09)	.219 (5.56)	.093 (2.36)	.050 (1.27)	.050 (1.27)	.062 (1.57)	.250 (6.35)	.781 (19.84)	.232 (5.89)	.107 (2.72)	.063 (1.60)	4-40
91	2039-14-1	10000	.344 (8.74)	.531 (13.49)	.219 (5.56)	.140 (3.56)	.062 (1.57)	.078 (1.98)	.062 (1.57)	.250 (6.35)	.875 (22.23)	.232 (5.89)	.158 (4.01)	.097 (2.46)	6-32
91	2037-14-1	10000	.344 (8.74)	.531 (13.49)	.219 (5.56)	.140 (3.56)	.062 (1.57)	.078 (1.98)	.062 (1.57)	.250 (6.35)	.875 (22.23)	.232 (5.89)	.158 (4.01)	.097 (2.46)	4-40
91	2321-14-1	10000	.344 (8.74)	.531 (13.49)	.156 (3.96)	.140 (3.56)	.062 (1.57)	.078 (1.98)	.062 (1.57)	.250 (6.35)	.875 (22.23)	.232 (5.89)	.158 (4.01)	.097 (2.46)	4-40
91	2402-14-1	10000	.250 (6.35)	.531 (13.49)	.219 (5.56)	.125 (3.18)	.062 (1.57)	.062 (1.57)	.062 (1.57)	.250 (6.35)	.781 (19.84)	.232 (5.89)	.102 (2.59)	.078 (1.98)	6-32
91	3103-14-1	10000	.250 (6.35)	.531 (13.49)	.219 (5.56)	.093 (2.36)	.050 (1.27)	.050 (1.27)	.062 (1.57)	.250 (6.35)	.781 (19.84)	.232 (5.89)	.107 (2.72)	.063 (1.60)	6-32
91	3239-14-1	10000	.250 (6.35)	.531 (13.49)	.219 (5.56)	.093 (2.36)	.050 (1.27)	.050 (1.27)	.062 (1.57)	.250 (6.35)	.781 (19.84)	.232 (5.89)	.107 (2.72)	.063 (1.60)	4-40
91	2318-14-1	10000	.328 (8.33)	.531 (13.49)	.156 (3.96)	.188 (4.78)	.110 (2.79)	.125 (3.18)	.062 (1.57)	.250 (6.35)	.859 (21.82)	.232 (5.89)	.138 (3.51)	.090 (2.29)	4-40
91	3025-14-1	10000	.344 (8.74)	.531 (13.49)	.156 (3.96)	.140 (3.56)	.062 (1.57)	.078 (1.98)	.062 (1.57)	.250 (6.35)	.875 (22.23)	.232 (5.89)	.102 (2.59)	.078 (2.59)	6-32
91	3040-14-1	9000	.250 (6.35)	.500 (12.70)	.219 (5.56)	.125 (3.18)	.062 (1.57)	.062 (1.57)	.062 (1.57)	.250 (6.35)	.750 (19.05)	.232 (5.89)	.102 (2.59)	.078 (2.59)	4-40

inch (mm)



EMC® Product "DTS" Series

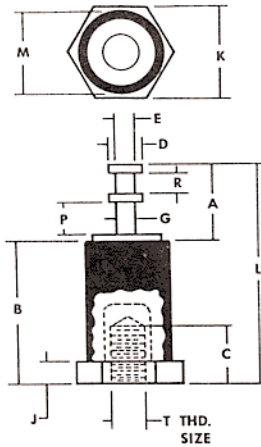

Type 91

Plating:

- 14: 400µ" Tin terminal, 200µ" Cadmium Chromate base/eyelet
- 4: 30µ" Gold terminal, 200µ" Cadmium Chromate base/eyelet
- 17: 400µ" Tin terminal, 200µ" Nickel base/eyelet
- 52: 400µ" Tin terminal, 200µ" Cadmium Chromate base/eyelet

Material:

Terminal: Brass, 1/2-hard, QQ-B-626
 Base/Eyelet: Brass, 1/2-hard, QQ-B-626
 Insulator: Diallyl Phthalate, MIL-M-14F Type SDG

Type	EMC Part #	Flash-over Volt.	A	B	C	D	E	G	J	K	L	M	P	R	T
91	4064-14-1	9000	.219 (5.56)	.500 (12.70)	.219 (5.56)	.125 (3.18)	.155 (3.94)	.078 (1.98)	.062 (1.57)	.250 (6.35)	.719 (18.26)	.232 (5.89)	.090 (2.29)	.058 (1.47)	4-40
91	2180-14-1	8200	.156 (3.96)	.390 (9.91)	.078 (1.98)	.072 (1.83)	.050 (1.27)	.050 (1.27)	.046 (1.17)	.156 (3.96)	.547 (13.89)	.146 (3.71)	.055 (1.40)	.046 (1.17)	2-56
91	2883-14-1	8000	.406 (10.31)	.375 (9.53)	.156 (3.96)	.140 (3.56)	.062 (1.57)	.078 (1.98)	.062 (1.57)	.250 (6.35)	.781 (19.84)	.232 (5.89)	.170 (4.32)	.160 (4.06)	6-32
91	3237-14-1	8000	.250 (6.35)	.500 (12.70)	.219 (5.56)	.093 (2.36)	.050 (1.27)	.050 (1.27)	.062 (1.57)	.250 (6.35)	.750 (19.05)	.232 (5.89)	.107 (2.72)	.063 (1.60)	4-40
91	3238-14-1	8000	.250 (6.35)	.500 (12.70)	.219 (5.56)	.093 (2.36)	.050 (1.27)	.050 (1.27)	.062 (1.57)	.250 (6.35)	.750 (19.05)	.232 (5.89)	.107 (2.72)	.063 (1.60)	6-32
91	3044-14-1	8000	.344 (8.74)	.500 (12.70)	.219 (5.56)	.140 (3.56)	.062 (1.57)	.078 (1.98)	.062 (1.57)	.250 (6.35)	.844 (21.44)	.232 (5.89)	.158 (4.01)	.097 (2.46)	4-40
91	3241-14-1	8000	.344 (8.74)	.500 (12.70)	.219 (5.56)	.140 (3.56)	.062 (1.57)	.078 (1.98)	.062 (1.57)	.250 (6.35)	.844 (21.44)	.232 (5.89)	.158 (4.01)	.097 (2.46)	6-32
91	2013-14-1	8000	.344 (8.74)	.375 (9.53)	.156 (3.96)	.140 (3.56)	.062 (1.57)	.078 (1.98)	.062 (1.57)	.250 (6.35)	.719 (18.26)	.232 (5.89)	.158 (4.01)	.097 (2.46)	4-40
91	2019-14-1	8000	.344 (8.74)	.375 (9.53)	.156 (3.96)	.140 (3.56)	.062 (1.57)	.078 (1.98)	.062 (1.57)	.250 (6.35)	.719 (18.26)	.232 (5.89)	.158 (4.01)	.097 (2.46)	6-32
91	5684-14-1	8000	.344 (8.74)	.375 (9.53)	.156 (3.96)	.140 (3.56)	.062 (1.57)	.078 (1.98)	.062 (1.57)	.250 (6.35)	.719 (18.26)	.232 (5.89)	.139 (3.53)	.093 (2.36)	4-40
91	5685-14-1	8000	.344 (8.74)	.375 (9.53)	.156 (3.96)	.140 (3.56)	.062 (1.57)	.078 (1.98)	.062 (1.57)	.250 (6.35)	.719 (18.26)	.232 (5.89)	.139 (3.53)	.093 (2.36)	6-32
91	3029-14-1	8000	.250 (6.35)	.375 (9.53)	.156 (3.96)	.093 (2.36)	.050 (1.27)	.075 (1.91)	.062 (1.57)	.250 (6.35)	.625 (15.88)	.232 (5.89)	.107 (2.72)	.063 (1.60)	6-32
91	3041-14-1	8000	.250 (6.35)	.375 (9.53)	.156 (3.96)	.125 (3.18)	.062 (1.57)	.062 (1.57)	.062 (1.57)	.250 (6.35)	.625 (15.88)	.232 (5.89)	.102 (2.59)	.078 (1.98)	6-32
91	2396-14-1	8000	.250 (6.35)	.375 (9.53)	.156 (3.96)	.125 (3.18)	.062 (1.57)	.062 (1.57)	.062 (1.57)	.250 (6.35)	.625 (15.88)	.232 (5.89)	.102 (2.59)	.078 (1.98)	4-40
91	5688-14-1	8000	.219 (5.56)	.375 (9.53)	.156 (3.96)	.093 (2.36)	.047 (1.19)	.047 (1.19)	.062 (1.57)	.250 (6.35)	.594 (15.09)	.232 (5.89)	.093 (2.36)	.063 (1.60)	4-40
91	5689-14-1	8000	.219 (5.56)	.375 (9.53)	.156 (3.96)	.093 (2.36)	.047 (1.19)	.047 (1.19)	.062 (1.57)	.250 (6.35)	.594 (15.09)	.232 (5.89)	.093 (2.36)	.063 (1.60)	6-32
91	2310-14-1	8000	.219 (5.56)	.375 (9.53)	.156 (3.96)	.093 (2.36)	.050 (1.27)	.050 (1.27)	.062 (1.57)	.250 (6.35)	.594 (15.09)	.232 (5.89)	.089 (2.26)	.052 (1.32)	6-32
91	2333-14-1	8000	.219 (5.56)	.375 (9.53)	.156 (3.96)	.093 (2.36)	.050 (1.27)	.050 (1.27)	.062 (1.57)	.250 (6.35)	.594 (15.09)	.232 (5.89)	.089 (2.26)	.052 (1.32)	4-40
91	5747-14-1	7000	.231 (5.87)	.359 (9.12)	.125 (3.18)	.094 (2.39)	.047 (1.19)	.047 (1.19)	.062 (1.57)	.313 (7.95)	.594 (15.09)	.281 (7.14)	.094 (2.39)	.063 (1.60)	4-40
91	5302-14-1	6000	.234 (5.94)	.266 (6.76)	.078 (1.98)	.094 (2.39)	.047 (1.19)	.047 (1.19)	.062 (1.57)	.250 (6.35)	.500 (12.70)	.232 (5.89)	.094 (2.39)	.063 (1.60)	4-40
91	2174-14-1	6000	.156 (3.96)	.234 (5.94)	.078 (1.98)	.072 (1.83)	.050 (1.27)	.050 (1.27)	.046 (1.17)	.156 (3.96)	.391 (9.93)	.146 (3.71)	.055 (1.40)	.046 (1.17)	2-56

inch
(mm)