



Micro Commercial Components

Micro Commercial Components
 20736 Marilla Street Chatsworth
 CA 91311
 Phone: (818) 701-4933
 Fax: (818) 701-4939

2SA1585S
2SA1585S-Q
2SA1585S-R

Features

- Power dissipation: $P_D = 0.4W(T_{amb}=25^\circ C)$
- Collector current: $I_{CM} = -2A$
- Collector-base voltage: $V_{(BR)CBO} = -20V$
- Operating and storage junction temperature range
 $T_J, T_{stg}: -55^\circ C$ to $+150^\circ C$

Electrical Characteristics @ 25°C Unless Otherwise Specified

Symbol	Parameter	Min	Typ	Max	Unit
V_{CEO}	Collector-Emitter Voltage ($I_C = -50 \mu A, I_E = 0$)	-20	---	---	V
V_{CBO}	Collector-Base Voltage ($I_C = -1 \mu A, I_B = 0$)	-20	---	---	V
V_{EBO}	Emitter-Base Voltage ($I_E = -50 \mu A, I_C = 0$)	-6.0	---	---	V
I_{CBO}	Collector cut-off Current ($V_{CB} = -20V, I_E = 0$)	---	---	-0.1	μA
I_{EBO}	Emitter cut-off Current ($V_{EB} = -5V, I_C = 0$)	---	---	-0.1	μA
h_{FE}	DC current gain ($V_{CE} = -2V, I_C = -0.1A$)	120	---	390	---
$V_{CE(sat)}$	Collector-Emitter Saturation Voltage ($I_C = -2A, I_B = -0.1A$)	---	---	-0.82	V
f_T	Transition Frequency ($V_{CE} = 2.0Vdc, I_C = 0.5Adc$)	200	---	---	MHz

CLASSIFICATION OF h_{FE}

Rank	Q	R
Range	120-170	180-390
Marking	1815Q	1815R

PNP
Plastic-Encapsulate
Transistors

TO-92S

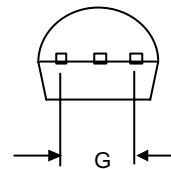
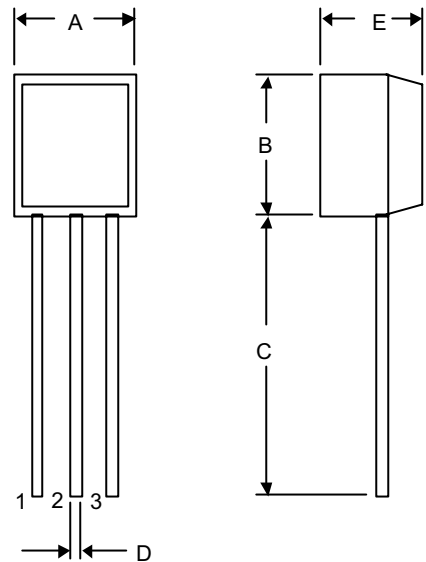

1.EMITTER
 2.COLLECTOR
 3.BASE

DIM	INCHES		MM		NOTE
	MIN	MAX	MIN	MAX	
A	.16	---	4.00	---	
B	.12	---	3.00	---	
C	.59	---	15.00	---	
D	.02	---	0.45	---	
E	.08	---	2.00	---	
G	.20	---	5.00	---	