

FSW-0503 Version: 1



## 4 FE PoE + 1 FE Switch, 61.6W

### Advanced PoE Solution

FSW-0503(Z) is a 4 Fast Ethernet PoE +1 Fast Ethernet Switch. Per PoE port is powered up to 15.4W. The total PoE power budget is 61.6W. It is an ideal solution for extensive WLAN, IP surveillance system deployments especially when the legacy and PoE compliance devices co-exist in your network environment. The switch automatically detects IEEE 802.3af compliant device connected and provides power and data over a single cable to these devices.

FSW-0503(Z) is compact in size, making it ideal for desktop users with limited space. You also have option of installing several FSW-0503(Z) in a 19" chassis (POC-6000) for a largescale rack-mount PoE Solution.

### Stable and Reliable Network Environment

FSW-0503(Z) enables users to deploy a stable and reliable high-speed LAN environment, with store-and-forward switching architecture, packet error filtering and non-blocking packet forwarding. The 802.3x and backpressure flow control mechanisms work respectively for full and half duplex modes. This device supports N-way auto-negotiation protocol that automatically detects networking speed and duplex modes.

### Easy to Use

For instant error detection, the switch is equipped with a full range of LEDs to help monitor and troubleshoot problems on the network.

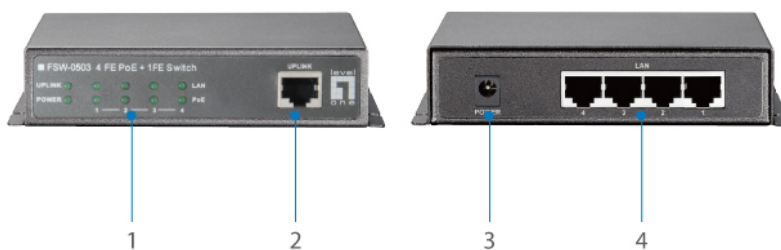

1. LED Indicators
2. 10/100Mbps RJ-45 Uplink Port
3. External Power Socket
4. 10/100Mbps RJ-45 PoE Ports

### Key Features

- Provides flexibility of 4 x 10/100BASE-TX PoE ports
- IEEE 802.3af PoE compliant to simplify deployment and installation



- Auto-detection and protection of non-standard PoE devices
- 10/100Mbps-Full/Half-duplex, Auto-Negotiation, Auto-MDI/MDIX
- IEEE 802.3x Flow Control protects against lost packets for reliable data transmission
- Total PoE power budget: 61.6W, up to 15.4W per port

---

## Specifications

### System Specifications

**Buffer Memory (KB):**

48KB

**Connectors and Cabling:**

4 x 10/100Base-TX RJ-45 PoE Ports

1 x 10/100Base-T RJ-45 Uplink Port

10Base T Cat. 3, 4, 5 UTP/STP

100Base TX Cat. 5 UTP/STP

**Indicator:**

Power, Uplink, LAN 1~4 port, PoE 1~4 port

**Transmission Method:**

Store-and-Forward

**Power:**

Power Consumption: < 65W

Power Input: 100 ~ 240V DC / 50~60Hz 1.35A External Power Adapter

**Standards & Protocols:**

IEEE 802.3 10-BASE-T, Ethernet

IEEE 802.3u 100-BASE-TX, Fast Ethernet

IEEE 802.3x Full-duplex Flow Control

IEEE 802.3af Power over Ethernet (PoE)

### Features

**PoE:**

Power Budget: Max. 61.6w

PoE Standard: IEEE 802.3af Power over Ethernet / PSE

PD classification identity

PoE over current protection

PoE circuit sorting protection

PoE Power Output: Per Port 48V DC, Max. 15.4 watts (802.3af)

Power Pin Assignment: 1/2(+), 3/6(-)

### Performance

**MAC Address Table:**

1K

**Data Transfer Rate:**

10/100Mbps

**Packet Forwarding Rate:**

100Mbps port - 148,000pps

10Mbps port - 14,880pps

### Environment

**Temperature (°C):**

Operating: 0°C ~ 45°C

Storage: - 40°C ~ 70°C

Humidity (Non-condensing):  
Storage: 10% ~ 90%  
Operating: 10% ~ 90%

## Physical Specifications

Dimensions (W x D x H mm):  
90 x 120 x 28 mm

Weight (g):  
800 g

## Others

Approval and Compliance:  
FCC, CE

## Diagram

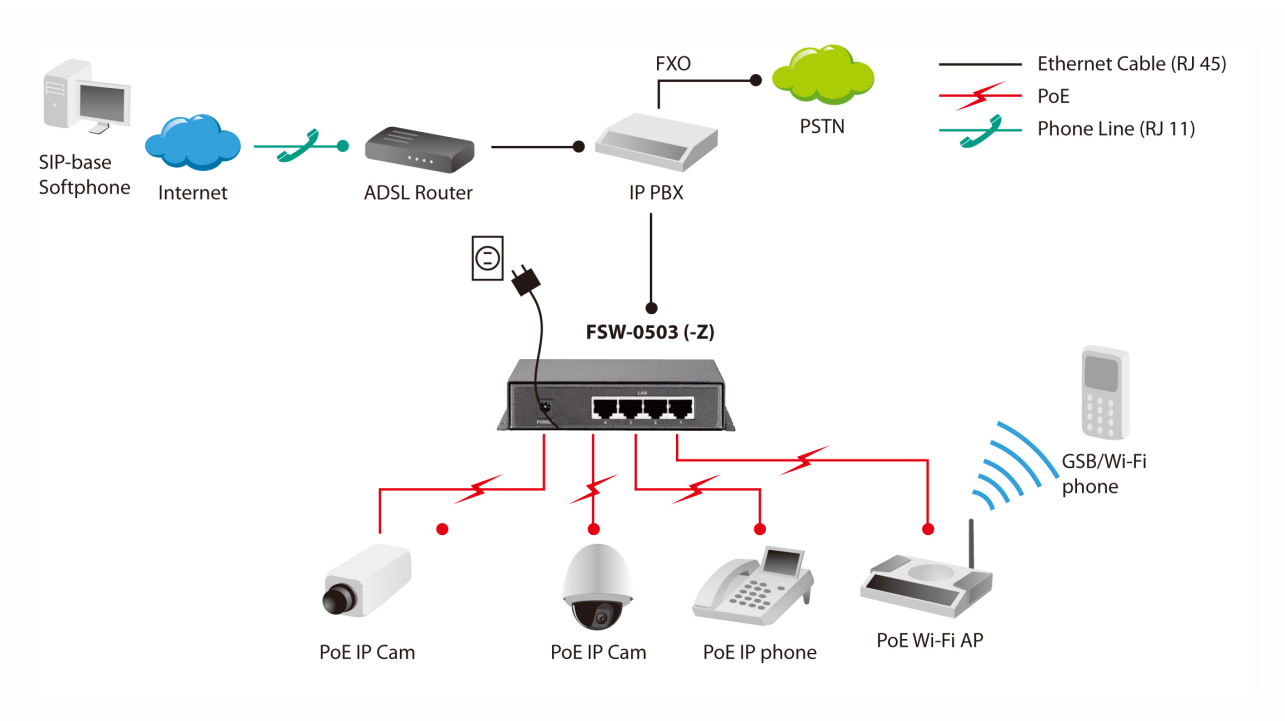

## Order Information

FSW-0503: power adapter included  
FSW-0503Z: excl. power adapter

## Package Contents

User Manual



## Optional Accessory



**POC-6000**  
8-Bay Chassis, 1000W



**POC-4002**  
8-Bay Chassis, 500W

All mentioned brand names are registered trademarks and property of their owners.  
Copyright © Digital Data Communications GmbH, Germany. All Rights Reserved.