

Non-Insulated Locking Fork Terminals

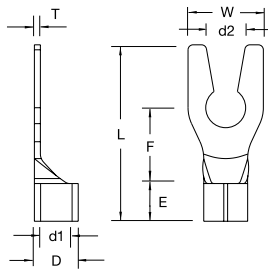

- Chamfered Barrel
- Brazed Seam
- Internal Barrel Serrations

Catalog Number	Wire Range	Bolt Size (d2)		Dimension <small>inch mm</small>						
				W	F	L	E	D	d1	T
K18-6LF-M	22-16 A.W.G. 0.5-1.5 mm'	#6	.146 3.7	.252 6.4	.256 6.5	.630 16.0	.189 4.8	.134 3.4	.067 1.7	.030 0.75
K18-8LF-M		#8	.169 4.3	.283 7.2						
K18-10LF-M		#10	.209 5.3	.319 8.1						
K14-6LF-M	16-14 A.W.G. 1.5-2.5 mm'	#6	.146 3.7	.236 6.0	.256 6.5	.630 16.0	.189 4.8	.161 4.1	.091 2.3	.031 0.8
K14-8LF-M		#8	.169 4.3	.283 7.2						
K14-10LF-M		#10	.209 5.3	.319 8.1						
K10-6LF-M	12-10 A.W.G. 4-6 mm'	#6	.146 3.7	.327 8.3	.276 7.0	.717 18.2	.236 6.0	.220 5.6	.134 3.4	.039 1.0
K10-8LF-M		#8	.169 4.3	.327 8.3						
K10-10LF-M		#10	.209 5.3	.354 9.0						



Box Quantity: (M)=1000

For Mylar Tape replace box quantity with (T). Example: K18-6LF-T

UL File #E9809

CSA File #LR4503

See pages in back of catalog for complete tool information.

Tool and Die Selection Chart on page M42.

Terminal Material: Copper

Tools used with Non-Insulated Locking Fork Terminals



ERG2002



KT-2500

M

Spec-Kon®