



Solid State Devices, Inc.

14701 Firestone Blvd * La Mirada, CA 90638
 Phone: (562) 404-4474 * Fax: (562) 404-1773
 ssdi@ssdi-power.com * www.ssdi-power.com

**SDA280D
 THRU
 SDA280G**

**15 AMPS / 400 – 1000 VOLTS
 FAST RECOVERY
 CENTERTAP RECTIFIER**

DESIGNER'S DATA SHEET

Part Number/Ordering Information ^{1/}

SDA280

Screening ^{2/}
 — = Not Screened
 TX = TX Level
 TXV = TXV
 S = S Level

Configuration
 C = Common Cathode
 A = Common Anode
 D = Doubler

Voltage
 D = 400V
 E = 600V
 F = 800V
 G = 1000V

- Features:**
- Average Output Current: 15 Amps
 - PIV: 400 to 1000V
 - Max Thermal Resistance 5.0 °C/Watt
 - Fast Recovery: 150 / 180 nsec
 - Glass Passivated Rectifiers
 - Hermetically Sealed Discretes
 - Aluminum Case for Maximum Thermal Conductivity
 - Common Cathode, Common Anode, and Doubler Versions Available. Contact Factory for Part Number.
 - Parts with Blade and Hook Terminals Available. Contact Factory for Part Number.
 - TX, TXV, and Space Level Screening Available

Maximum Ratings		Symbol	Value	Units
Peak Repetitive and Peak Surge Reverse Voltage	SDA280D	V_{RRM} V_{RSM} V_R	400	Volts
	SDA280E		600	
	SDA280F		800	
	SDA280G		1000	
Average Rectified Forward Current ^{4/} (Resistive Load, 60 hz Sine Wave, No Heatsink)	$T_A = 55^\circ\text{C}$	I_o	15	Amps
	$T_A = 100^\circ\text{C}$		10	
Peak Surge Current ^{3/} (8.3 ms Pulse, Half Sine Wave, $T_A = 25^\circ\text{C}$, per leg)		I_{FSM}	150	Amps
Operating & Storage Temperature		$T_{op} \& T_{stg}$	-55 to +150	°C
Maximum Thermal Resistance Junction to Case		$R_{\theta JC}$	5.0	°C/W

^{1/} For Ordering Information, Price, Operating Curves, and Availability- Contact Factory.

^{2/} Screening based on MIL-PRF-19500. Screening flows available on request.

^{3/} Both legs tied together

^{4/} Per leg

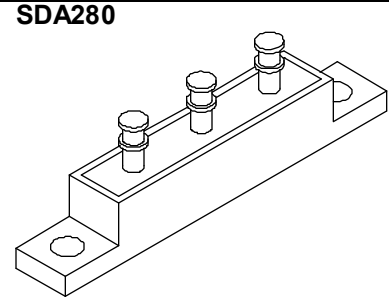



Solid State Devices, Inc.

14701 Firestone Blvd * La Mirada, CA 90638
 Phone: (562) 404-4474 * Fax: (562) 404-1773
 ssdi@ssdi-power.com * www.ssdi-power.com

**SDA280D
 thru
 SDA280G**

Electrical Characteristics	Symbol	Value	Units
Instantaneous Forward Voltage Drop ($I_F = 5A$, $T_A = 25^\circ C$, 300 - 500 μ sec pulse)	V_{F1}	1.4	V_{DC}
Reverse Leakage Current (Rated V_R , $T_A = 25^\circ C$, 300 μ sec pulse minimum)	I_{R1}	5	μA
Reverse Recovery Time ($T_A = 25^\circ C$, $I_F = 0.5A$, $I_R = 1.0A$, $I_{RR} = 0.25A$)	t_{RR}	SDA280D 150 SDA280E - SDA280G 180	nsec

Case Outline:

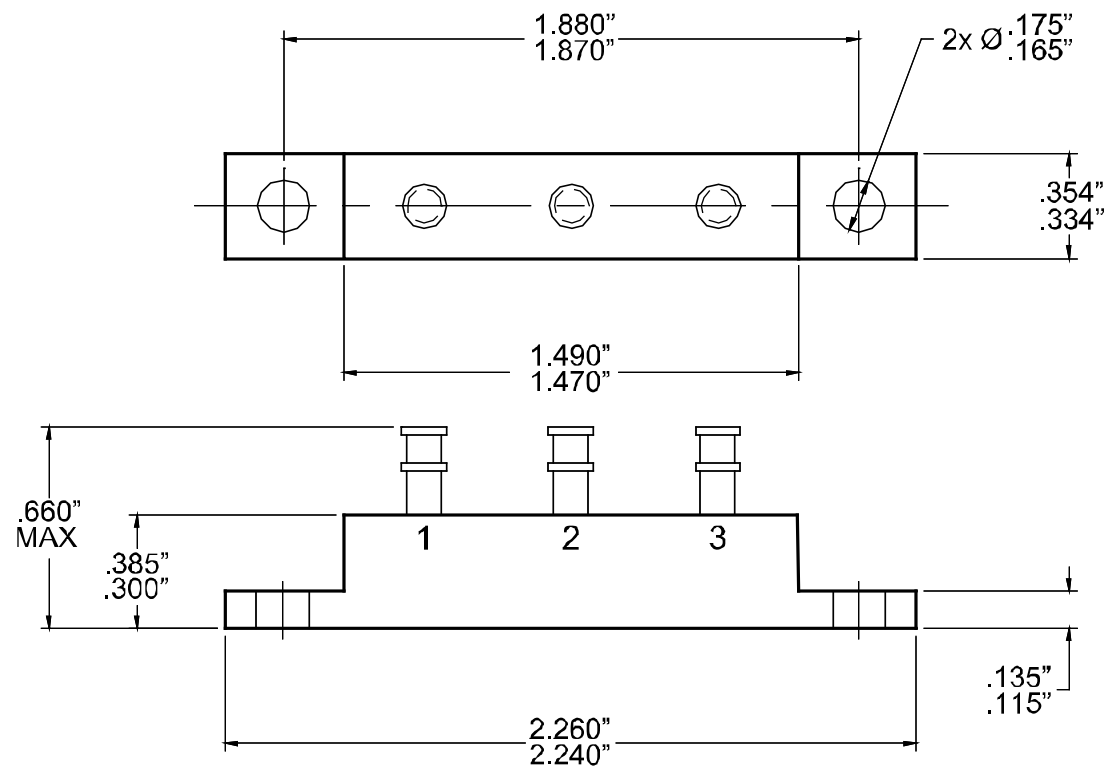
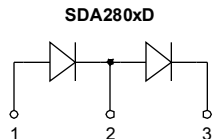
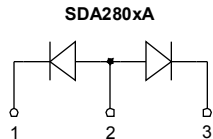
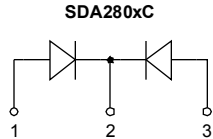

NOTE: All specifications are subject to change without notification. SCD's for these devices should be reviewed by SSDI prior to release.

DATA SHEET #: RA0050C

DOC