

C 091 D

Female receptacle for front mounting

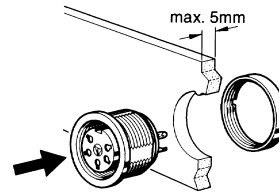

Assembling instruction

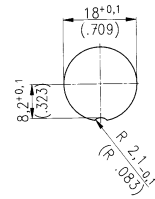

Panel Cutout

Description	Drawing	No. of cont.	Part Number solder termination		Part Number Crimp termination ¹⁾			
			Contact plating silver	Contact plating gold ²⁾				
Female receptacle, termination: solder or crimp, contact plating: silver or gold, panel mounting with ring nut, sealing with O-Ring, solder area: tin plated.		3	DIN	C091 31N003 100 2	–	C091 11N003 000 2		
		4	IEC	C091 31N004 100 2	–	C091 11N004 000 2		
		5	DIN	C091 31N005 100 2	–	C091 11N005 000 2		
		5S	DIN	C091 31N105 100 2	–	C091 11N105 000 2		
		6	DIN	C091 31N006 100 2	–	C091 11N006 000 2		
		7		C091 31N007 100 2	–	C091 11N007 000 2		
		7	DIN	C091 31N107 100 2 ⁴⁾	–	C091 11N107 000 2		
		8	DIN	C091 31N008 100 2	–	C091 11N008 000 2		
		12	–		C091 31N012 200 2 ⁴⁾	–		
		14	–		C091 31N014 200 2 ⁴⁾	–		
		Female receptacle, termination: straight dip solder, contact plating: silver or gold, pin length 15 mm (12 + 14 contacts: 18 mm) from flange, panel mounting with ring nut, sealing with O-Ring, solder area: tin plated.		3	DIN	C091 61N003 110 2	–	–
				4	IEC	C091 61N004 110 2	–	–
				5	DIN	C091 61N005 110 2	–	–
				5S	DIN	C091 61N105 110 2	–	–
6	DIN			C091 61N006 110 2	–	–		
7				C091 61N007 110 2	–	–		
7	DIN			C091 61N107 110 2	–	–		
8	DIN			C091 61N008 110 2	–	–		
12	–				C091 61N012 210 2	–		
14	–				C091 61N014 210 2	–		
Female receptacle, termination: straight dip solder, contact plating: silver, panel mounting with ring nut, sealing with O-Ring, solder area: tin plated.				3	DIN	C091 61N003 120 2	–	–
				4	IEC	C091 61N004 120 2	–	–
				5	DIN	C091 61N005 120 2	–	–
				5S	DIN	C091 61N105 120 2	–	–
		6	DIN	C091 61N006 120 2	–	–		
		7		C091 61N007 120 2	–	–		
		7	DIN	C091 61N107 120 2	–	–		
		8	DIN	C091 61N008 120 2	–	–		
		12	–		–	–		
		14	–		–	–		
		Female receptacle, termination: straight dip solder, contact plating: silver, panel mounting with ring nut, sealing with O-Ring, solder area: tin plated.		3	DIN	C091 61N003 130 2	–	–
				4	IEC	C091 61N004 130 2	–	–
				5	DIN	C091 61N005 130 2	–	–
				5S	DIN	C091 61N105 130 2	–	–
6	DIN			C091 61N006 130 2	–	–		
7				C091 61N007 130 2	–	–		
7	DIN			C091 61N107 130 2	–	–		
8	DIN			C091 61N008 130 2	–	–		
12	–				–	–		
14	–				–	–		

¹⁾ Please order crimp contacts separately, see page 46 ²⁾ see remark page 39

⁴⁾ Available upon request. Min. order qty.100 pcs/type.