

Detail contact area

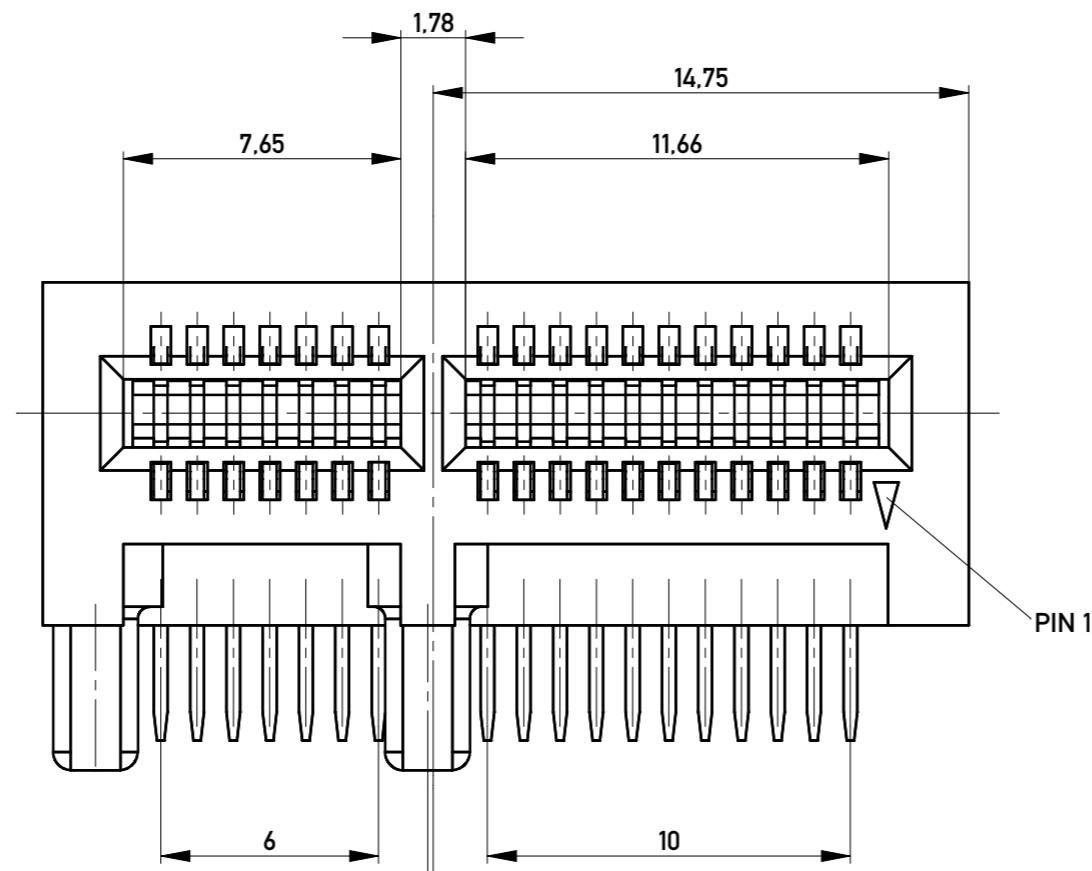

Offset von Führungssteg zu Referenzzapfen 0.15
Offset from guiding bar to reference peg

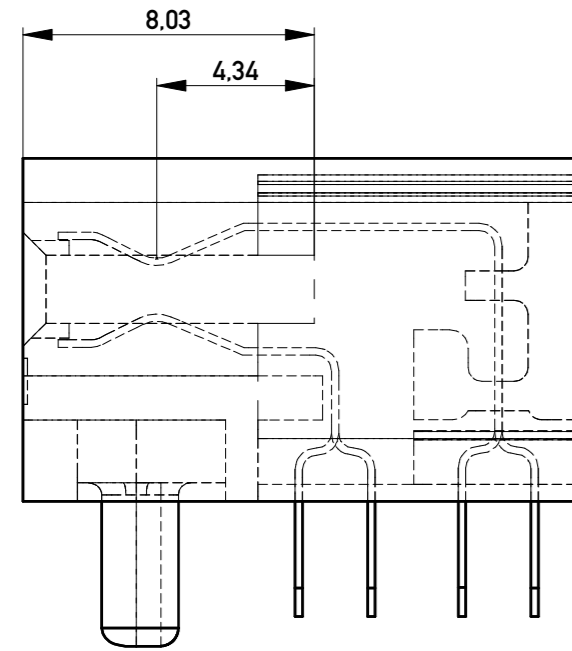
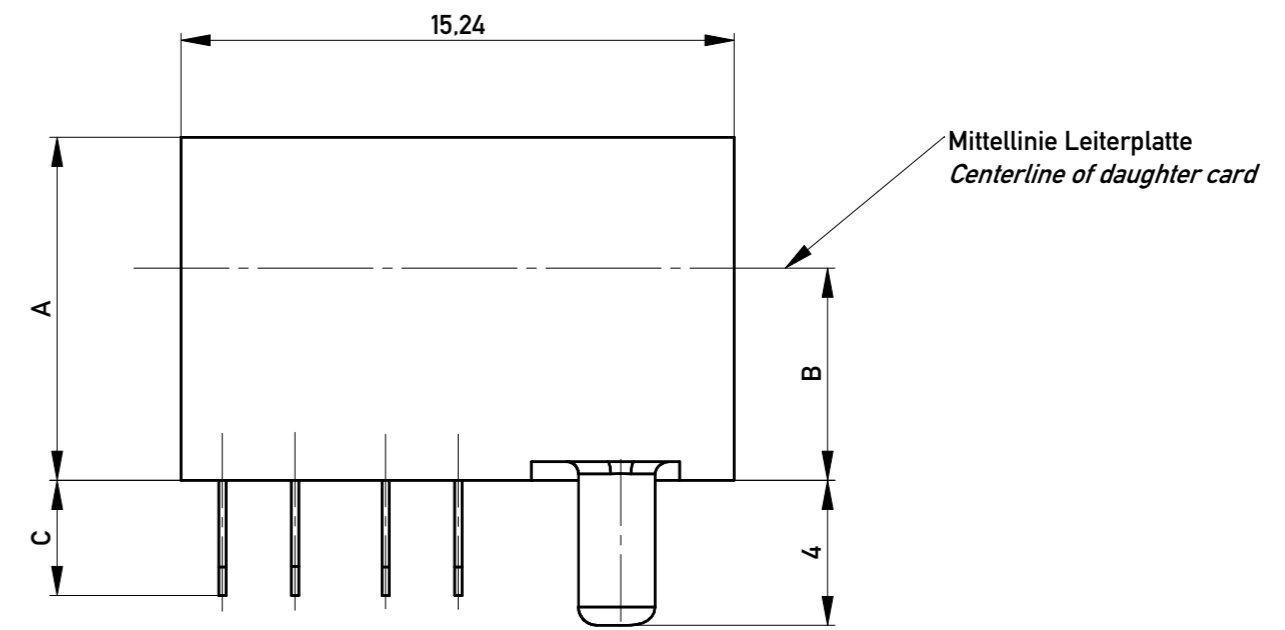

Datum
Date code (see notes)

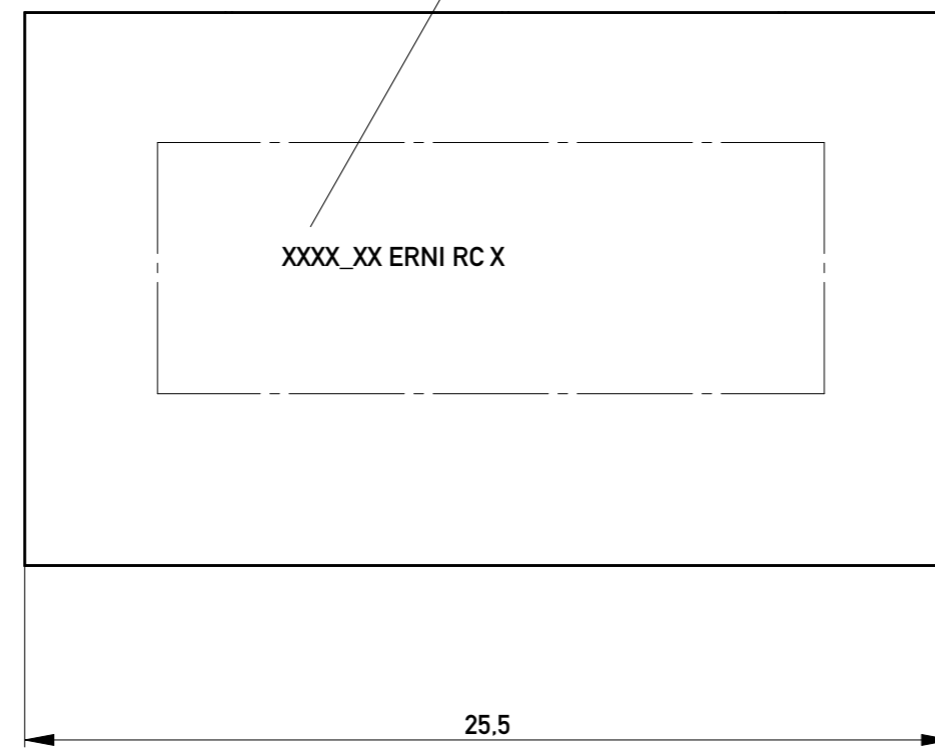

NOTES:

Material: LCP GF 30 schwarz
Material: LCP GF 30 black

Galvanik: min. 1,27 µm Unternickelung über gesamten PIN - Bereich
min. 0,127 µm Au im Steckbereich
Gold - Flash im Lötbereich

Plating: min. 1,27 µm Ni entire contact
min. 0,127 µm Au in contact area
Gold - Flash plating on contact tails

1.) Fertigllochdurchmesser
finished viadiameter (PTH)

Package: Tray (20 pcs.)

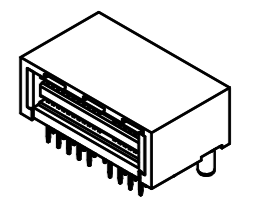

M 1:1

Lochbild für Leiterplatte (Bestückungsseite)
Board hole pattern (component mounting side)

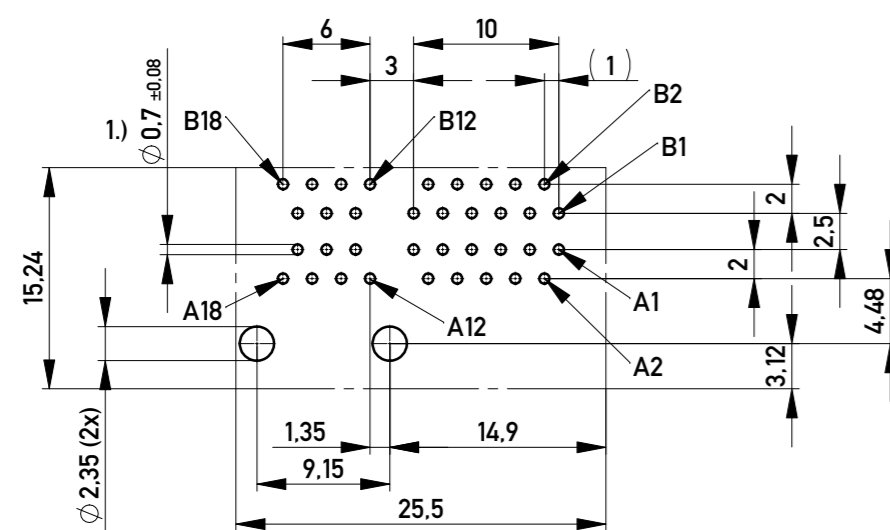

daughter card layout

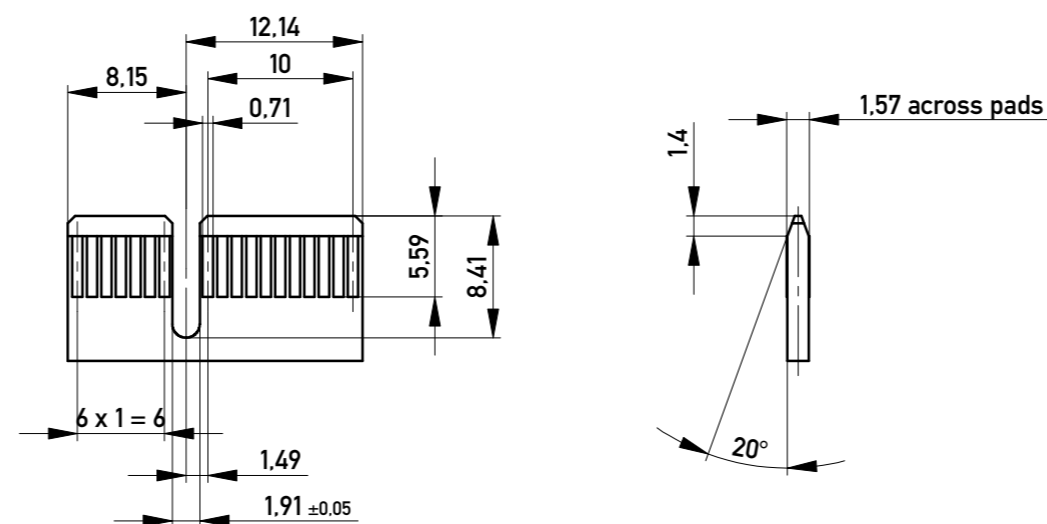

Layout proposal is in accordance with the PCI Express spezifikation

9.4	5.84	2.54
Maß "A" Dim "A"	Maß "B" Dim "B"	Maß "C" Dim "C"

Information: All rights reserved. Only for Information. To ensure that this is the latest version of this drawing, please contact one of the ERNI companies before using.	Tolerances All Dimensions in mm	Scale 5:1		
		Designation Abgew. PCI Express STV 36pol. RT. Angle PCI Express 36 pins		
f Index	Date 04.11.2011	www.ERNI.com	100101710001	K
				A2
Class PCIEXP				