

PART NUMBER	INDUCTANCE MIN. (μ H)	INDUCTANCE NOM. (μ H)	INDUCTANCE MAX. (μ H)	MIN. Q @ INDUCTANCE NOM.	COLOR
LIM10-3-09	.404	.550	.693	86 @ 40MHz	Wht
LIM10-3-10	.460	.624	.788	90 @ 40MHz	Blk
LIM10-3-11	.515	.708	.900	78 @ 40MHz	Brn
LIM10-3-12	.578	.764	.950	84 @ 40MHz	Red
LIM10-3-13	.673	.845	1.02	84 @ 40MHz	Orn
LIM10-3-14	.726	.908	1.09	82 @ 40MHz	Yel
LIM10-3-15	.803	.978	1.15	90 @ 40MHz	Grn
LIM10-3-16	.891	1.08	1.27	74 @ 40MHz	Blu
LIM10-3-17	1.01	1.18	1.34	74 @ 40MHz	Vio
LIM10-3-18	1.10	1.25	1.40	92 @ 40MHz	Gray
LIM10-3-19	1.20	1.32	1.44	98 @ 40MHz	Wht
LIM10-3-20	1.30	1.40	1.50	92 @ 40MHz	Blk

Tunable 10mm Coils

LIM10-3 Insert Molded Unshielded

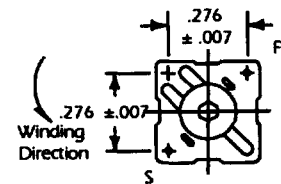
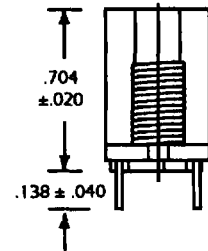
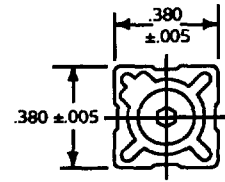

PART NUMBER	INDUCTANCE MIN. (μ H)	INDUCTANCE NOM. (μ H)	INDUCTANCE MAX. (μ H)	MIN. Q @ INDUCTANCE NOM.	COLOR
LIMS10-3-09	.315	.369	.423	80 @ 40MHz	Wht
LIMS10-3-10	.355	.416	.477	82 @ 40MHz	Blk
LIMS10-3-11	.396	.468	.540	78 @ 40MHz	Brn
LIMS10-3-12	.433	.509	.585	80 @ 40MHz	Red
LIMS10-3-13	.475	.556	.637	80 @ 40MHz	Orn
LIMS10-3-14	.515	.604	.693	78 @ 40MHz	Yel
LIMS10-3-15	.583	.660	.738	80 @ 40MHz	Grn
LIMS10-3-16	.638	.720	.801	76 @ 40MHz	Blu
LIMS10-3-17	.693	.770	.846	76 @ 40MHz	Vio
LIMS10-3-18	.754	.814	.874	82 @ 40MHz	Gray
LIMS10-3-19	.792	.846	.900	80 @ 40MHz	Wht
LIMS10-3-20	.847	.896	.945	74 @ 40MHz	Blk

LIMS10-3 Insert Molded Shielded

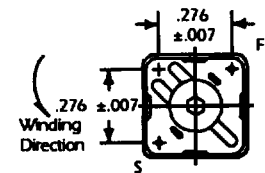
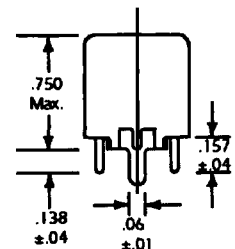
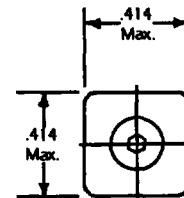

Wire: AWG#22 Single Polyurethane

Core: 10-32 (.180 x 32 TPI) Hex Hole

Testing:

1. Inductance and Q measured on Q meter HP4342A. Attach 1/2" AWG #16 TWC soldered along full length of the coil leads. Then bend at 90°, 1/4" from bottom of lead.

2. Inductance min. is measured with core flush to top of form.

3. All inductance values read at recommended Q meter frequency.

All information contained in this document is furnished for the sole purpose of identifying and suggesting the nature of the products' specifications and does not warrant the nature or quality of the products. Specifications are subject to change without notice.



800/854-1881