

DASH NO.	M CODE	MADE FROM
----------	--------	-----------

GSD

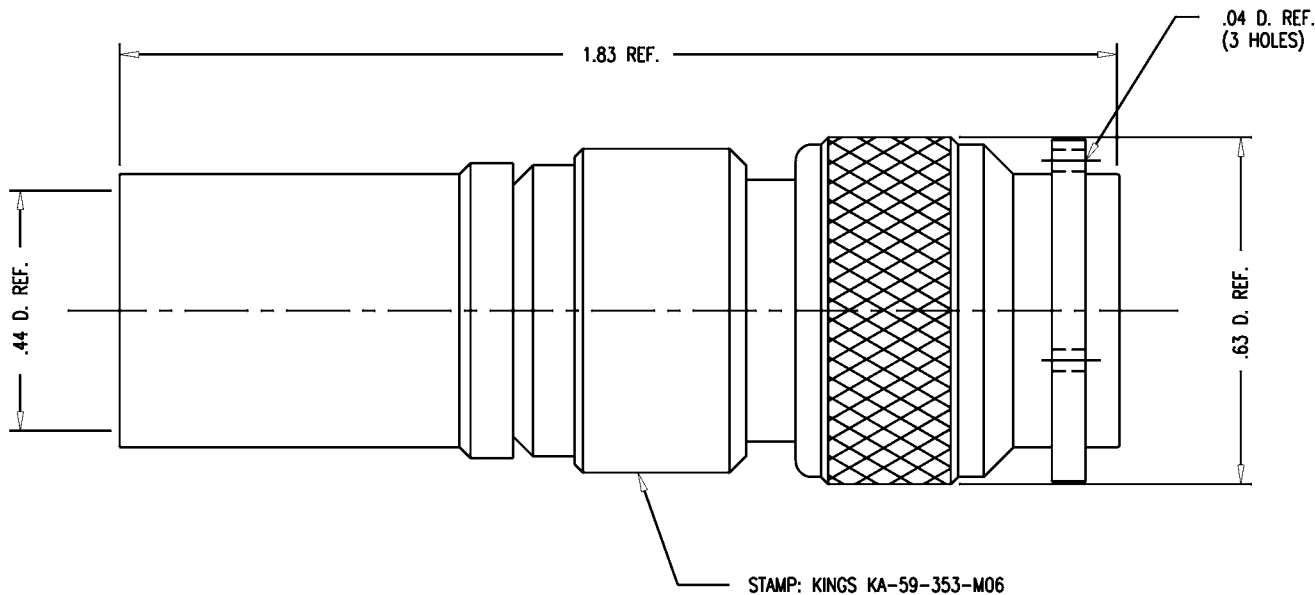

NOTES:

- FOR USE WITH RG-393/U CABLE.
- FOR CABLE TRIMMING USE KTJ-150 AND KTD-138.
- FOR CRIMPING USE DIE SIZE KTH-2105.
- FOR CABLING INSTRUCTIONS SEE CP-5402.
- CENTER CONTACT TO BE SUPPLIED UNASSEMBLED.
- MATERIALS:
 INSULATOR-TEFLON, L-P-403
 GASKET-SILICONE RUBBER, ZZ-R-765
 K-GRIP SLEEVE-COMMERCIAL BRONZE TUBE, ALLOY 220
 C-RING-PHOSPOR BRONZE, QQ-B-750
 OUTER CONTACT-BER. COP., QQ-C-530
 ALL OTHER METAL PARTS-BRASS, QQ-B-626
- FINISHES:
 CENTER CONTACT-.00005 HARD GOLD PLATE PER MIL-G-45204
 ALL OTHER METAL PARTS-KINGS TARNISH RESISTANT FINISH (TR-5)
- ELECTRIAL CHARACTERISTICS:
 NOMINAL IMPEDANCE-50 OHMS
 FREQUENCY RANGE-DC TO 11 GHZ
 WORKING VOLTAGE-500 VRMS
- MARK PACKAGE: KINGS KA-59-353-M06
 XXXX (DATE CODE)

KA-59-353-M06

REVISIONS	
ISSUE	CHANGES
3	CN 31109 A AJ 14 SEP 89

SCALE 4:1	
APPROX SURFACE AREA	
WAS: E-11379	
USED ON	
REF:	
TNC PLUG	
DRAWN KH	DATE 05/29/90
DESIGN MJB	DATE 05/30/90
APPR.	DATE

 ELECTRONICS CO., INC.
 TUCKAHOE, NEW YORK 10707

KA-59-353-M06

GSD