

SOLDER SUFFIX	CUSTOMER TERMINAL	RoHS	LEAD(Pb)-FREE
LF1	Sn96%, Ag4%	Yes	Yes

TERM. NO.'s FOR REF. ONLY
CUSTOMER TERM. NO.'s IN ()

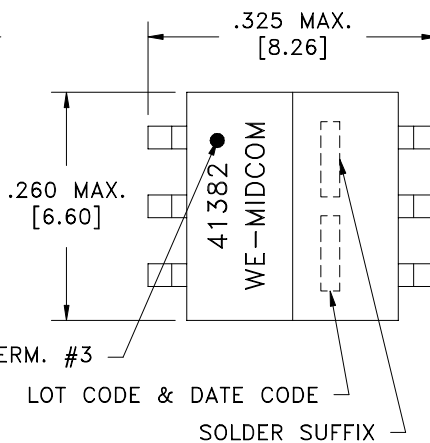
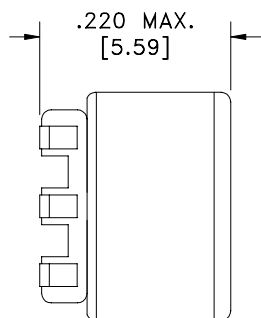
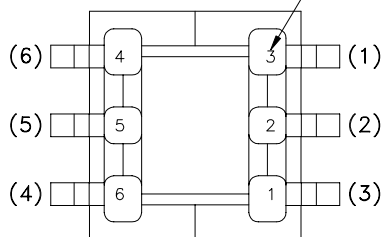

DOT LOCATES TERM. #3

LOT CODE & DATE CODE

SOLDER SUFFIX

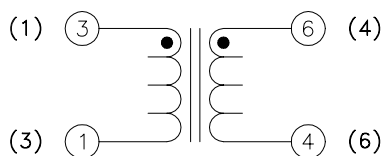

AREA REPRESENTS
TERMINAL PAD DIMENSIONS

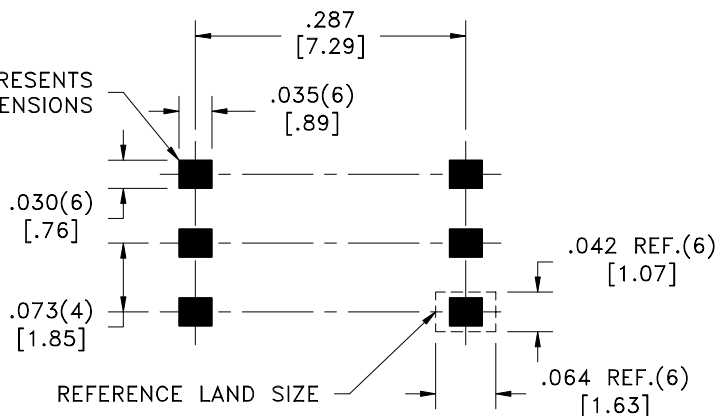

REFERENCE LAND SIZE

CUSTOMER TO DETERMINE LAND LAYOUT

ELECTRICAL SPECIFICATIONS @ 25°C unless otherwise noted:

- D.C. RESISTANCE (@20°C): 3-1, 1.25 ohms ±15%.
6-4, 1.50 ohms ±15%.
- DIELECTRIC RATING: 500VAC, 1 minute tested by applying 625VAC for 1 second between 3-6.
- INDUCTANCE: 59.3uH ±5%, 10kHz, 100mVAC, 3-1, Ls.
- TURNS RATIO: (3-1):(6-4) = 1:1, ±1%.
- OPERATING TEMPERATURE RANGE: -40°C to +85°C.

DETAILS SUBJECT TO CHANGE

Midcom, Inc.
Watertown, SD USA
Toll Free: 800-643-2661
Fax: 605-886-4486

Unless otherwise specified:
Tolerances: Fractions: ±1/64
Angles: ±1° Decimals: ±.005[.13]

DRAWING TITLE

INDUCTOR

REVISIONS: SEE SHEET 1

Midcom

DRAWING NO.

41382R-LF1

SCALE ---

REV.

6A
3/07

SHEET 2 OF 5

DWG # 41382R-LF1

This drawing is dual dimensioned.
Dimensions in brackets are in millimeters.