

SCHEMATIC

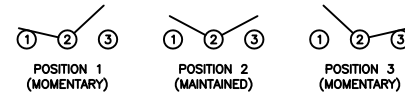

SPECIFICATIONS

FUNCTION:
1P2T (ON)-OFF-(ON)

RATINGS:
ANSI/UL 1054 and CAN/CSA C22.2 No. 55 (E194579):
11A 125VAC [cURus]
5.5A 250VAC [cURus]

CONTACT RESISTANCE:
Initial: 30mΩ Max. at 50VAC

INSULATION RESISTANCE:
500MΩ Min. at 500VDC

DIELECTRIC STRENGTH:
1,000VAC For 1 Minute

ELECTRICAL LIFE:
6,000 Cycles [cURus]

TEMPERATURE:
Operating: -20°C to 55°C [cURus]

APPROVALS:
 UL **RoHS**
COMPLIANT

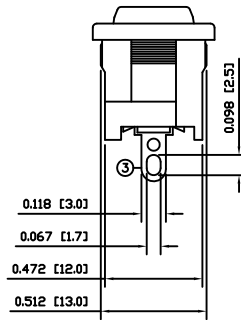
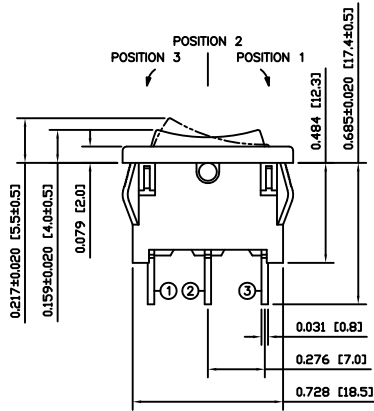
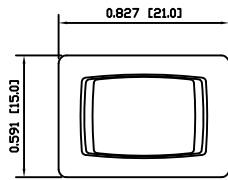

COLORS AND MARKINGS

BODY:
Black

ACTUATOR:
Black

MARKING:
None

MARKING COLOR:
None

MATERIALS

BODY:
Polyamide 6/6 (PA66), UL94 V-2

ACTUATOR:
Polyamide 6/6 (PA66), UL94 V-2

SPRING:
Steel

PLUNGER:
Polyamide 6/6 (PA66), UL94 V-2

MOBILE CONTACT:
Silver Plated Copper

CONTACTS:
Silver Alloy Over Copper

TERMINALS:
Silver Plated Brass

SUGGESTED PANEL CUTOUT

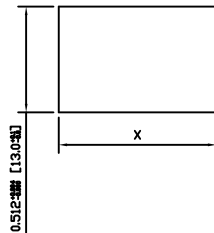

| PANEL THICKNESS | X |
|-------------------------|--------------|
| 0.020~0.049 [0.50~1.25] | 0.764 [19.4] |
| 0.049~0.079 [1.25~2.00] | 0.775 [19.7] |
| 0.079~0.118 [2.00~3.00] | 0.787 [20.0] |

| ACTUATOR | A | 09/07/28 | CAB |
|----------------|------|----------|-----|
| BODY | A | 09/07/28 | CAB |
| COLORS | A | 09/07/28 | CAB |
| MATERIALS | A | 09/07/28 | CAB |
| SPECIFICATIONS | B | 11/03/28 | CAB |
| REFERENCE | REV. | DATE | BY |

THE INFORMATION CONTAINED IN THIS DOCUMENT IS PROPRIETARY TO E-SWITCH-LAMB INDUSTRIES AND IS NOT TO BE COPIED OR TRANSFERRED

| B | REMOVED VDE RATING | 19793 | 11/03/28 | CAB |
|------|--------------------|----------|----------|----------|
| A | INITIAL RELEASE | PCRD0152 | 09/11/25 | CAB |
| REV. | DESCRIPTION | PCR | DATE | DRAWN BY |

| DIMENSIONS | |
|----------------------|------------|
| INCHES [MILLIMETERS] | |
| GENERAL TOLERANCES | |
| ±0.008 [±0.2] / ±1' | |
| SCALE | PROJECTION |
| DRAWING NOT TO SCALE | 1st Angle |

| | | | |
|---------------|----------------|----------|--|
| | | | |
| RA12DA1100 | | | |
| ITEM NUMBER | DATE | REVISION | |
| 03-RA12DA1100 | MARCH 28, 2011 | B | |