

REV.	DESCRIPTION	DATE	BY	APPD.
D	NPR 2528	08/23/01	KJ	

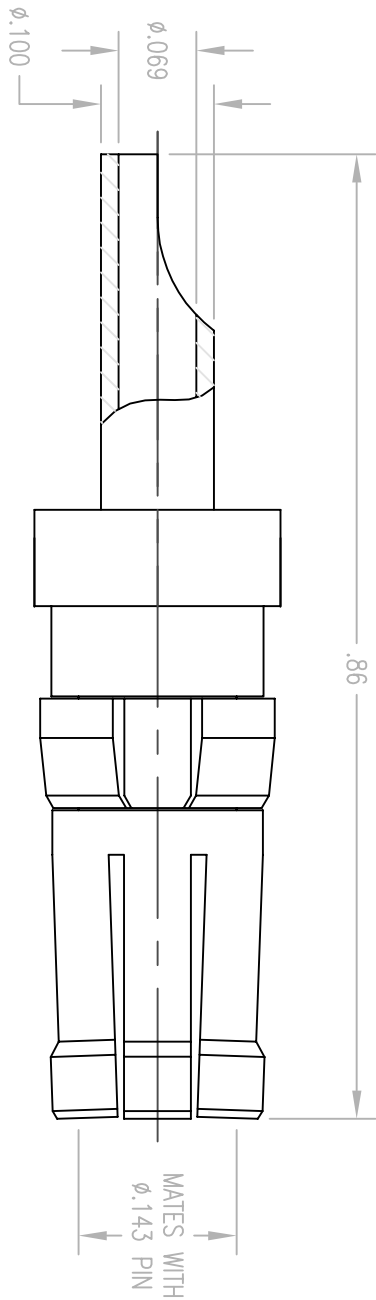

- NOTES:
1. MATERIALS:  
 BODY: COPPER ALLOY  
 CLIP RING: BERYLLIUM COPPER PER ASTM B194
  2. FINISH:  
 BODY: .000030 MIN. GOLD PER MIL-G-45204 OVER  
 .000050 MIN. NICKEL PER QQ-N-290  
 CLIP RING: .000100 MIN. NICKEL PER QQ-N-290 OVER  
 COPPER FLASH
  3. FOR USE WITH #16 AWG OR EQUIVALENT.

PER ASME Y14.5M-1994 UNLESS OTHERWISE SPECIFIED: TOLERANCES ARE IN INCHES (IN)		PER ASME Y14.5M-1994 UNLESS OTHERWISE SPECIFIED: TOLERANCES ARE IN MILLIMETERS (MM)	
DIMENSIONS ARE IN INCHES (IN)		DIMENSIONS ARE IN MILLIMETERS (MM)	
DECIMALS .XX ± .01/0.254		DECIMALS .XX ± .005/0.127	
ANGLES ± Z°		SCALE 6:1	
<b>CUSTOMER DRAWING</b>		<b>Winchester/Reticon</b>	
DRAWN KJ		CHECKED DATE	
DATE 08/23/01		DATE	
APPROVED		APPROVED	
DATE		DATE	
A		A	
221-510-0002G		SHT. 1 OF 1	
REV. D		REV. D	

**Winchester/Reticon**  
 400 Park Road  
 Waterbury, Connecticut 06705

**High Power RDM Receptacle**