

1 2 3 4 5 6 7

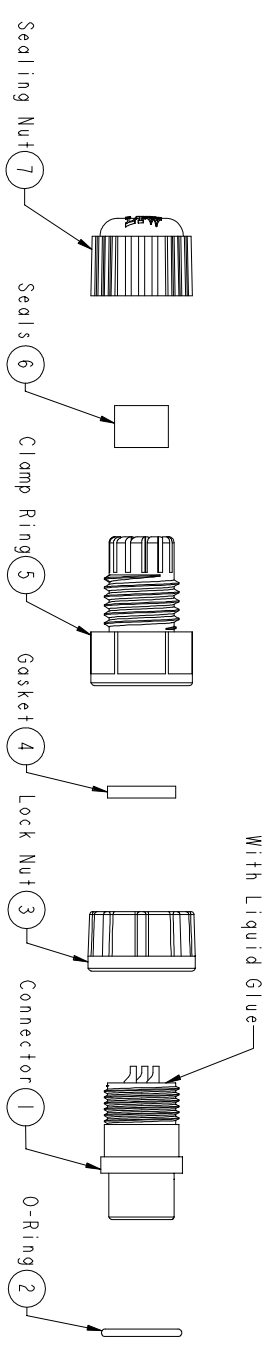

- Note:
- * \varnothing Important Dimension To Check.
 - * Waterproof Rate : IP67
 - * Housing: Nylon+GF, Black
 - * Female Pin: Copper Alloy, Gold Plated
 - * O-Ring: EPDM, Black
 - * Lock Nut: Nylon+GF, Black
 - * Gasket: EPDM, Black
 - * Seals: EPDM, Black
 - * Clamp Ring: Nylon, Black
 - * Sealing Nut: Nylon, Black
 - * Seals for Cable OD: \varnothing 4.5mm- \varnothing 6.5mm
 - * One Set Unassembled in One PE Bag

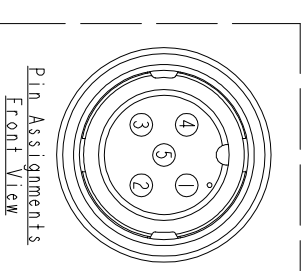
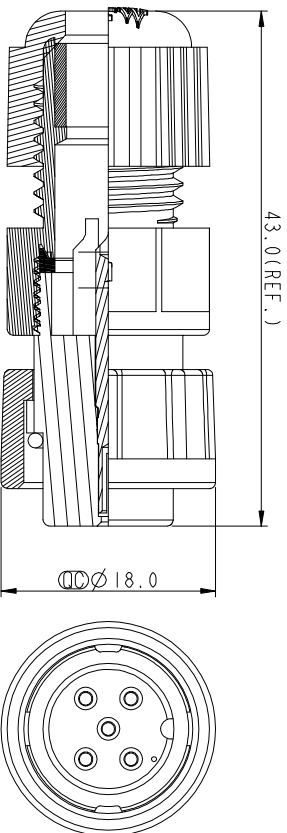

RoHS compliant

Scale	Free						
TOLERANCE							
.X	±0.25		Drawn	11.03.2014	Winnie	Drawn	11.03.2014
.XX	±0.10		Approved	11.03.2014	Winnie		
.XXX	±0.05						
Angle	±1°						

Id.	Modification	Date	Name
①	Drawn	11.03.2014	Winnie



Customer-No.	
ASSMANN WSW-No.	A-CR-05BFFA-L180-WP
Drawing-No.	ASS 6240 CO

Replace	rev00	Sheet
---------	-------	-------

A	1	2	3	4	5	6	7
B	1	2	3	4	5	6	7
C	1	2	3	4	5	6	7
D	1	2	3	4	5	6	7
E	1	2	3	4	5	6	7
F	1	2	3	4	5	6	7
G	1	2	3	4	5	6	7
H	1	2	3	4	5	6	7