

Verpackt in Gurtverpackung - Tape on Reel Packaging  
 Verpackungseinheit: 260 Stück - Packaging unit: 260 pcs

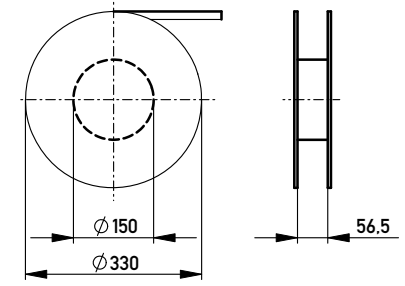

Abspulrichtung - Reel off Direction

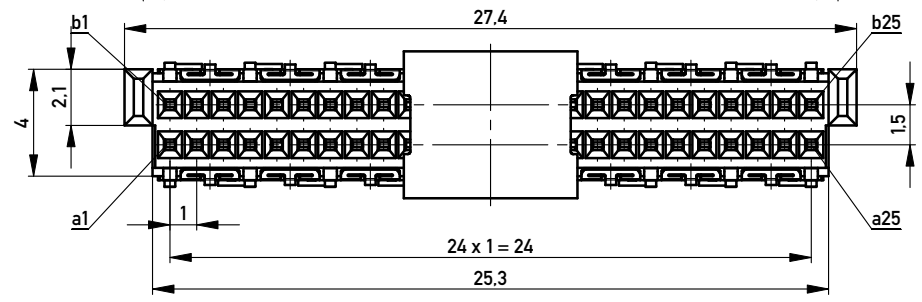

Leiterplatten-Layout Vorschlag / PCB-Layout Proposal

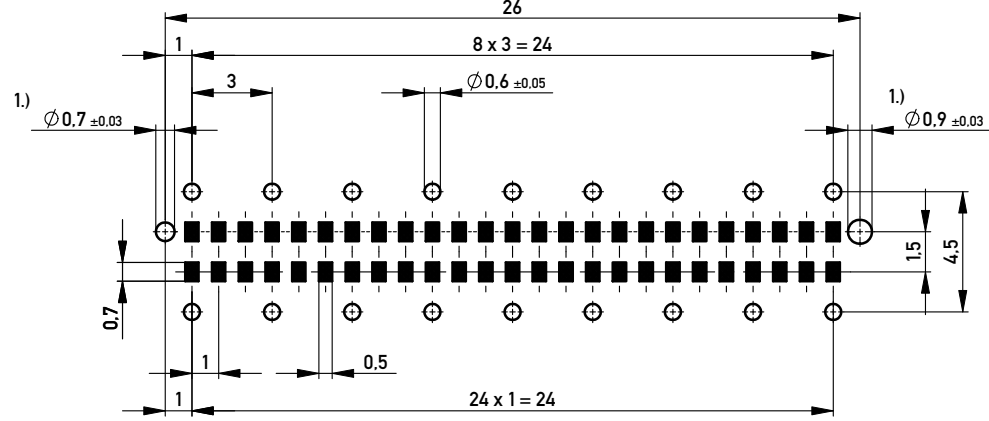

Anforderungsstufe 1  
 Performance Level 1

Kontaktbereich vergoldet  
 Mating Area gold plating

Anschlussbereich verzinkt 4-6µm  
 Terminal Area 4-6µm tin plating

Koplanarität der Anschlüsse ≤ 0,1mm  
 Coplanarity Area of Termination ≤ 0,1mm

1.) Durchmesser des Bohrers / Drill tool

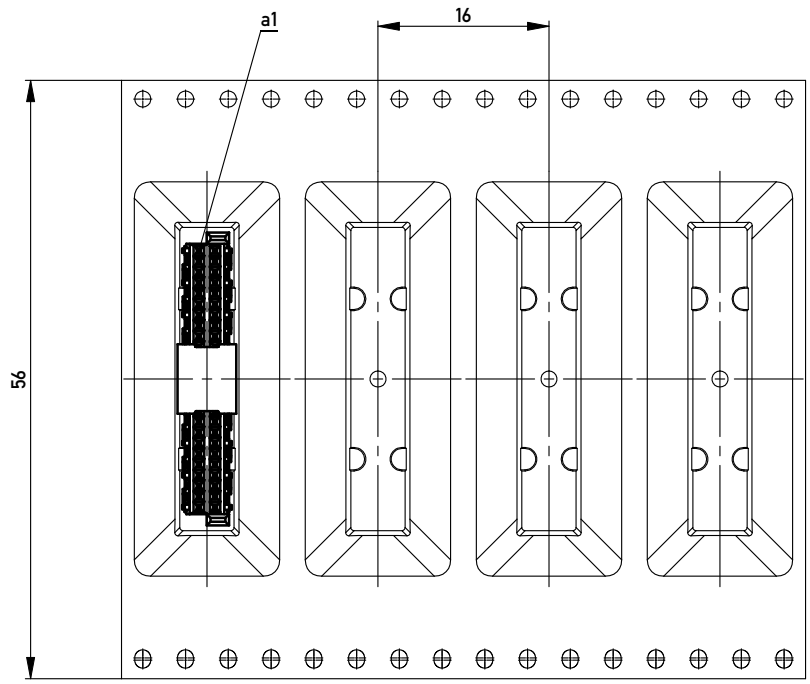

Information:	Tolerances	 All Dimensions in mm	Scale	5:1
	All rights reserved. Only for Information. To ensure that this is the latest version of this drawing, please contact one of the ERNI companies before using.			
Subject to modification without prior notice. Drawing will not be updated.	Designation			F10 MSpeed BlindMate 50 THR
	www.ERNI.com			354181
a	31.08.2010	Class		MSPEED
Index	Date			I A3

Copyright by ERNI GmbH. Proprietary notice pursuant to ISO 16106 to be observed.