

Rev	AWO #	Description	Date	Appr
-		RELEASED	11/29/10	

APPROVED: _____
 DATE: _____ TITLE: _____

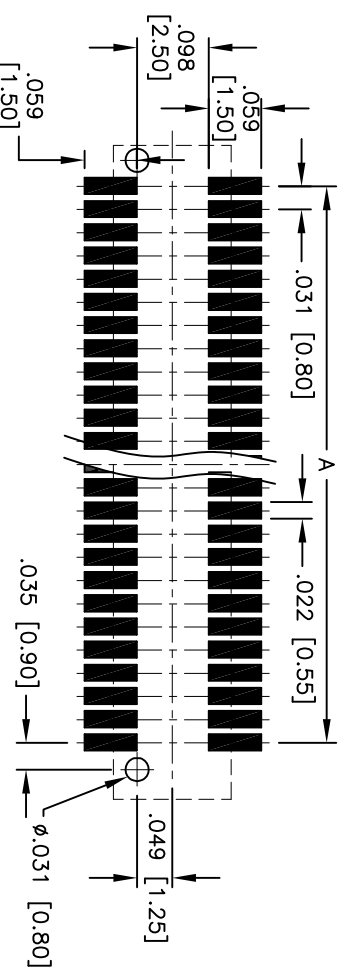
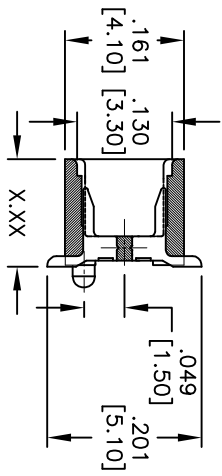
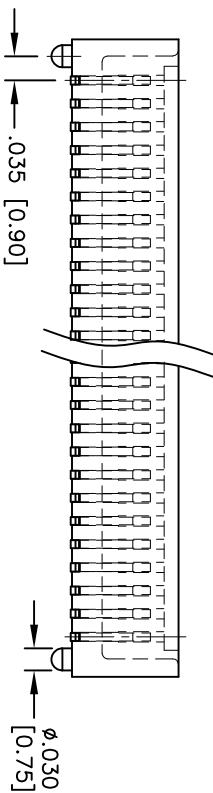
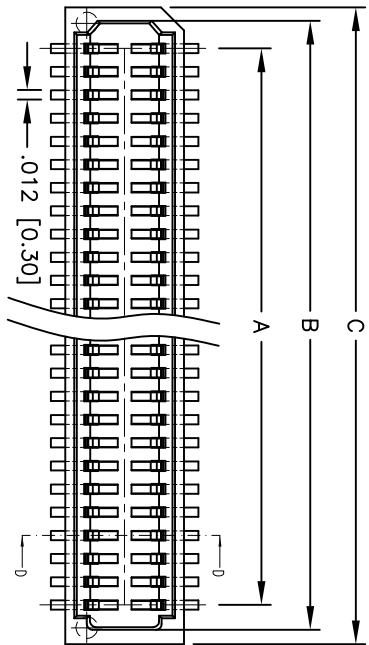

RECOMMENDED PCB LAYOUT

ADAM P/N	X.XX
BB8-SL-XXX-G-3.55-T/R	1.40 [3.55]
BB8-SL-XXX-G-5.05-T/R	1.99 [5.05]
BB8-SL-XXX-G-5.45-T/R	2.15 [5.45]
BB8-SL-XXX-G-6.05-T/R	2.38 [6.05]

PACKAGED ON TAPE & REEL

SPECIFICATIONS:
 Material: Insulator: Hi-Temp thermoplastic, rated UL 94V-0
 Insulator color: Natural
 Contacts: Copper Alloy
 Plating: Gold flash over Nickel underplate overall

Electrical:
 Operating voltage: 50 VAC max.
 Current rating: 0.5 Amps max.
 Contact resistance: 40 mohms max. initial
 Insulation resistance: 100 Mohms min
 Dielectric withstanding voltage: 500 VAC for 1 minute
 Temperature Rating: Operating temperature: -20°C to +105°C
 Environmental: Lead free, RoHS compliant
 Recommended soldering temp: 260°C for 5 seconds



Position: 10 thru 100
 A = .031 [0.80] x (No. of Contacts/2 - 1) + .063 [1.60]
 B = .031 [0.80] x (No. of Contacts/2 - 1)
 C = .031 [0.80] x (No. of Contacts/2 - 1) + .126 [3.20]

UNLESS OTHERWISE SPECIFIED
 ALL DIMENSIONS ARE IN INCHES [MM]
 TOLERANCES: EXCEPT AS NOTED
 INCHES HILES
 .X ± .10 ØXX ± .10
 .XX ± .020 ØXXX ± .015
 .XXX ± .015 ØXXXX ± .010

ADAM TECH
 909 Rahway Avenue, Union, NJ 07083
 Phone: 908-687-5000 Fax: 908-687-5710
 TITLE: .031 [0.80] PITCH BOARD TO BOARD
 SOCKET CONNECTOR, SMT TYPE

DRAWN	AY	11/29/10	SIZE	PART NO.	REV.
CHECKED	JL	11/29/10	X	BB8-SL-XXX-G-X-XX-T/R	-
APPROVED			REF: S00070T	SCALE: NTS	SHEET 1 OF 1