



TAI-SAW TECHNOLOGY CO., LTD.

No. 3, Industrial 2nd Rd., Ping-Chen Industrial District,
Taoyuan, 324, Taiwan, R.O.C.

TEL: 886-3-4690038 FAX: 886-3-4697532

E-mail: tstsales@mail.taisaw.com Web: www.taisaw.com

Approval Sheet For Product Specification

Issued Date: Mar, 2, 2007

Product Name: SAW Filter 165.45 MHz SMD 5.0X7.0 mm

TST Parts No.: TB0483A

Customer Parts No.: _____

Company: _____
Division: _____
Approved by : _____
Date: _____

Checked by: _____ Bob Chau

Approval by: _____ Francis Chen

Date: _____ 3, 2, 2007



TAI-SAW TECHNOLOGY CO., LTD.

No. 3, Industrial 2nd Rd., Ping-Chen Industrial District,
Taoyuan, 324, Taiwan, R.O.C.

TEL: 886-3-4690038 FAX: 886-3-4697532

E-mail: tstsales@mail.taisaw.com Web: www.taisaw.com

SAW Filter 165.45MHz

MODEL NO.:TB0483A

REV. NO.:1

A. MAXIMUM RATING:

1. Input Power Level: 15 dBm
2. DC Voltage : 5V
3. Operating Temperature: -40°C to +85°C
4. Storage Temperature: -50°C to +95°C

RoHS Compliant
Lead free
Lead-free soldering

B. ELECTRICAL CHARACTERISTICS:

Item	Unit	Min.	Type.	Max.	Note
Center frequency Fc	MHz	-	165.45	-	-
Insertion loss at center frequency ILc	dB	-	3.0	7.0	-
Ripple (165.44625~165.45375)	dB	-	±0.2	±1	-
Attenuation (relative to ILc)					
164.45 ~ 164.5525 MHz	dB	30	50	-	-
164.5525 ~ 165.35 MHz	dB	7	21	-	-
165.55 ~ 166.3475 MHz	dB	7	21	-	-
166.3475 ~ 166.45 MHz	dB	30	50	-	-
Temperature coefficient of frequency TCf		-0.034 ppm/C ²			

Note1. Considering -20 KHz frequency shift from -40°C to +85°C

C.OUTLINE DRAWING:

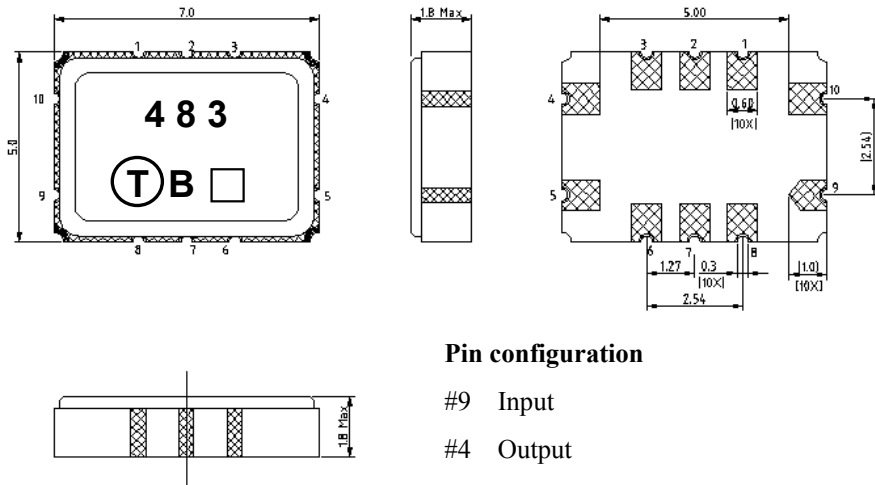

Pin configuration

- #9 Input
- #4 Output
- #10 Balance input or input ground
- #5 Balance output or output ground
- #1,2,3,6,7,8 To be grounded
- Date code
- Unit mm

Product Year Code

Year	2001	2002	2003	2004
	2005	2006	2007	2008
Product Code	B	b	<u>B</u>	<u>b</u>

D. MEASUREMENT CIRCUIT:

50 Ohm Test circuit (single-ended / single-ended)

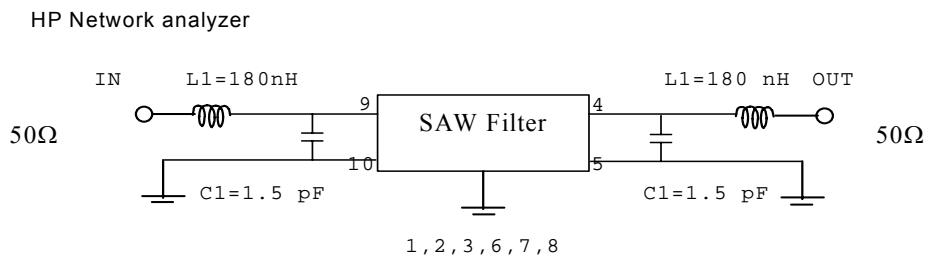

E. PCB Footprint:

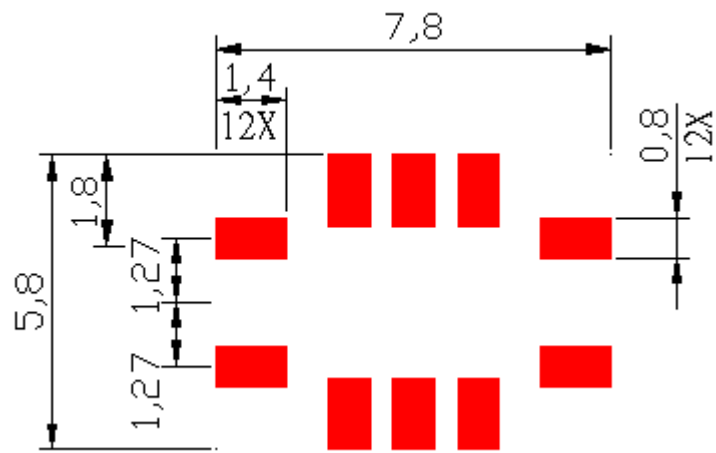

F. Frequency Characteristics :

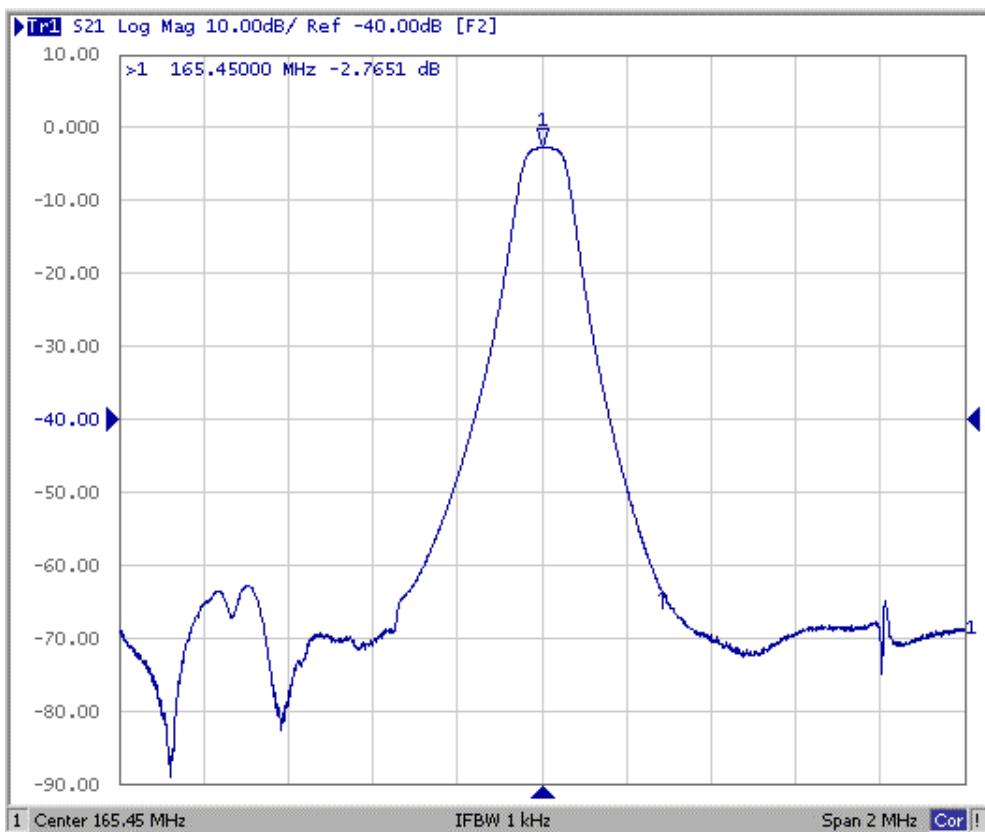
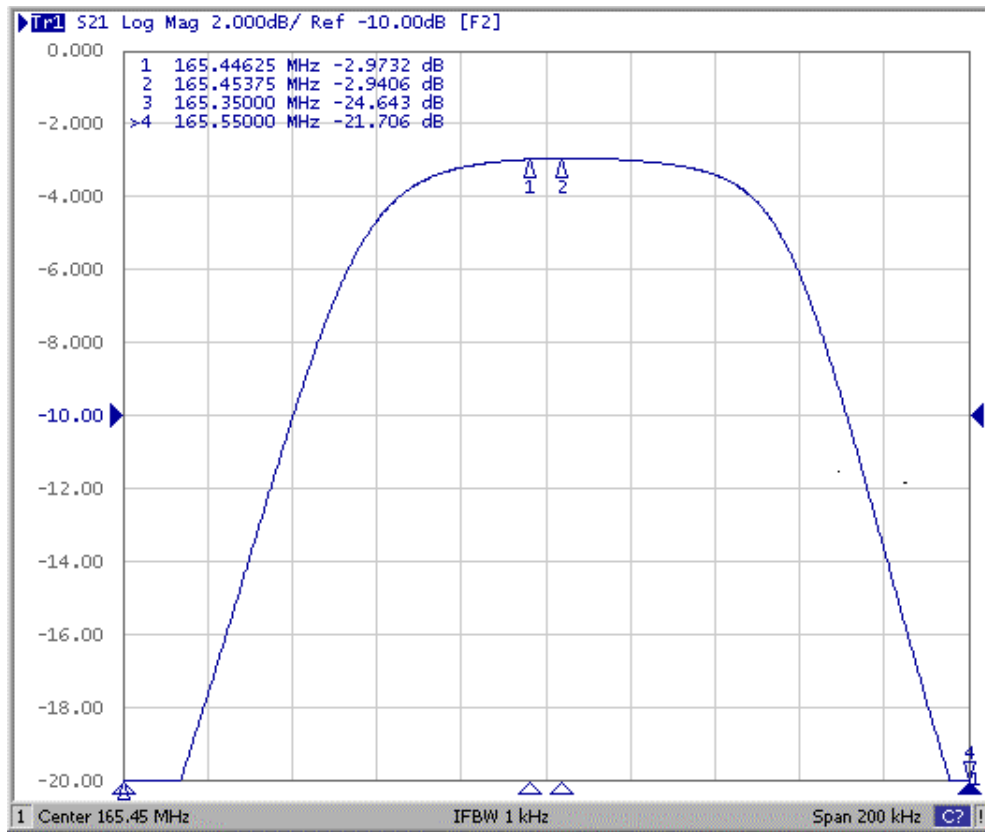

G. PACKING:
1. REEL DIMENSION

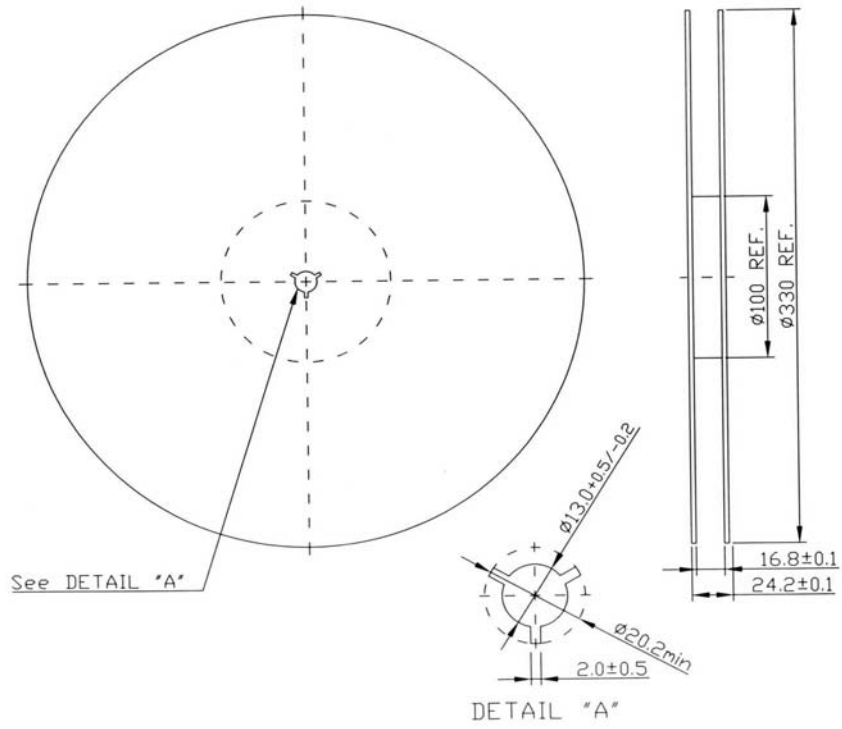

2. TAPE DIMENSION

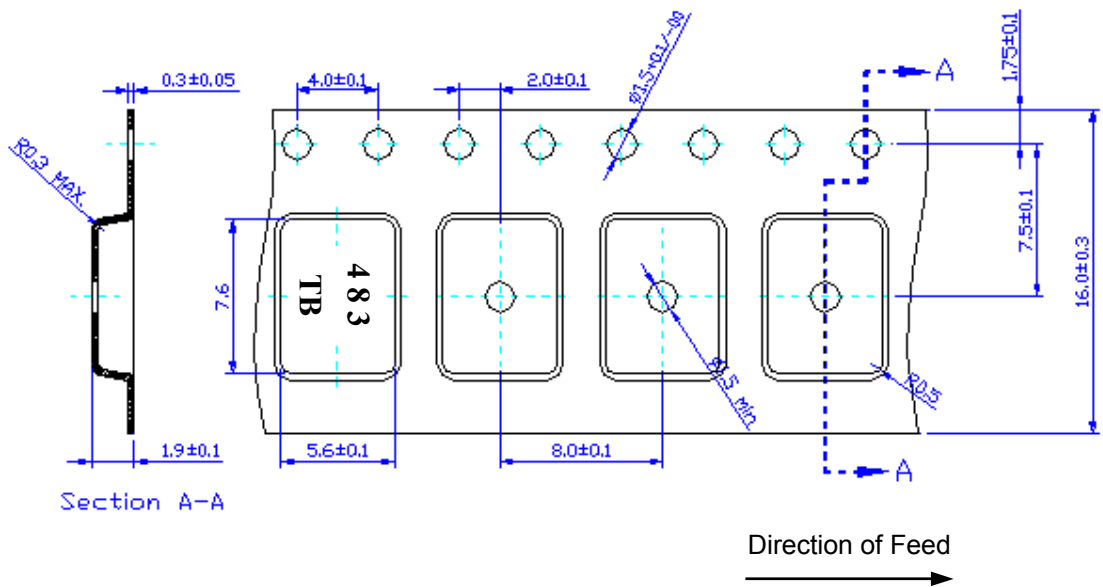

H. RECOMMENDED REFLOW PROFILE :

