



TAI-SAW TECHNOLOGY CO., LTD.

No. 3, Industrial 2nd Rd., Ping-Chen Industrial District,
Taoyuan, 324, Taiwan, R.O.C.

TEL: 886-3-4690038 FAX: 886-3-4697532

E-mail: tstsales@mail.taisaw.com Web: www.taisaw.com

Product Specifications Approval Sheet

Product Name: SAW Filter 1582.4MHz (BW 46.61MHz) SMD 3.0x3.0 mm

TST Parts No.: TA1658A

Customer Parts No.: _____

Company: _____
Division: _____
Approved by : _____
Date: _____

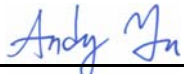
Checked by: _____ Andy Yu 

Approval by: _____ Bob Chau 

Date: _____ 2013/11/26

1. Customer signed back is required before TST can proceed with sample build and receive orders.
2. Orders received without customer signed back will be regarded as agreement on the specifications.
3. Any specifications changes must be approved upon by both parties and a new revision of specifications shall be released to reflect the changes



TAI-SAW TECHNOLOGY CO., LTD.

No. 3, Industrial 2nd Rd., Ping-Chen Industrial District,
Taoyuan, 324, Taiwan, R.O.C.

TEL: 886-3-4690038 FAX: 886-3-4697532

E-mail: tstsales@mail.taisaw.com Web: www.taisaw.com

SAW Filter 1582.4MHz (BW 46.61MHz) SMD 3.0x3.0 mm

MODEL NO.:TA1658A

REV. NO.:1.0

A. MAXIMUM RATING:

1. Input Power Level: 15 dBm
2. DC Voltage : 3V
3. Operating Temperature: -40°C to +85°C
4. Storage Temperature: -40°C to +85°C

RoHS Compliant
Lead free
Lead-free soldering

Electrostatic Sensitive Device (ESD)

B. ELECTRICAL CHARACTERISTICS:

AEC-Q200

Item	Unit	Min.	Type.	Max.	Note
Center Frequency Fc	MHz	-	1582.4	-	-
Insertion Loss IL					
1)1574.42 ~ 1576.42 MHz	dB		1.2	2.0	
2)1559.05 ~ 1563.15 MHz			1.7	2.2	
3)1573.37 ~ 1577.47 MHz			1.3	2.0	
4)1597.78 ~ 1605.66 MHz			1.5	2.0	
GD Ripple (1597.55~1605.89 MHz)	dB	-	5	12	-
VSWR		-	-	-	
1)1574.42 ~ 1576.42 MHz	-	-	1.6	2.0	
2)1559.05 ~ 1563.15 MHz			1.3	2.0	-
3)1573.37 ~ 1577.47 MHz			1.7	2.0	
4)1597.78 ~ 1605.66 MHz			1.4	2.0	
Attenuation					
10 ~ 824 MHz	dB	30	38	-	-
824 ~ 925 MHz	dB	30	37	-	-
1427 ~ 1453 MHz	dB	40	47	-	-
1710 ~ 1785 MHz	dB	37	45	-	-
1850 ~ 1910 MHz	dB	38	47	-	
1920 ~ 1980 MHz	dB	39	49	-	
2400 ~ 2500 MHz	dB	35	45	-	
2500 ~ 2570 MHz	dB	37	45	-	
2600 ~ 3000 MHz	dB	20	41	-	

C.OUTLINE DRAWING:

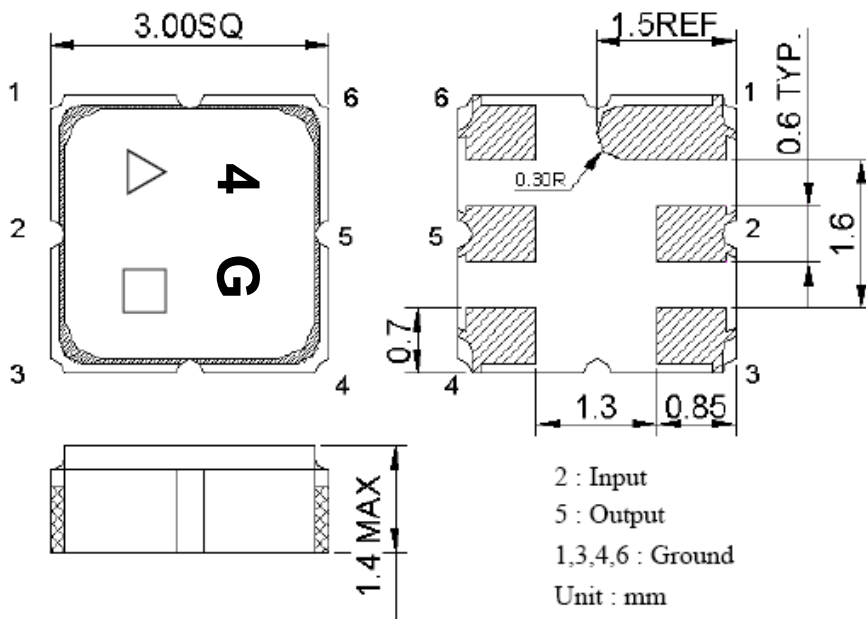

△ : Year Code (2009->9, 2010->0, ..., 2018->8)
 □ : Date Code (Follow the table from planner each year)

D. MEASUREMENT CIRCUIT:

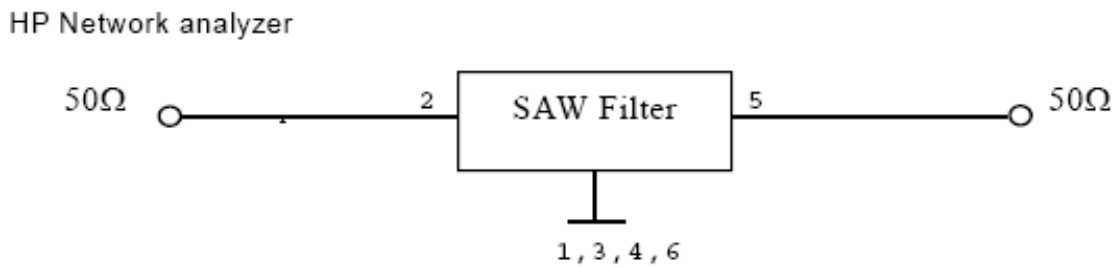

E. Frequency Characteristics :

S21 response: (span 500MHz)

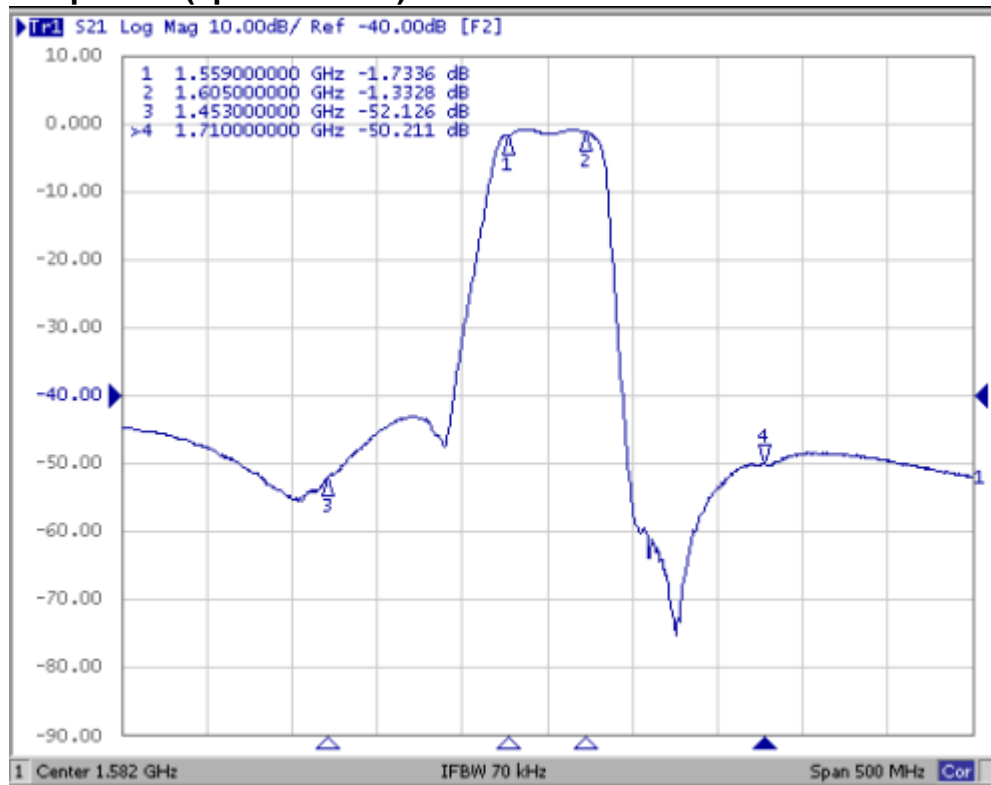

S21 response: (span 100MHz)

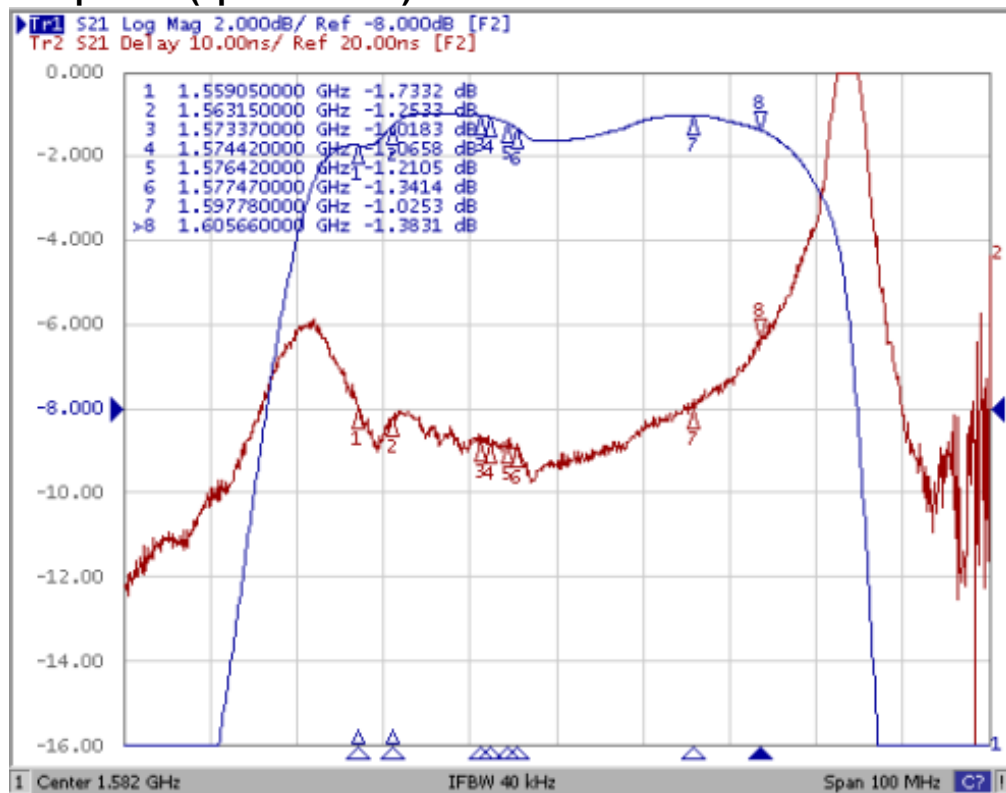

Sd21 response: (span 3000MHz)

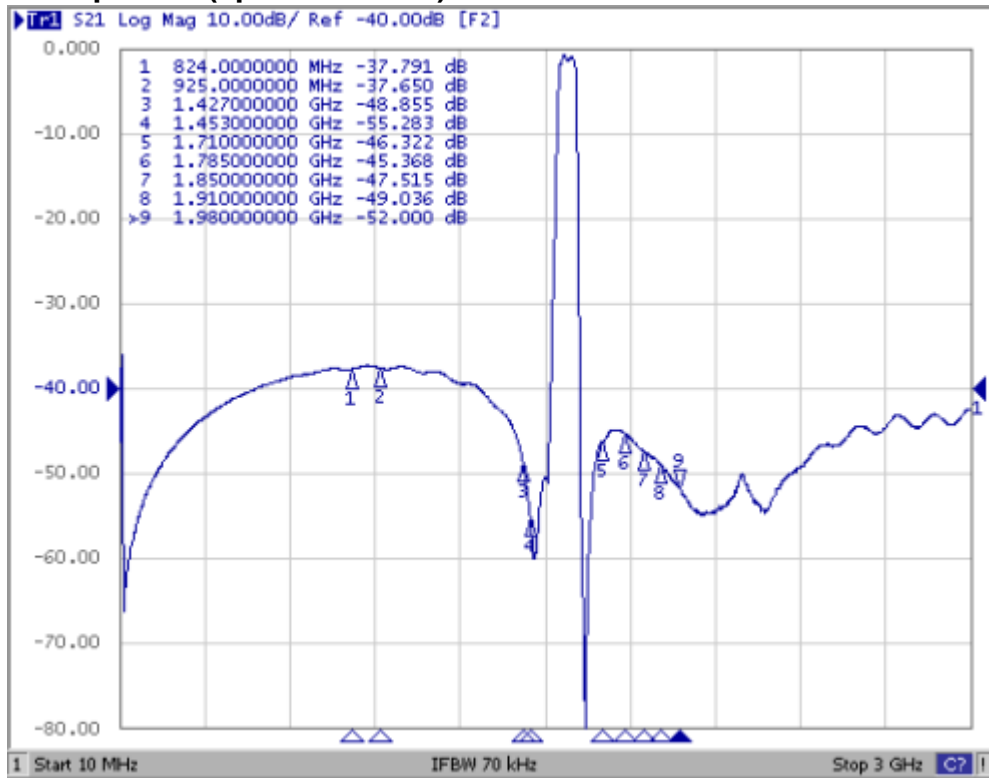

S11&S22 VSWR: (span 100MHz)

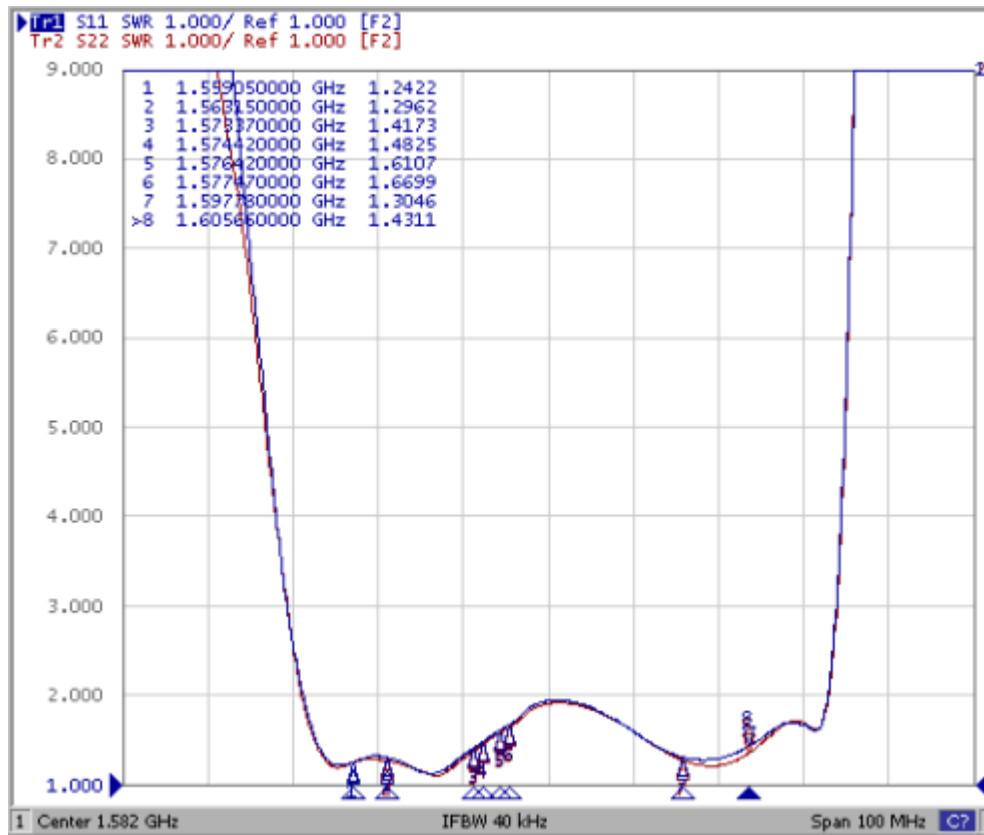

F. PACKING:

1. REEL DIMENSION

(Please refer to FR-75D10 for packing quantity)

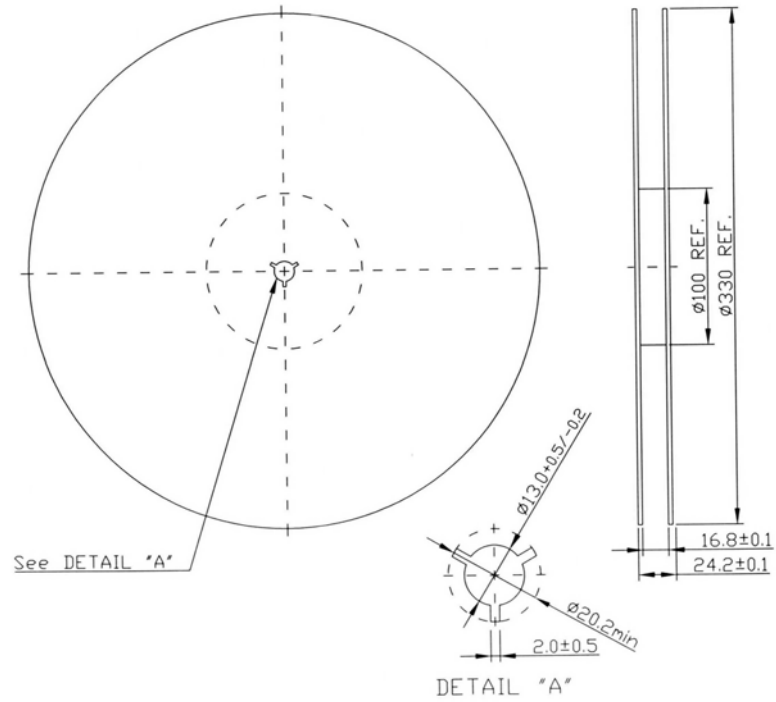

2. TAPE DIMENSION

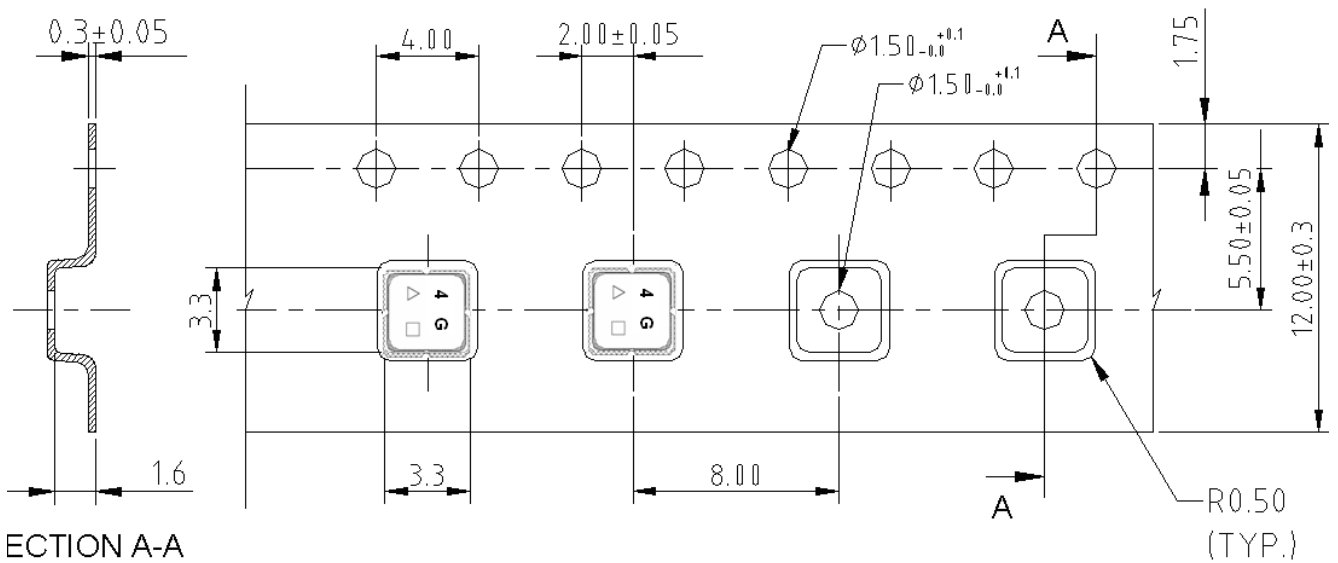

G. PCB Footprint:

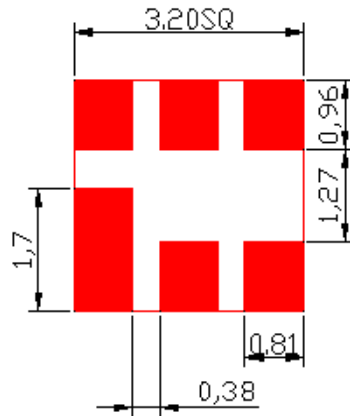

H. RECOMMENDED REFLOW PROFILE :

