

MCR12D, MCR12M, MCR12N

Preferred Device

Silicon Controlled Rectifiers

Reverse Blocking Thyristors

Designed primarily for half-wave ac control applications, such as motor controls, heating controls, and power supplies; or wherever half-wave silicon gate-controlled devices are needed.

- Blocking Voltage to 800 Volts
- On-State Current Rating of 12 Amperes RMS at 80°C
- High Surge Current Capability — 100 Amperes
- Rugged, Economical TO220AB Package
- Glass Passivated Junctions for Reliability and Uniformity
- Minimum and Maximum Values of IGT, VGT and IH Specified for Ease of Design
- High Immunity to dv/dt — 100 V/μsec Minimum at 125°C
- Device Marking: Logo, Device Type, e.g., MCR12D, Date Code

MAXIMUM RATINGS (T_J = 25°C unless otherwise noted)

Rating	Symbol	Value	Unit
Peak Repetitive Off-State Voltage ⁽¹⁾ (T _J = -40 to 125°C, Sine Wave, 50 to 60 Hz, Gate Open)	V _{DRM} , V _{RRM}		Volts
MCR12D		400	
MCR12M		600	
MCR12N		800	
On-State RMS Current (180° Conduction Angles; T _C = 80°C)	I _{T(RMS)}	12	A
Peak Non-repetitive Surge Current (1/2 Cycle, Sine Wave 60 Hz, T _J = 125°C)	I _{TSM}	100	A
Circuit Fusing Consideration (t = 8.33 ms)	I ² t	41	A ² sec
Forward Peak Gate Power (Pulse Width ≤ 1.0 μs, T _C = 80°C)	P _{GM}	5.0	Watts
Forward Average Gate Power (t = 8.3 ms, T _C = 80°C)	P _{G(AV)}	0.5	Watts
Forward Peak Gate Current (Pulse Width ≤ 1.0 μs, T _C = 80°C)	I _{GM}	2.0	A
Operating Junction Temperature Range	T _J	-40 to +125	°C
Storage Temperature Range	T _{stg}	-40 to +150	°C

(1) V_{DRM} and V_{RRM} for all types can be applied on a continuous basis. Ratings apply for zero or negative gate voltage; positive gate voltage shall not be applied concurrent with negative potential on the anode. Blocking voltages shall not be tested with a constant current source such that the voltage ratings of the devices are exceeded.



KERSEMI

www.kersemi.com

SCRs
12 AMPERES RMS
400 thru 800 VOLTS

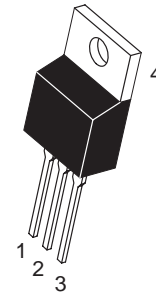

TO-220AB
CASE 221A
STYLE 3

PIN ASSIGNMENT

Pin	Assignment
1	Cathode
2	Anode
3	Gate
4	Anode

ORDERING INFORMATION

Device	Package	Shipping
MCR12D	TO220AB	50 Units/Rail
MCR12M	TO220AB	50 Units/Rail
MCR12N	TO220AB	50 Units/Rail

Preferred devices are recommended choices for future use and best overall value.

MCR12D, MCR12M, MCR12N

THERMAL CHARACTERISTICS

Characteristic	Symbol	Value	Unit
Thermal Resistance — Junction to Case — Junction to Ambient	$R_{\theta JC}$ $R_{\theta JA}$	2.2 62.5	$^{\circ}C/W$
Maximum Lead Temperature for Soldering Purposes 1/8" from Case for 10 Seconds	T_L	260	$^{\circ}C$

ELECTRICAL CHARACTERISTICS ($T_J = 25^{\circ}C$ unless otherwise noted)

Characteristic	Symbol	Min	Typ	Max	Unit
----------------	--------	-----	-----	-----	------

OFF CHARACTERISTICS

Peak Repetitive Forward or Reverse Blocking Current ($V_D = \text{Rated } V_{DRM} \text{ and } V_{RRM}$; Gate Open)	I_{DRM} , I_{RRM}	— —	— —	0.01 2.0	mA
					$T_J = 25^{\circ}C$ $T_J = 125^{\circ}C$

ON CHARACTERISTICS

Peak Forward On-State Voltage* ($I_{TM} = 24 \text{ A}$)	V_{TM}	—	—	2.2	Volts
Gate Trigger Current (Continuous dc) ($V_D = 12 \text{ V}$; $R_L = 100 \Omega$)	I_{GT}	2.0	8.0	20	mA
Holding Current ($V_D = 12 \text{ V}$, Gate Open, Initiating Current = 200 mA)	I_H	4.0	20	40	mA
Latch Current ($V_D = 12 \text{ V}$, $I_G = 20 \text{ mA}$)	I_L	6.0	25	60	mA
Gate Trigger Voltage (Continuous dc) ($V_D = 12 \text{ V}$; $R_L = 100 \Omega$)	V_{GT}	0.5	0.65	1.0	Volts

DYNAMIC CHARACTERISTICS

Critical Rate of Rise of Off-State Voltage ($V_D = \text{Rated } V_{DRM}$, Exponential Waveform, Gate Open, $T_J = 125^{\circ}C$)	dv/dt	100	250	—	$V/\mu s$
Repetitive Critical Rate of Rise of On-State Current $I_{PK} = 50 \text{ A}$, $P_w = 40 \mu s$, $di_G/dt = 1 \text{ A}/\mu s$, $I_{gt} = 50 \text{ mA}$	di/dt	—	—	50	$A/\mu s$

*Indicates Pulse Test: Pulse Width $\leq 2.0 \text{ ms}$, Duty Cycle $\leq 2\%$.

MCR12D, MCR12M, MCR12N

Voltage Current Characteristic of SCR

Symbol	Parameter
V_{DRM}	Peak Repetitive Off State Forward Voltage
I_{DRM}	Peak Forward Blocking Current
V_{RRM}	Peak Repetitive Off State Reverse Voltage
I_{RRM}	Peak Reverse Blocking Current
V_{TM}	Peak On State Voltage
I_H	Holding Current

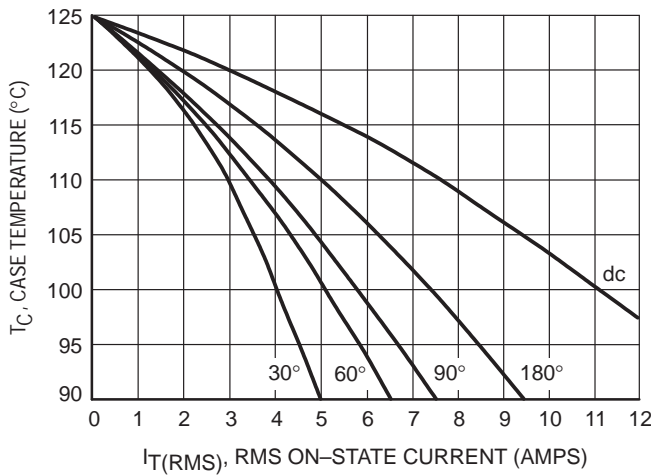
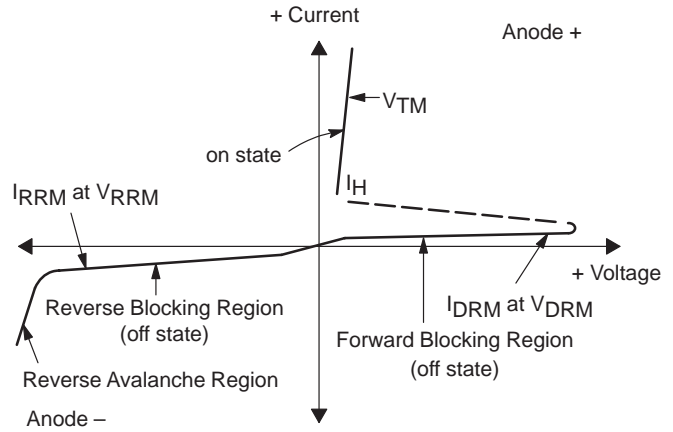

Figure 1. Typical RMS Current Derating

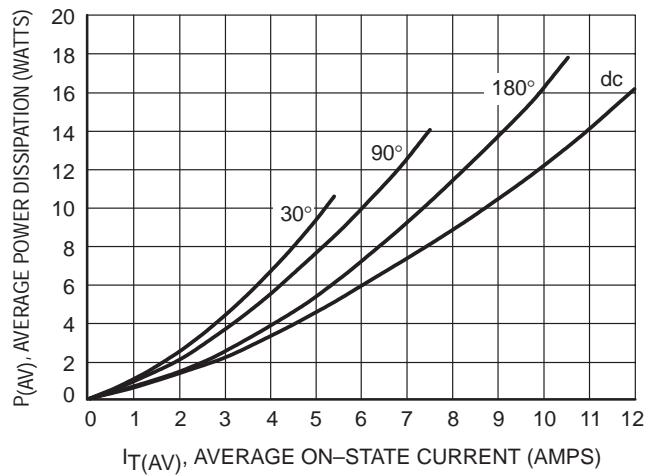

Figure 2. On-State Power Dissipation

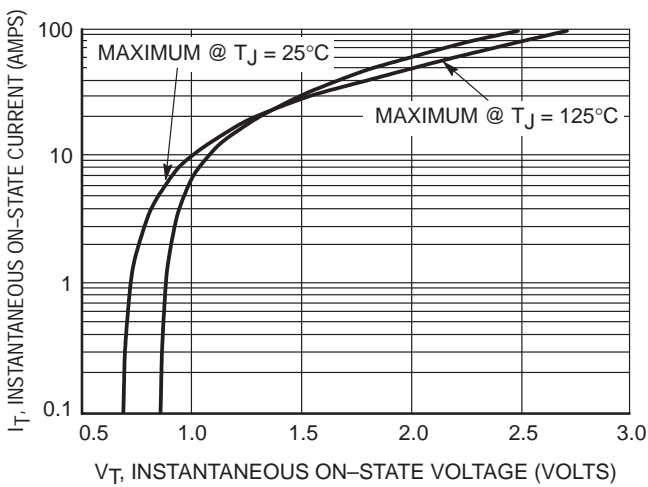

Figure 3. Typical On-State Characteristics

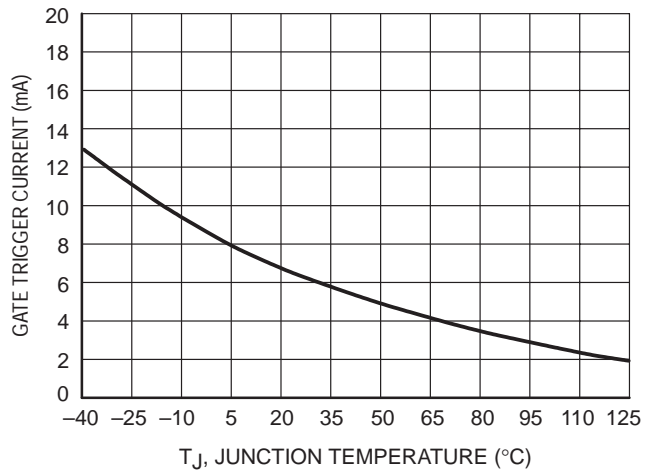

Figure 4. Typical Gate Trigger Current versus Junction Temperature

MCR12D, MCR12M, MCR12N

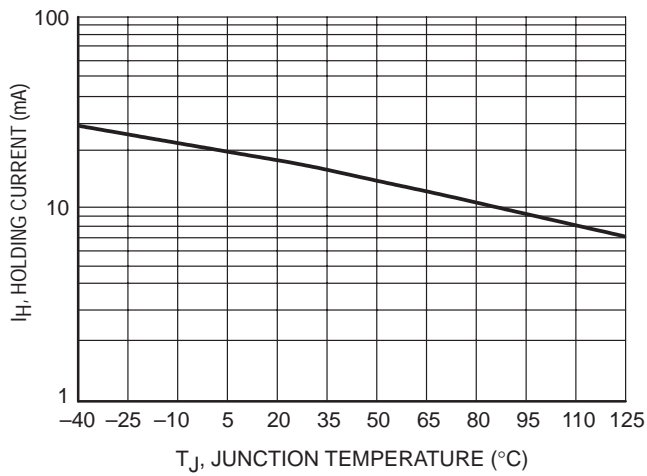

Figure 5. Typical Holding Current versus Junction Temperature

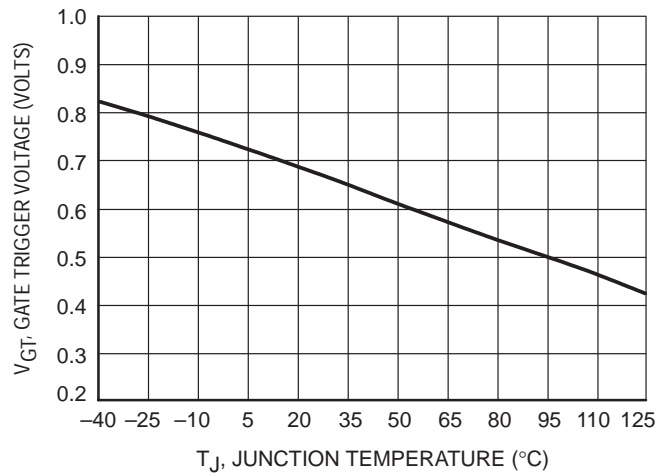

Figure 6. Typical Gate Trigger Voltage versus Junction Temperature

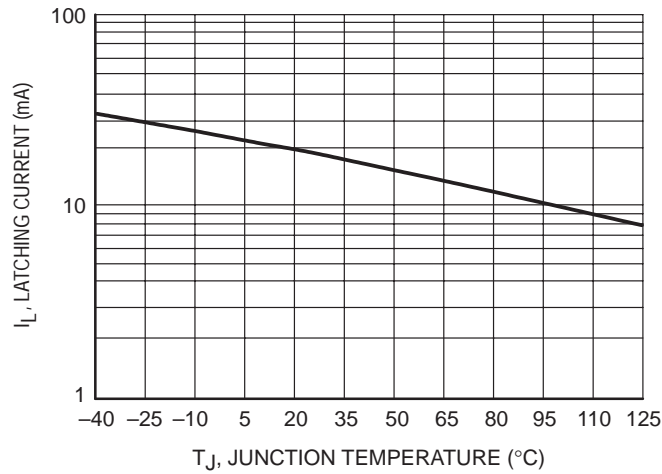
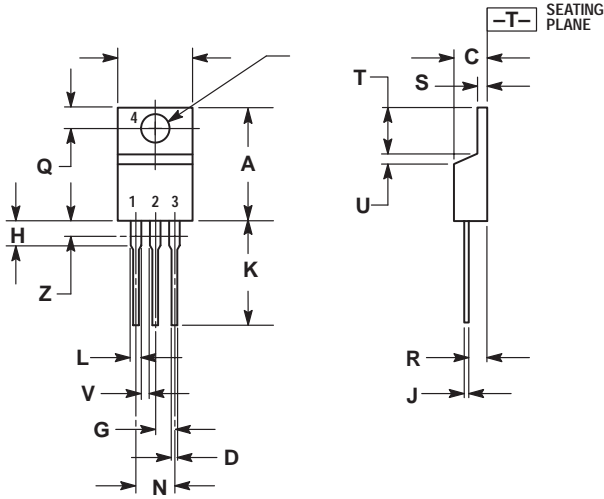

Figure 7. Typical Latching Current versus Junction Temperature

MCR12D, MCR12M, MCR12N

PACKAGE DIMENSIONS

TO-220AB
CASE 221A-09
ISSUE Z



- NOTES:
1. DIMENSIONING AND TOLERANCING PER ANSI Y14.5M, 1982.
 2. CONTROLLING DIMENSION: INCH.
 3. DIMENSION Z DEFINES A ZONE WHERE ALL BODY AND LEAD IRREGULARITIES ARE ALLOWED.

DIM	INCHES		MILLIMETERS	
	MIN	MAX	MIN	MAX
A	0.570	0.620	14.48	15.75
B	0.380	0.405	9.66	10.28
C	0.160	0.190	4.07	4.82
D	0.025	0.035	0.64	0.88
F	0.142	0.147	3.61	3.73
G	0.095	0.105	2.42	2.66
H	0.110	0.155	2.80	3.93
J	0.018	0.025	0.46	0.64
K	0.500	0.562	12.70	14.27
L	0.045	0.060	1.15	1.52
N	0.190	0.210	4.83	5.33
Q	0.100	0.120	2.54	3.04
R	0.080	0.110	2.04	2.79
S	0.045	0.055	1.15	1.39
T	0.235	0.255	5.97	6.47
U	0.000	0.050	0.00	1.27
V	0.045	---	1.15	---
Z	---	0.080	---	2.04

- STYLE 3:
PIN 1. CATHODE
2. ANODE
3. GATE
4. ANODE