

LML4P6432RGB-0505 – Pitch 4mm 64x32 LED Display Module



Features

- Very good performance of uniformities, high efficiency, low lumen degrade and high stability.
- 4mm pixel pitch, RGB 0505 SMD LED soldered per pixel, array in a line better in color mix display, 62500 pixels per square meter.
- With resolution of 64x32 and module size of 256mmx128mm, the structure of combined driver board ensures the high reliability.
- It is suitable for indoor LED display application because of its large viewing angle, soft image and high definition.
- It has good performance in color consistency and mosaic tile free with high temperature resistance module mask and heavier-duty module frame.
- The design of multi-layer circuit board makes the uniform distribution of current distribution, quick heat dispelling, long life span and high reliability.
- RoHS and CE compliant

Package Dimensions

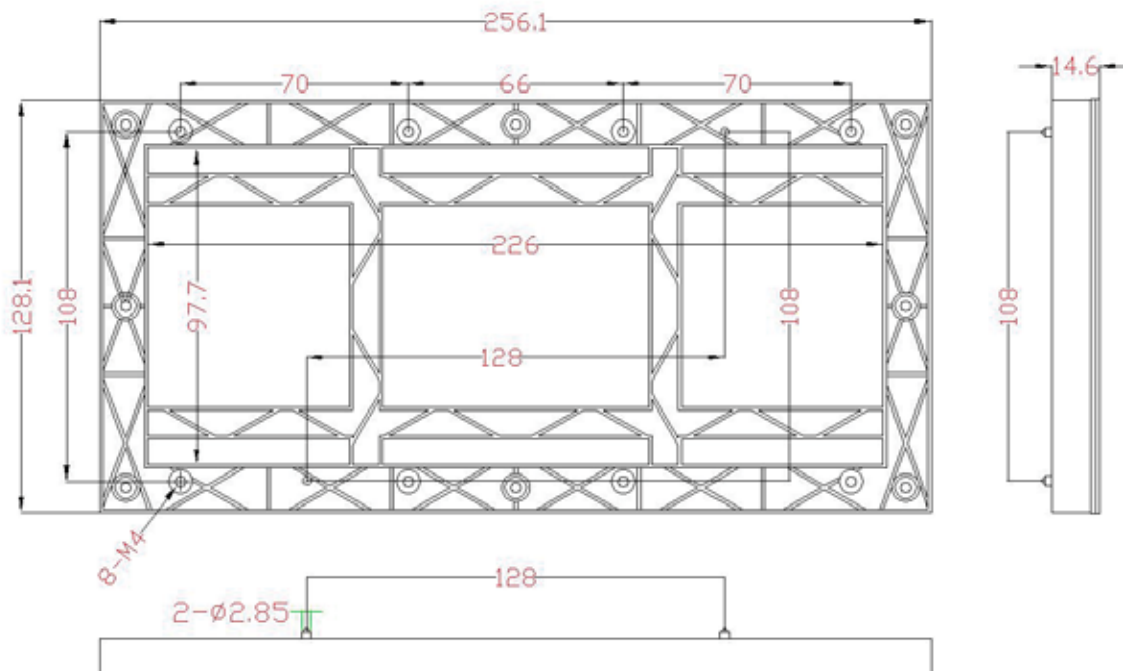

Module Data Interface

| Pin Assignment(Data J1/J2) | | | | Pin Assignment(Power) | | Module Data Interface |
|----------------------------|----------|--------|----------|-----------------------|----------|--|
| Pin NO | Function | Pin NO | Function | Pin NO | Function | |
| 1 | R1 | 2 | G1 | 1 | +5V |  |
| 3 | B1 | 4 | GND | 2 | +5V | |
| 5 | R2 | 6 | G2 | 3 | GND | |
| 7 | B2 | 8 | GND | 4 | GND | |
| 9 | A | 10 | B | | | |
| 11 | C | 12 | NC | | | |
| 13 | CLK | 14 | LAT | | | |
| 15 | OE | 16 | GND | | | |

Specifications

| Specifications | Parameters |
|-----------------------|--|
| Real Pixel Pitch | 4mm |
| Pixel Composition | 1RGB |
| Real Pixel Density | 62500 dots/m ² |
| LED Encapsulation | SMD 0505 |
| Module Resolution | 64x32 Dots |
| Module Size | 256x128mm |
| Display Viewing Angle | Horizontal: 140 degree(±10) |
| | Vertical: 140 degree(±10) |
| Drive Mode | Constant Current Driver, 1/16 scan |
| Display Brightness | ≥900cd/m ² |
| Module Structure | Combined Driver Board |
| Best Viewing Distance | 4-12m |
| Life Span | ≥50,000 hours |
| Max Power Consumption | 800W/m ² |
| Ave Power Consumption | 270W/m ² |
| Input Voltage | 220V±10% or 100V±10% |
| Operating Environment | Temperature: -20 -60 ; Humidity: 10% - 95% |
| Water Proof | IP31 |

NOTE:

Power consumption value stated above is only for reference, the exact value is upon the actual test on modules.

The specifications are subject to change without notice.

Photos of P4 64x32 Indoor RGB LED Display Module



Pixel: RGB 0505 SMD LED

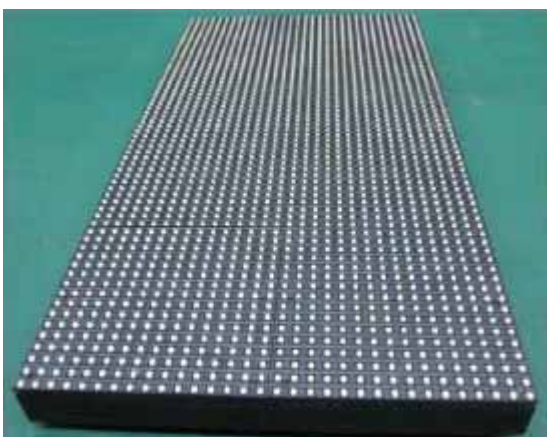

Screws for the Module Cover



Screws for the Whole Module