

Rev	AWO #	Description	Date	Appr
-		RELEASED	1/03/10	

APPROVED: \_\_\_\_\_  
 DATE: \_\_\_\_\_ TITLE: \_\_\_\_\_

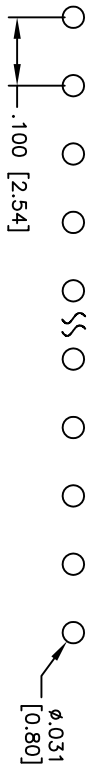

RECOMMENDED PCB LAYOUT

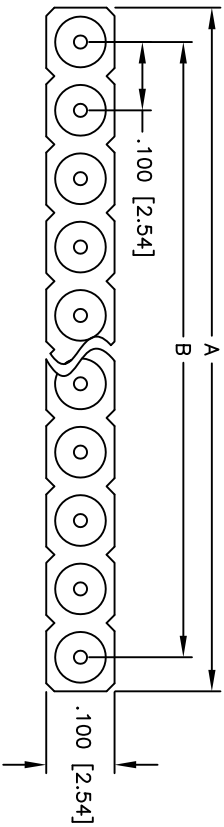
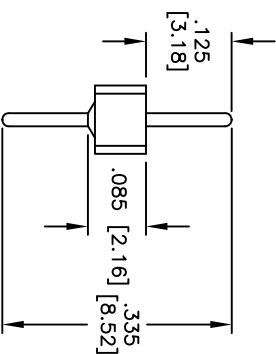
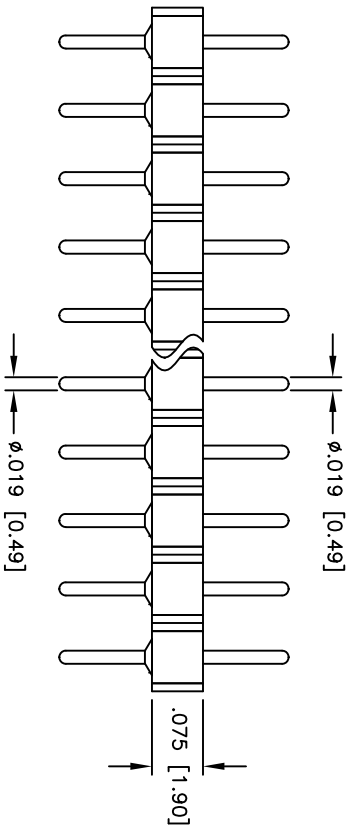

SPECIFICATIONS:  
 Material: PPS, Glass reinforced, rated UL 94V-0  
 Insulator: Brass  
 Contacts: Brass  
 Plating: Gold over Nickel underplate overall  
 Electrical: Gold over Nickel underplate overall

Current rating: 3 Amp max  
 Contact resistance: 10 mohms Max  
 Dielectric Strength: Min 1000V/RMS  
 Temperature Rating: Operating temperature: -40°C to +105°C  
 Environmental: Lead free, RoHS compliant  
 Recommended soldering temp: 235°C for 5 seconds



Positions: 1 thru 40  
 A = .100 [2.54] x No. of Positions  
 B = .100 [2.54] x No. of Spaces

UNLESS OTHERWISE SPECIFIED  
 ALL DIMENSIONS ARE IN INCHES [MM]  
 TOLERANCES: EXCEPT AS NOTED

INCHES	HOLES
.X ± .10	ØX ± .10
.XX ± .020	ØXXX ± .015
.XXX ± .015	ØXXX ± .010

APPROVALS: \_\_\_\_\_ DATE: \_\_\_\_\_

DRAWN	DY	1/03/10
CHECKED		
APPROVED		

**ADAM TECH**  
 909 Rahway Avenue, Union, NJ 07083  
 Phone: 908-687-5000 Fax: 908-687-5710

TITLE: SCREW MACHINE TERMINAL STRIP, SINGLE ROW STRAIGHT, .100" SPACING, GOLD PLATED

SIZE	PART NO.	REV.
X	MCT-1-XX-.125/.335-G-L	-
REF:	S00007T	SHEET 1 OF 1
SCALE:	NTS	