

DASH NO.	M CODE	MADE FROM
----------	--------	-----------

STAMP: KINGS B25-2-9

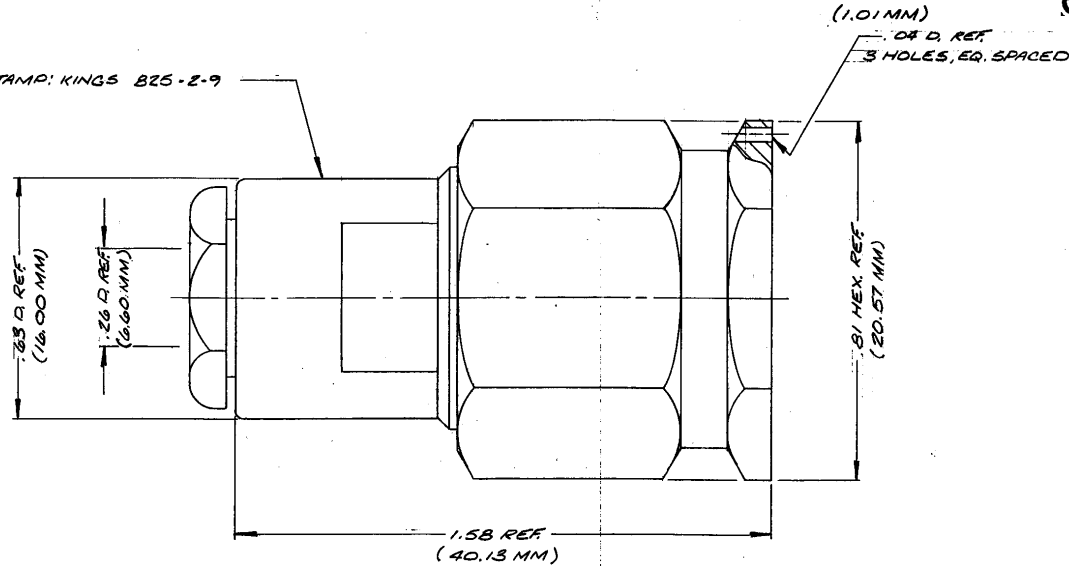

GSD

B25-2-9

REVISIONS	
ISSUE	CHANGES
0	ER 23065 PLATING SPECS ADDED MJB 14 MAR 84

GSD

SCALE:	4:1
APPROX SURFACE AREA:	
USED ON:	
REF:	HUGHES DWG 720809 C
	SC PLUG
DRAWN MCD	DATE 7 MAR 83
APP. MJB	DATE 20 MAR 83
 <small>TROY, NEW YORK 12182</small>	
B25-2-9	

GSD

NOTES:

1. FOR USE WITH RG-40/U (.250 Ø) SEMI-RIGID CABLE.
2. FOR CABLING INSTRUCTIONS SEE 3-210.
3. MATERIALS:
 - CENTER & OUTER CONTACT - BERYLLIUM COP, QQ-C-630.
 - C-RING - PHOSPHOR BRONZE, QQ-B-750.
 - ALL OTHER METAL PARTS - BRASS, QQ-B-616.
 - GASKET - SILICONE RUBBER, ZE-R-745.
 - INSULATOR - TEFLON, L-P-408.

4. FINISHES:

CENTER CONTACT } HARD GOLD PLATE
ADAPTER } MIL-B-45204B, TYPE II,
GRADE C, CLASS I

OUTER CONTACT - SILVER PLATE,
QQ-S-365A, TYPE III, GRADE A
ALL OTHER METAL PARTS - KINGS
TARNISH RESISTANCE FINISH (TR-5)

5. ELECTRICAL CHARACTERISTICS:
 - NOMINAL IMPEDANCE - 50 Ω OHMS.
 - FREQUENCY RANGE - DC TO 11GHz.
 - WORKING VOLTAGE - 1000 RMS.

UNLESS OTHERWISE SPECIFIED:

- | | |
|--|--|
| 1. TOLERANCES: FRACTIONS & 2 PLACE DECIMALS ± .010 | 2. REMOVE ALL BURRS, BREAK SHARP EDGES .005 MAX. |
| 3 PLACE DECIMALS ± .004 | 3. NO FILLETS PERMITTED. |
| ANGLES ± 0°30' | 4. SURFACE ROUGHNESS 83 MICROINCHES RMS MAX. |
| T. I. R. CONCENTRICITY OF ANY 2 DIAMETERS MAY NOT EXCEED HALF THE SUM OF THEIR TOLERANCES. | 5. ALL DIMENSIONS PRIOR TO PLATING. |
| | 6. ALL PLATING IN ACCORDANCE WITH KER 10004. |