

# Fan, AC & DC Types, 80 x 80mm

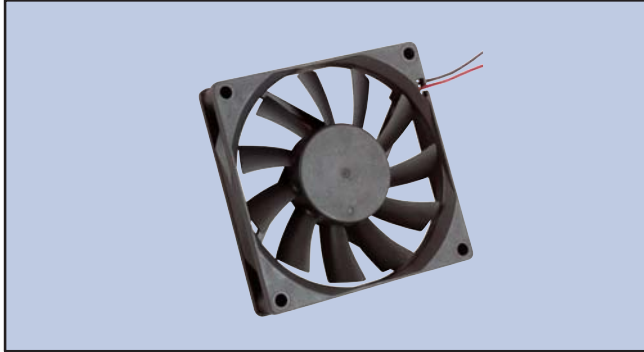

## Features

- High Speed
- Ball Bearings
- Terminal Types – “T” Suffix
- 24 AWG Red (+) and Black (-) Leads – DC Types
- 22 AWG Black Leads – AC Types
- 11.8” (300mm) Lead Length



F3

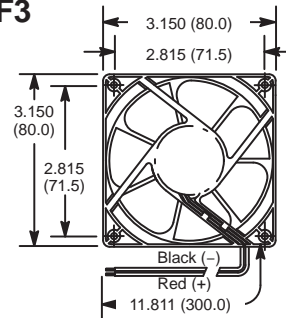

	Thickness “T”	
	DC	AC
15mm	.590 (15.0)	N/A
25mm	.984 (25.0)	1.043 (26.5)
38mm	N/A	1.516 (38.5)

a: Lead Types

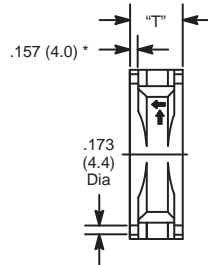

b: Terminal Types

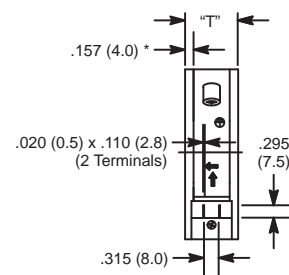

\* 15mm Types: .118 (3.0)

DC OPERATED							
NTE Type No.	Rated Voltage	Max. Input Current	Max. Input Power (W)	Speed ±10% (RPM)	Max Air Flow (CFM)	Max Acoustical Noise	Diag No.
77-8015D12	12	0.20A	2.35	3000	31.74	38dB(A)	F3a
77-8015D24#	24	0.17A	4.14	3000	31.74	38dB(A)	F3a
77-8025D12	12	0.26A	3.17	3000	41.06	37dB(A)	F3a
77-8025D24	24	0.17A	4.14	3000	41.06	37dB(A)	F3a
AC OPERATED							
NTE Type No.	Rated Voltage	Max. Input Current	Max. Input Power (W)	Speed ±10% (RPM)	Max Air Flow (CFM)	Max Acoustical Noise	Diag No.
77-8025A120	115	0.13A	13	2200	19	26dB(A)	F3a
77-8025A120-T	115	0.13A	13	2200	19	26dB(A)	F3b
77-8038A120	115	0.20A	12	3000	29	34dB(A)	F3a
77-8038A120-T	115	0.20A	12	3000	29	34dB(A)	F3b

# These devices do not meet UL approval

ACCESSORIES		
FAN TYPE	DESCRIPTION	NTE TYPE NO.
80 X 80mm	Fan Guard, Metal	77-MG80
80 X 80mm	Fan Filter, 3-Piece w/Cover	77-FF80
80 X 80mm, Terminal Type	Fan Cord, 12", 45° Blunt Cut	77-FC12
	Fan Cord, 24", 45° Blunt Cut	77-FC24
	Fan Cord, 36", 45° Blunt Cut	77-FC36
	Fan Cord, 48", 45° Blunt Cut	77-FC48
	Fan Cord, 72", 45° Blunt Cut	77-FC72

## Specifications

### Electrical Characteristics

**Insulation Resistance:** 10M± Min. (at 500VDC) between frame and positive terminal

**Dielectric Strength:**

**DC Types:** 500VAC, 1 minute; 600VAC, 1 sec at 5mA Max. between frame and positive terminal

**AC Types:** 1500VAC, 1 minute; 1800VAC, 1 sec at 5mA Max. between frame and positive terminal

**Life Expectancy:**

**DC Types:** Approx. 70000 hrs at rated voltage, +40°C, 15% to 65% RH

**AC Types:** Approx. 50000 hrs at rated voltage, +25°C, 15% to 65% RH

### Mechanical Characteristics

**Frame:**

**DC Types:** Thermoplastic, Black, UL94V-0

**AC Types:** Die-Cast Aluminum, Black

**Impeller:** Thermoplastic, Black, UL94V-0

**Bearing:**

**DC Types:** 2 Ball Bearings

**AC Types:** Ball Bearing

**Weight:**

**DC Types:** Approx. 54g (15mm); 76g (25mm)

**AC Types:** Approx. 208g (25mm); 340g (38mm)

### Environmental Characteristics

**Operating Temperature:** -10°C to +70°C

**Storage Temperature:** -40°C to +75°C

**Operating Humidity:** 35% to 85% RH

**Storage Humidity:** 35% to 85% RH

### Protection

**Polarity (DC Types ONLY):** Damage will not occur for up to 10 minutes with positive and negative leads connected in reverse.

**Locked Rotor:** Within 72 hours of a rotor locking condition, at the rated voltage and operating temperature, the impedance of the motor winding will protect the motor from damage.