

| SWITCH FUNCTION |        |        |
|-----------------|--------|--------|
| POS. 1          | POS. 2 | POS. 3 |
|                 |        |        |
| ON              | NONE   | ON     |
| 2-3             | OPEN   | 2-1    |

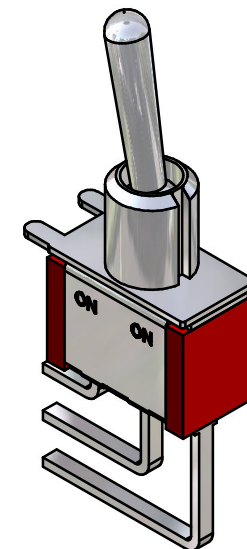
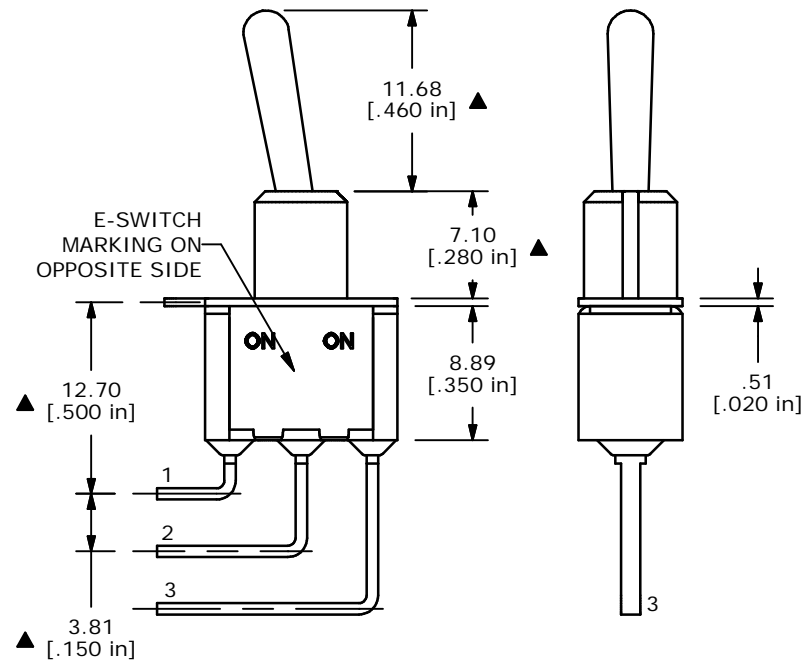
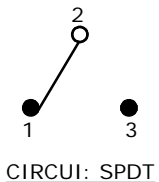

ISOMETRIC

NOTE:

1. ALL DIMENSIONS IN MM [INCH]
2. GENERAL TOLERANCE: X.X=±0.4  
X.XX=±0.25
3. TERMINAL NUMBERS FOR REF ONLY
- ▲4. PLATING MATERIAL: GOLD
5. RATING: 0.4 (VA) Max. @20V Max.
6. ELECTRIC LIFE: 40,000 make-and-break cycles at full load.
7. INSULATION RESISTANCE: 1,000 Mega-ohm min.
8. DIELECTRIC STRENGTH: 1,000 V RMS @sea level.
9. OPERATING TEMP.: -30°C to 85°C
10. ▲DENOTES CRITICAL PARAMETER.

**E-SWITCH®**

|     |        |                         |          |    |
|-----|--------|-------------------------|----------|----|
| A   | 13667  | RELEASED FOR PRODUCTION | 12/22/03 | AR |
| REV | PCR NO | DESCRIPTION             | DATE     | BY |

|                      |          |    |         |     |
|----------------------|----------|----|---------|-----|
| TITLE 100SP1T1B4M7RE |          |    |         |     |
| SCALE                | DATE     | DR | DWG     | REV |
| 2:1                  | 12/22/03 | AR | T111022 | A   |

THE INFORMATION CONTAINED IN THIS DOCUMENT IS PROPRIETARY TO E-SWITCH AND IS NOT TO BE COPIED OR TRANSFERRED