

UNAUTHORIZED USE OF THIS
DRAWING IS STRICTLY PROHIBITED

DAR	REV	DESCRIPTION	APPVD	DATE
1106	A	INITIAL RELEASE	TP	5-06
1147	B	REVISE FREQUENCY RANGE	TJD	6-06
1317	C	CHANGE TEMPERATURE TO 150 DEGREES	TP	7-07
1362	D	REVISED PART NUMBER	DG	11-07
1497	E	CHANGE LD HEIGHT & HEIGHT DIMS	DG	8-08
1824	F	SEE DAR	DG	4-09
2006	G	SEE DAR	DG	8-09
2570	H	SEE DAR	DG	7-10
3504	J	SEE DAR	DG	2-12
3533	K	SEE DAR	DG	2-12
5103	L	SEE DAR	DG	8-14

ELECTRICAL SPECIFICATIONS

PART NO.	VALUE	INPUT POWER	FREQUENCY	VSWR
IPP-TB203-50	50 OHMS ±5%	50 WATT	DC-5000 MHz	<1.10:1 DC-4200 MHz <1.25:1 DC-5000 MHz
IPP-TB203-100	100 OHMS ±5%	50 WATT	DC-3000 MHz	2.0±0.20:1

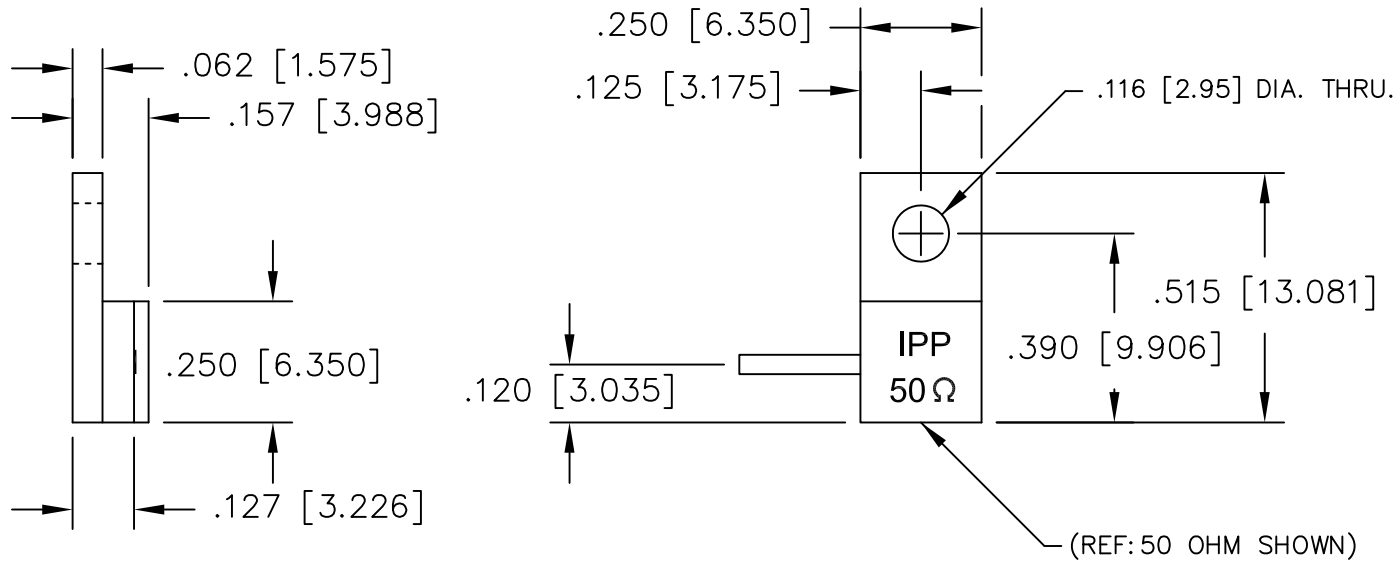

NOTES:

- LEAD MATERIAL: 99.99% PURE SILVER, .040 [1.016] WIDE x .005 [.127] THICK x .250 [6.350] MIN. LONG.
- SUBSTRATE MATERIAL: BeO
COVER MATERIAL: Al₂O₃
- FLANGE MATERIAL: COPPER
PLATING: NICKEL
- LEAD(S) WELDED TO SUBSTRATE.
- RoHS COMPLIANT.

POWER DERATING CURVE

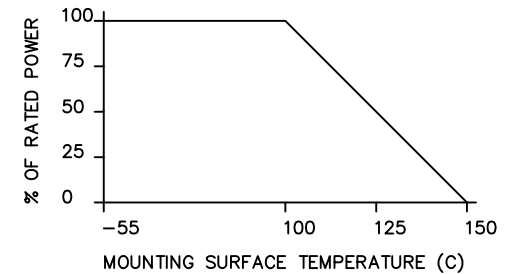

MATERIAL	[2] [3]	DWN	DG	DATE	12/05		
FINISH	[3]	ENG	TJD	DATE	12/05		
TOLERANCE	.XX ±.02 [.51] IN [MM] .XXX ±.010 [.254]	MANUF	TP	DATE	12/05		
		CAGE CODE: 437R2				TITLE	TERMINATION, 50 WATT, FLANGE
		SHEET	OF	SCALE		P/N	IPP-TB203-XXX
		1	1	4:1		REV.	L