

Wall Industries, Inc.

PSHF320W SERIES

85~264VAC (120~370VDC) Input Voltage Range
Up to 322 Watts Output Power
Single Outputs, Power Factor Correction
AC/DC Switching Power Supplies



FEATURES

- RoHS Compliant
- $\pm 10\%$ Voltage Adjustment Range
- 85~264VAC (120~370VDC) Input Voltage Range
- Built-in Fan Speed Control
- Power Factor > 0.98 at 115VAC; > 0.95 at 230VAC
- 3000VAC I/O Isolation
- Single Outputs
- 8.46" x 4.53" x 1.97" Enclosed Case
- Up to 320W Output Power
- Short Circuit, Over Current, Over Voltage, and Over Temperature Protection
- UL60950, EN60950, GB4943, and CE Approvals

DESCRIPTION

The PSHF320W series of AC/DC power supplies offers up to 322W of output power in a 8.46" x 4.53" x 1.97" enclosed case. This series consists of single output models with a universal input voltage range of 85~264VAC (120~370VDC). Some features include built-in fan speed control, power factor > 0.98 at 115VAC, and $\pm 10\%$ output adjustment range. These supplies are also protected against short circuit, over current, over voltage, and over temperature conditions. This series is RoHS compliant and has UL60950, EN60950, GB4943, and CE approvals.

SPECIFICATIONS: PSHF320W SERIES					
<p style="color: red;">All specifications are based on 25°C, Nominal Input Voltage, and Maximum Output Current unless otherwise noted. We reserve the right to change specifications based on technological advances.</p>					
SPECIFICATION	TEST CONDITIONS	Min	Nom	Max	Unit
INPUT SPECIFICATIONS					
Input Voltage Range	AC input voltage range	85		264	VAC
	DC input voltage range	120		370	VDC
Inrush Current	At 115VAC	Cold start		20	A
	At 230VAC			40	
Input Frequency		47		63	Hz
Power Factor	At 115VAC	0.98			VAC
	At 230VAC	0.95			
OUTPUT SPECIFICATIONS					
Output Voltage		See Table			
Output Voltage Adjustment Range		-10		+10	%
Line Regulation	Full load	-0.5		+0.5	%
Load Regulation			0.5		%
Output Current		See Table			
Output Power		See Table			
Ripple & Noise		See Table			
Rise Time	Full load		50		ms
Hold-up Time	Full load		20		ms
PROTECTION					
Over Current Protection		110		130	%
Over Voltage Protection		115		150	%
Short Circuit Protection		Yes			
Over Temperature Protection		Yes			
GENERAL SPECIFICATIONS					
Efficiency		See Table			
Withstand Voltage	Input to Output	All for 1 minute	3000		VAC
	Input to FG		1500		
	Output to FG		500		
Leakage Current	At 230VAC			0.7	mA
ENVIRONMENTAL SPECIFICATIONS					
Operating Temperature		-10		+50	°C
Operating Humidity	non-condensing	20		93	% RH
Storage Temperature		-20		+85	°C
Storage Humidity	non-condensing	20		95	% RH
Cooling Method		fan			
PHYSICAL SPECIFICATIONS					
Weight		2.34 lbs (1060g)			
Dimensions (L x W x H)		8.46 x 4.53 x 1.97 inches (215 x 115 x 50 mm)			
SAFETY & EMC CHARACTERISTICS					
Safety Standards		UL60950, EN60950, GB4943			
EMC Standards		GB9254, EN55022 Class B, EN61000-3-2,3, EN61000-4-2,3,4,5,6,8,11			

MODEL SELECTION TABLE						
Model Number	Input Voltage Range	Output Voltage	Output Current	Ripple & Noise	Output Power	Efficiency
PSHF320W-SC-5	85 ~ 264 VAC or 120 ~370 VDC	5 VDC	60A	100mVp-p	300W	79%
PSHF320W-SC-7.5		7.5 VDC	40A	100mVp-p	300W	83%
PSHF320W-SC-12		12 VDC	25A	100mVp-p	300W	86%
PSHF320W-SC-13.5		13.5 VDC	22A	100mVp-p	297W	86%
PSHF320W-SC-15		15 VDC	20A	100mVp-p	300W	86%
PSHF320W-SC-24		24 VDC	13A	150mVp-p	312W	87%
PSHF320W-SC-27		27 VDC	11.7A	150mVp-p	316W	88%
PSHF320W-SC-48		48 VDC	6.7A	240mVp-p	321.6W	89%

MECHANICAL DRAWING

Unit: inches (mm)

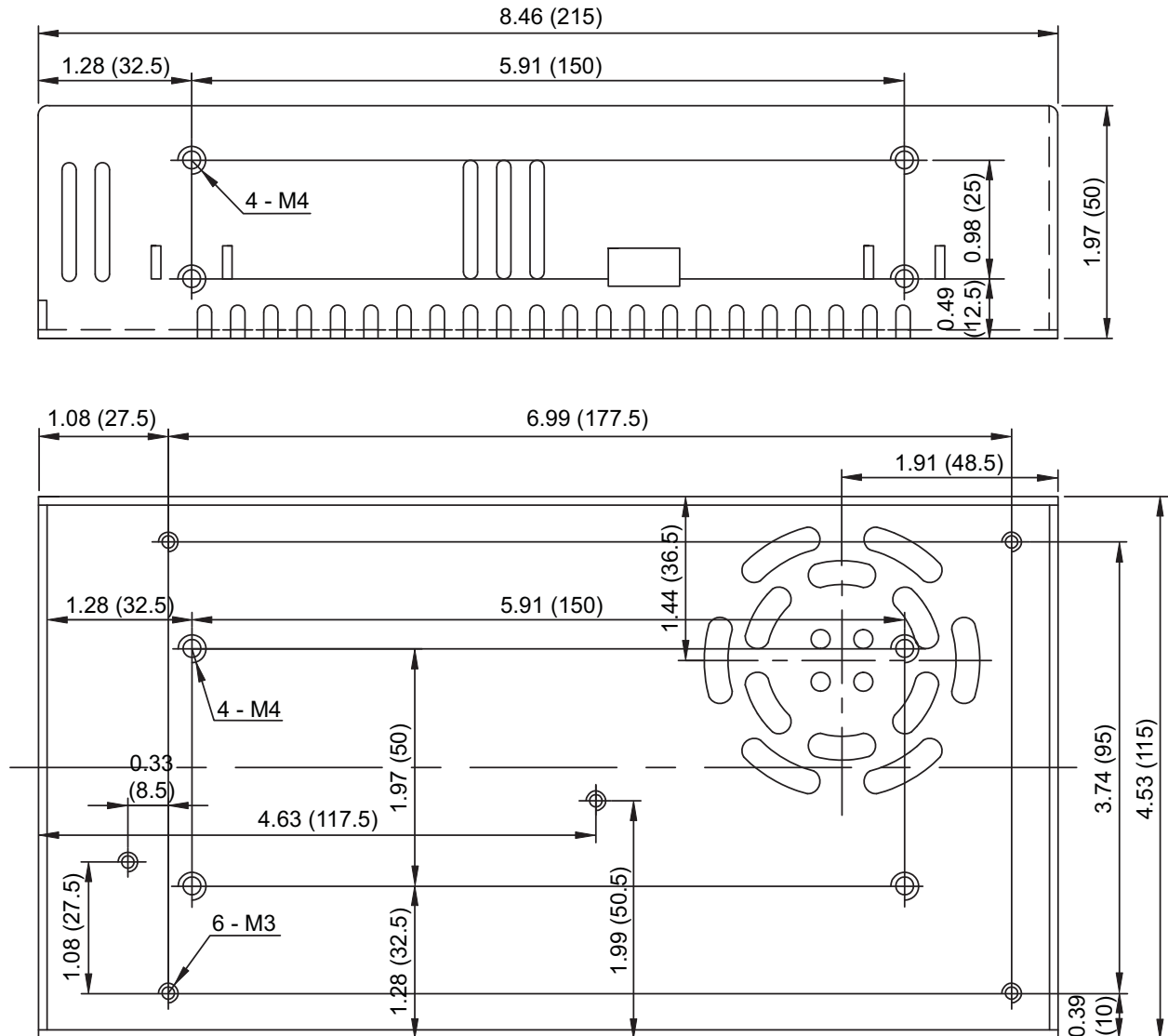

COMPANY INFORMATION

Wall Industries, Inc. has created custom and modified units for over 50 years. Our in-house research and development engineers will provide a solution that exceeds your performance requirements on-time and on budget. Our ISO9001-2008 certification is just one example of our commitment to producing a high quality, well-documented product for our customers.

Our past projects demonstrate our commitment to you, our customer. Wall Industries, Inc. has a reputation for working closely with its customers to ensure each solution meets or exceeds form, fit and function requirements. We will continue to provide ongoing support for your project above and beyond the design and production phases. Give us a call today to discuss your future projects.

Contact **Wall Industries** for further information:

<u>Phone:</u>	☎ (603)778-2300
<u>Toll Free:</u>	☎ (888)597-9255
<u>Fax:</u>	☎ (603)778-9797
<u>E-mail:</u>	sales@wallindustries.com
<u>Web:</u>	www.wallindustries.com
<u>Address:</u>	5 Watson Brook Rd. Exeter, NH 03833