

NOTES:

1. ROHS COMPLIANT
2. HEADER: PHENOLIC WITH FLAMMABILITY RATING UL 94V-0 OR BETTER.
3. STORAGE TEMPERATURE: -20°C TO +125°C
4. COMPLIANCE TO J-STD:
 - A. J-STD-002: SOLDERABILITY AT 245°C REFLOW PROFILE
 - B. J-STD-020: LEVEL 1, NO MOISTURE SENSITIVE
 - C. J-STD-075: R7, 245°C MAXIMUM THROUGH REFLOW SOLDER
5. TO ORDER TAPE & REEL PACKAGING ADD A "T" SUFFIX TO THE PART NUMBER(i.e T8008FNL BECOMES T8008FNLT).

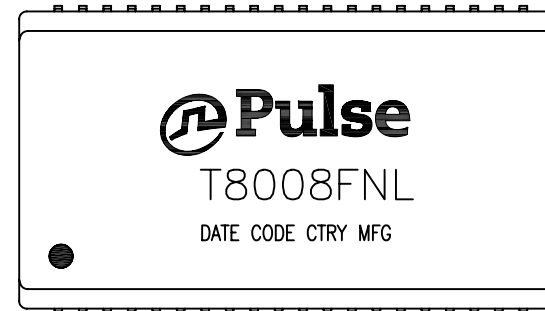

FINAL OUTLINE

© Copyright, 2014. Pulse Electronics Corp. All rights reserved. Pulse confidential & proprietary. (06/17/14)

PRODUCT DESCRIPTION	TLA DRAWING	PS DRAWING	SHEET	PART NO.	DATASHEET REV.
CHOKE 2W,OCTAL,T1,40POH,47uH,NL	T8008FNL-10	PS-2743.001-A	1 OF 3	T8008FNL	A

ELECTRICAL CHARACTERISTICS AT +25°C UNLESS OTHER SPECIFIED

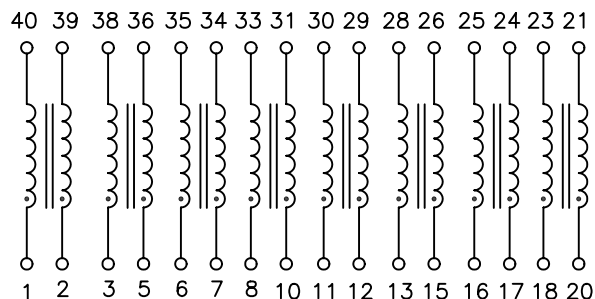

SCHEMATIC

PARAMETER	SPECIFICATIONS																					
OPERATING TEMPERATURE	0°C - 70°C																					
POLARITY	PER SCHEMATIC																					
TURNS RATIO @ 10 KHz, 0.1 VRMS	$\frac{(1-40)}{(2-39)} = \frac{(3-38)}{(5-36)} = \frac{(6-35)}{(7-34)} = \frac{(8-33)}{(10-31)} = 1.0 \pm 2\%$ $\frac{(11-30)}{(12-29)} = \frac{(13-28)}{(15-26)} = \frac{(16-25)}{(17-24)} = \frac{(18-23)}{(20-21)} = 1.0 \pm 2\%$																					
INDUCTANCE (OCL) @ 100 KHz, 0.1 VRMS	(1-40) = (3-38) = (6-35) = (8-33) = 47.0 uH MIN (12-29) = (15-26) = (17-24) = (20-21) = 47.0 uH MIN																					
DC RESISTANCE	(11-30) = (13-28) = (16-25) = (18-23) = 0.50 OHMS MAX (2-39) = (5-36) = (7-34) = (10-31) = 0.50 OHMS MAX																					
LEAKAGE INDUCTANCE @ 100 KHz, 0.1 VRMS	(1-40) WITH (2-39) SHORTED = .450 uH MAX (3-38) WITH (5-36) SHORTED = .450 uH MAX (6-35) WITH (7-34) SHORTED = .450 uH MAX (8-33) WITH (10-31) SHORTED = .450 uH MAX (11-30) WITH (12-29) SHORTED = .450 uH MAX (13-28) WITH (15-26) SHORTED = .450 uH MAX (16-25) WITH (17-24) SHORTED = .450 uH MAX (18-23) WITH (20-21) SHORTED = .450 uH MAX																					
CWW @ 100 KHz, 1.0 VRMS	(1-40) TO (2-39) = 25 pF MAX (3-38) TO (5-36) = 25 pF MAX (6-35) TO (7-34) = 25 pF MAX (8-33) TO (10-31) = 25 pF MAX (11-30) TO (12-29) = 25 pF MAX (13-28) TO (15-26) = 25 pF MAX (16-25) TO (17-24) = 25 pF MAX (18-23) TO (20-21) = 25 pF MAX																					
COMMON MODE ATTENUATION	<table border="1"> <thead> <tr> <th>.100 MHz</th> <th>1 MHz</th> <th>10 MHz</th> <th>30 MHz</th> <th>50 MHz</th> <th>100 MHz</th> <th>300 MHz</th> </tr> </thead> <tbody> <tr> <td>-7 dB</td> <td>-18 dB</td> <td>-32 dB</td> <td>-36 dB</td> <td>-35 dB</td> <td>-29 dB</td> <td>-15 dB</td> </tr> <tr> <td>MINIMUM</td> <td>MINIMUM</td> <td>MINIMUM</td> <td>MINIMUM</td> <td>MINIMUM</td> <td>MINIMUM</td> <td>MINIMUM</td> </tr> </tbody> </table>	.100 MHz	1 MHz	10 MHz	30 MHz	50 MHz	100 MHz	300 MHz	-7 dB	-18 dB	-32 dB	-36 dB	-35 dB	-29 dB	-15 dB	MINIMUM	MINIMUM	MINIMUM	MINIMUM	MINIMUM	MINIMUM	MINIMUM
.100 MHz	1 MHz	10 MHz	30 MHz	50 MHz	100 MHz	300 MHz																
-7 dB	-18 dB	-32 dB	-36 dB	-35 dB	-29 dB	-15 dB																
MINIMUM	MINIMUM	MINIMUM	MINIMUM	MINIMUM	MINIMUM	MINIMUM																
HIPOT	650 VRMS FOR 6S																					

© Copyright, 2014. Pulse Electronics Corp. All rights reserved. Pulse confidential & proprietary. (06/17/14)

PRODUCT DESCRIPTION	TLA DRAWING	PS DRAWING	SHEET	PART NO.	DATASHEET REV.
CHOKE 2W,OCTAL,T1,40POH,47uH,NL	T8008FNL-10	PS-2743.001-A	2 OF 3	T8008FNL	A

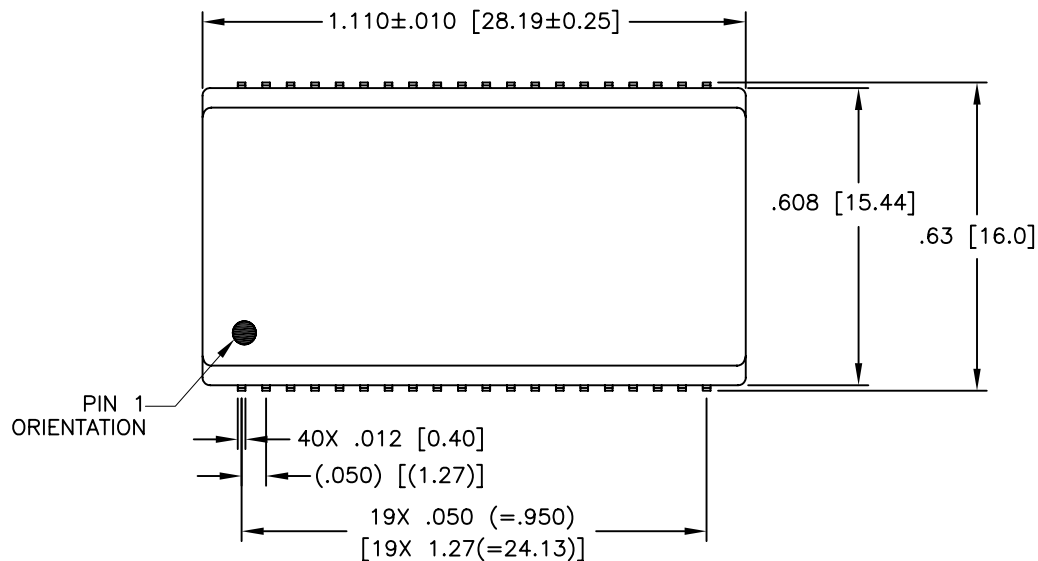

SUGGESTED PAD LAYOUT

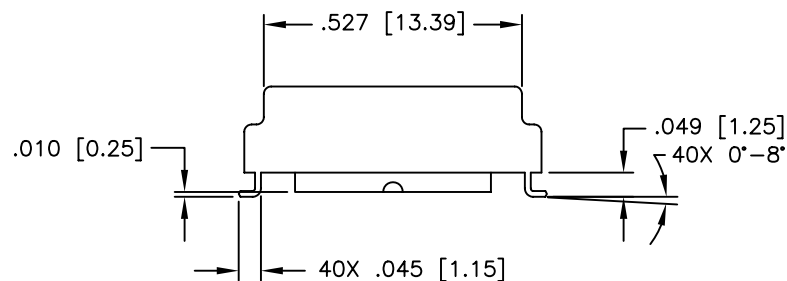

DIMENSIONS ARE IN INCHES [MILLIMETERS] WITH THE FOLLOWING TOLERANCES: [MILLIMETERS] ARE FOR REFERENCE ONLY.
 .XX= ± 0.01 [± 0.25]
 .XXX= ± 0.005 [± 0.13]

© Copyright, 2014. Pulse Electronics Corp. All rights reserved. Pulse confidential & proprietary. (06/17/14)

PRODUCT DESCRIPTION	TLA DRAWING	PS DRAWING	SHEET	PART NO.	DATASHEET REV.
CHOKE 2W,OCTAL,T1,40POH,47uH,NL	T8008FNL-10	PS-2743.001-A	3 OF 3	T8008FNL	A