

*) stretched length

All dimensions are in mm; tolerances according to ISO 2768 m-H

Cable

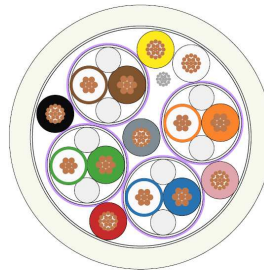

Wire	6x
Stranded bare copper wire with PVC insulation	26 AWG, Ø 0.48 mm Ø 0.9 mm
Shielded pair	4x
Stranded bare copper wire with PE insulation	26 AWG, Ø 0.48 mm Ø 1.0 mm
Plastic tape overlapped	
Aluminum foil overlapped	
Drain wire	1x
Stranded tinned copper wire	28 AWG
Jacket	
PUR, similar RAL 9010	Ø 6.8 ± 0.2 mm

Dieses Dokument ist urheberrechtlich geschützt • This document is protected by copyright • Rosenberger Hochfrequenztechnik GmbH & Co. KG

RF_35/09;14/6.2

MultiMag 15

Cable Assembly

L99-346-XXX

Available versions

Type	Cable	Length A [mm]
L99-346-3500	L45467-J414-W28	3500 +60/-10
L99-346-3000	L45467-J414-W28	3000 +60/-10
L99-346-500	L45467-J414-W28	500 +60/-10

General information

Break-off plug with iron cores
 Coding
 Number and type of contacts
 Cable outlet

mechanical
 15 spring-loaded contacts
 straight

Technical data break-off plug

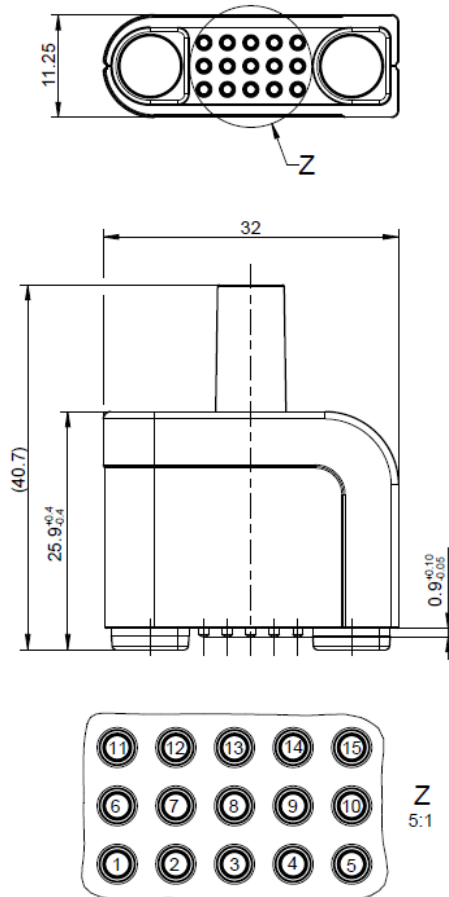

face plan - break-off plug			
Pos.	signal	colour	AWG
1	D4-	brown <i>(twisted pair)</i>	26
2	D4+	white-brown <i>(twisted pair)</i>	26
3	DC	yellow	26
4	TX+ / D1+	white-green <i>(twisted pair)</i>	26
5	TX- / D1-	green <i>(twisted pair)</i>	26
6	DC	black	26
7	DC	red	26
8	Ground	drain wire	28
9	DC	grey	26
10	DC	pink	26
11	D3-	white-blue <i>(twisted pair)</i>	26
12	D3+	blue <i>(twisted pair)</i>	26
13	DC	white	26
14	RX- / D2-	orange <i>(twisted pair)</i>	26
15	RX+ / D2+	white-orange <i>(twisted pair)</i>	26

All dimensions are in mm; tolerances according to ISO 2768 m-H
 The pin assignment corresponds to the coding of the connector. Different assignments can cause malfunction or damage.

Dieses Dokument ist urheberrechtlich geschützt • This document is protected by copyright • Rosenberger Hochfrequenztechnik GmbH & Co. KG
 RF_35/09;14/6.2

MultiMag 15

Cable Assembly

L99-346-XXX

Interface

Mating with

M9K102-199 (Long receptacle with magnets, cable version)
 M9K103-400 (Short receptacle with magnets, PCB version)
 M9K115-400 (Long receptacle with magnets, PCB version)

Material and plating

Connector parts

Housing insert
 Housing parts 1 and 2
 Iron Core
 Bend protection

Material

PBT
 PC
 S235
 TPE

Plating / Color

similar RAL 9003
 similar RAL 9003
 similar RAL 9003

Spring loaded contacts

Piston
 Ferrule
 Spring

Material

Brass
 Brass
 Stainless steel

Plating / Color

AuroDur®, gold plated
 AuroDur®, gold plated
 min 0,1 µm Au over 2,5 µm Ni

Flammability rating

Connector parts

Housing insert
 Housing parts 1 and 2
 Bend protection

Category

uncolored raw material acc. to UL94 V-0*
 uncolored raw material acc. to UL94 HB*
 uncolored raw material acc. to UL94 HB*

*Please note that a non UL rated color batch is added

Electrical data

Operating voltage
 Operating current
 Contact resistance

12 V
 1.5 A per contact
 typically ≤ 60 mΩ

Mechanical data

Mating cycles
 Minimum bending radius

min. 1.000
 static: 28 mm, multiple: 56 mm

Environmental data

Temperature range
 RoHS

-25 °C to +75 °C
 compliant

Packing

Standard
 Weight

1 pce in plastic bag, 10 bags in box
 L99-346-3500 tbd g/pce
 L99-346-3000 173 g/pce
 L99-346-500 38 g/pce

While the information has been carefully compiled to the best of our knowledge, nothing is intended as representation or warranty on our part and no statement herein shall be construed as recommendation to infringe existing patents. In the effort to improve our products, we reserve the right to make changes judged to be necessary.

Draft	Date	Approved	Date	Rev.	Engineering change number	Name	Date
H. Wurm	19.04.13	T. Scheuerlein	07.06.16	700	16-0888	A. Streibl	07.06.16

Rosenberger Hochfrequenztechnik GmbH & Co. KG P.O.Box 1260 D-84526 Tittmoning Germany www.rosenberger.de				Tel. : +49 8684 18-0 Email : info@rosenberger.de		Page 3 / 3
--	--	--	--	--	--	---------------