

HSS



RoHS Compliant

Miniature Slide Switches



Part Numbering

HSS 1 12 A 12

Series code Number of poles Current Switching function Terminal style

1	1 pole		1 pole	2 poles	Switching function	None	#187 Tab terminal
2	2 poles		A	K	ON — OFF	12	Solder terminal
			D	N	ON — ON		

Terminal Styles

Single pole		Double poles	
Tab term.#187	Solder term.	Tab term.#187	Solder term.

Panel Cut Out Dimension

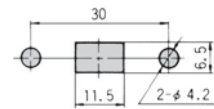

Table of Part Numbers → Page 524.

HSS112

1 pole

Opposite side 4.6
Depth 1.0

Stroke (5)

Part number marking side

Solder term.

Terminal numbers are shown on the bottom of the switch.

S/D

Dimension L

Part No.	Terminal style	TAB#250	Solder
HSS112A	■	24	20.5
HSS112D	■	24	20.5

Specifications

	Rating	Initial contact resistance	Dielectric strength	Insulation resistance	Electrical life
HSS112A	AC125V 12A Max. AC250V 6A Max.	100mΩ Max. (DC2~4V 1A)	AC1500V 1 minute	100MΩ Min. (DC500V)	15,000 cycles
HSS112D	AC-DC 6V 1mA Min.				

Part No.	Switching function	
	Viewed from part No. marking side	
HSS112A		
Connecting terminals	2-1	—
HSS112D		
Connecting terminals	2-1	2-3

HSS208

2 pole

Opposite side 4.6
Depth 1.0

Stroke (5)

Part number marking side

Solder term.

Terminal numbers are shown on the bottom of the switch.

S/D

Part No. marking

TAB#187

TAB

Specifications

	Rating	Initial contact resistance	Dielectric strength	Insulation resistance	Electrical life
HSS208K	AC125V 8A Max. AC250V 5A Max.	100mΩ Max. (DC2~4V 1A)	AC1500V 1 minute	100MΩ Min. (DC500V)	15,000 cycles
HSS208N	AC-DC 6V 1mA Min.				

Part No.	Switching function	
	Viewed from part No. marking side	
HSS208K		
Connecting terminals	2-1 5-4	—
HSS208N		
Connecting terminals	2-1 5-4	2-3 5-6

■ To check the full part number of the products marked with the ■, please refer to "Table of Part Numbers" on P. 530.