

1 0 1 0 2
3 0 0 4
a-L-b (+)

SPST
CONTACT CONFIGURATION

PARTS LIST		
ITEM	QTY.	PART NO. PART DESCRIPTION
1	1	F040009 D16 OA R1 1
2	1	F050405 50-004-05 (28V INCANDESCENT LAMP)
3	1	F050112 50-001-12 (TRANSPARENT GREEN LENS)

NOTES:

1. ALL DIMENSIONS IN MM
2. GENERAL TOLERANCE: X.X=±0.4
X.XX=±0.25
3. RATINGS: 5A @250V AC;
8A @125V AC
4. CONTACT MATERIAL:
COPPER ALLOY W/Silver Plating
5. TRAVEL: 3.00mm

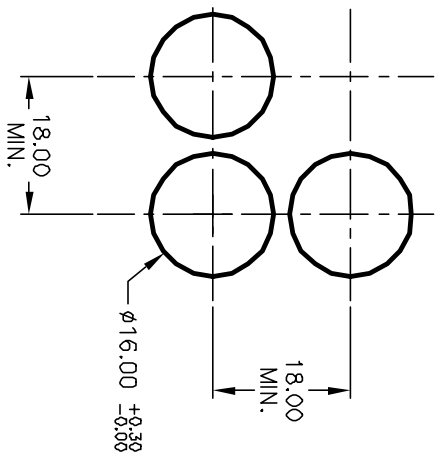

RECOMMENDED PANEL MOUNTING
SCALE 1:1

REV.	ECN No.	DESCRIPTION	DATE	CHKD
A	12848	ADD TR/FLAT TO DESC.	2/27/03	CJB
B	12946	CORRECT PARTS LIST DISC.	3/24/03	AR

TITLE	SCALE	DATE	DR	DWG	REV
D16 DA R11 C GRN TRANSPARENT /FLAT LENS	1.5:1	2/27/03	CB	XF0542P	B



THE INFORMATION CONTAINED IN THIS DOCUMENT IS PROPRIETARY TO E-SWITCH AND IS NOT TO BE COPIED OR TRANSFERRED