

DETAILS

Product Number	CN13131_MIRELLA-50-M-DL-PF
Family	Mirella
Type	RefPack
Color	metal
Diameter	49,9 mm
Height	25,5 mm
Style	round
Optic Material	PC
Holder Material	
Fastening	glue, screw
Status	production ready
ROHS Compliant	Yes
Date Updated	31/10/2016



OPTICAL PROPERTIES

LED	Viewing	Light	Effi-		Connector
	Angle	Beam	ciency	cd/lm	
CLL01x	28 deg	Medium	86 %	2.300	-
CLL02x/CLU02x (LES10)	31 deg	Medium	87 %	2.300	-
CLU700/701	24 deg	Medium	81 %	2.500	-
MT-G	36 deg	Medium	87 %	1.900	-
MT-G2	32 deg	Medium	86 %	2.000	-
MK-R	23 deg	Medium	80 %	2.600	-
XHP50	24 deg	Medium	84 %	2.500	-
XHP70	28 deg	Medium	82 %	2.200	-
MHD-E/G	29 deg	Medium	86 %	2.000	-
COB 4W	29 deg	Medium	85 %	2.400	-
CXM-9	35 deg	Medium	84 %	1.700	-
Duris S10	31 deg	Medium	80 %	1.900	LEDiL: LEDiL
Soleriq S9	sim: 32	Medium	sim: 85 %	sim: 2.100	LEDiL: LEDiL
ZC4/6	32 deg	Medium	83 %	2.100	-
Mini Zenigata (GW6BM)	30 deg	Medium	83 %	1.900	-

Relative intensity of CN13131_MIRELLA-50-M-DL-PF-(CLL010)

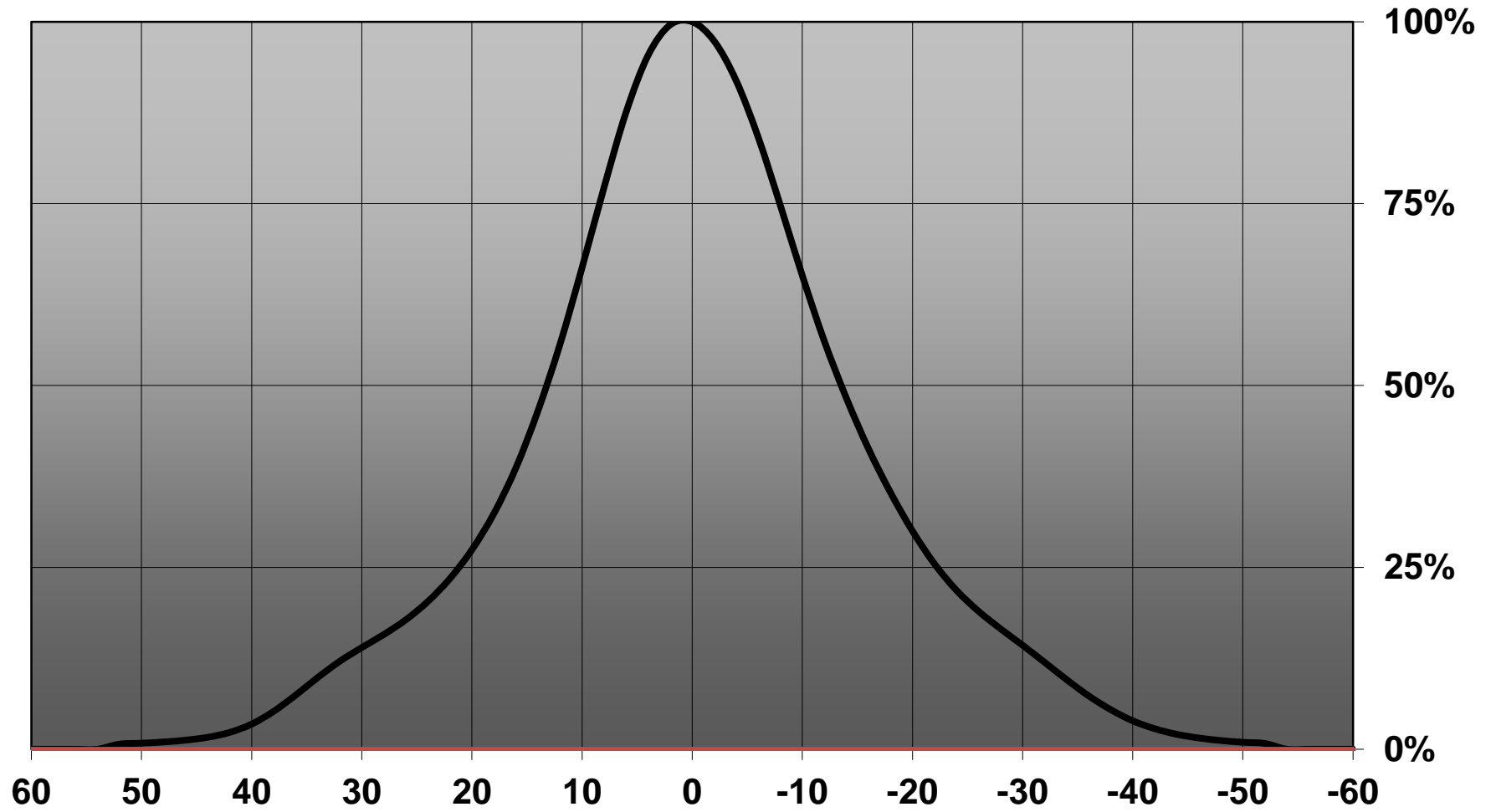

Relative intensity of CN13131_MIRELLA-50-M-DL-PF-(CLL020)

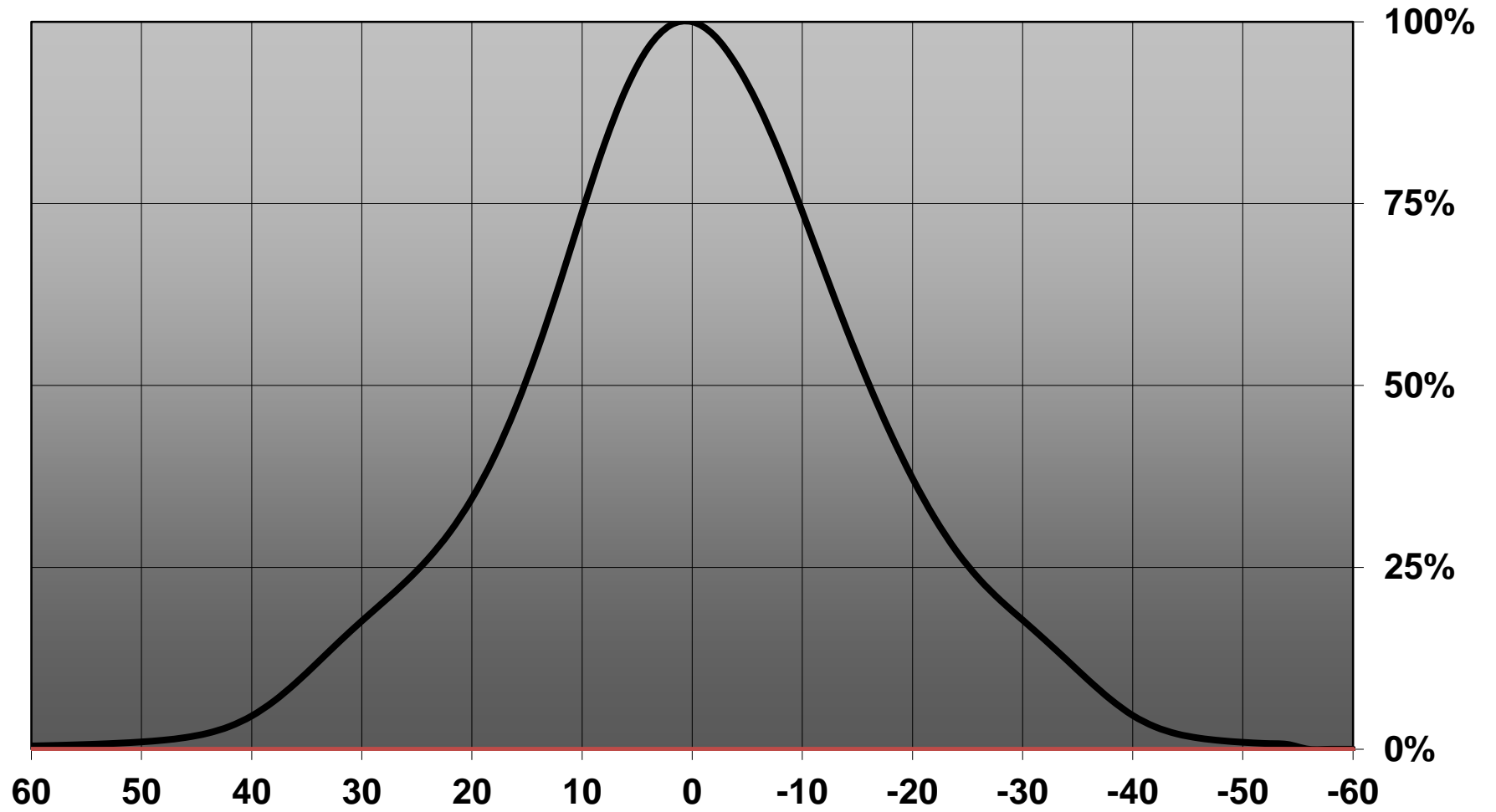

Relative intensity of CN13131_MIRELLA-50-M-DL-PF-(MTG)

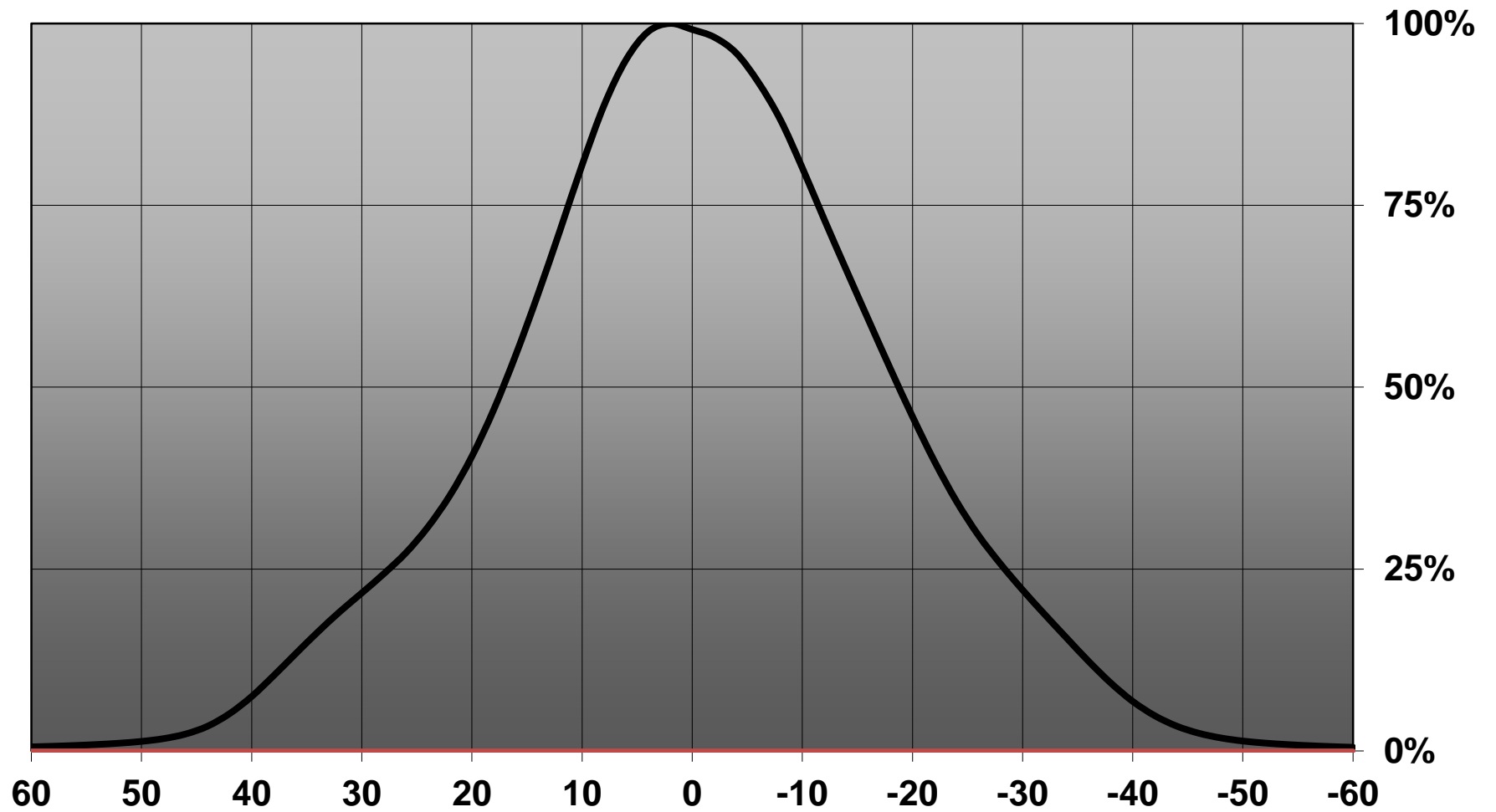

Relative intensity of CN13131_MIRELLA-50-M-DL-PF-(MTG2)

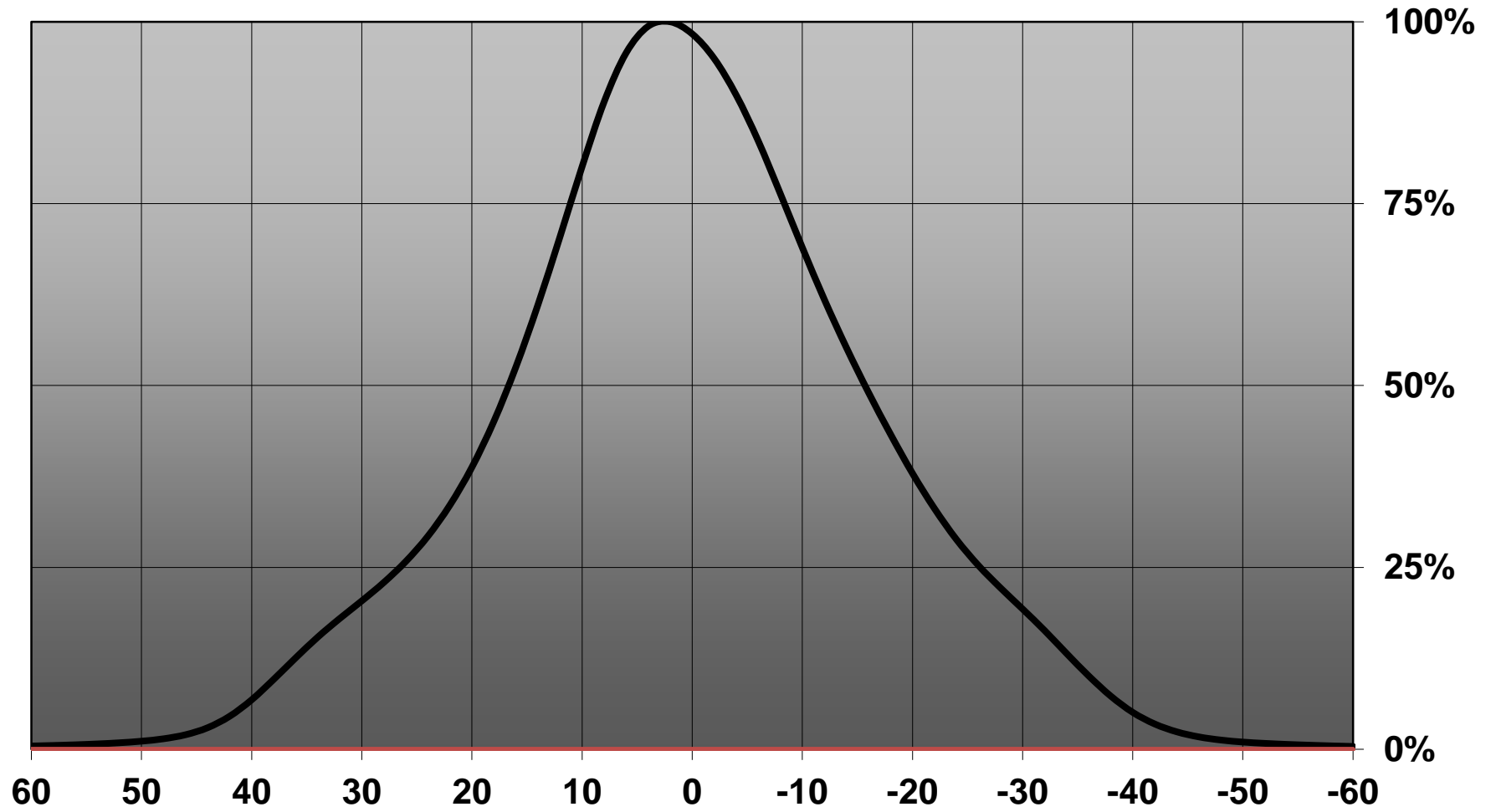

Relative intensity of Mirella-M-DL-4WLG

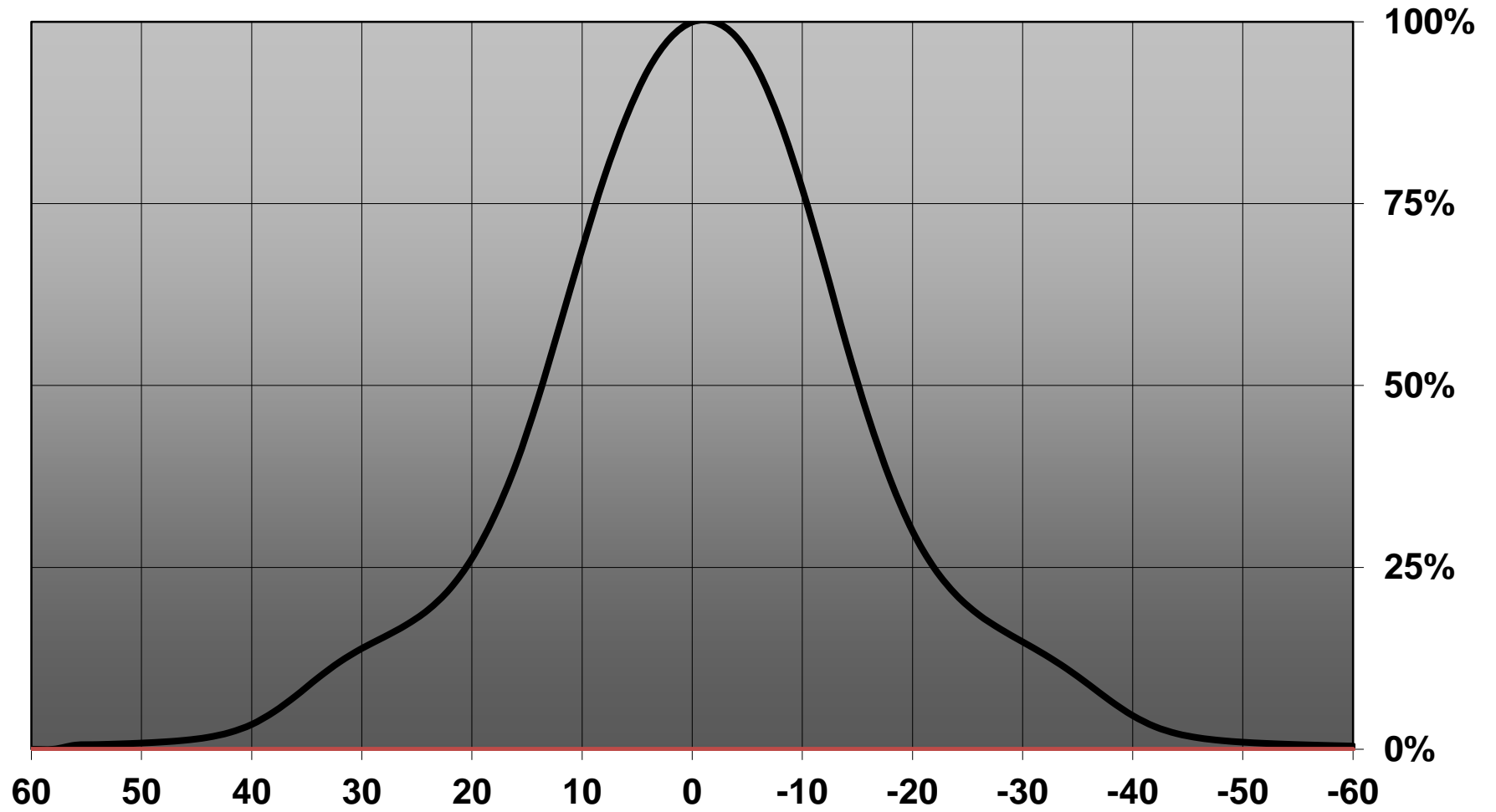

Relative intensity of CN13131_MIRELLA-50-M-DL-PF_(Duris_S10)

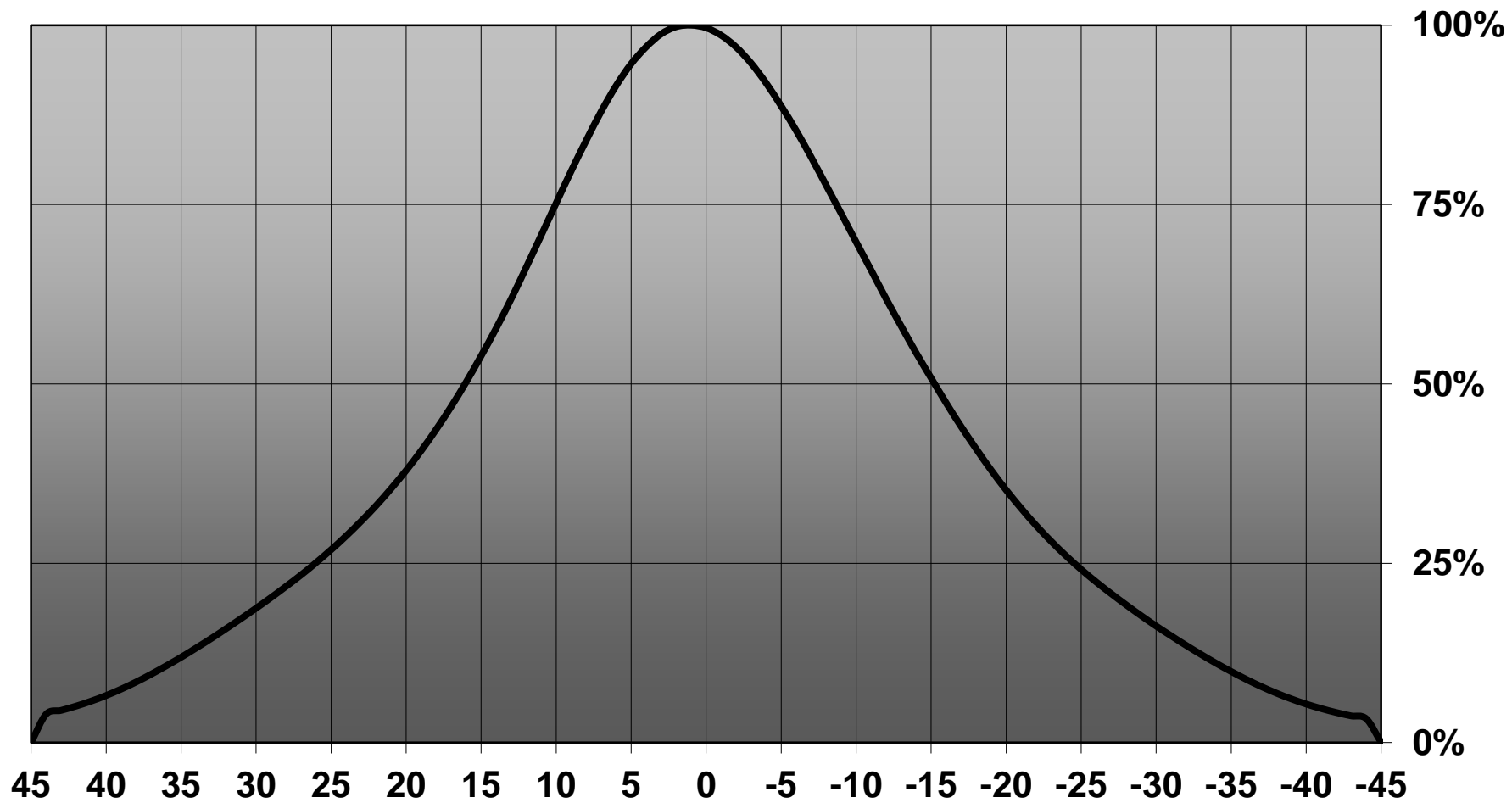

D

C

B

A

4

4

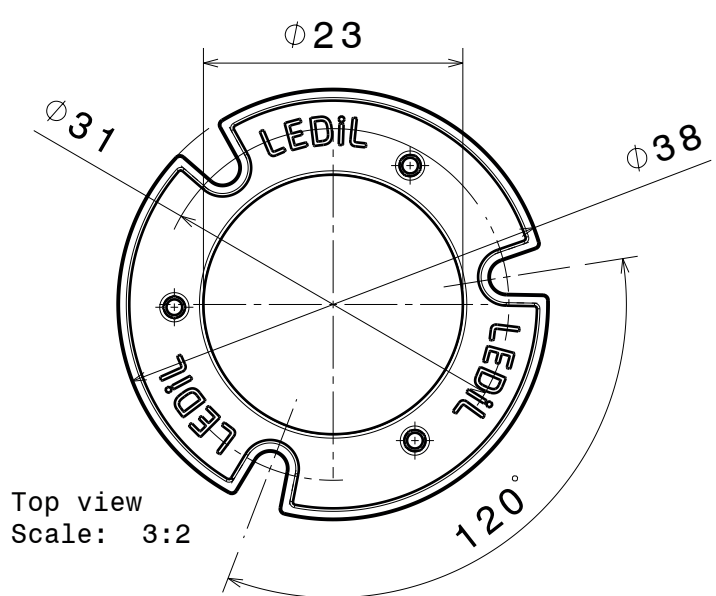

Top view
Scale: 3:2

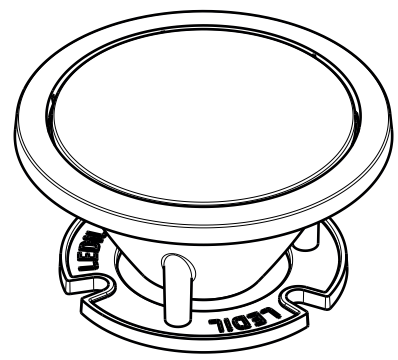

Isometric view

3

3

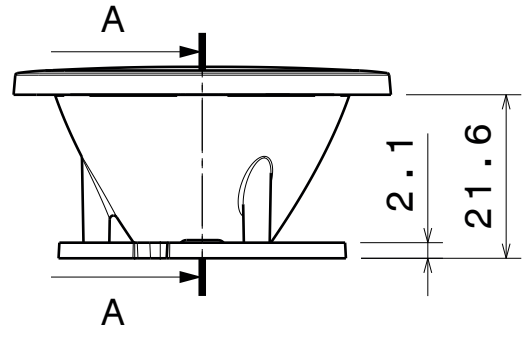

Front view

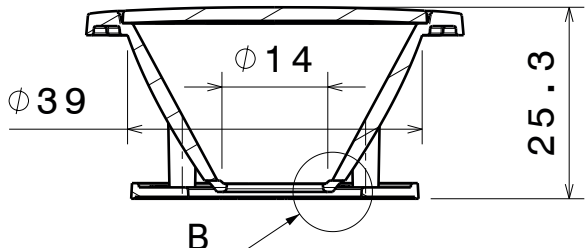

Section view A-A

2

2

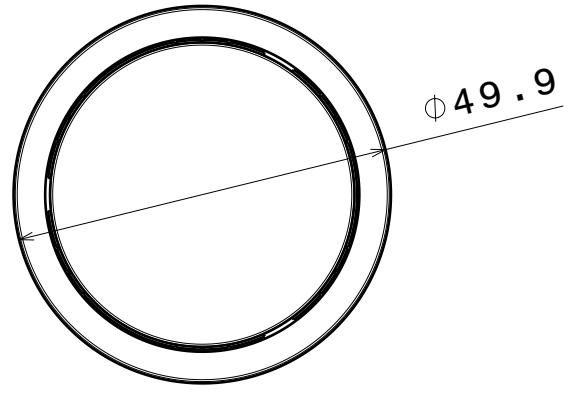

Top view

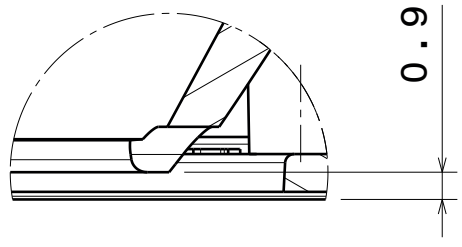

Detail B

NOTE: It is recommended to use glue like DELO-PUR 9895 for pin fastening.
[http://www.delo.de/fileadmin/datasheet/DELO-PUR_9895_\(TIDB-GB\).pdf](http://www.delo.de/fileadmin/datasheet/DELO-PUR_9895_(TIDB-GB).pdf)

This drawing is our property.
 It can't be reproduced
 or communicated without
 our written agreement.



DRAWING TITLE Mechanical drawing

DRAWN BY
as

DATE
28.8.2012

MIRELLA-DL-PF

CHECKED BY
VS

DATE
28.8.2012

SIZE
A4

REV
001

DESIGNED BY
as

DATE
-

SCALE 1:1

WEIGHT -

SHEET 1/1

D

A

1

1

Luminaire: LEDiL Oy CN13131_MIRELLA-50-M-DL-PF_(CLU700)

Lamps: 1 x Citizen_CLU700_C13083_PF-SOCKET_394.785lm@100mA_P=2.92999W_I=0.1044A

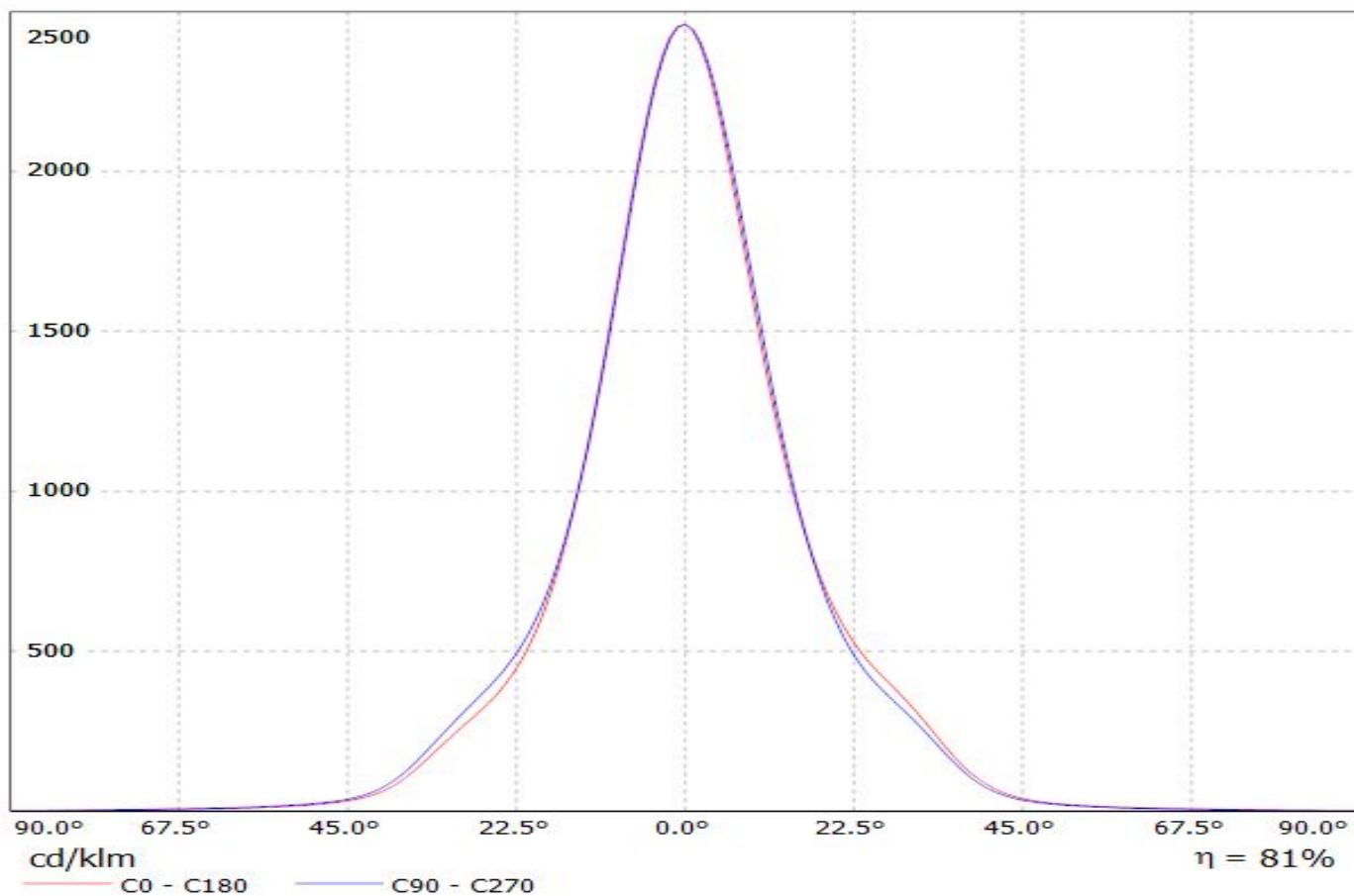

Luminaire: LEDiL Oy CN13131_MIRELLA-50-M-DL-PF_(MK-R) Eff 80.2%
Lamps: 1 x CREE_MK-R_358.348lm@250mA_P=2.84311W_I=249.9mA

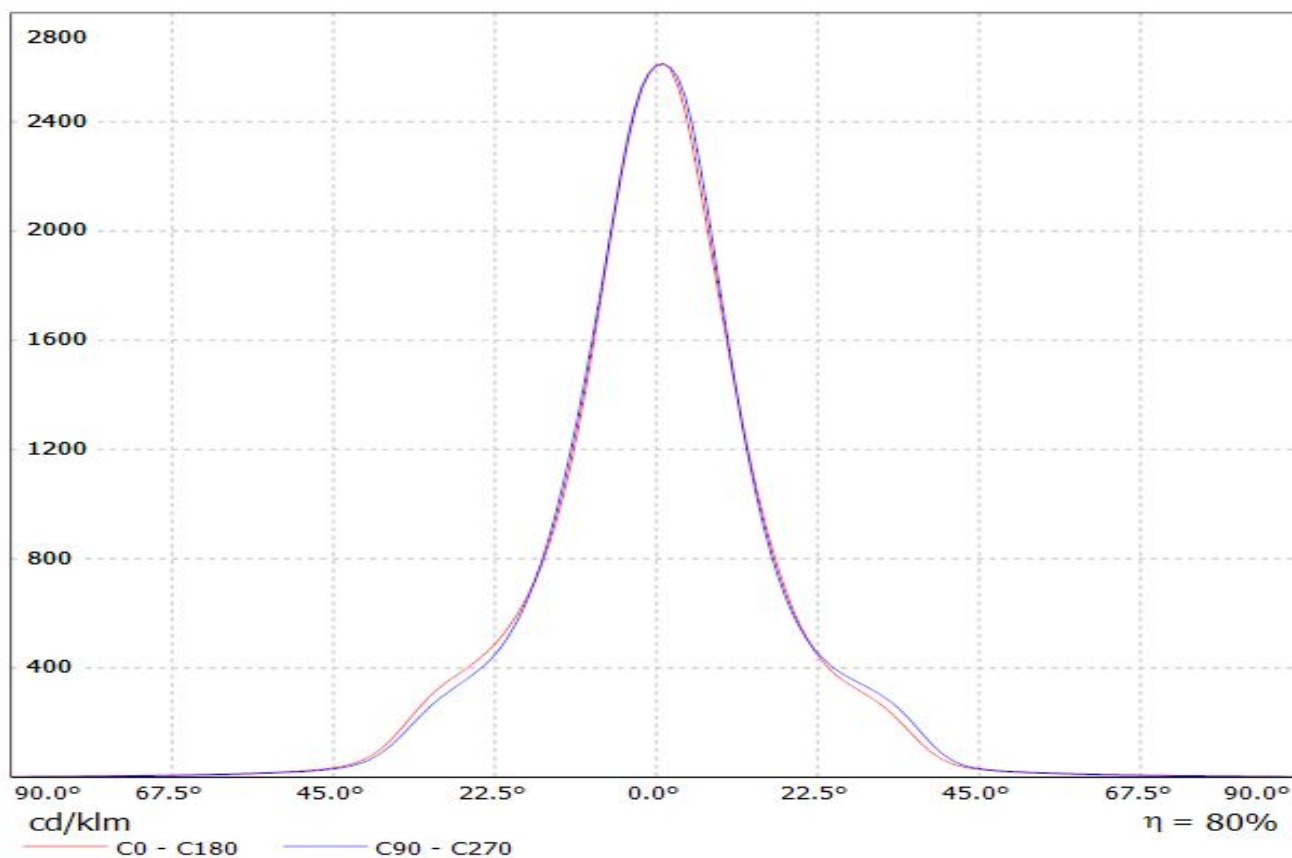

Luminaire: LEDiL Oy CN13131_MIRELLA-50-M-DL-PF_(CREE_XHP50_WARM_WHITE)
Lamps: 1 x CREE_XHP50_WARM_WHITE_194.142lm@250mA_P=1.39939W_I=0.2499A

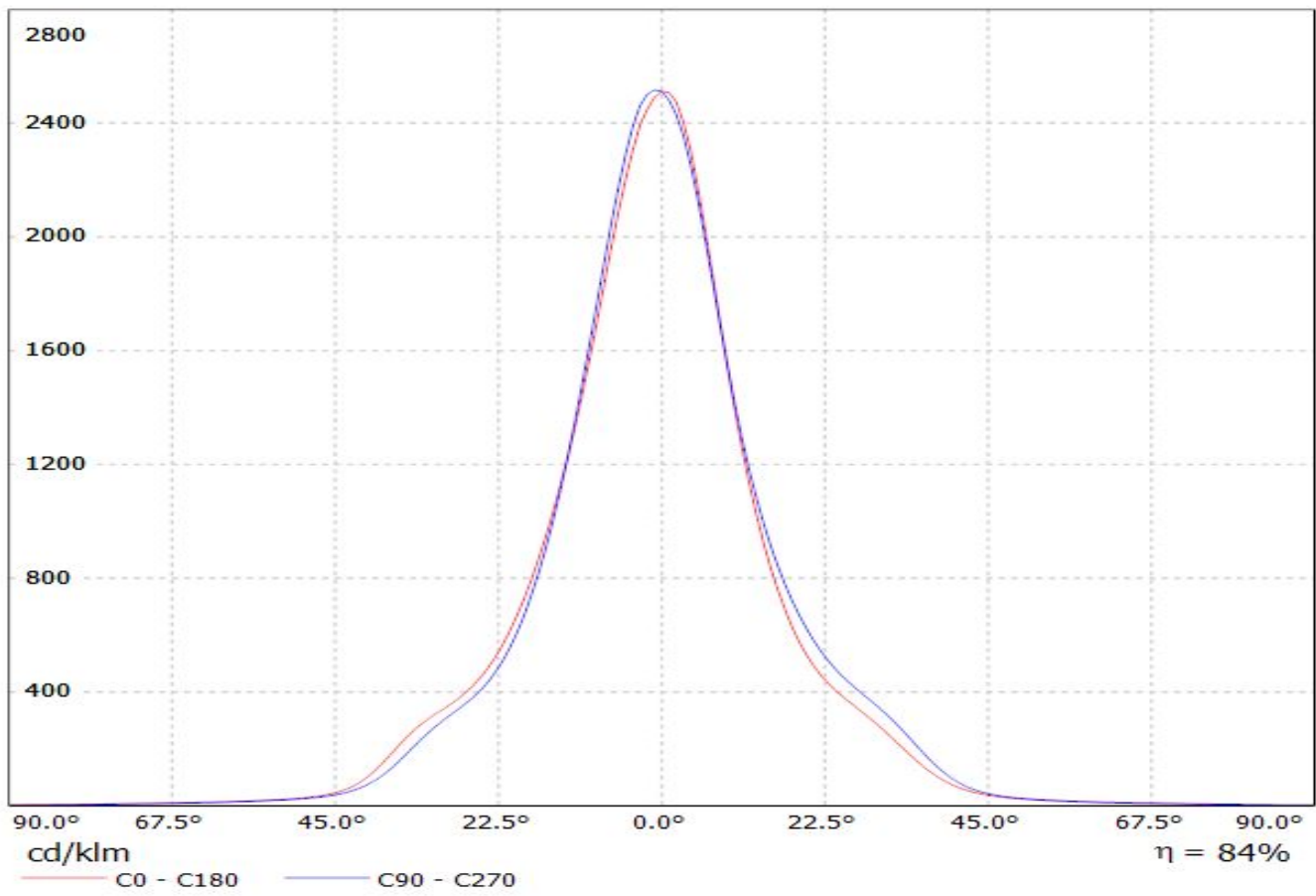

Luminaire: LEDiL Oy CN13131_MIRELLA-50-M-DL-PF_(CREE_XHP70)
Lamps: 1 x CREE_XHP70_260.212lm@250mA_P=1.383W_I=0.2499A

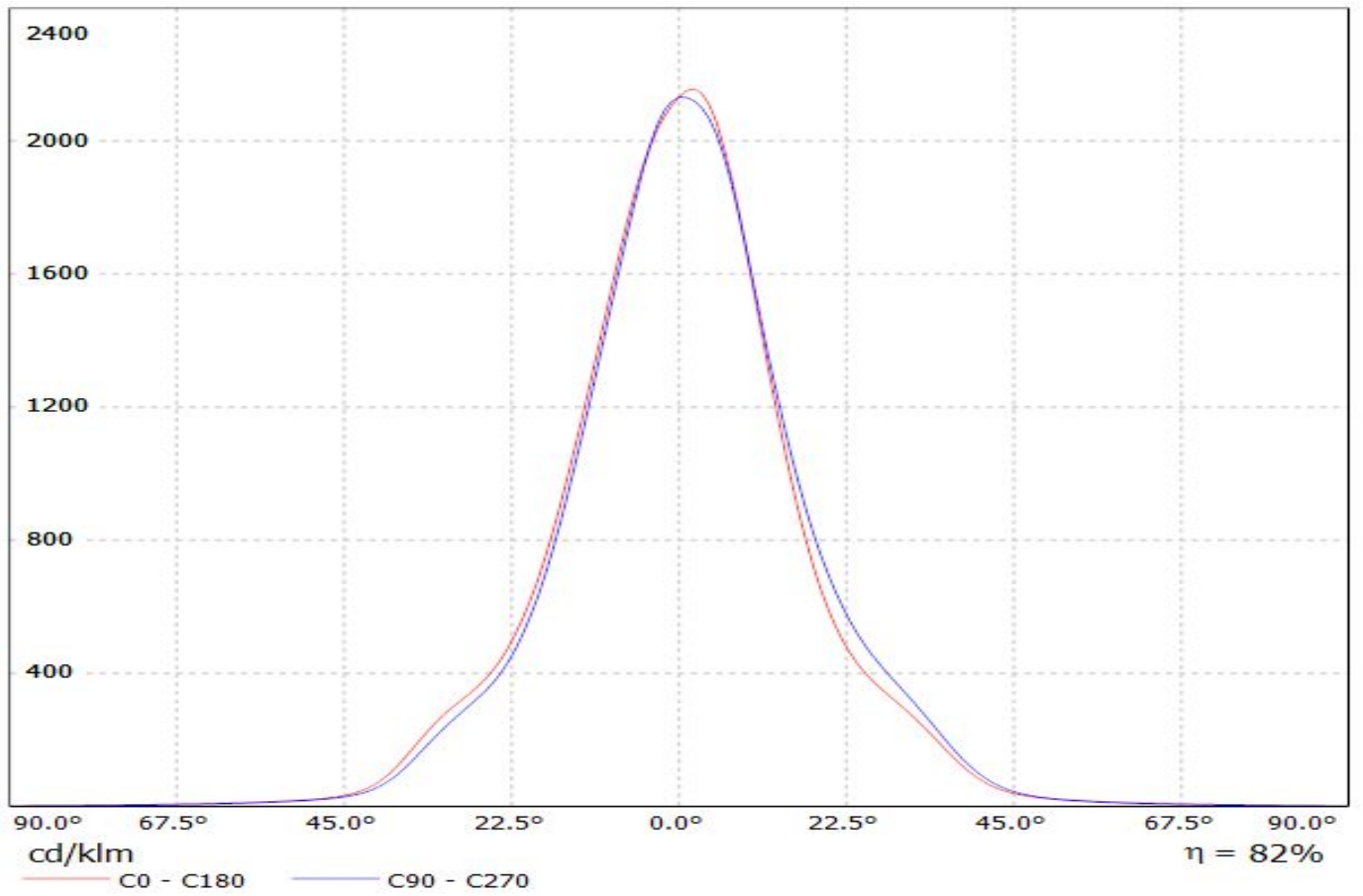

Luminaire: Ledil CN13131_MIRELLA-50-M-DL-PF_(MHD-G)
Lamps: 1 x Cree MHD-G_530.44lm@100mA_P=3.0W_I=0.100A

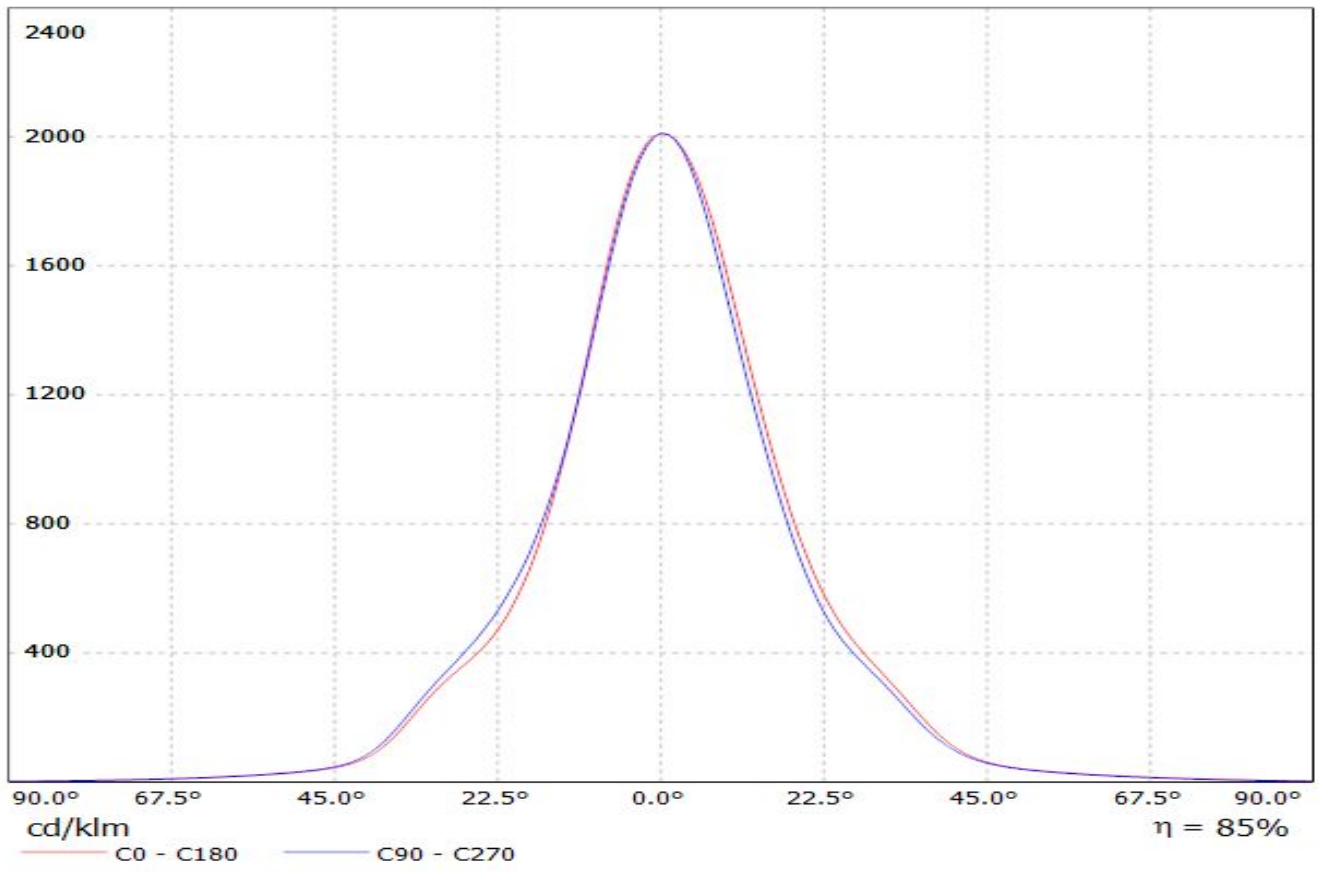

Luminaire: LEDiL Oy CN13131_MIRELLA-50-M-DL-PF_(CXM-9)

Lamps: 1 x Luminus_XNOVA_CXM-9_(AA00)_974.297lm@240mA_P=8.2836W_I=240mA

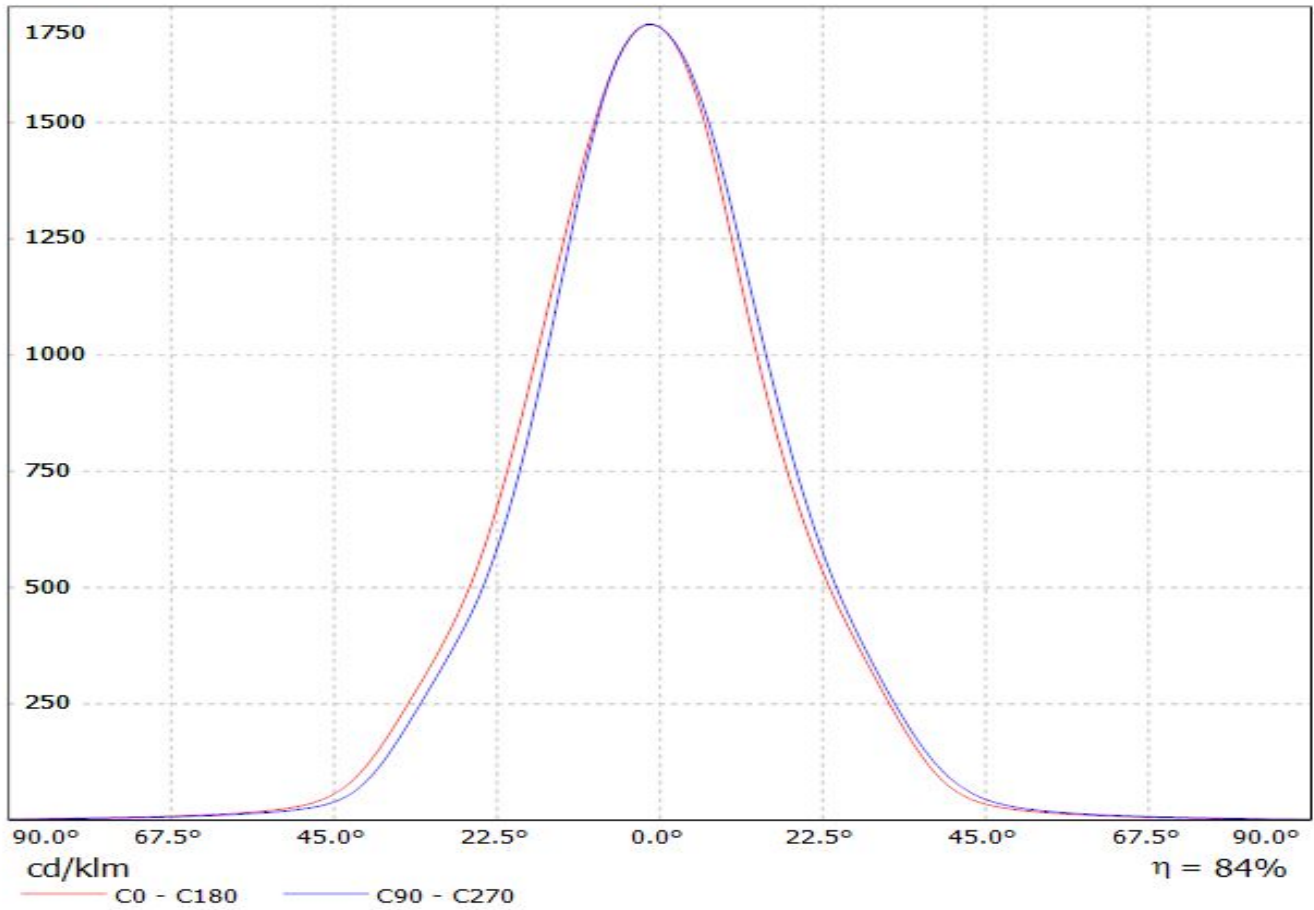

Luminaire: Ledil Oy CN13131_MIRELLA-50-M-DL-PF_(Soleriq_S9)_SIMULATED
Lamps: 1 x Osram Soleriq S9 (GW KAJFB3.EM)

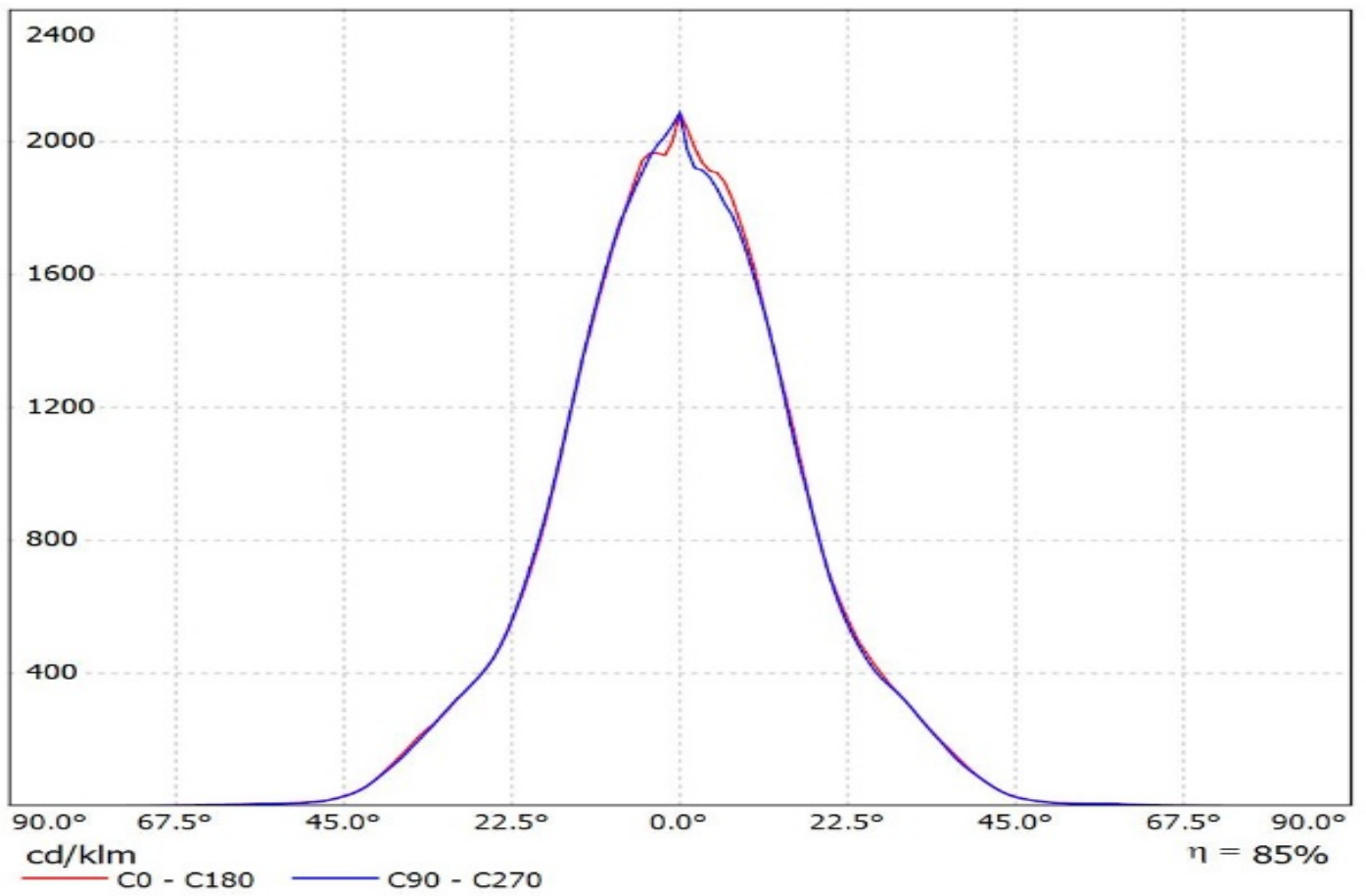

Luminaire: LEDil Oy CN13131_MIRELLA-50-M-DL-PF_(ZC6) Efficiency=83%
Lamps: 1 x Seoul ZC6 (SDW81F1C) 422lm @ 100mA CCT=3100K P=3.4W I=100mA

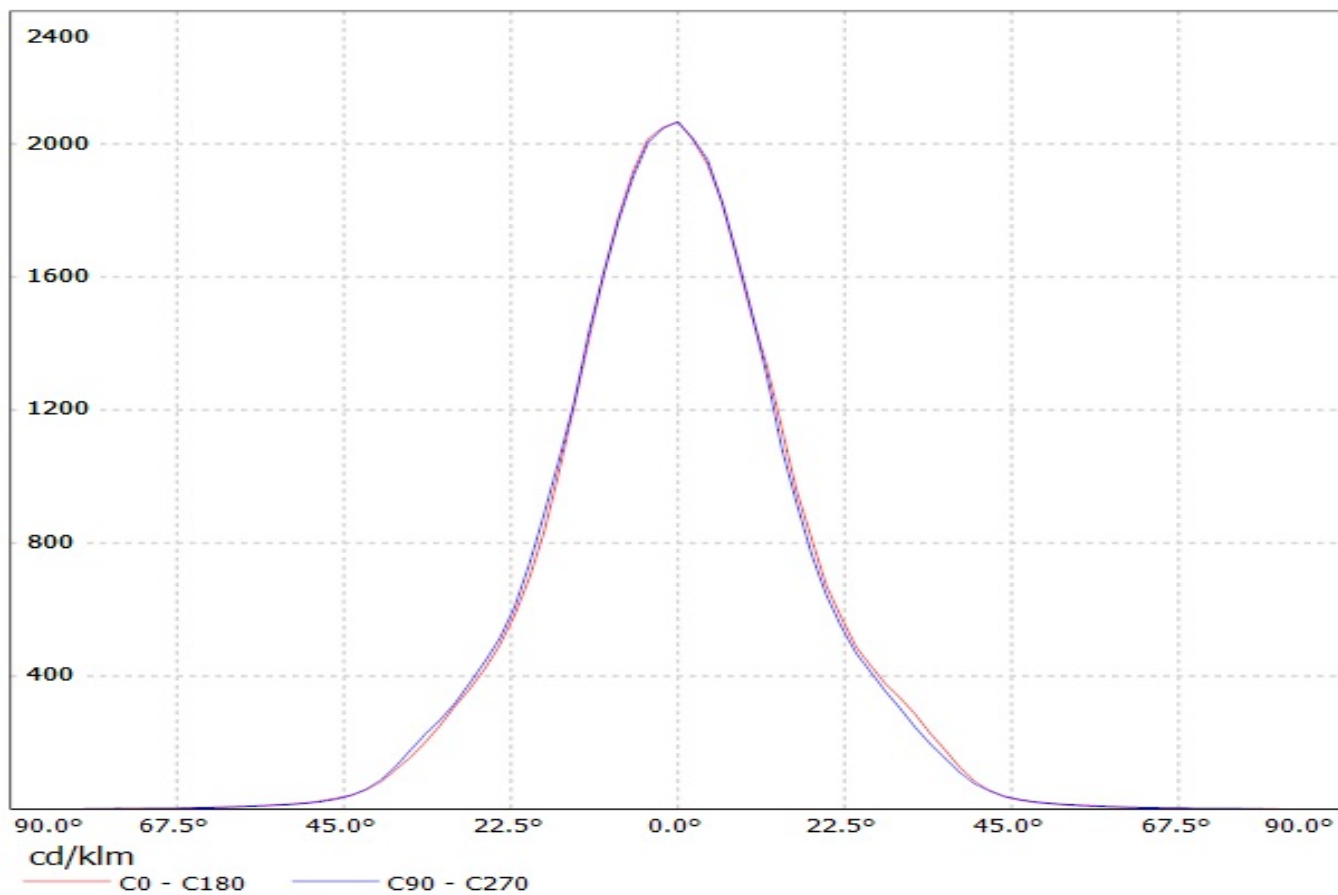

Luminaire: LEDiL Oy CN13131_MIRELLA-50-M-DL-PF_(Mini_Zenigata_GW6BM) Eff.83.3%
Lamps: 1 x Mini_Zenigata_GW6BM (803.772lm@250mA)

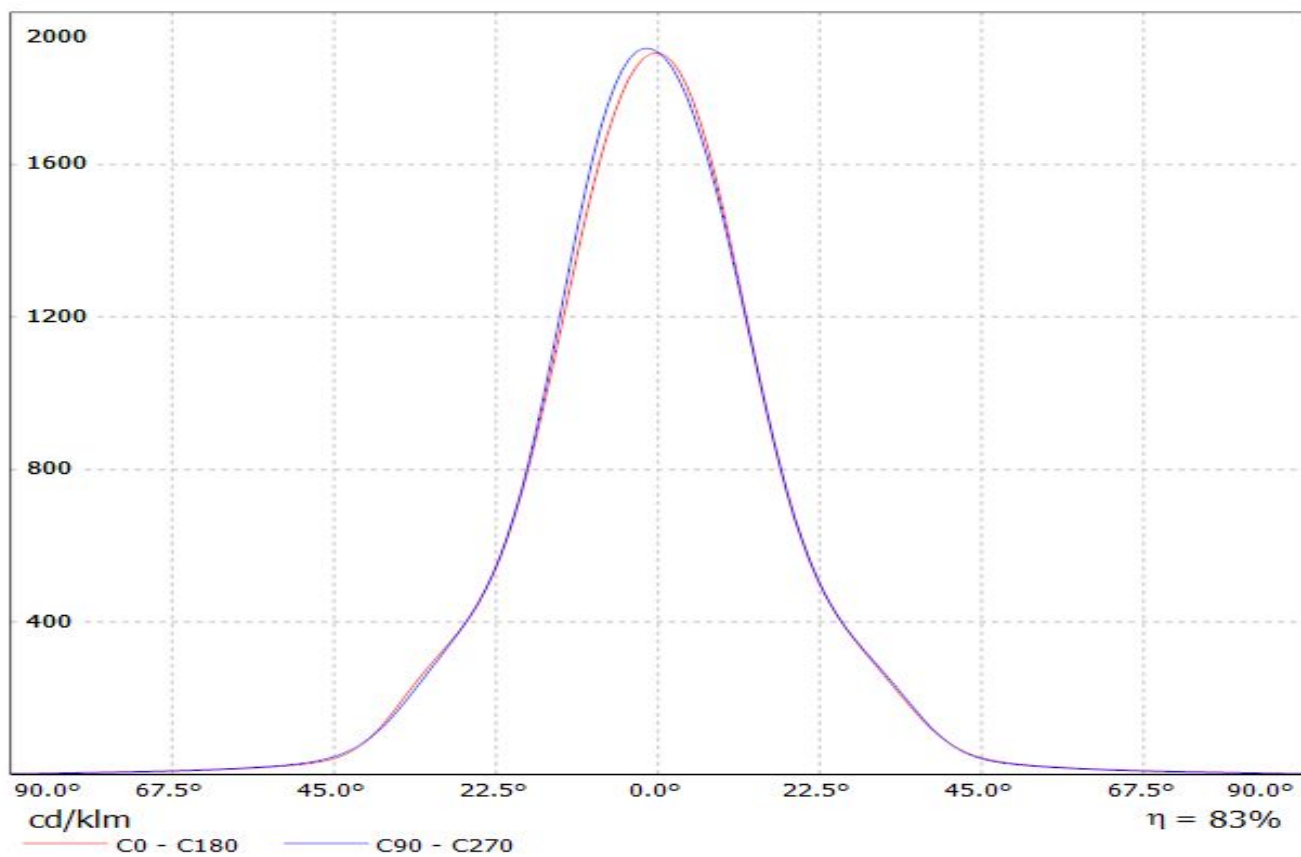

Luminaire: LEDiL Oy CN13131_MIRELLA-50-M-DL-PF_(CLU700)

Lamps: 1 x Citizen_CLU700_C13083_PF-SOCKET_394.785lm@100mA_P=2.92999W_I=0.1044A

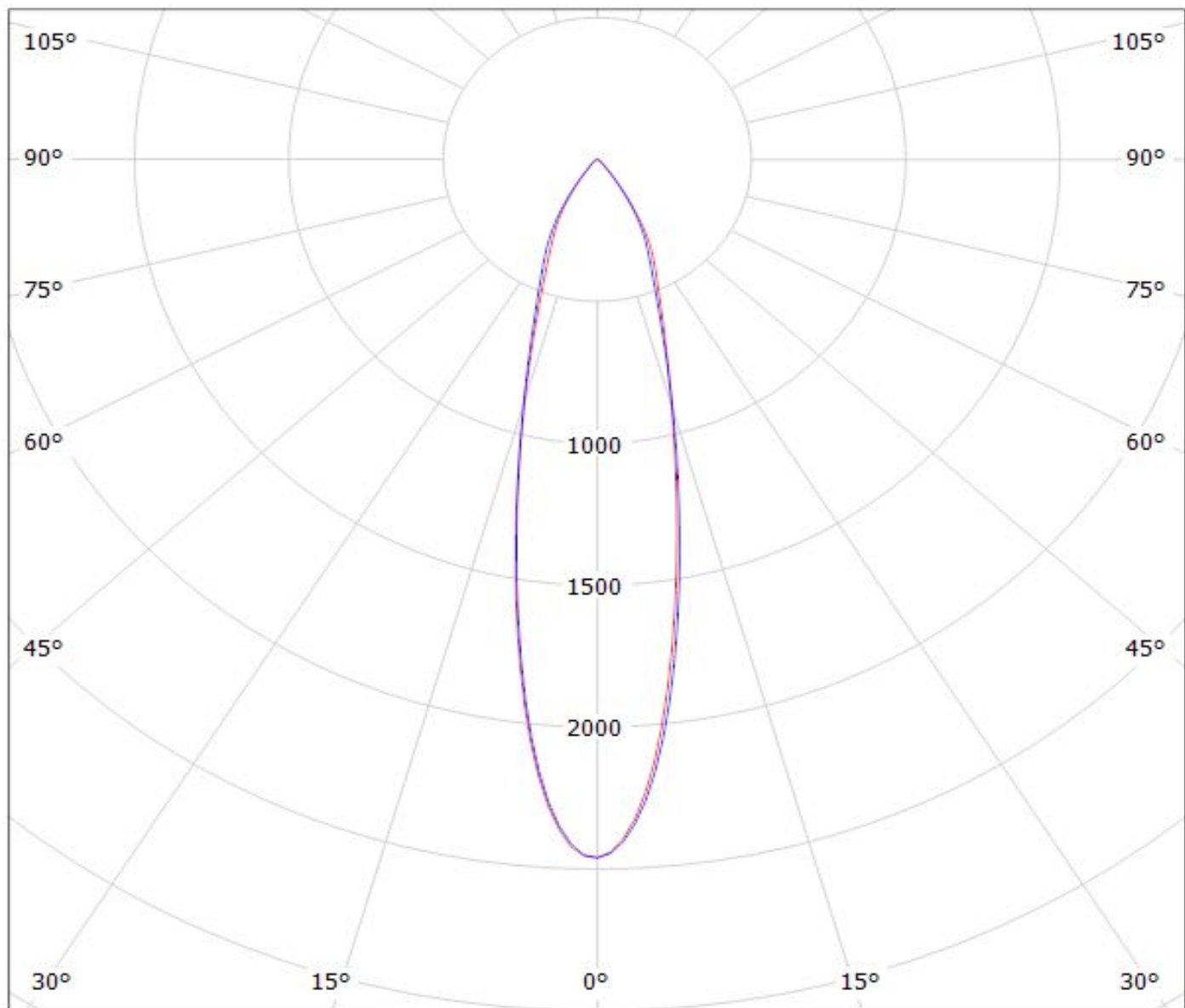

cd/klm

— C0 - C180

— C90 - C270

$\eta = 81\%$

Luminaire: LEDiL Oy CN13131_MIRELLA-50-M-DL-PF_(MK-R) Eff.80.2%
Lamps: 1 x CREE_MK-R_358.348lm@250mA_P=2.84311W_I=249.9mA

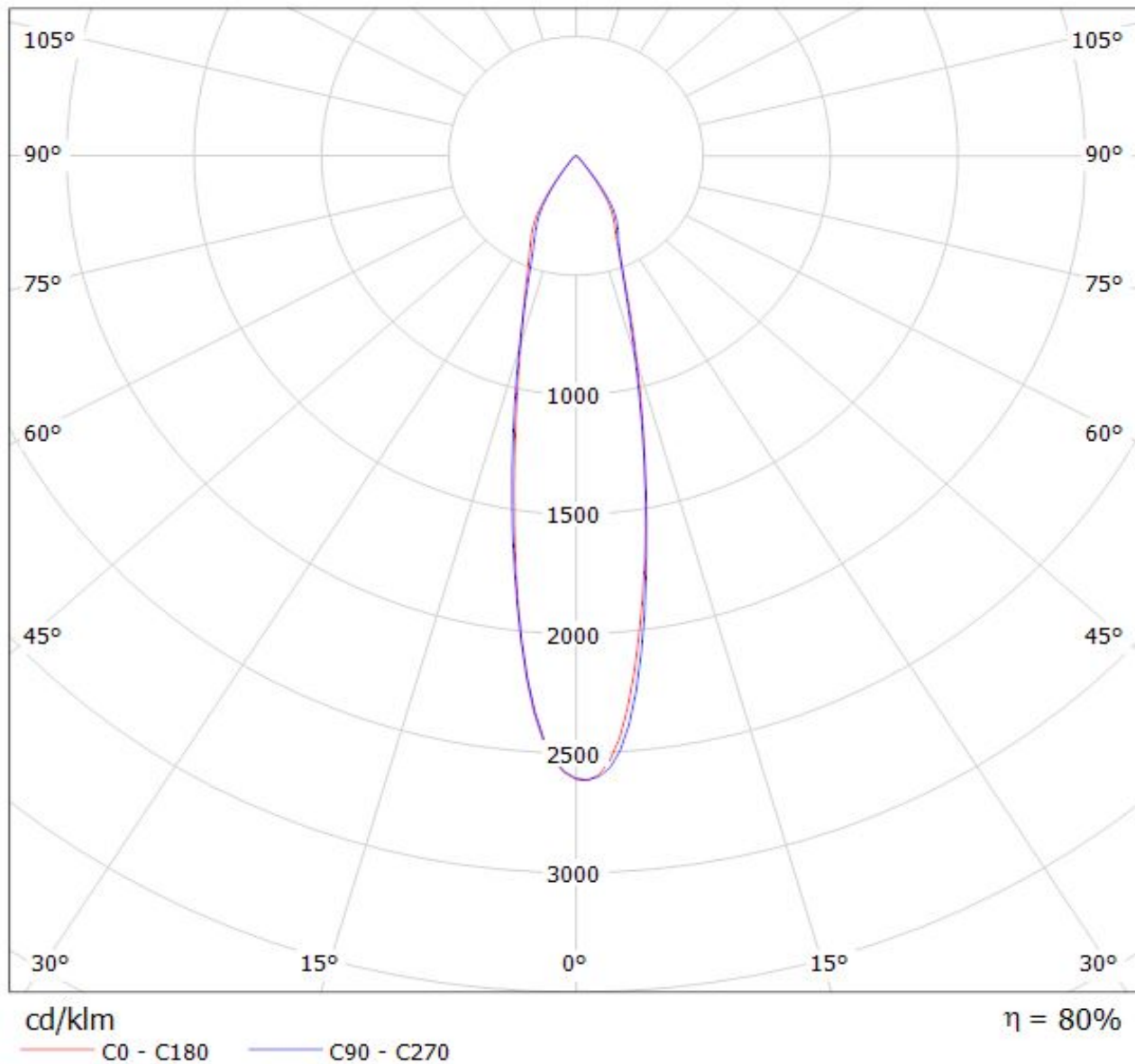

Luminaire: LEDiL Oy CN13131_MIRELLA-50-M-DL-PF_(CREE_XHP50_WARM_WHITE)
Lamps: 1 x CREE_XHP50_WARM_WHITE_194.142lm@250mA_P=1.39939W_I=0.2499A

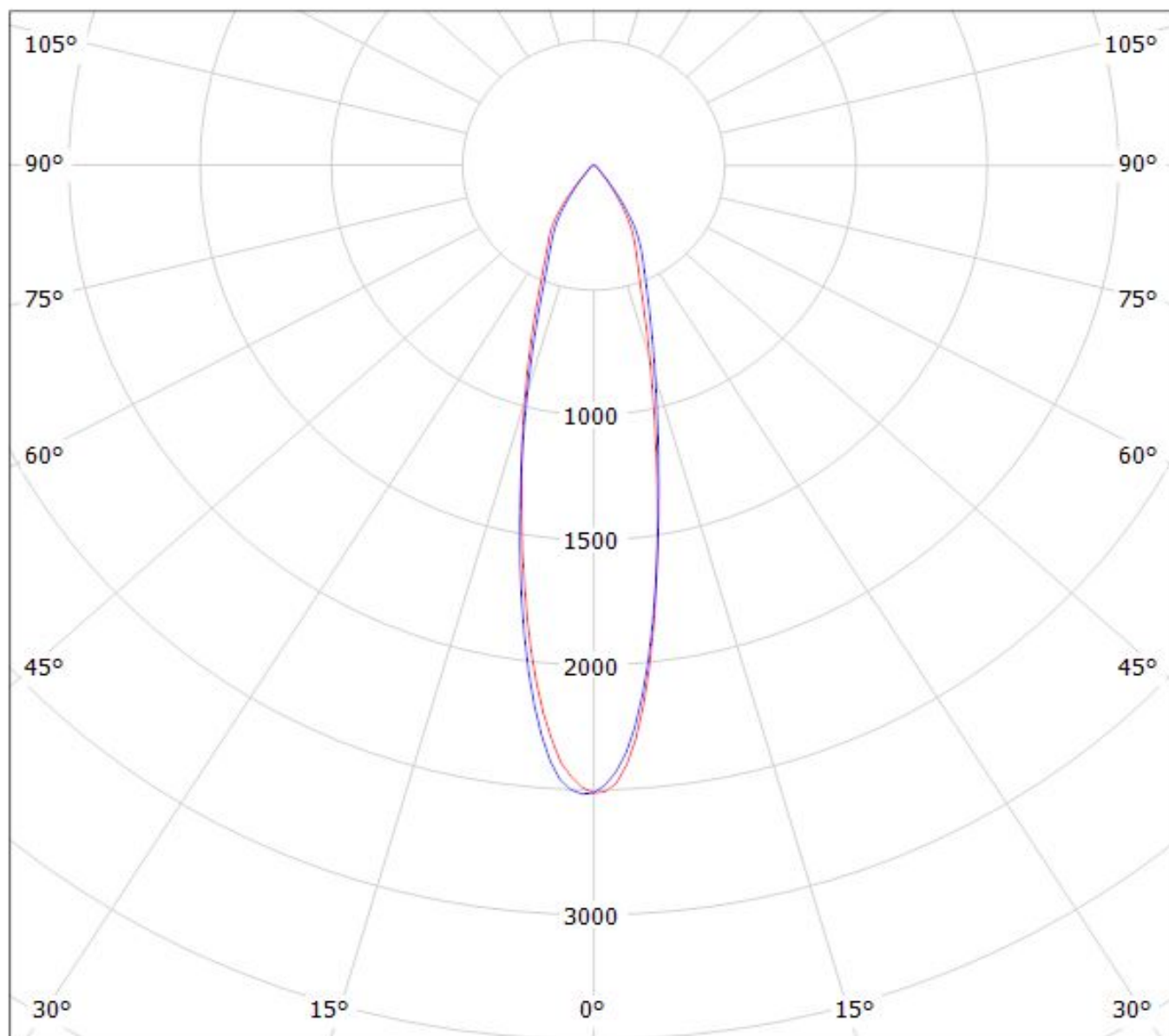

cd/klm

— C0 - C180 — C90 - C270

$\eta = 84\%$

Luminaire: LEDiL Oy CN13131_MIRELLA-50-M-DL-PF_(CREE_XHP70)
Lamps: 1 x CREE_XHP70_260.212lm@250mA_P=1.383W_I=0.2499A

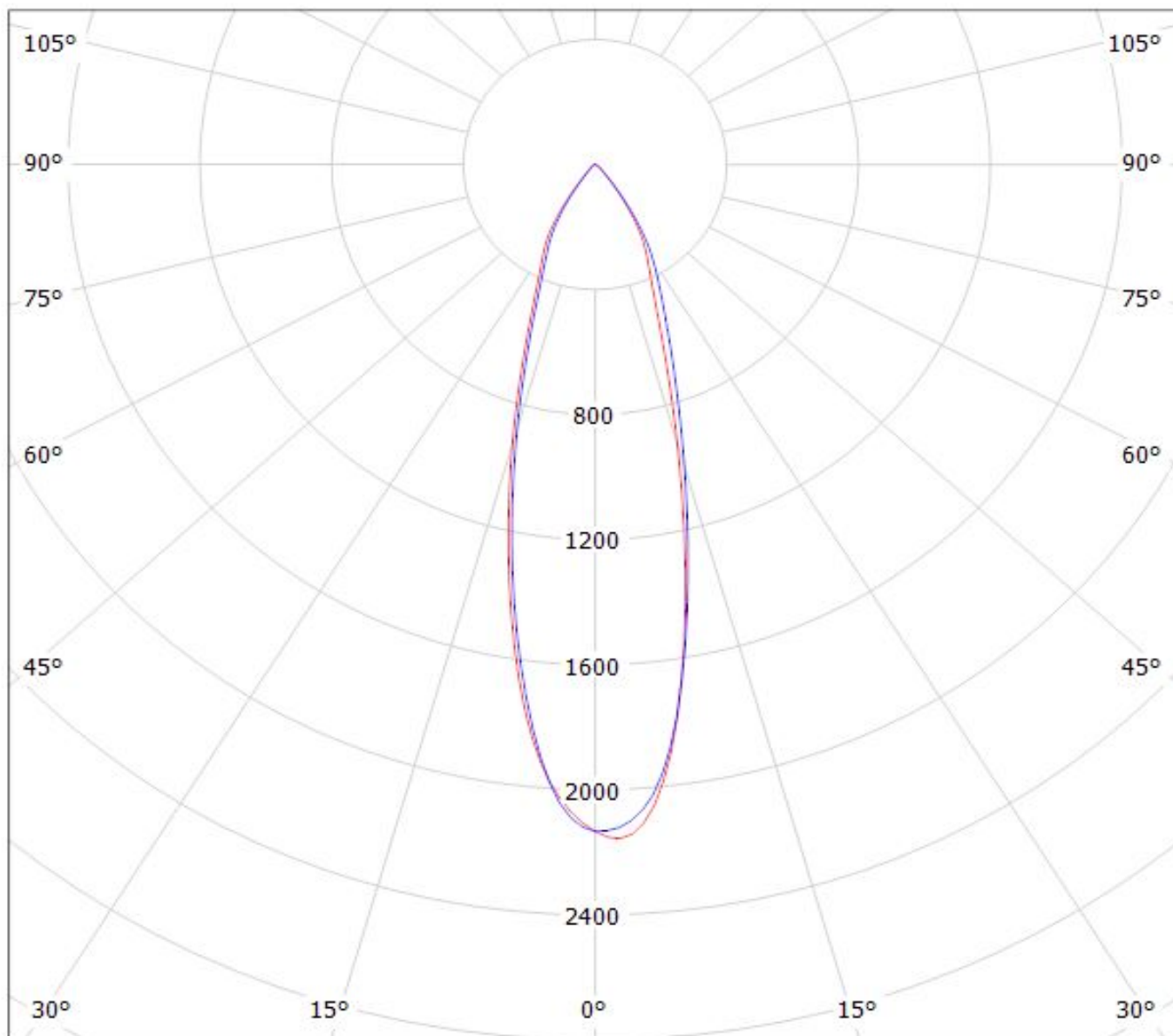

cd/klm

— C0 - C180 — C90 - C270

$\eta = 82\%$

Luminaire: Ledil CN13131_MIRELLA-50-M-DL-PF_(MHD-G)
Lamps: 1 x Cree MHD-G_530.44lm@100mA_P=3.0W_I=0.100A

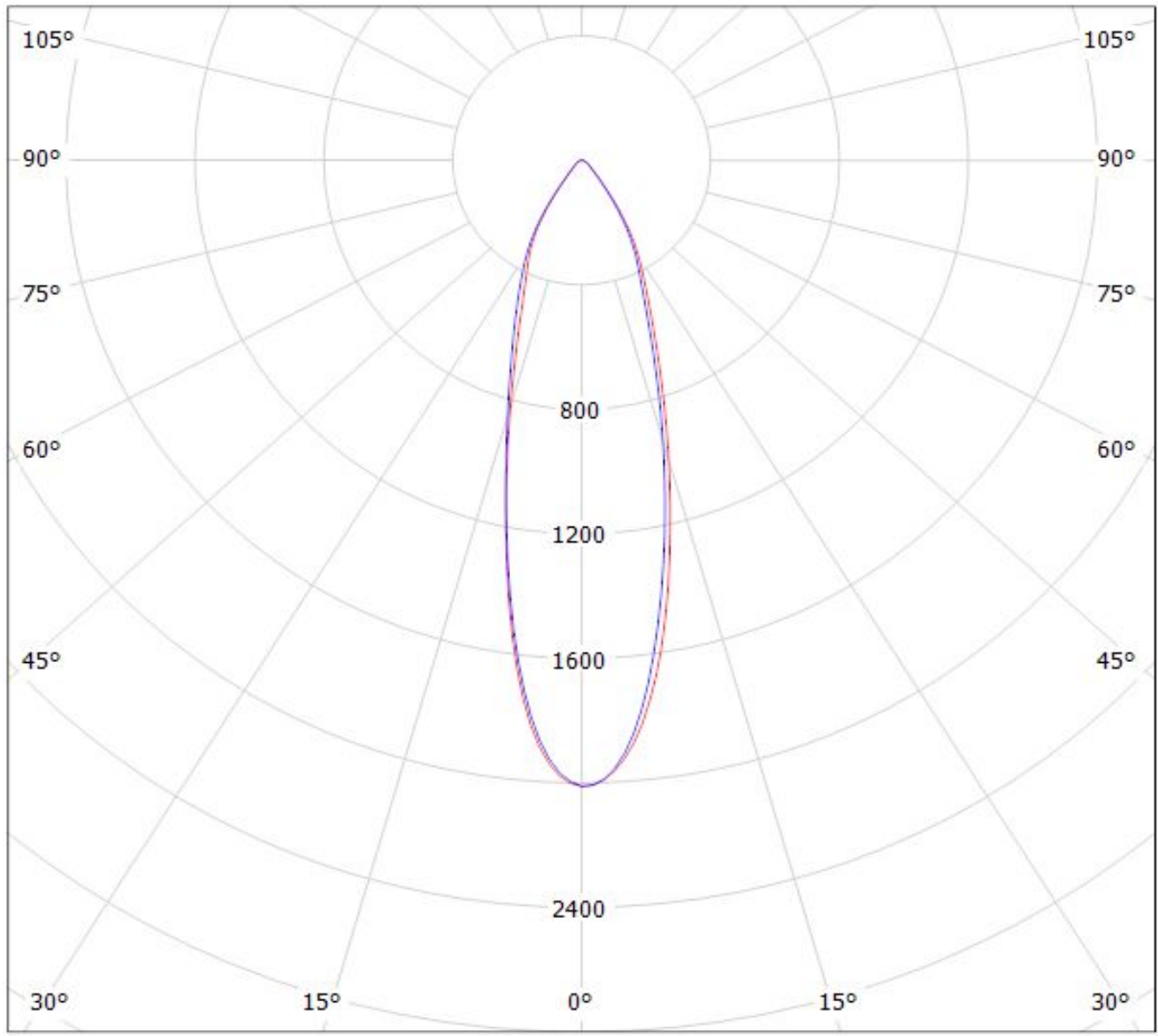

cd/klm

— C0 - C180

— C90 - C270

$\eta = 85\%$

Luminaire: LEDiL Oy CN13131_MIRELLA-50-M-DL-PF_(CXM-9)

Lamps: 1 x Luminus_XNOVA_CXM-9_(AA00)_974.297lm@240mA_P=8.2836W_I=240mA

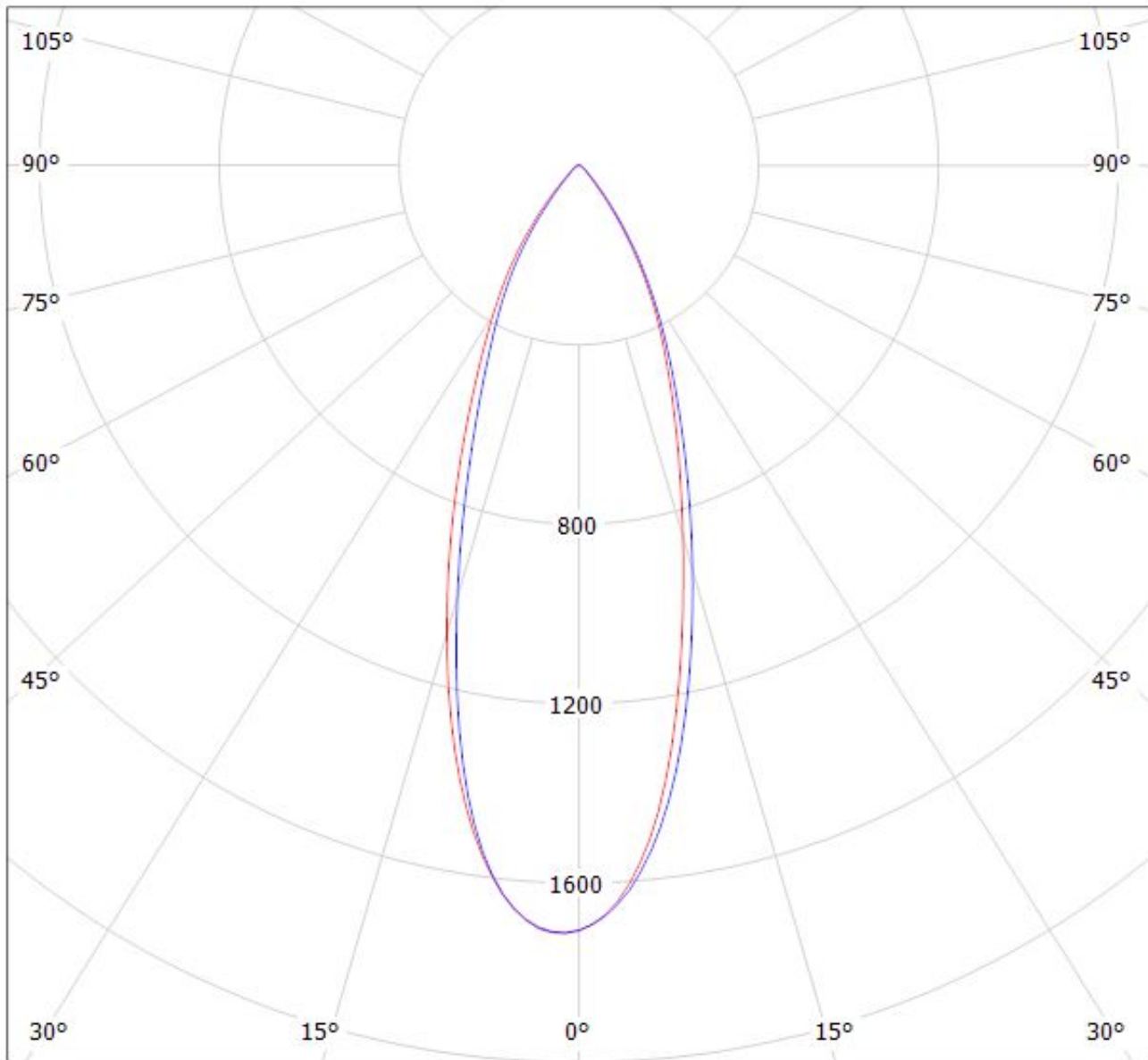

cd/klm

$\eta = 84\%$

— C0 - C180

— C90 - C270

Luminaire: Ledil Oy CN13131_MIRELLA-50-M-DL-PF_(Soleriq_S9)_SIMULATED
Lamps: 1 x Osram Soleriq S9 (GW KAJFB3.EM)

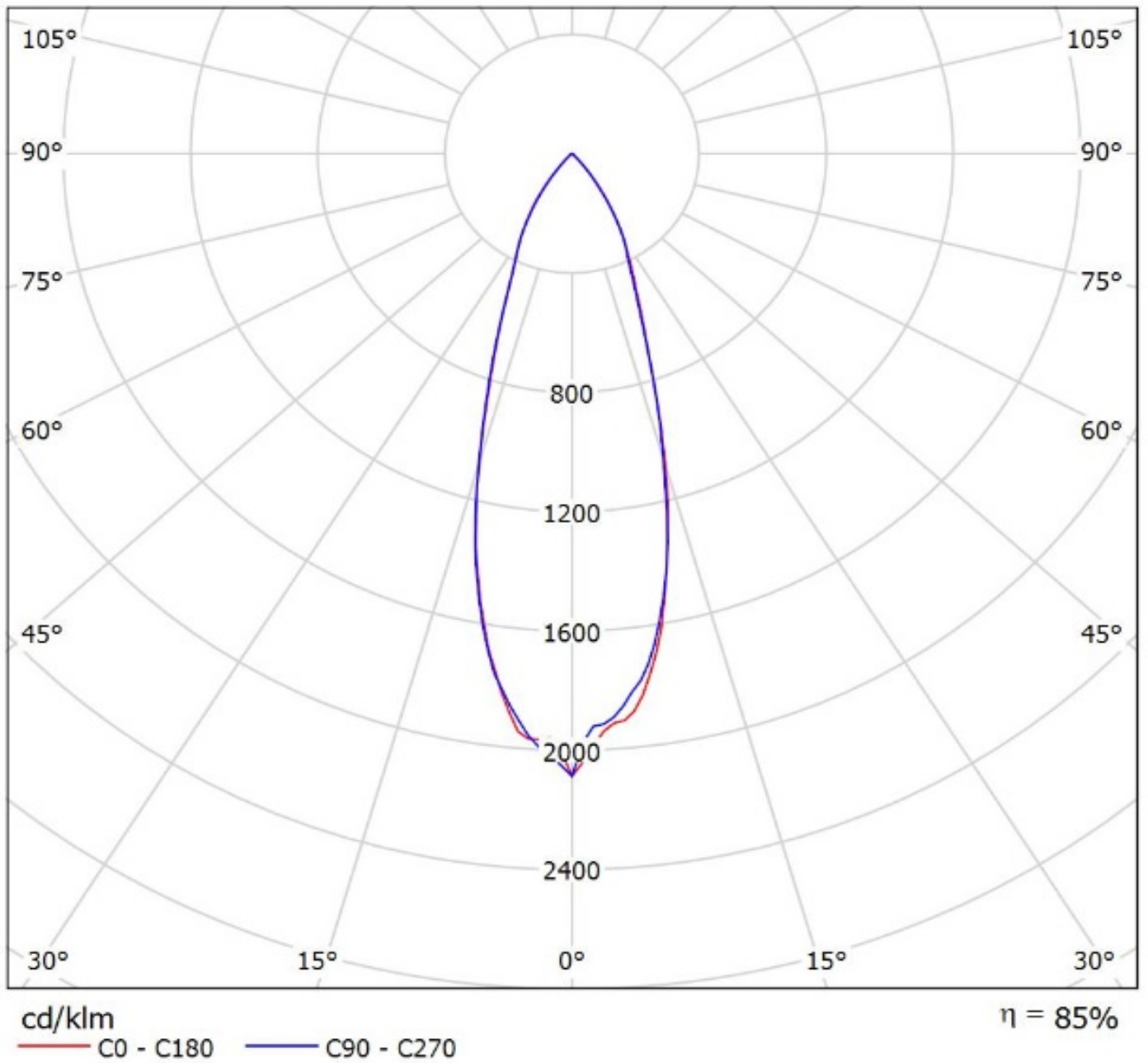

Luminaire: LEDil Oy CN13131_MIRELLA-50-M-DL-PF_(ZC6) Efficiency=83%
Lamps: 1 x Seoul ZC6 (SDW81F1C) 422lm @ 100mA CCT=3100K P=3.4W I=100mA

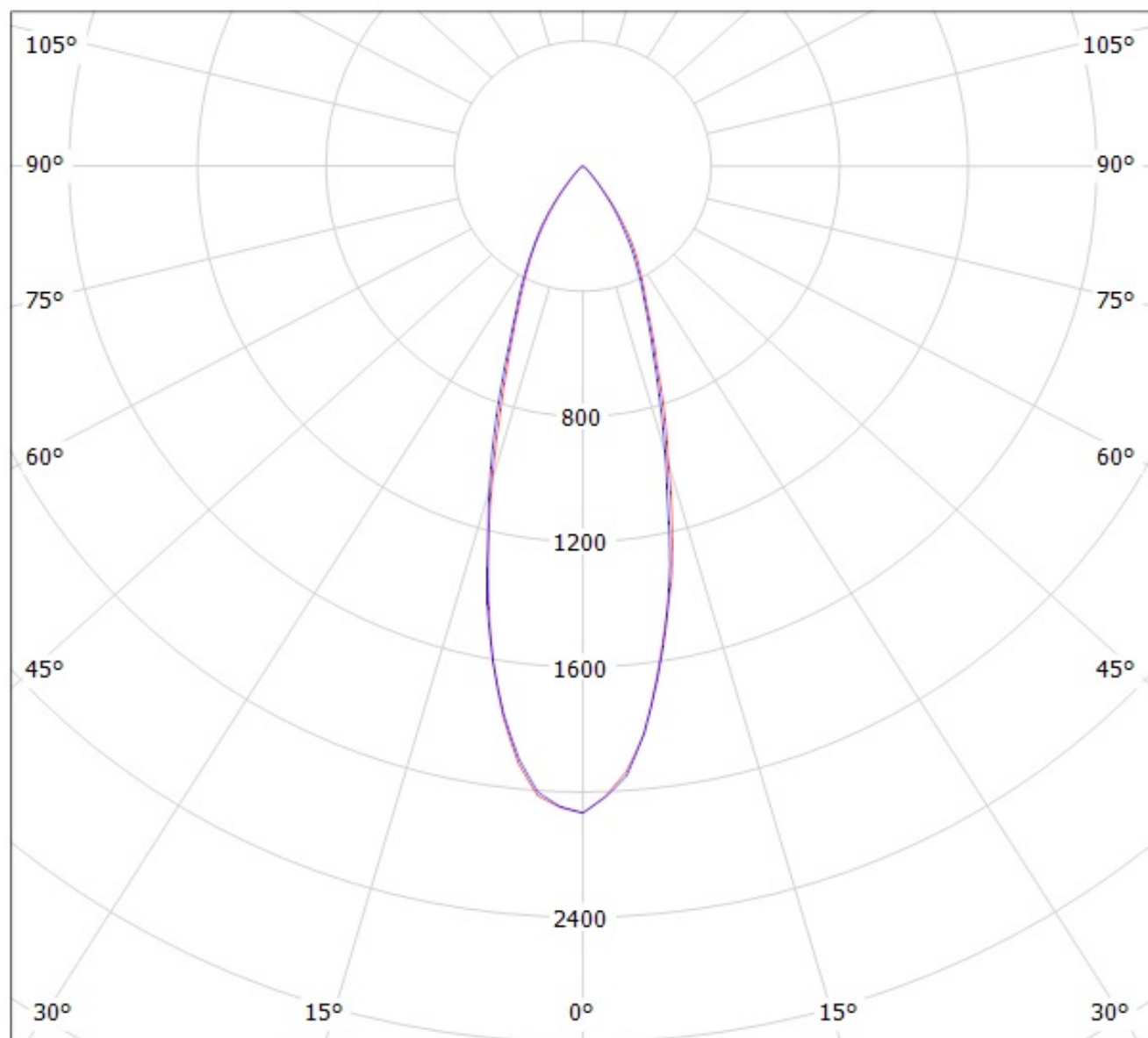

cd/klm

— C0 - C180

— C90 - C270

Luminaire: LEDiL Oy CN13131_MIRELLA-50-M-DL-PF_(Mini_Zenigata_GW6BM) Eff.83.3%
Lamps: 1 x Mini_Zenigata_GW6BM (803.772lm@250mA)

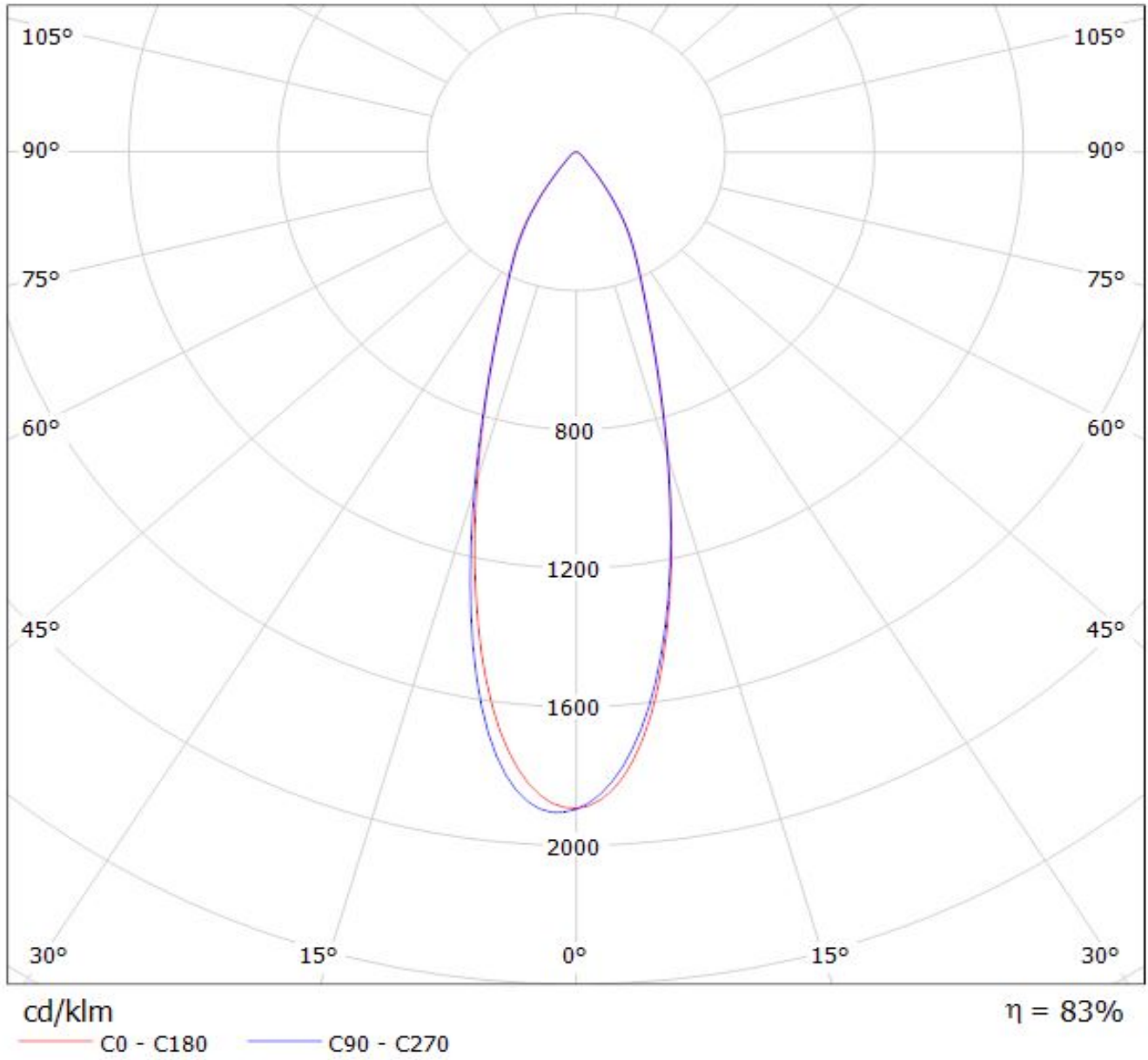

NOTE: The typical divergence will be changed by different color, chip size and chip position tolerance. The typical total divergence is the full angle measured where the luminous intensity is half of the peak value.

GENERAL INFORMATION

- Product series especially designed & optimized for series of LEDs.
- Special care taken to make light distribution as uniform as possible.

Note! Due to use of high power COB's with this product, special attention to proper thermal design is highly recommended. LEDiL has no liability for direct, indirect or consecutive damages arising from the LEDiL products being used outside of the recommended temperature range.