

POS. 1 DESIGNATE  
PIN #1 LOCATION

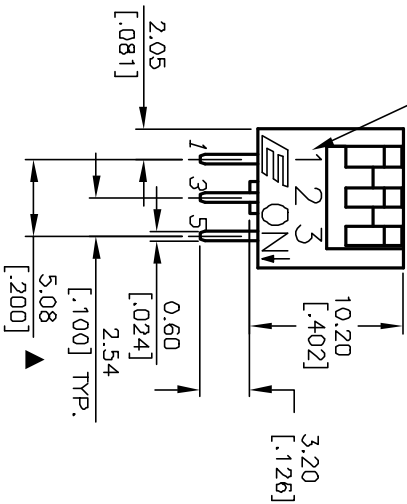

NOTES:

1. ALL DIMENSIONS IN MM
2. GENERAL TOLERANCE: X.X=±0.4  
X.XX=±0.25
3. TERM. NOS. FOR REFERENCE ONLY.
4. CONTACT RATINGS: 25mA @24VDC.
5. MATERIAL: (TERMINALS/CONTACTS):  
PHOSPHOR BRONZE w/Gold Plate over  
Nickel Plate
6. INSULATION RESISTANCE:  
100Mega-ohms min @500VDC
7. CONTACT RESISTANCE (INITIAL):  
50mILLI-ohms @2-4VDC @100mA
8. OPERATING FORCE: 1000gf max.
9. TRAVEL: 2mm typical
- ▲10. SWITCHES SUPPLIED IN DISPENSING TUBES  
WITH ALL POLES IN THE "OFF" POSITION.
11. ▲ DENOTES CRITICAL PARAMETER.

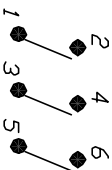
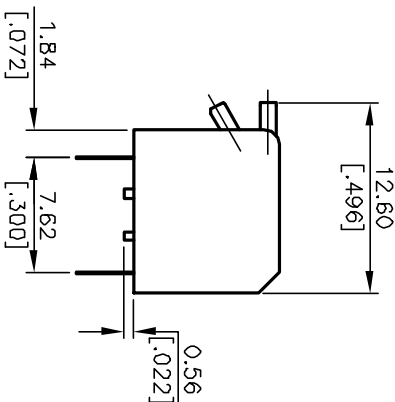

CONTACT CONFIGURATION

\* (Pos. 1 Denotes Pin No. 1)

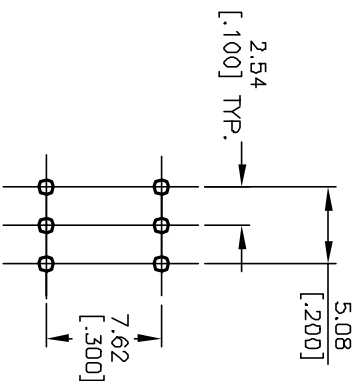

RECOMMEND P.C.B. LAYOUT -For 3 Pos.

A	13130	RELEASED FOR PRODUCTION	5/12/03	CHKD
REV.	ECN No.	DESCRIPTION	DATE	CHKD

TITLE				
KAP1103E				
SCALE	DATE	DR	DWG	REV
2:1	5/12/03	AR	N411032	A

**E-SWITCH®**

THE INFORMATION CONTAINED IN THIS DOCUMENT IS PROPRIETARY TO E-SWITCH AND IS NOT TO BE COPIED OR TRANSFERRED