

POS. 1 DESIGNATE
PIN #1 LOCATION

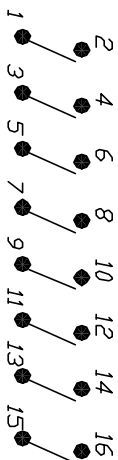
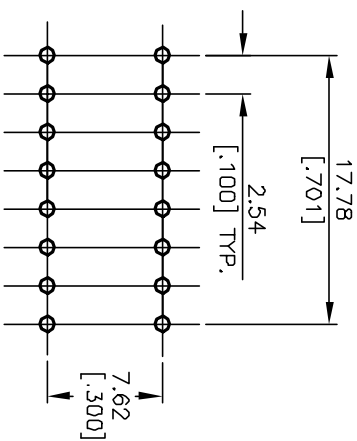
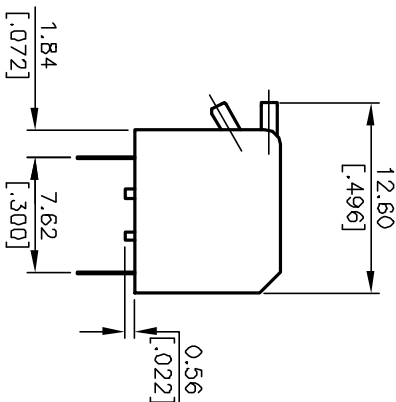
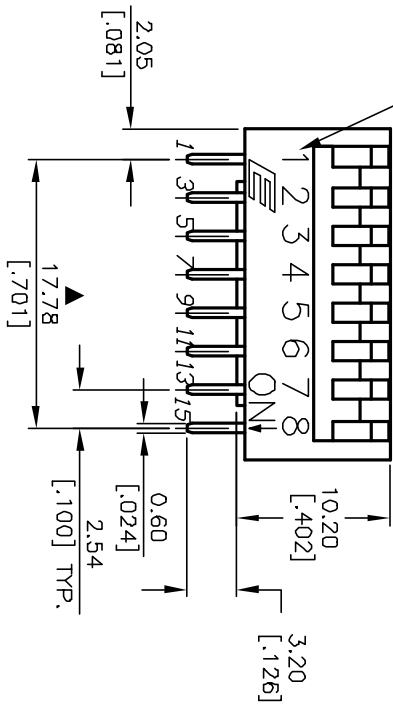

CONTACT CONFIGURATION

* (Pos. 1 Denotes Pin No. 1)

RECOMMEND P.C.B. LAYOUT - FOR 8 POS.

NOTES:

1. ALL DIMENSIONS IN MM
2. GENERAL TOLERANCE: X.X=±0.4
X.XX=±0.25
3. TERM. NOS. FOR REFERENCE ONLY.
4. CONTACT RATINGS: 25mA @24VDC.
5. MATERIAL: (TERMINALS/CONTACTS):
PHOSPHOR BRONZE w/Gold Plate over
Nickel Plate
6. INSULATION RESISTANCE:
100Mega-ohms min @500VDC
7. CONTACT RESISTANCE (INITIAL):
50mILLI-ohms @2-4VDC @100ma
8. OPERATING FORCE: 1000gf max.
9. TRAVEL: 2mm typical
- ▲ 10. SWITCHES SUPPLIED IN DISPENSING TUBES
WITH ALL POLES IN THE "OFF" POSITION.
11. ▲ DENOTES CRITICAL PARAMETER.

B	13130	REMOVE TABLE, REDRAW	5/12/03	AR
A		RELEASED FOR PRODUCTION	12/4/96	MM
REV.	ECN No.	DESCRIPTION	DATE	CHKD

E-SWITCH®				
TITLE KAP1108E				
SCALE	2:1	DATE	5/12/03	DR
				AR
		DWG	N411082	REV
				B

THE INFORMATION CONTAINED IN THIS DOCUMENT IS PROPRIETARY TO E-SWITCH AND IS NOT TO BE COPIED OR TRANSFERRED