

POS. 1 DESIGNATE  
PIN #1 LOCATION

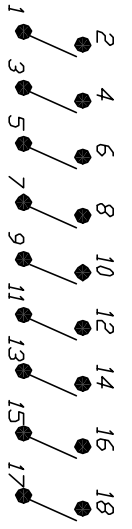
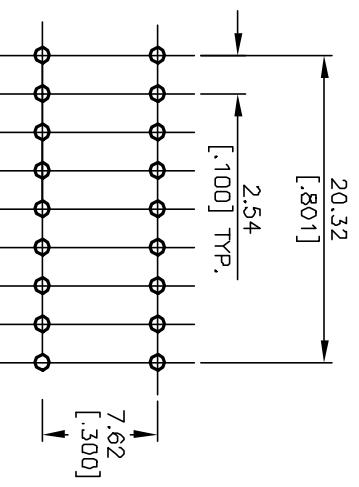
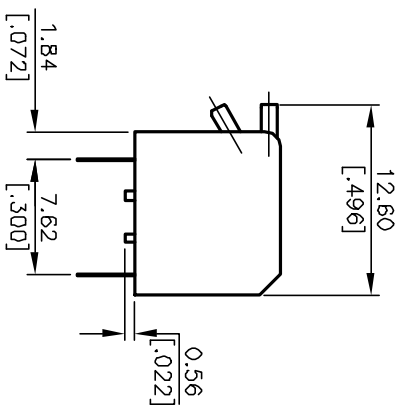
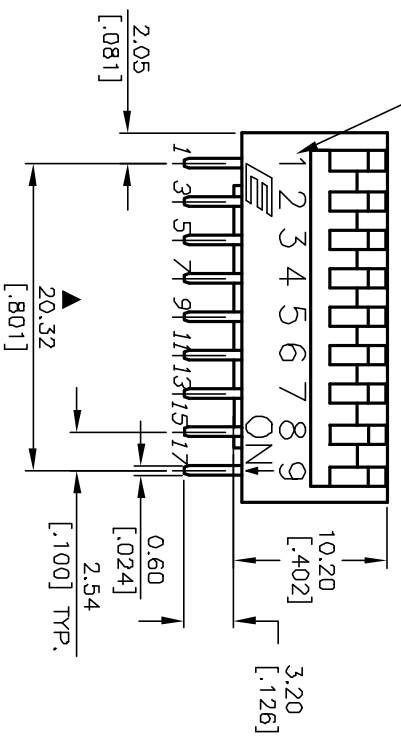

\*KPos. 1 Denotes Pin No. 1)

RECOMMEND P.C.B. LAYOUT -FOR 9 POS.

- NOTES:
1. ALL DIMENSIONS IN MM
  2. GENERAL TOLERANCE: X.X=±0.4  
X.XX=±0.25
  3. TERM. NOS. FOR REFERENCE ONLY.
  4. CONTACT RATINGS: 25mA @24VDC.
  5. MATERIAL: (TERMINALS/CONTACTS):  
PHOSPHOR BRONZE w/Gold Plate over  
Nickel Plate
  6. INSULATION RESISTANCE:  
100Mega-ohms min @500VDC
  7. CONTACT RESISTANCE (INITIAL):  
50mILLI-ohms @2-4VDC @100mA
  8. OPERATING FORCE: 1000gf max.
  9. TRAVEL: 2mm typical
  10. SWITCHES SUPPLIED IN DISPENSING TUBES  
WITH ALL POLES IN THE "OFF" POSITION.
  11. ▲ DENOTES CRITICAL PARAMETER.

|      |         |                         |         |      |
|------|---------|-------------------------|---------|------|
| REV. | ECN No. | DESCRIPTION             | DATE    | CHKD |
| A    | 13131   | RELEASED FOR PRODUCTION | 5/12/03 | AR   |

|          |  |       |         |    |         |     |
|----------|--|-------|---------|----|---------|-----|
| TITLE    |  | SCALE | DATE    | DR | DWG     | REV |
| KAP1109E |  | 2:1   | 5/12/03 | AR | N411092 | A   |

**E-SWITCH®**

THE INFORMATION CONTAINED IN THIS DOCUMENT IS PROPRIETARY TO E-SWITCH AND IS NOT TO BE COPIED OR TRANSFERRED