

16

NES/J 25

Power supply connectors



Power supply plug, short, straight version, with solder eyes

State: Active

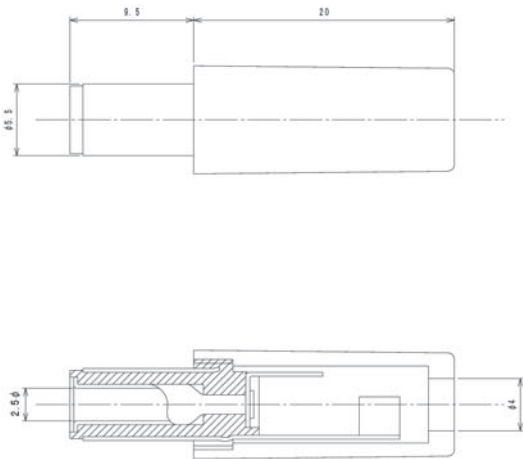

Environmental conditions

Temperature range -25 °C/+70 °C

Materials

Insulating body	ABS, HB according to UL94
Contact	CuZn, nickel-plated
Housing	ABS

Mechanical data

Outer diameter	5,5 mm
Inner diameter	2,5 mm

Connectable conductors for solder area

Cable diameter 4 mm

Electrical data (at T_{amb} 20 °C)

Rated current	1 A
Rated voltage	12 V DC
Rated impulse voltage	500 V/60 s
Insulation resistance	≥ 100 MΩ

Associated products

Counterparts

☞ 1610 01	☞ 1610 05	☞ 1613 21
☞ 1614 10	☞ 1614 15	☞ 1614 20
☞ 1634 02	☞ NEB/J 25	☞ NEB/J 25 C
☞ NEB/J 25 R	☞ NEK/J 250	

16

NES/J 25

Designation	Pole Number	PU (Pieces)	MDQ (Pieces)
NES/J 25	2	100	1000

Packaging:

in bulk, in a cardboard box or a plastic bag