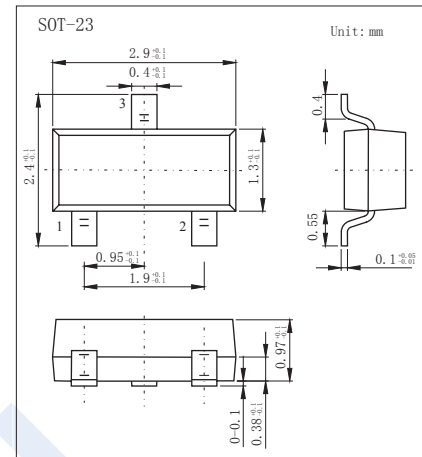
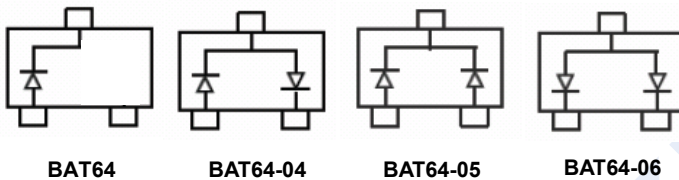

Schottky Diodes

BAT64-04/05/06 (KAT64-04/05/06)

■ Features

- For low-loss, fast-recovery, meter protection, bias isolation and clamping applications
- Integrated diffused guard ring
- Low forward voltage

■ Absolute Maximum Ratings $T_a = 25^\circ\text{C}$

| Parameter | Symbol | Rating | Unit |
|--|-----------------|------------|---------------------------|
| Peak Reverse Voltage | V_{RM} | 40 | V |
| DC Reverse Voltage | V_R | 40 | |
| Forward Current | I_F | 250 | mA |
| Non-repetitive Peak forward surge current @ $t=8.3\text{ms}$ | I_{FSM} | 800 | |
| Power Dissipation | P_D | 250 | mW |
| Thermal Resistance Junction to Ambient | $R_{\theta JA}$ | 400 | $^\circ\text{C}/\text{W}$ |
| Junction Temperature | T_J | 125 | $^\circ\text{C}$ |
| Storage Temperature range | T_{stg} | -55 to 150 | |

■ Electrical Characteristics $T_a = 25^\circ\text{C}$

| Parameter | Symbol | Test Conditions | Min | Typ | Max | Unit |
|---------------------------------|--------|--|-----|-----|-----|---------------|
| Reverse breakdown voltage | V_R | $I_R = 100 \mu\text{A}$ | 40 | | | V |
| Forward voltage | V_F | $I_F = 1 \text{ mA}$ | | | 350 | mV |
| | | $I_F = 10 \text{ mA}$ | | | 430 | |
| | | $I_F = 30 \text{ mA}$ | | | 520 | |
| | | $I_F = 100 \text{ mA}$ | | | 750 | |
| Reverse voltage leakage current | I_R | $V_R = 25 \text{ V}$ | | | 2 | μA |
| Capacitance between terminals | C_T | $V_R = 1 \text{ V}, f = 1 \text{ MHz}$ | | 6 | | pF |

■ Marking

| Type | BAT64 | BAT64-04 | BAT64-05 | BAT64-06 |
|---------|-------|----------|----------|----------|
| Marking | 63S | 64S | 65S | 66S |

Schottky Diodes

BAT64-04/05/06 (KAT64-04/05/06)

■ Typical Characteristics

