

35

352300

RAST 2.5 connectors, pitch 2.5/5.0 mm

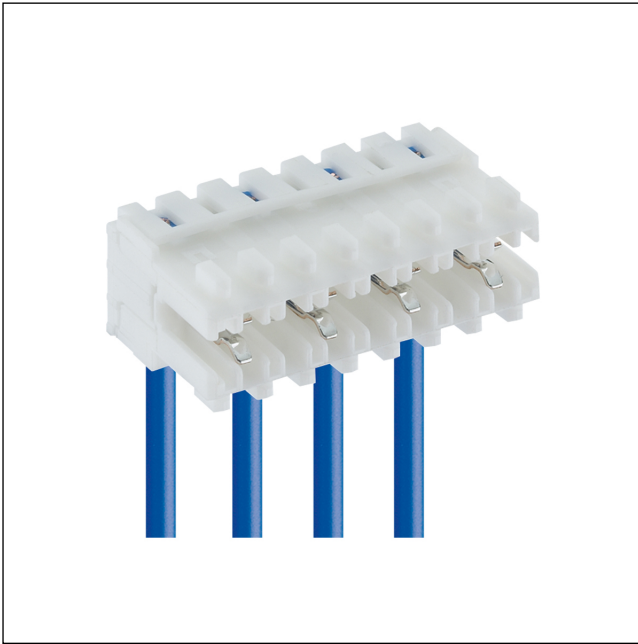

RAST 2.5 plus™ connector for direct and indirect mating,
with double-sided keying, insulation displacement
technology (IDT)
contact pitch 5.0 mm

State: Active

Approvals:



35 352300

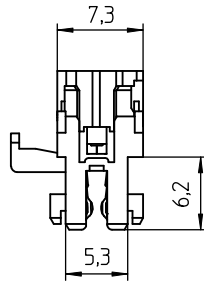
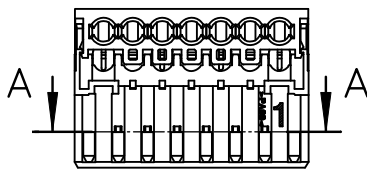
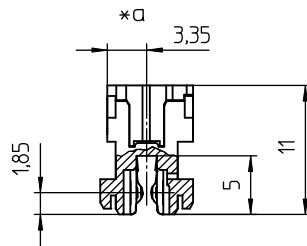
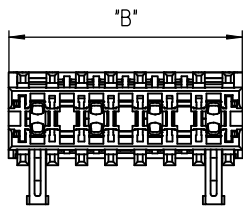

A-A

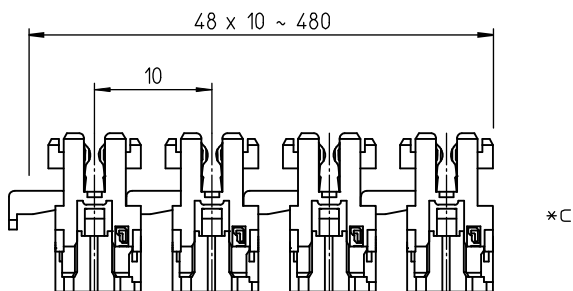
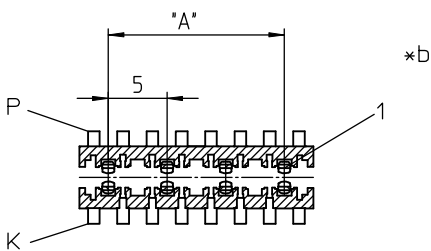

Environmental conditions

Temperature range -40 °C/+130 °C¹

¹ upper limit temperature (insulating body) RTI (electrical) of the UL Yellow Card

Materials

Insulating body PA, V-0 according to UL94¹

Contact spring CuSn, tin-plated

¹ material halogen-free, GWFI 850 °C, GWIT 775 °C

Mechanical data

Mating with Leiterplatte 1,5 ± 0,14 mm

Insertion force/contact ≤ 4,0 N

Withdrawal force/contact ≥ 0,5 N

Keying proposals at www.lumberg.com 

Connectable conductors for IDT area

Construction discrete conductor, notched flat cable 2.5 mm

Section min. 0,35 mm²

Section max. 0,38 mm²

Insulation diameter ≤ 1,6 mm

Approved cables at www.lumberg.com 

Electrical data (at T_{amb} 20 °C)

Contact resistance ≤ 5 mΩ

Rated current 4 A (T_v 60 °C)
2 A (T_v 100 °C)

Rated voltage 250 V AC

Material group I (IEC)/0 (UL) (CTI ≥ 250)









Creepage distance 3,65 mm

Clearance 3,20 mm

Insulation resistance > 1 GΩ

Associated products

Counterparts

 3542	 3542-1	 3546
 3546-1	 3552	 355295
 355299	 3556	 83546

Accessories







 3500

35

352300

-
- *a terminated connector
 - *b K = keying
P = Positioning
 - *c chaining of the component parts (state of delivery)

Harnessing equipment

- | | | |
|--|--|---|
|  HA3...e |  HA35 plus |  HZ35-K |
|  KHP35 plus |  VARICON 7000 |  VARICON 7000-RD |
-

35

352300

Designation	Pole Number	PU (Pieces)	MDQ (Pieces)	Dimensions	
				A (mm)	B (mm)
352300 02	2	3456	10368	5.0	9.9
352300 03	3	2160	10800	10.0	14.9
352300 04	4	1728	5184	15.0	19.9
352300 05	5	1296	3888	20.0	24.9
352300 06	6	864	2592	25.0	29.9

Designation to be completed by further details (e.g. for keying, color or material options).

Packaging:

chained, in a cardboard box