

**SAW Filter 902.5MHz**  
**Part No: MA04713**

**Model: TA0143A**  
**Rev No: 3**

**A. MAXIMUM RATING:**

1. Input Power Level: 10dBm
2. DC voltage: 0V
3. Operating Temperature: -25°C to +75°C
4. Storage Temperature: -40°C to +85°C

**B. ELECTRICAL CHARACTERISTICS:**

Characteristics	Specification			Note
	Min.	Typ.	Max	
Center frequency Fc MHz	-	902.5	-	-
Insertion loss (890 ~ 915MHz) IL dB	-	2.9	3.5	-
VSWR (890 ~ 915MHz )	-	1.5	2.3	-
Ripple (890 ~ 915MHz ) dB	-	0.5	1.5	-
Attenuation: (Reference level from 0dB)				
1. 0 ~ 845MHz dB	45	51.0	-	-
2. 925 ~ 935MHz dB	5	21.0	-	-
3. 935 ~ 980MHz dB	25	28.0	-	-
4. 980 ~ 1200MHz dB	50	56.0	-	-
5. 1200 ~ 3000MHz dB	25	28.0	-	-
Impedance at Fc				
Input $Z_{IN} = R_{IN} // C_{IN}$	50Ω // 0PF			1
Output $Z_{OUT} = R_{OUT} // C_{OUT}$	50Ω // 0PF			1

Note1. No matching network required for operation at 50 Ω

**SAW Filter 902.5MHz**  
**Part No: MA04713**

**Model: TA0143A**  
**Rev No: 3**

**C. FREQUENCY CHARACTERISTICS:**

1. wide band of S21

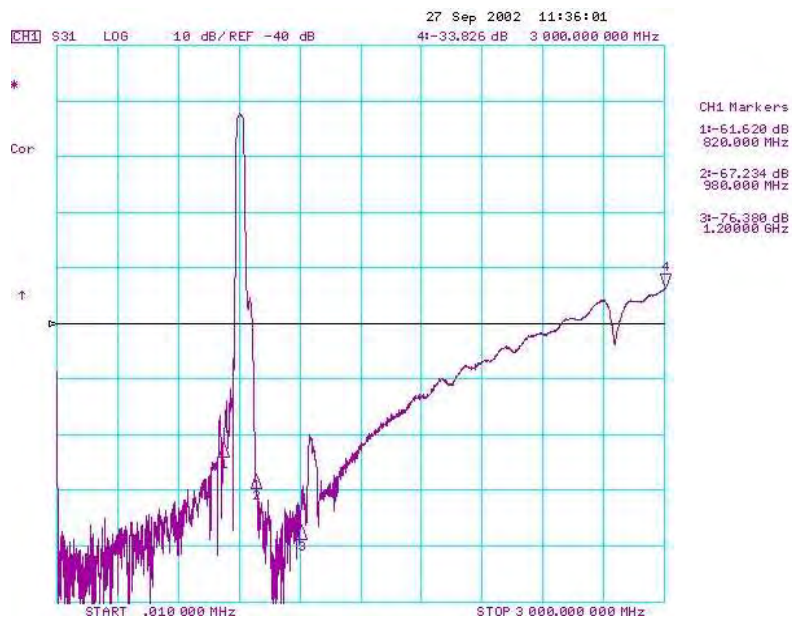
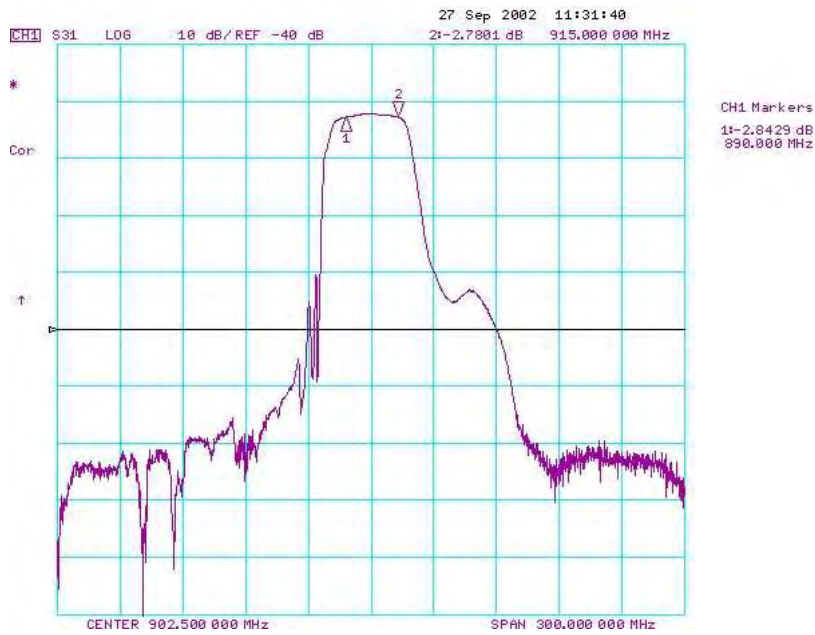

**SAW Filter 902.5MHz**  
**Part No: MA04713**

**Model: TA0143A**  
**Rev No: 3**

2. Reflections Functions

S11

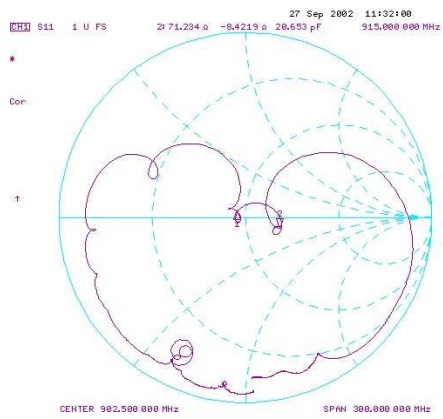

CH1 Markers  
 1: 45.205 Ω  
 2: 3.3652 Ω  
 3: 890.000 MHz

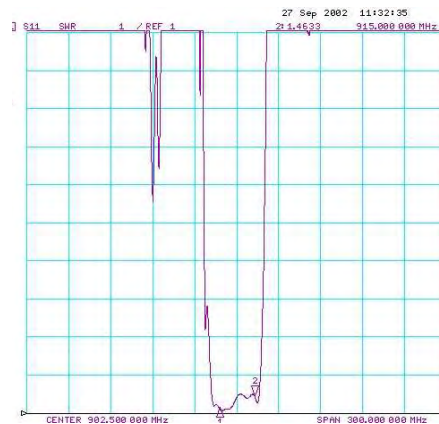

CH1 Markers  
 1: 1.1500  
 3: 890.000 MHz

S22

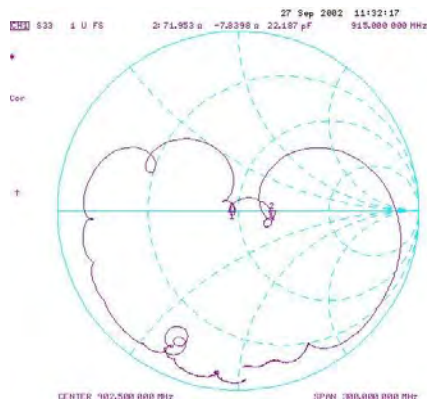

CH1 Markers  
 1: 45.877 Ω  
 2: 3.3450 Ω  
 3: 890.000 MHz

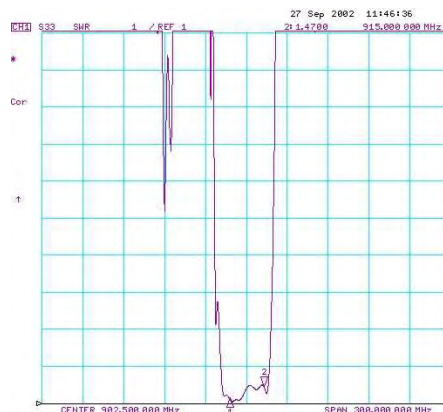

CH1 Markers  
 1: 1.1277  
 3: 890.000 MHz

**SAW Filter 902.5MHz**  
**Part No: MA04713**

**Model: TA0143A**  
**Rev No: 3**

**D. MEASUREMENT CIRCUIT:**

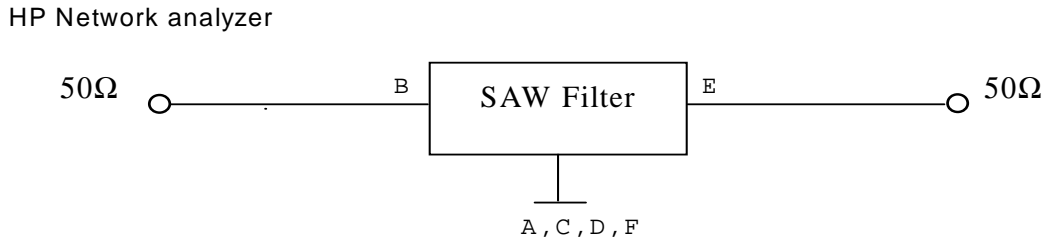

**E. OUTLINE DRAWING:**

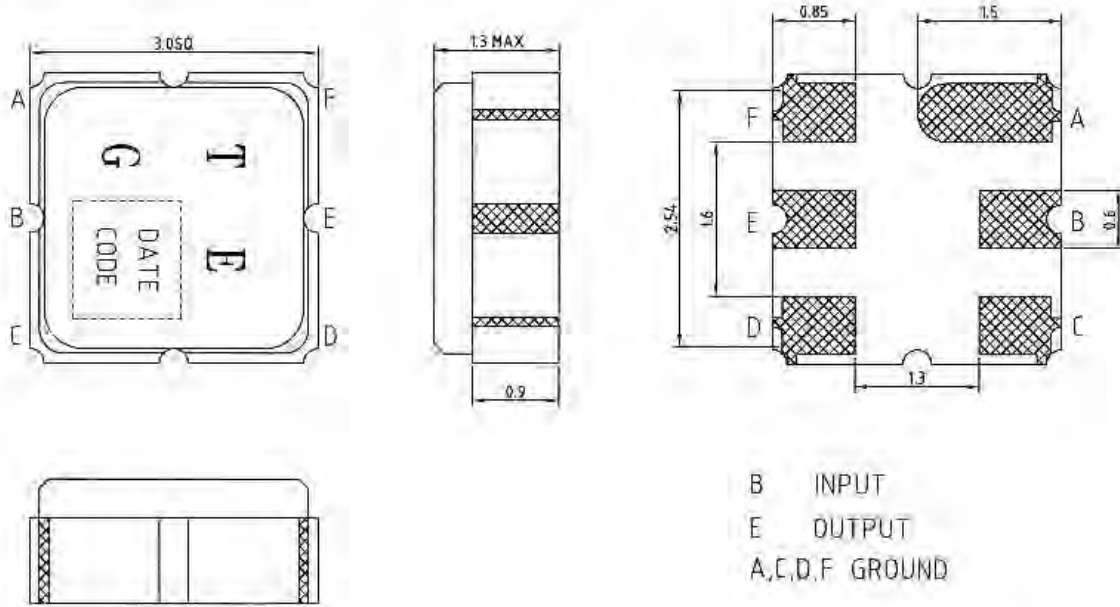

**SAW Filter 902.5MHz**  
**Part No: MA04713**

**Model: TA0143A**  
**Rev No: 3**

**F. PACKING:**

1. REEL DIMENSION

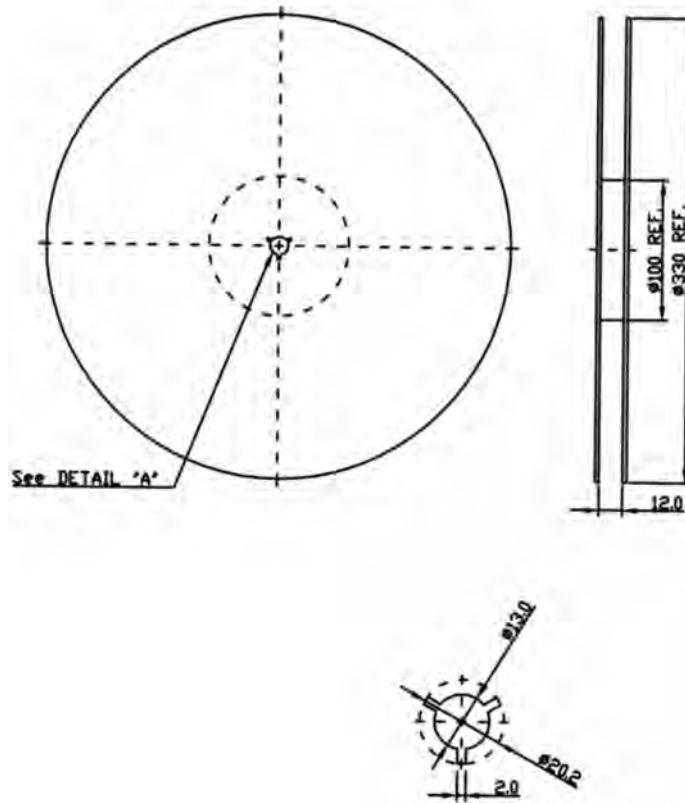

2. TAPE DIMENSION

